

Installation and operation instruction

What you receive is whole unit, please.

1. Take apart Plastic nut ⑥ and Rubber washer ⑤ from Tap body ① one by one by hand.
2. Put Tap body ① in the hole of Basin, make sure correct direction.
3. Hose-Cold ⑦ pass through Plastic nut ⑥ and Rubber washer ⑤, then connect to Tap body ① left side hole. So is Hose-Hot ⑧, but it needs to connect to Tap body ① right side hole. (Pay attention, Plastic nut ⑥ and Rubber washer ⑤ under the basin)
4. Screw Plastic nut ⑥ with Tap body ① by hand.
5. At last, turn Handle clockwise. You can use it now.

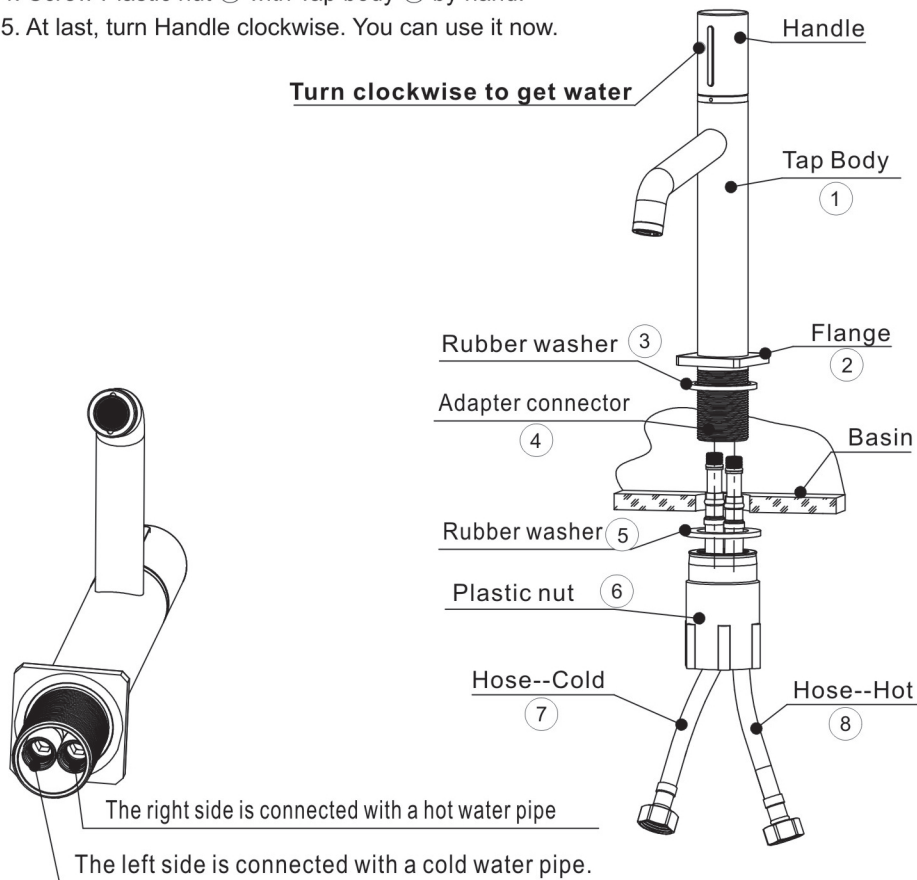

Victorian Plumbing

Diamond House.41, Stephenson Way. Formby Business Park Formby. England. L37 8EG

Tel: 0044 800 862 0878

Website: www.victorianplumbing.co.uk