

Installation and operation instruction

1. Place two plastic expansion screws (2) on the wall, and then use two SS304 self-tapping screws (3) to fix the valve body (1) on the wall (pay attention to the position and levelness between the valve body, floor and wall).
2. Connect the cold/hot water inlet pipe to the two G1/2 inlet holes of the valve body (1).
The outlet connector connect to shower pipe.
3. Decorate the wall tile surface.
4. Pull plastic sleeves (4), Unscrew the M5 locking screw (5) with the S2.5 Allen key (6), then remove the handle (7).
5. Cover Flange (8) on Cartridge sleeve (9).
6. Put the handle (7) on the stem of the spool (10), turn the handle (7) to the left side of the spool counter-clockwise. Pull out handle (7) align the blue dot. Tighten the M5 screw (5) with the S2.5 Allen Key (6), and finally install the rubber plug (11) in the handle hole.
7. Check all joints & connections for leaks.

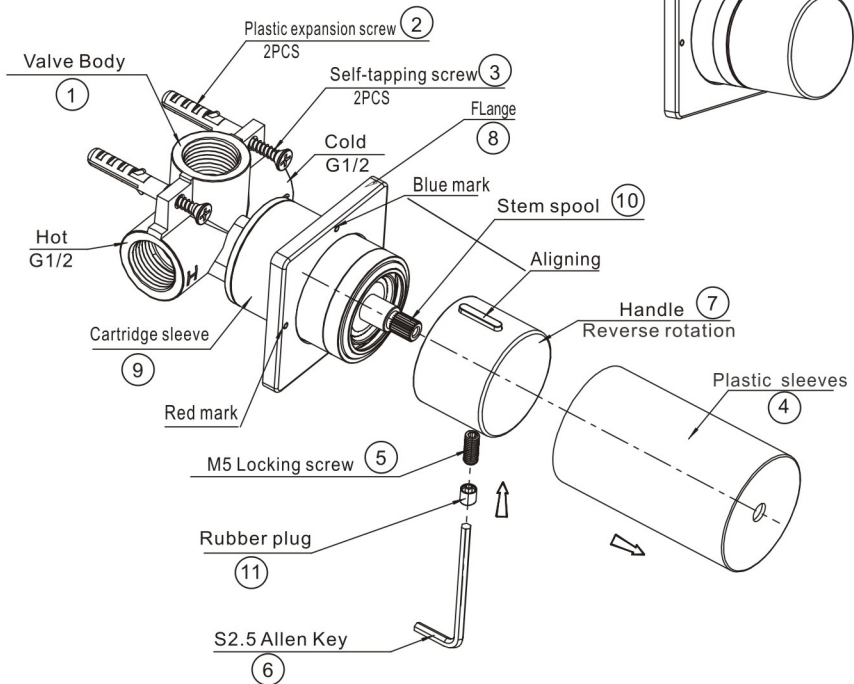

Victorian Plumbing

Diamond House.41, Stephenson Way. Formby Business Park Formby. England. L37 8EG

Tel: 0044 800 862 0878

Website: www.victorianplumbing.co.uk