

# Back to Wall Riser Rail Kit

ONE YEAR  
GUARANTEE**1**

INSTALLERS PLEASE NOTE THESE INSTRUCTIONS ARE TO BE LEFT WITH THE USER

**Fig.1** For illustration purposes only

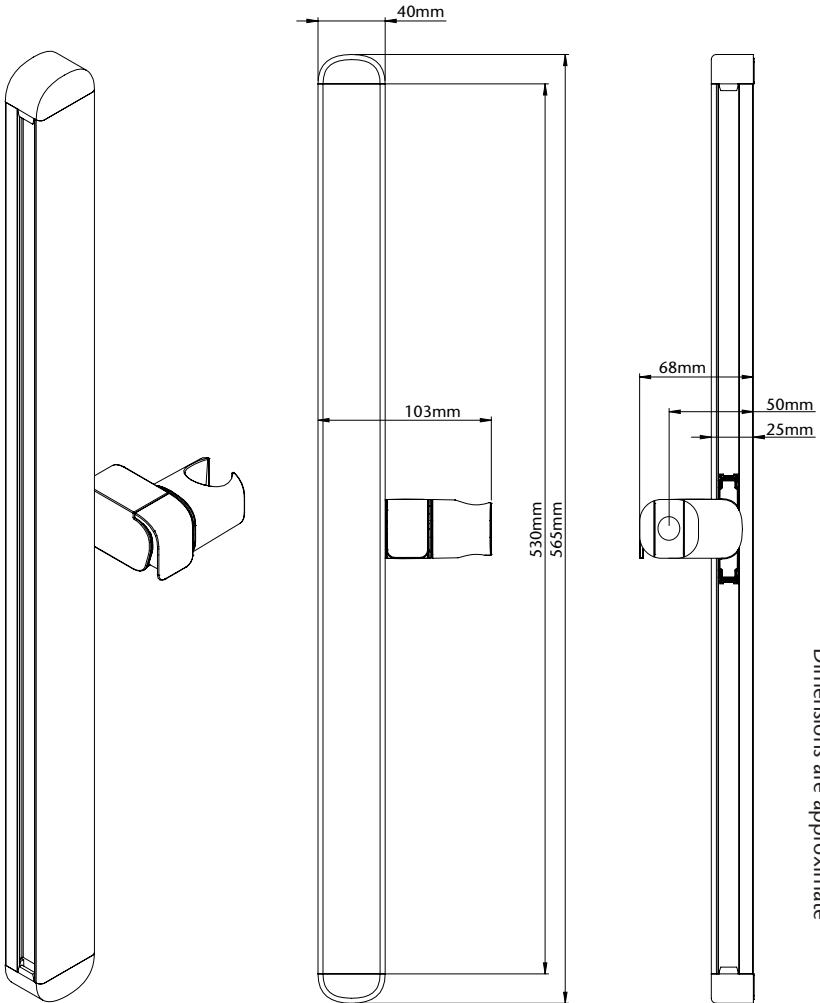
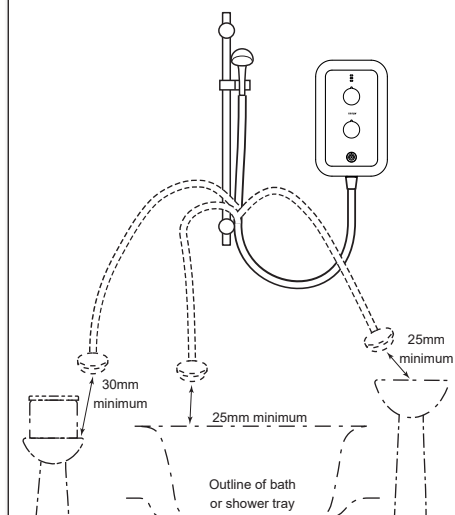

## Siting

To prevent the possibility of back siphonage, consideration must be made on installation to the airgap arrangement. For guidance, the shower head must be prevented from reaching within 25mm of the spillover level of any bath, shower tray or washbasin and from reaching within 30mm of the spillover level of any WC, bidet or other basin that is classified higher than fluid category 3 - see **fig.1**.

**Fig.2**

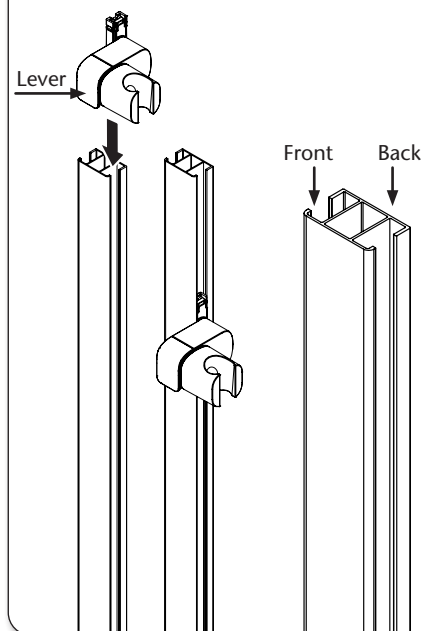

## Installation

Decide on the position of the rail within the shower area.

**The shower head holder can only be used on the right hand side, therefore consideration must be given to the distance from the shower unit or wall.**

### Fig.2

Press the lever on the shower head holder and slide into the rail as shown - pressing the lever allows for movement up and down the rail.

**Fig. 3**

Insert the wall fixing brackets into the rail, ensuring the fixing holes are to the back of the rail. Hold the rail to the wall and using a spirit level to ensure rail is aligned correctly, mark the top and bottom fixing holes.

**Note:** The fixing holes are elongated to allow for some adjustment. An appropriate drill bit should be used. If the wall is brick, plasterboard or a soft building block, appropriate wall plugs and screws should be fitted.

**WARNING!**

**Check there are no hidden cables or pipes before drilling holes for wall plugs. Use great care when using power tools near water. The use of a residual current device (RCD) is recommended.**

Remove the rail, drill and plug the wall.

Secure the rail to the wall.

**Fig.3**

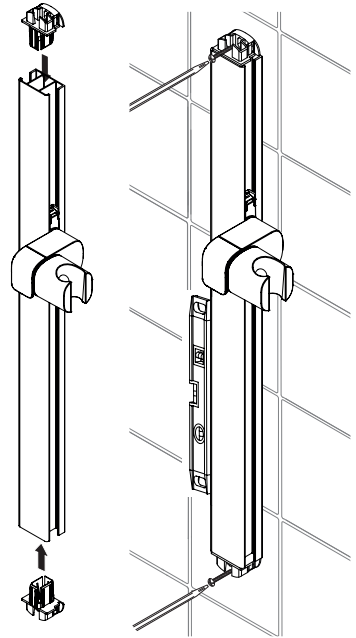
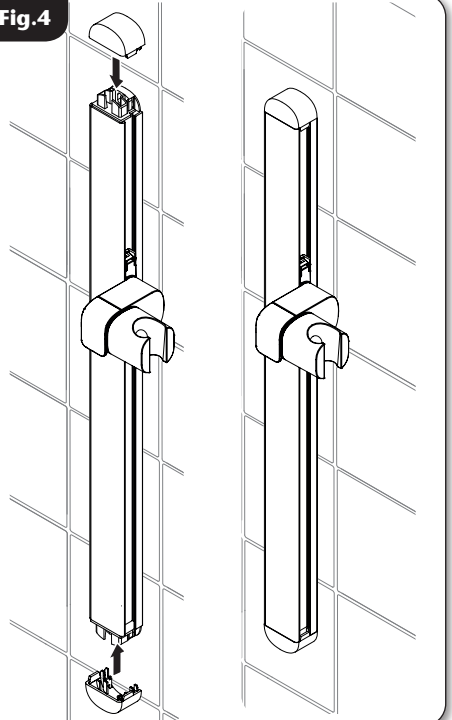

**Fig.4**

Place the bracket trims over the brackets and click into place with a firm press.

Kit is now ready for use.

**Fig.4**



Visit **[www.tritonshowers.co.uk/spares](http://www.tritonshowers.co.uk/spares)** to find genuine Triton spare parts.  
Alternatively please call our Customer Experience team on 024 7637 2222 to  
order direct. Please have your model name available.

**For latest service policy and contact details visit [www.tritonshowers.co.uk](http://www.tritonshowers.co.uk)**