

**TRITON**

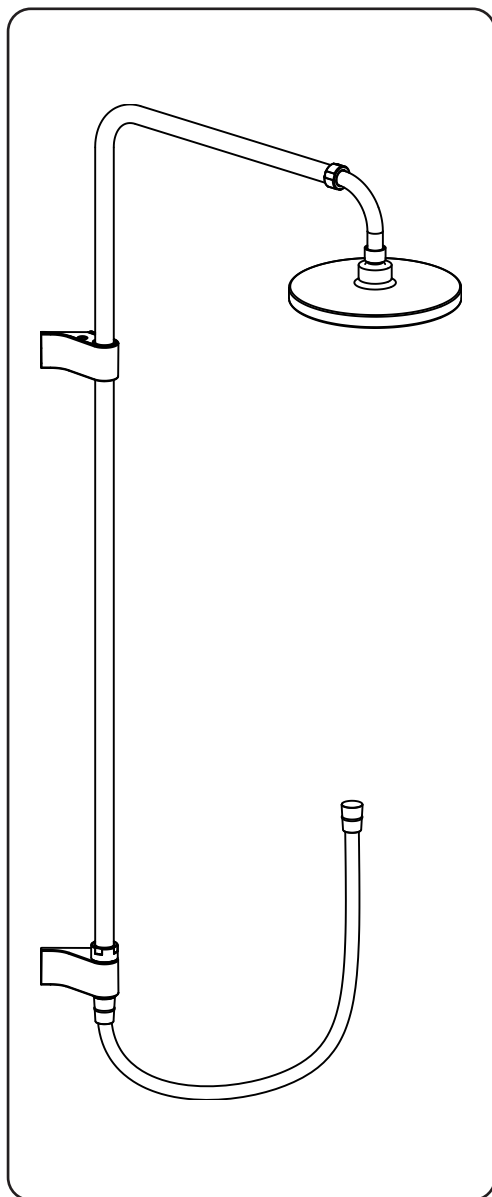

## **UNIQ<sup>®</sup>**

### **Overhead Kit**

#### **IMPORTANT SAFETY ADVICE**

The shower heads and hoses supplied with this product are a safety critical part of your shower system. Failure to use genuine Triton parts may cause injury and invalidate your guarantee.

#### **INSTALLATION AND OPERATING INSTRUCTIONS**

Please read this book thoroughly and familiarise yourself with all instructions before commencing installation.

Keep these instructions in a safe place for future reference.

## MAIN COMPONENTS

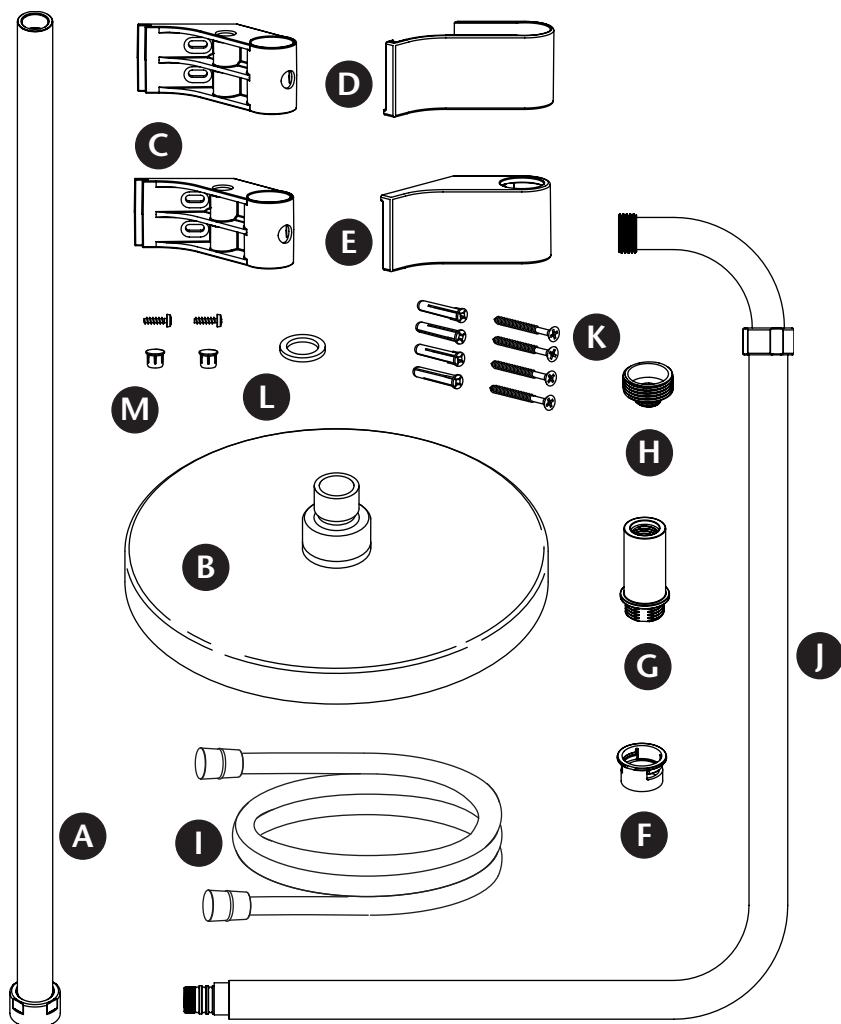

- |                             |                                  |
|-----------------------------|----------------------------------|
| A. Lower Arm                | H. Hose Adaptor                  |
| B. Shower Head              | I. Shower Hose 1m                |
| C. Wall Bracket x2          | J. Upper Extendable Arm          |
| D. Bracket Trim 1           | K. Wall Fixing Screws & Plugs x4 |
| E. Bracket Trim 2           | L. Washer                        |
| F. Collar                   | M. 3.5x12mm Screws & Caps x2     |
| G. Lower Arm Thread Adaptor |                                  |

## DIMENSIONS

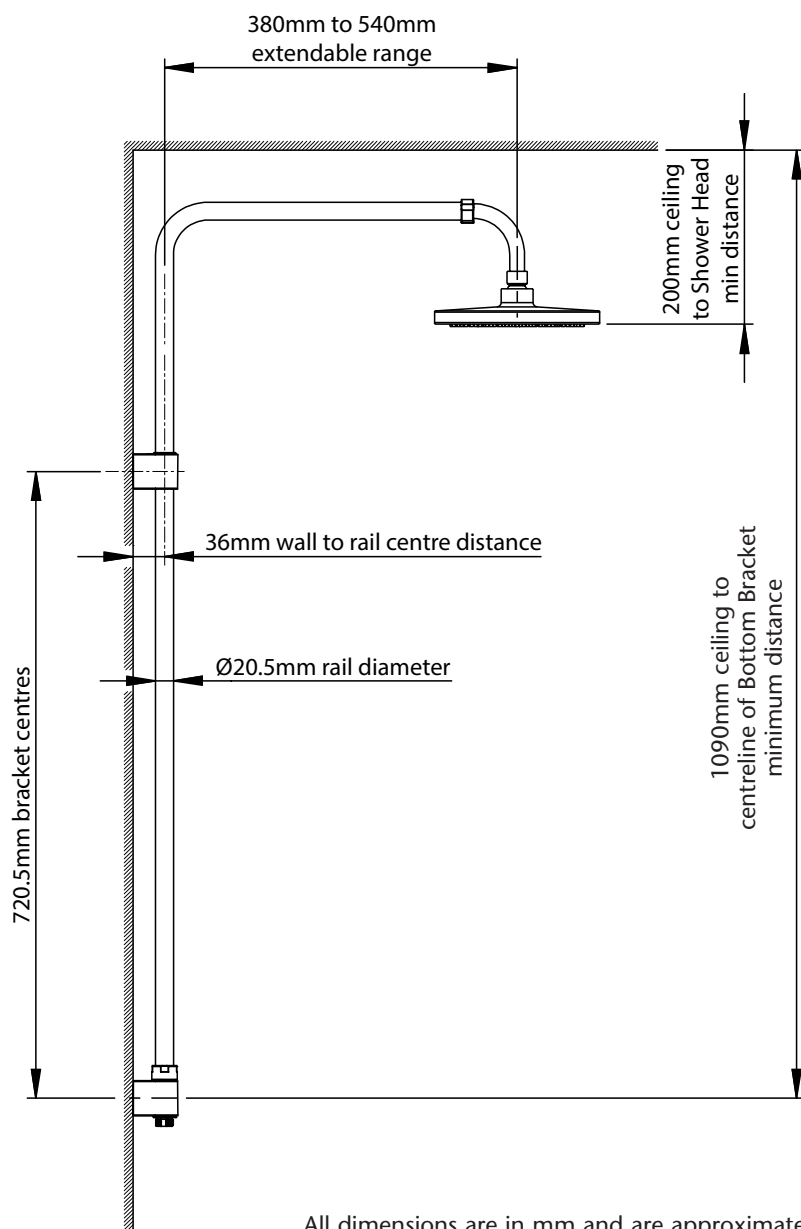

All dimensions are in mm and are approximate

## POSITIONING THE KIT

a) The threaded connection of the Bottom Bracket is to be located within 850mm radius of the threaded connection of the shower unit Outlet Pipe, to prevent strain and kinks on the connecting hose.

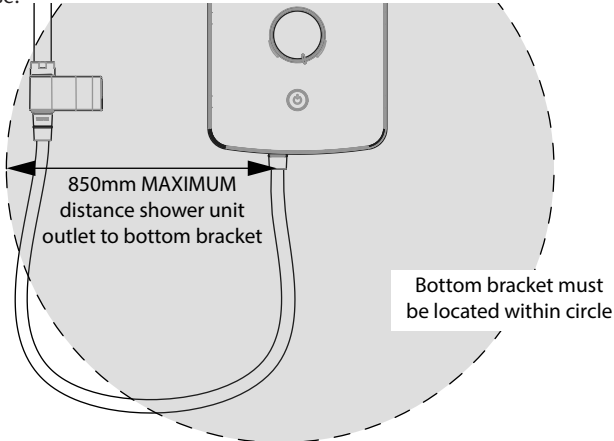

b) The kit can be installed in both left hand and right hand corner installations. It can also be installed at any intermediate position along a wall, in both left hand and right hand orientations.

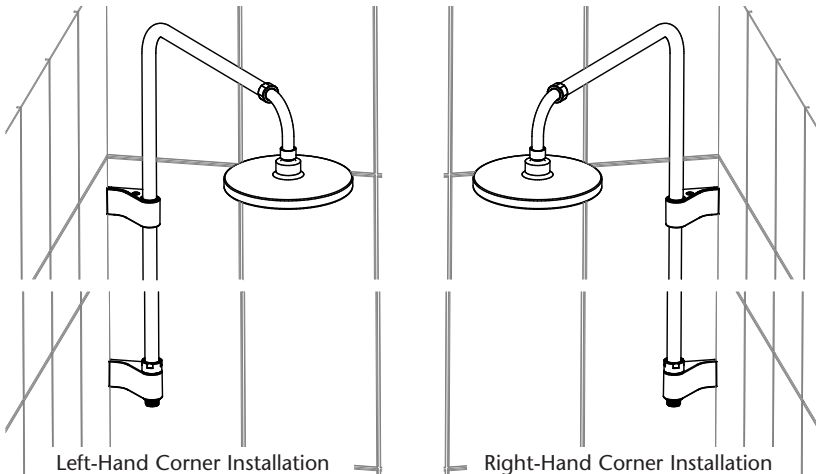

### **WARNING!**

**DO NOT** position the kit in such a way that water is sprayed from the Shower Head directly onto the shower unit.

# INSTALLATION (RH INSTALL SHOWN, REVERSE IMAGES FOR LH INSTALL)

**Step 1**

Referring to the 'Positioning the Kit' section, determine a suitable position for the Bottom Wall Bracket.

Using Bottom Wall Bracket as a template, mark, drill and plug fixing holes for the bracket, then fix bracket to wall.

Ensure suitable wall fixings used. Screws and plugs supplied are for solid wall fixing ONLY.

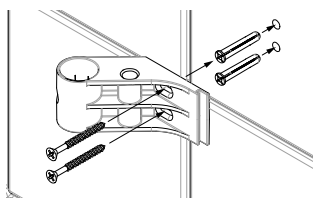

Ensure there are no hidden cables or pipes before drilling holes. Use great care when using power tools near water.

**Step 2**

Assemble Bracket Trim and threaded adaptors to Bottom Wall Bracket

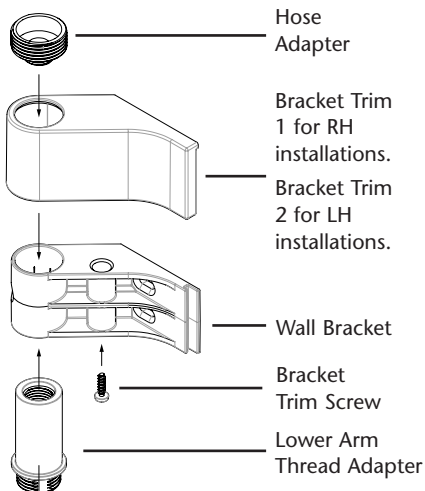

**Step 3**

Assemble shower arms and Top Wall Bracket.

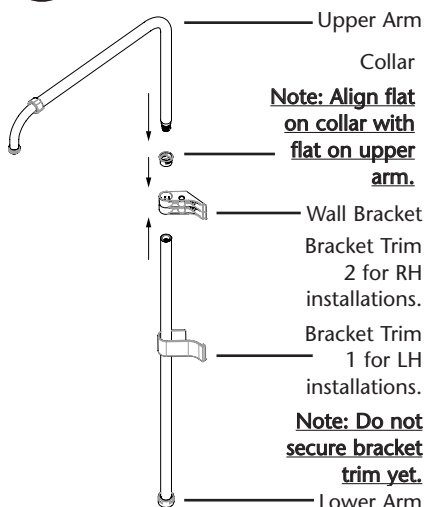

**Step 4**

Assemble shower arm assembly onto Bottom Wall Bracket assembly.

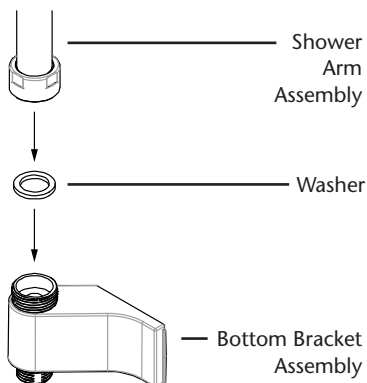

Rotate shower arm assembly to desired position then tighten bottom nut of lower shower arm to lock in position.

# INSTALLATION

Step

5

a) Ensuring arm assembly is vertical, slide top Wall Bracket upwards against Collar. Using bracket as template, mark top fixing positions.

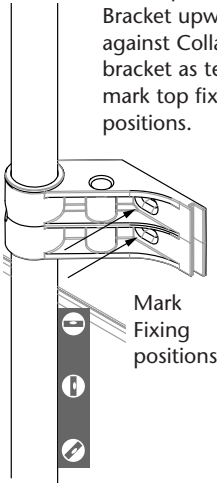

Ensure suitable wall fixings used. Screws and plugs supplied are for solid wall fixing ONLY.

b) Move bracket out of the way, and drill and plug the top 2 fixing holes.

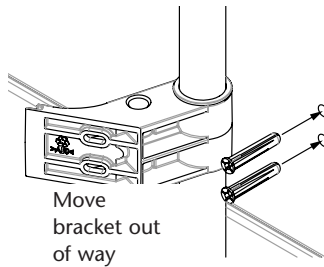

c) Rotate bracket back into position and fix to wall.

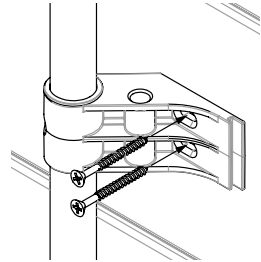

Ensure there are no hidden cables or pipes before drilling holes. Use great care when using power tools near water.

Step

6

Slide Bracket Trim into position and fix in position with supplied Bracket Trim Screw.

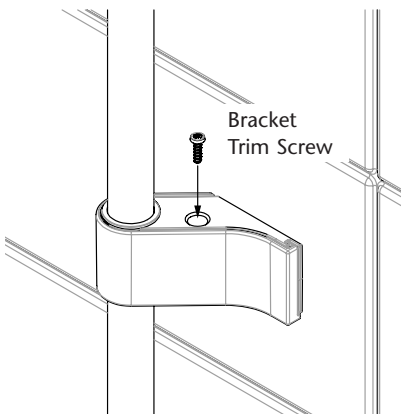

Step

7

Once satisfied with positioning of complete assembly, fit supplied Screw Caps.

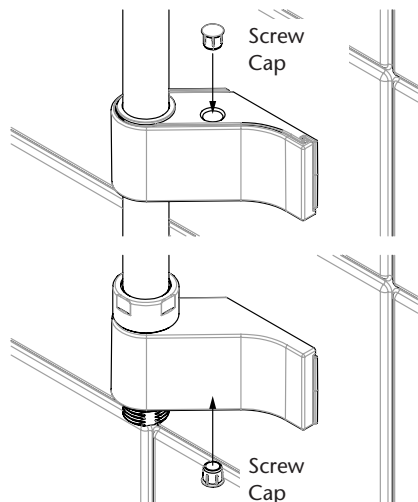

## INSTALLATION

Step  
**8**

Assemble the Shower Head on to the Upper Shower Arm.

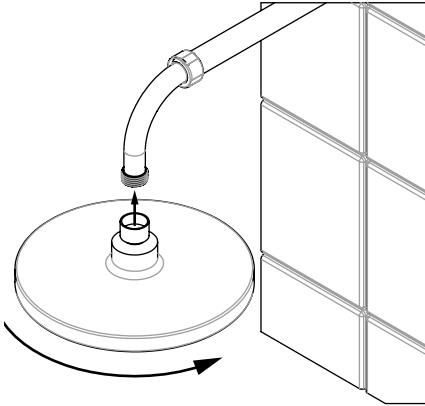

Step  
**9**

Loosen adjustment nut and set Upper Shower Arm to desired position. See Dimensions page for adjustable range. Tighten adjustment nut to lock Shower Arm in desired position.

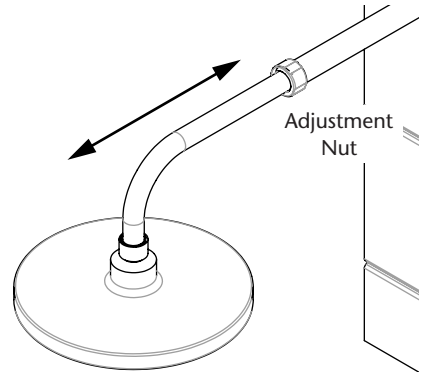

Step  
**10**

Fit rubber hose washers into cones at both ends of hose. Connect ends of hose to threaded connection on Lower Bracket assembly and threaded connection on Outlet Pipe of shower unit.

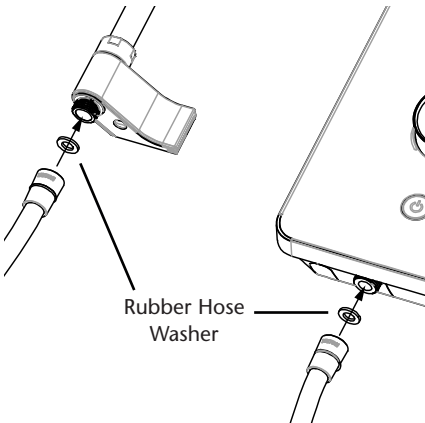

### **WARNING!**

Before using the shower, ensure that the shower has been commissioned in accordance with the shower fitting instructions.

# CLEANING

## CLEANING THE SHOWER HEAD

It is important to keep your shower head clean to maintain the performance of your shower.

Triton recommends that all products are cleaned using warm, soapy water.

**DO NOT** use abrasive or aggressive chemical cleaning products as this may affect the product surface and finish and invalidate your guarantee.

The shower head can be cleaned quickly by simply rubbing your fingers over the spray plate.

**DO NOT** use a pin or similar to poke the holes otherwise the efficiency of the shower spray will be impaired.

The hardness of the water will determine the frequency of cleaning. For example, if the shower is used every day in a very hard water area, it may be necessary to clean the shower head on a weekly basis.

## INSPECTING THE HOSES

Your shower hoses should be inspected from time to time for signs of damage or internal collapse.

Internal collapse can restrict the flow rate from the shower head and may cause damage to the shower.

Triton recommends use of a Triton branded anti-twist hose on all showers to ensure continuous safe performance.

### To inspect your hose:

1. Unscrew the hose from the bottom bracket and shower unit..
2. Inspect the hose for damage, internal kinks, etc.
3. If necessary, replace the hose.

Visit **[www.tritonshowers.co.uk/spares](http://www.tritonshowers.co.uk/spares)** to find genuine Triton spare parts.  
Alternatively please call our Customer Experience team on 024 7637 2222 to order direct. Please have your model name available.

Triton Showers  
Triton Road  
Nuneaton  
Warwickshire CV11 4NR

Triton is a division of Norcros Group (Holdings) Limited

**Customer Experience: 024 7637 2222**

**Trade Installer Hotline: 024 7637 8344**

**[www.tritonshowers.co.uk](http://www.tritonshowers.co.uk)**

**E-mail: [CXsupport@tritonshowers.co.uk](mailto:CXsupport@tritonshowers.co.uk)**

**E-mail: [technical@tritonshowers.co.uk](mailto:technical@tritonshowers.co.uk)**

**Please refer to shower installation and operating instructions for service details**

TRITON reserve the right to change product specification without prior notice. E&OE. © TRITON SHOWERS 2024