

ROUND SMARTFLOW SVACS02

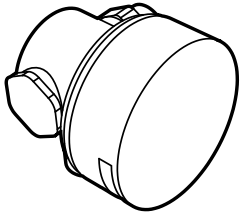

SQUARE SMARTFLOW SVACS07

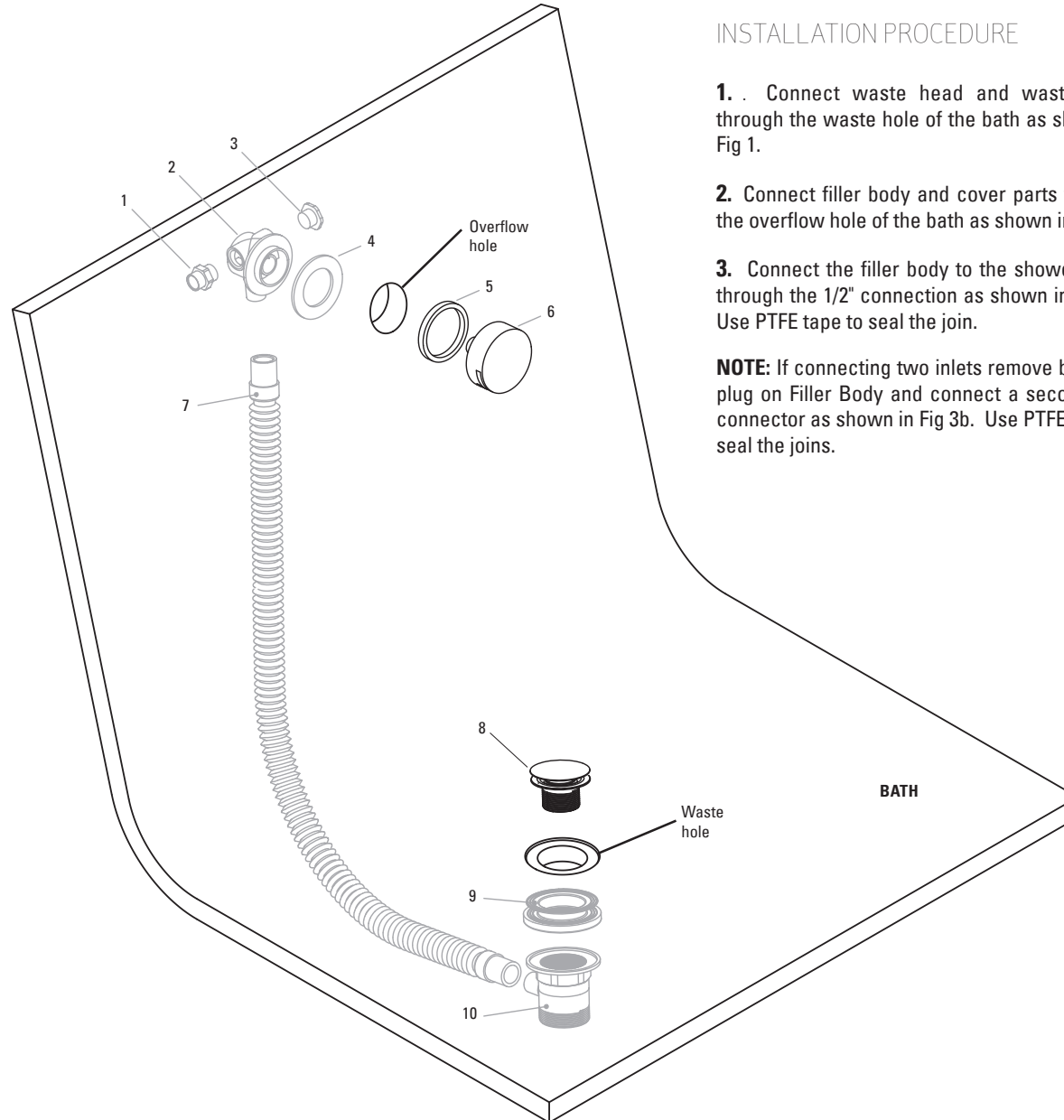
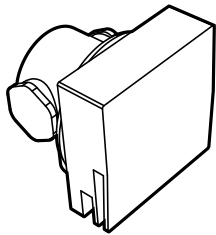

- 1 1/2" Connector
- 2 Filler body
- 3 Plug
- 4 Filler rubber washer
- 5 Spacer washer
- 6 Head
- 7 Extendable overflow
- 8 Waste head
- 9 Waste rubber washer
- 10 Waste body

INSTALLATION PROCEDURE

1. Connect waste head and waste body through the waste hole of the bath as shown in Fig 1.

2. Connect filler body and cover parts through the overflow hole of the bath as shown in Fig 2.

3. Connect the filler body to the shower valve through the 1/2" connection as shown in Fig 3a. Use PTFE tape to seal the joint.

NOTE: If connecting two inlets remove blanking plug on Filler Body and connect a second 1/2" connector as shown in Fig 3b. Use PTFE tape to seal the joints.

Fig 1

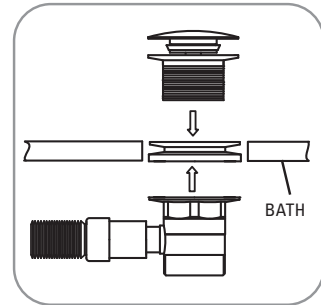

Fig 2

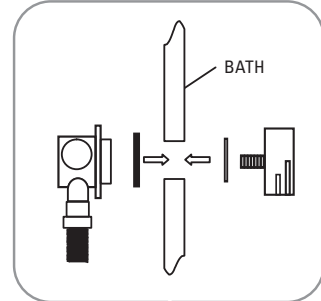

Fig 3a

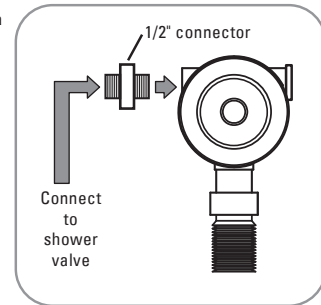

Fig 3b

