

Corner Panel

Instruction Manual

CSP



IMPORTANT INFORMATION

- Toughened glass is completely safe for use in our shower enclosures and bath screens; providing our products are installed according to our guidelines.
- It is important to note that the glass must not be mounted or 'pinched' in such a way that would cause a stress point to develop in the glass. In addition, it must not be subject to any sharp impact or severe temperature fluctuation which may also cause a stress point to develop in the glass.
- Toughened glass is physically and thermally significantly stronger than standard glass. During the toughening process the stresses contained within any glass are balanced so if in the unlikely event situation any of the above occurs and the glass breaks, the glass will shatter safely into small thumbnail sized blunt fragments.

PRE-INSTALLATION CHECKS

1. Check you have the correct product. Please look at the labels on the side of the product packaging.
2. Check all the product components are in the box and the fixing kits.
3. Unpack your product and handle it with care.
4. Please check the product for defects or damage, once the installation has commenced we cannot accept responsibility for any defects or damage.
5. Please take time to read these instructions prior to installing your product.
6. Before you commence any drilling check there are no hidden electrical cables and/or water pipes.
7. No attempt should be made to re-work the toughened safety glass.
8. The installation of the product should be performed by two persons.
9. It is strongly recommended that the walls the product is going to be installed on are vertical.
10. It is strongly recommended the product is fitted on a tiled surface or similar waterproof surface.
11. It is strongly recommended the walls are tiled and grouted before the product is installed.
12. If the walls and/or the tray are not level you will not achieve maximum adjustment of the product.
13. Pictures used are for illustration purposes only, product designs may alter slightly as a result of continuing product development.
14. We do not stipulate where the European Standard Kite Mark should be positioned on the glass when being factory assembled.
15. Please note that some natural misting may occur when you remove this product from its packaging, due to the addition of the glass protection pre-coating. If this does occur this can easily be removed with a soft, dry cloth.

Component Check List: Supplied

Description	Quantity
Glass Panel	1
Wall Profile	1
Bracing Assembly (for sizes 1000,1200 & 1400 only)	1

Equipment Check List: Not Supplied

Description
Electric / Battery Drill
6mm Masonry Drill Bit
Sealant Gun
Bathroom Sealant
Screwdriver (Pozi / Flat)
Spirit Level
Tape Measure
Pencil
Wall Fixings (if going into plasterboard etc.)

Fixing Kit Components

Description	Quantity
40mm Screws	4
Wall Plugs	4
9mm Screws	3
Screw Cover caps and bases	3
2.5mm Allen Key	1
2.5mm Drill Bit	1
Branding Badge (where applicable)	1

CONSUMER GUARANTEE

Please make sure the purchaser/end user completes and returns the guarantee card which is enclosed with this product. Failure to validate the Guarantee will mean only the 1 Year Statutory Guarantee will apply.

Step 1 - Preperation

NOTE: Checking the tray (Not applicable if fitting to a Wet Room Floor, however the Wet Room must be complete prior to installation of your panel).

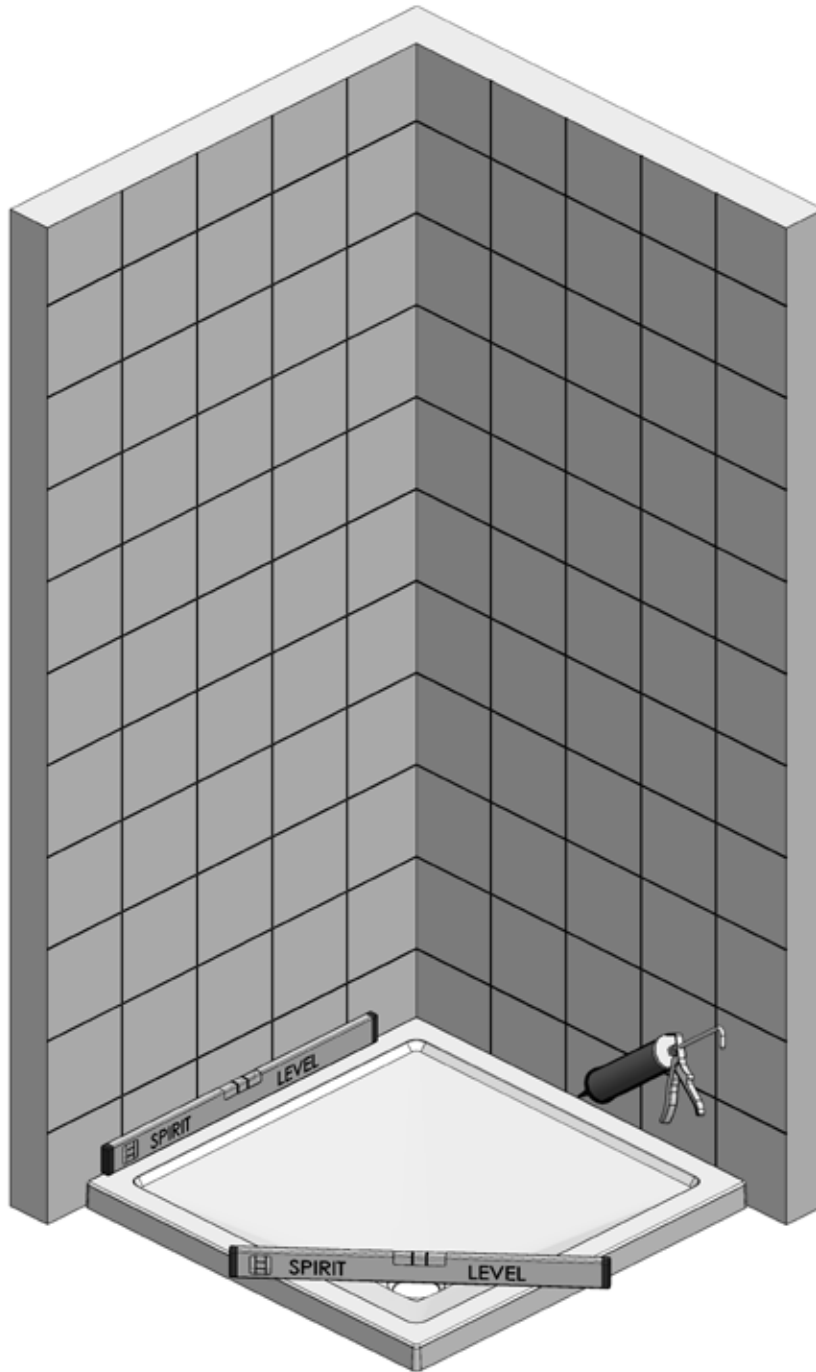

1. Ensure the Tray is completely level on all sides using a Spirit Level.
 - **The bubble should be in the centre of the 2 lines on the Spirit Level.**
2. Check that there is no movement in the Tray by standing in it.
3. Fill the tray with water to check all plumbing for leaks.
 - **Note: Please ensure that the Tray is installed as per Manufacturers' Instructions.**
4. The tray should be fully sealed along the tiled walls prior to installation with a Bathroom Sealant (not supplied).
5. The walls should be tiled and grouted prior to installing the enclosure.
 - **Do not grout the tiles after fitting the enclosure because the grout may discolour the aluminium profiles.**
6. Prior to commencing installation of the Panel and once the sealant has set, spray the shower handset around all joints to check for leaks.
 - **Allow 24 hours for the Bathroom Sealant to fully cure.**

Step 2 - Fitting the Wall Profile

NOTE: Whether you are fitting the panel on a tray or in a Wet Room situation you must take into account the Bracing adjustment (where applicable). Maximum adjustment from the wall is 1140mm.

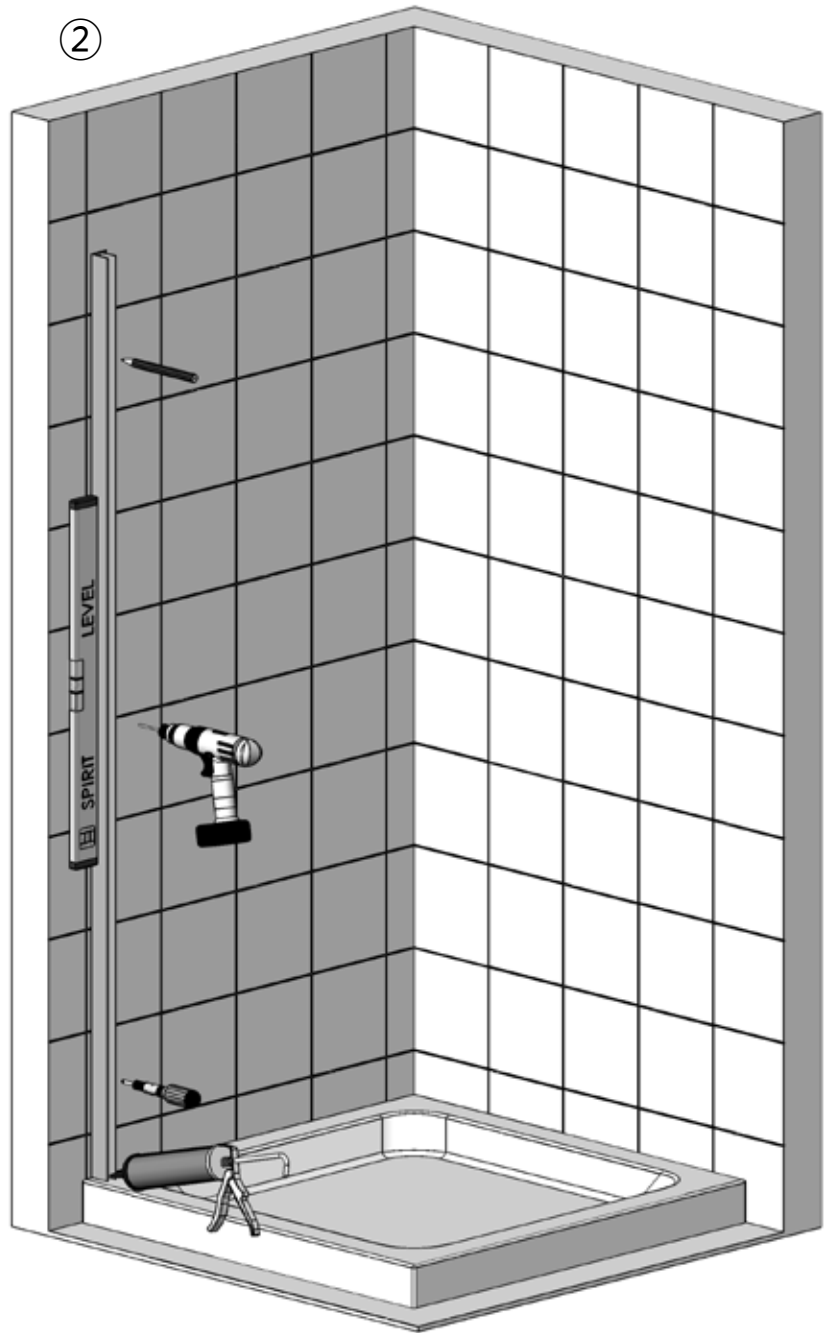
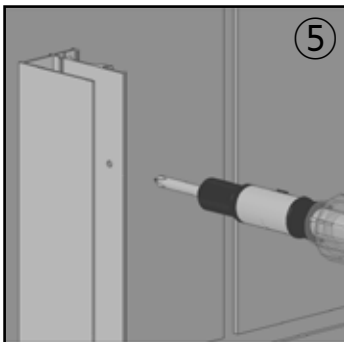
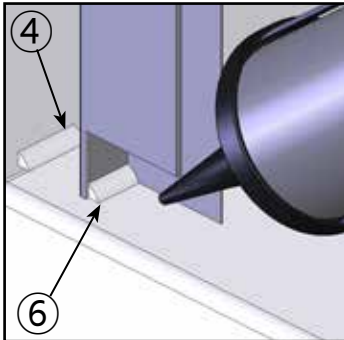
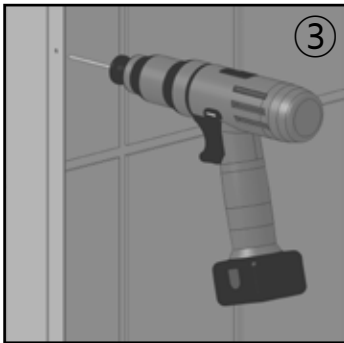
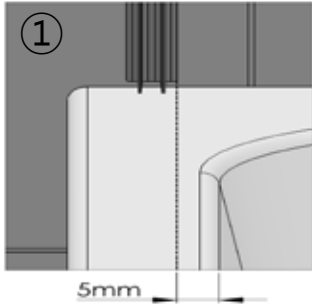

1. Position the Wall Profile approximately 5mm from the inside edge of the tray.
2. Ensure the Wall Profile is completely vertical using a Spirit Level and mark the wall through the slots.
 - **The Wall Profile must be completely vertical (make sure the bubble is in the centre of the 2 lines).**
3. Drill the holes with a 6mm Masonry Drill (not supplied) then push fit the wall plugs (supplied).
4. Remove any debris and apply sealant the width of the Wall Profile at the bottom where it meets the tiled wall and tray / floor.
5. Fix the Wall Profile using the 40mm screws (supplied).
 - **Take care not to overtighten as this will result in the Wall Profile being misshapen.**
6. Apply sealant to the inside of the Wall Profile at the bottom where it meets the tray / floor.
 - **The sealant must be applied in stages 4 and 6 as failure to carry out these procedures can result in serious water damage and is not covered by the guarantee.**

Step 3 - Fixing the Panel

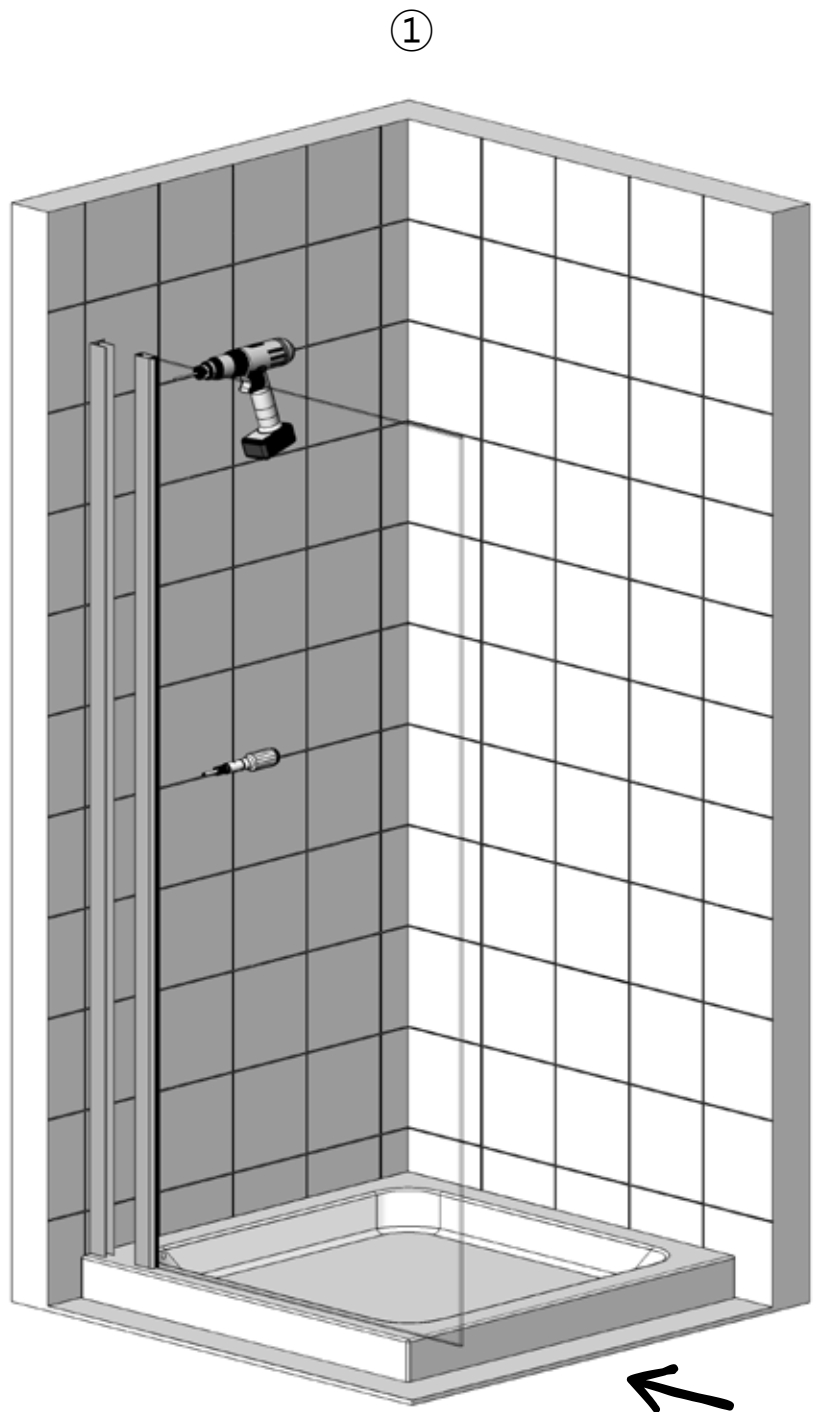
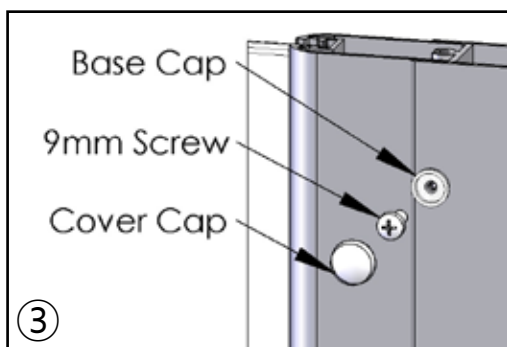
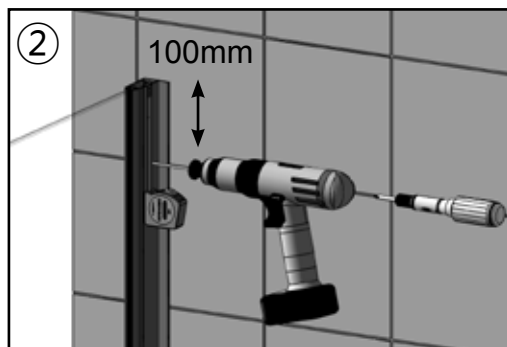
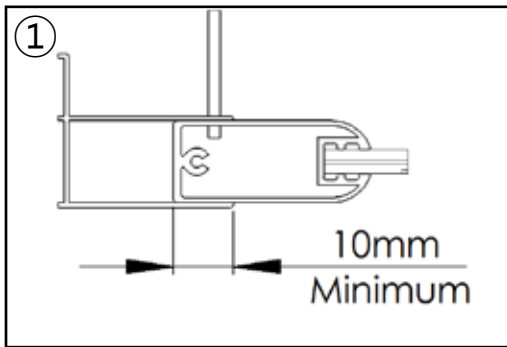

1. Offer the Panel into location onto the tray / floor and into the Wall Profile. A minimum of 10mm must be left between the Panel and Wall Profile for drilling and fixing.
 - **Make sure the Glass Panel is sitting in contact with the tray / floor along the full length of the glass.**
2. With the 2.5mm drill bit (supplied) drill a hole through the Wall Profile approximately 100mm from the top and bottom and one in the centre.
3. Fit the Cover Cap Bases to the 9mm screws and screw fix the Panel to the Wall Profile, push fit the screw Cover Caps.

NOTE: You may need help to lift the Panel into position and to hold it in place during drilling and fixing.

Step 4 - Fitting Bracing and Sealing

NOTE: The Bracing is only provided with the 1000,1200 and 1400 sizes. If you have purchased a 600,800 or 900 size then move straight to Stage 9 to complete your installation.

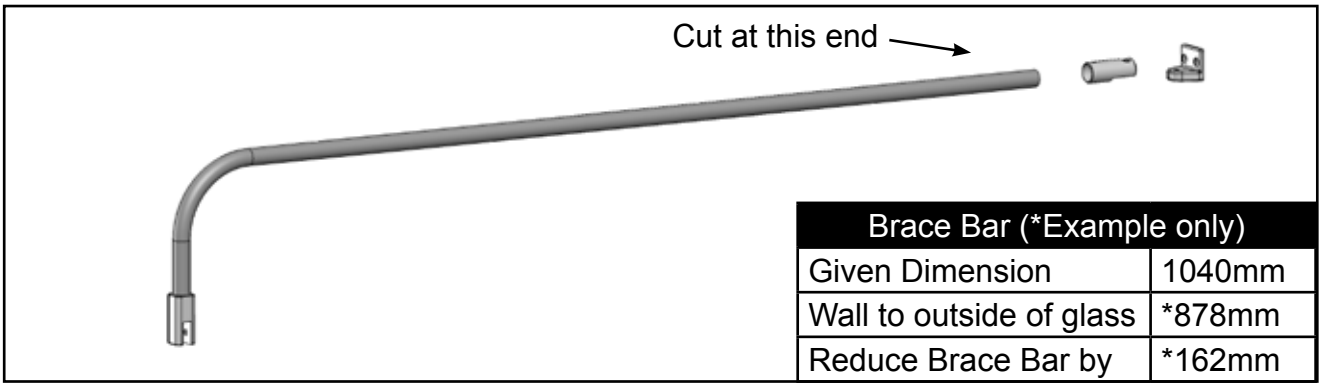
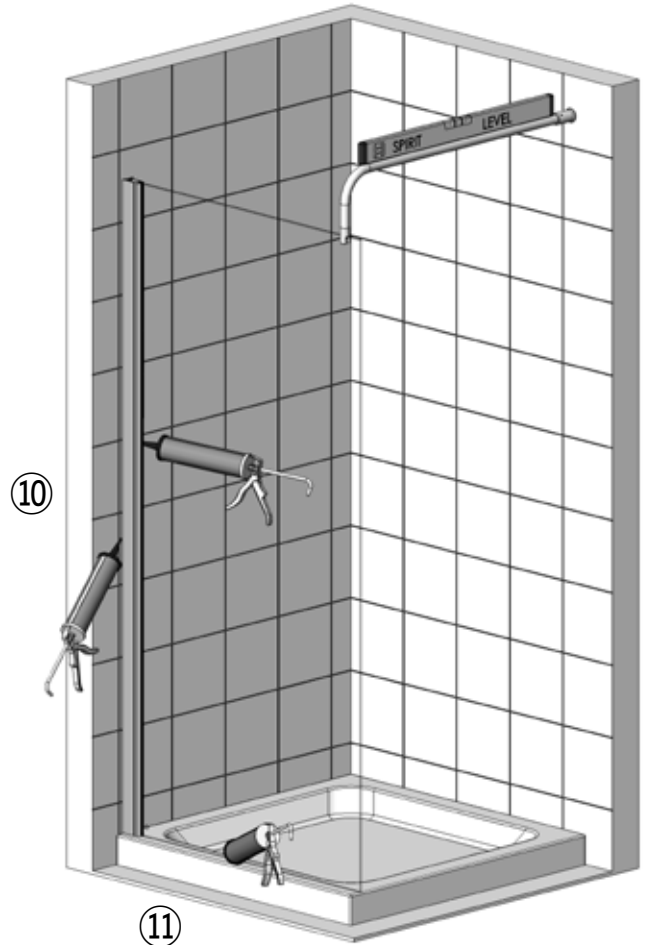
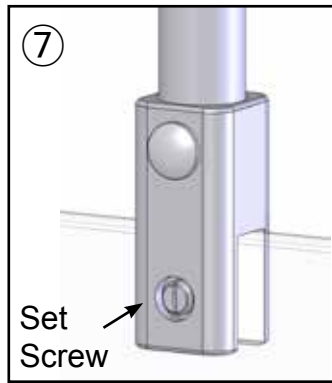
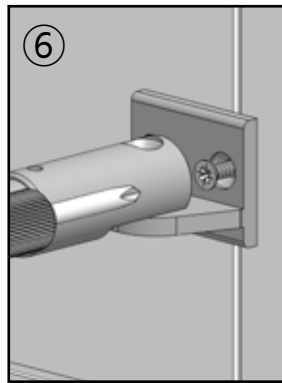
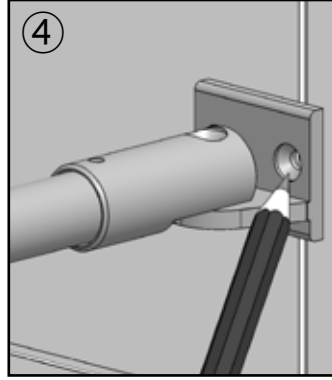
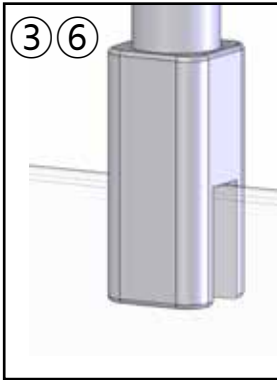

1. Measure the distance from the back wall to the outside face of the Panel Glass.
2. Deduct that measurement from 1040mm, shorten the Brace Bar by the new amount (see *Example above).
3. Place the Bracing Assembly over the glass and up to the back wall (place the bracing close to the door for the best stability). Use a Spirit level to keep it level.
4. With a pencil mark the wall through the screw holes in the Wall Bracket.
5. Remove the Bracing and drill the holes using a 6mm Masonry Drill (not supplied) and fit the Wall Plugs.
6. Replace the Bracing Assembly on to the Panel Glass and secure the Wall Bracket to the Back Wall.
7. Place the plastic spacer between the Glass and Glass Bracket at the front and tighten the Set Screw.
8. Tighten all screws.
 - There is 10mm of adjustment in the Brace Bar assembly to allow for correct adjustment.
 - The Brace Bar must be level, use a Spirit Level and ensure the bubble is in the middle of the two lines.
 - The panel must be vertically level, use a Spirit Level and adjust the bracing to achieve this.
9. Place the Branding Badge (if applicable) onto a prominent aluminium part.
10. Seal vertically inside and outside where both Wall Profiles meet the tiled wall.
11. Seal the Enclosure along the Tray top from the outside only.
 - NOTE: Leave the sealant for 24 hours to fully cure before using the shower.

Spare Parts

If you need to replace any damaged parts please see illustration below for parts list then call Customer Relations on 01325 328033

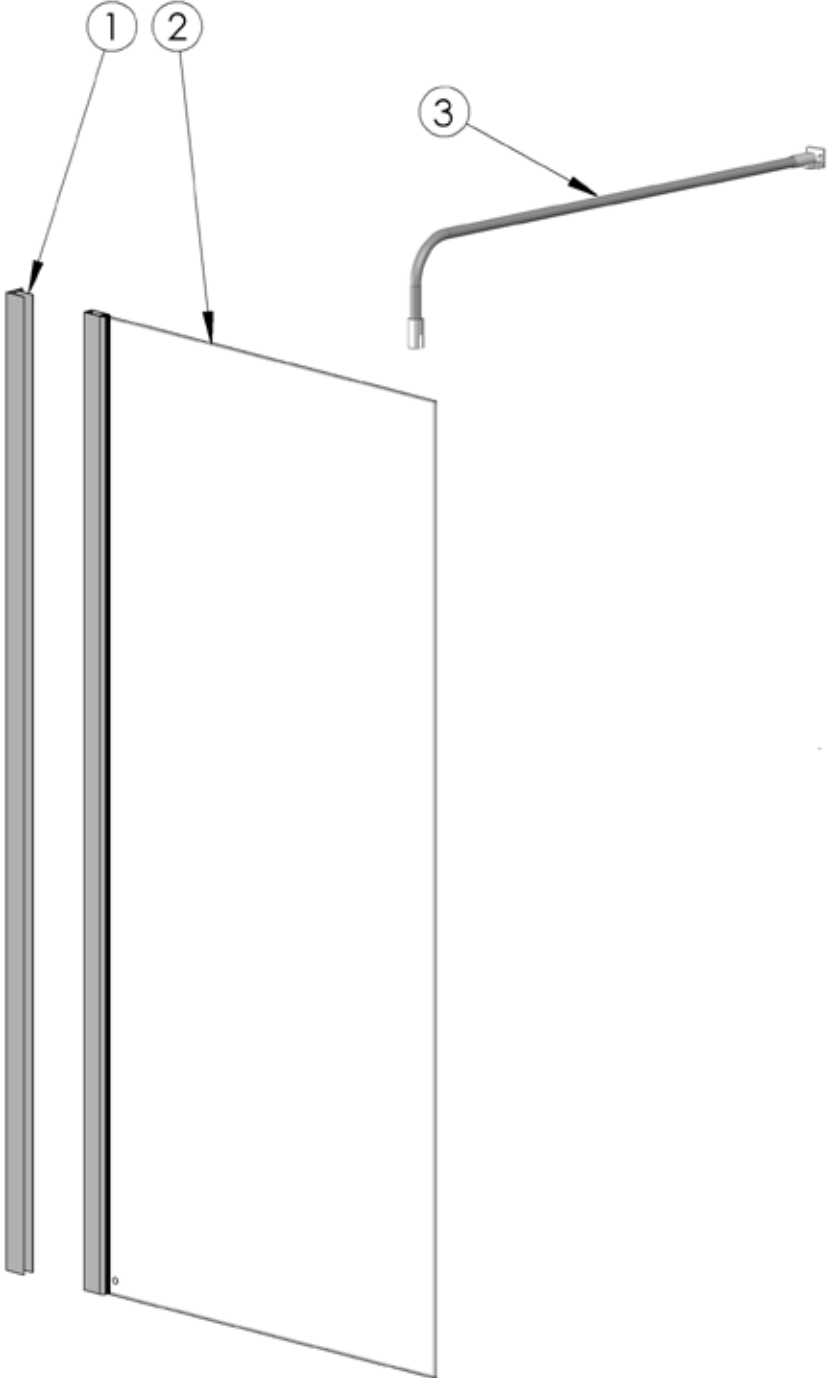

Part No.	Description	Q'ty	Part No.	Description	Q'ty	Part No.	Description	Q'ty
1	Wall Panel	1	11			21		
2	Glass Panel	1	12			22		
3	Bracing Assembly	1	13			23		
4			14			24		
5			15			25		
6			16					
7			17					
8			18					
9			19					
10			20					

TROUBLE SHOOTING GUIDE

Problem	Solution
Leaking	<ol style="list-style-type: none">1. Check that the inside gap between the Tray / Floor and Wall profiles has been sealed correctly.2. Ensure the tray is sealed along the tiled walls prior to installation.3. If the inside joint between the enclosure and the tray top / floor is sealed, this will cause leakage - sealant must be removed.4. Ensure the wall profiles on the tiled walls are sealed both vertically inside and outside.5. Ensure the joint between the enclosure and tray top / floor is sealed. <p>Important: This enclosure should be water tested conforming to BS EN 14428</p>
Enclosure Alignment on the Tray / Floor	<ol style="list-style-type: none">1. Check the tray has been installed as per manufacturers' instructions2. Check the Wall profile is completely vertical

Some important information to help you Maintain your product.

The following information is all you need to keep your product looking new.

Clean your product using a mild detergent diluted in water and then polished off using a soft cloth. If you live in a hard water area, periodically clean your product using a 50/50 solution of white vinegar and water. The solution should be left on the enclosure for approximately 5 minutes then rinsed off using warm water. This method of cleaning should remove lime scale residue.

Simple Maintenance

Our products are generally maintenance free, however it may be necessary to lubricate wheel assemblies and other moving parts from time to time.

It is strongly recommended that a quality silicone spray is used.

A list of Don't's:

1. Don't use acidic based products which are unsuitable for cleaning enamel surfaces.
2. Don't use abrasive cleaners or cleaners using bleach or solvents, these products will adversely affect the finish of the aluminium profiles.
3. Don't use scouring pads, powder or any sharp instruments when cleaning the enclosure.

Should you experience any problems during installation please refer to the Trouble Shooting Guide or contact Customer Relations on:

+44 (0) 1325 328033

To enable customer relations to provide you with an excellent level of service it is important that you quote your product Code and Reference Number - these can be found on the Guarantee card.