

AOSTA - 530

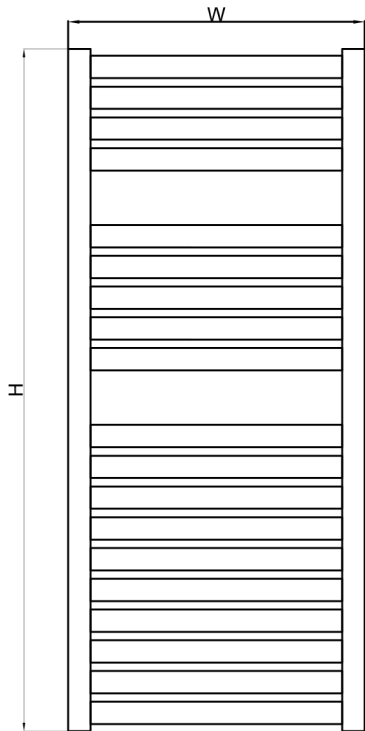

Front View

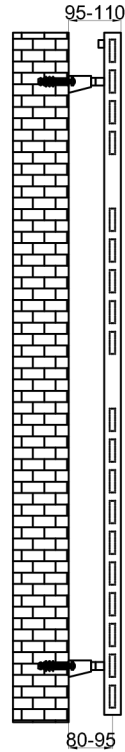

Side View

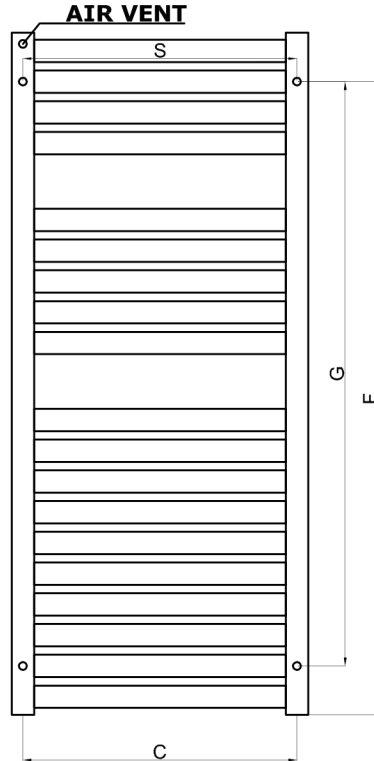

Back View

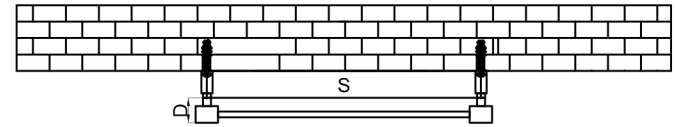

Top View

SUPPLIED INSTALLATION ACCESSORIES



SCREW 4 PCS



WALL PLUG 4 PCS



INSERT 4 PCS



GRAB SCREW 4 PCS



BRACKET 4 PCS



ALIEN KEY 1 PCS

MATERIAL DETAILS

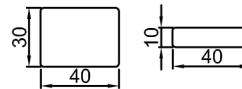

-Vertical Mounting
-Optional 304 QUALITY STAINLESS STEEL TOWEL RADIATOR: (RNS-AOS5122 : AOSTA RADIATOR)
-BRUSHED
-Max Operational Pressure: 10 Bar
-Inlet/Outlet: 1/2" Female Pipe Thread
-All Dimensions are in mm

Product Name	Product Code	Height	Width	Thickness	Plumbing Axes Center to Center	Hanger Axes Horizontal	Hanger to Bottom of the Product	Hanger Axes Vertical	Water Volume	Empty Weight	Thermal Output
		H	W	D	C	S	F	G	-	-	Watt - BTU/hr (Δ50°)
		mm	mm	mm	mm	mm	mm	mm	L	kg	
AOSTA 835 X 530	RNS-AOS5083	835	530	45	490	490	748	660	8.72	8.30	699 - 2382
AOSTA 1220 X 530	RNS-AOS5122	1220	530	45	490	490	1133	1045	13.61	12.81	1106 - 3771

