

# INTENSE DUAL LEVER TAP BRUSHED

TID1BF/



A bold, streamlined design. The Intense kitchen tap creates the ultimate statement piece in any contemporary kitchen. With the choice of five finishes; Intense is available in chrome, brushed, brushed copper, graphite and matt black.

- Suitable for medium pressure water systems emitting a minimum pressure of 0.5 bar or above
- Featuring an anti-splash spout with honeycomb aerator design which mixes air with water to emit a water flow with no splash

# RANGEMASTER

## SINKS & TAPS

Overall Height (mm)	398
Spout Reach (mm)	216
Spout Height (mm)	273
Spout Rotation Range	360°
Handle Type	Dual Lever
Colour	Brushed
Bar Pressure Suitability	Medium Pressure
Min. Bar Pressure	0.50
Max. Bar Pressure	5.50
Mixed Flow Rate at 3 Bar Pressure (l/min)	14.01
Flow Type	Single Flow
Recommended Hot Water Temperature	46°C
Maximum Hot Water Temperature	70°C
Handle Control	Quarter Turn
Centre Distance (mm)	-
Cartridge Type	Ceramic Disc Cartridge
Aerator Type	Honeycomb Aerator
Inlet Pipes	1/2" Stainless Flexible Hoses
Anti-Splash Spout	Yes
Pull Out Spray	No
WRAS Approved	No
Product Code	TID1BF/
Barcode	5015834050102

Date of download: March 20, 2025

AGA Rangemaster continuously seeks improvements in specification, design and production of products and thus, alterations take place periodically. Whilst every effort is made to produce up to date resources, the information included here is intended as a guide. Always refer to the installation instructions when fitting, installation work should be completed by a professional tradesman.

## INTENSE DUAL LEVER TAP BRUSHED

TID1BF/

# RANGEMASTER

SINKS & TAPS

### Technical Drawing

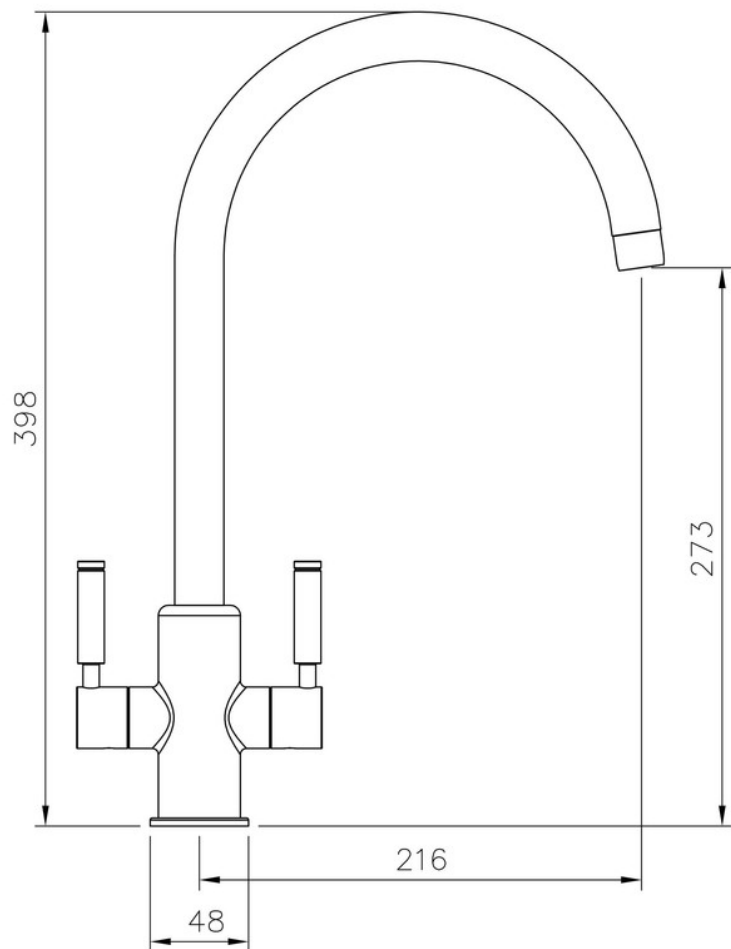

Date of download: March 20, 2025

AGA Rangemaster continuously seeks improvements in specification, design and production of products and thus, alterations take place periodically. Whilst every effort is made to produce up to date resources, the information included here is intended as a guide. Always refer to the installation instructions when fitting, installation work should be completed by a professional tradesman.