

Osaka Wooden Towel Shelf

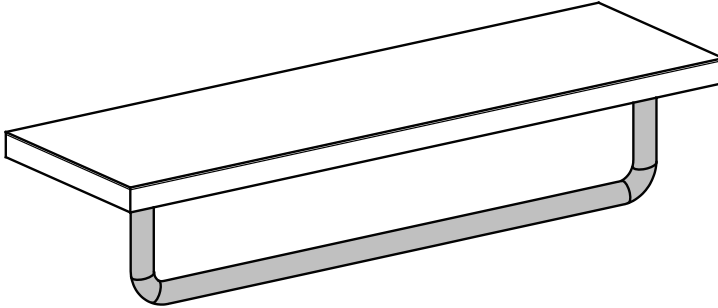

Fitting Instructions

Please follow them carefully and
leave this manual with end user

Items Included:

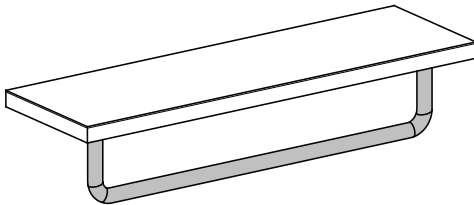

Towel Shelf (x1)

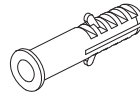

Rawl plugs
(x4)



Wall screws
(x4)

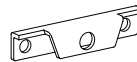

Fixing Brackets
(x2)

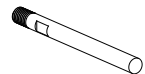

Fixing Rods
(x2)

Tools Required (Not Included):

Ensure the appropriate PPE is used during installation



Screw
driver



Drill

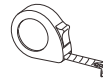

Tape
Measure



Spirit Level

Recycling and Disposal:

Please recycle the packaging in accordance with your local government regulations on waste handling and follow the same advice at the end of the products life.

Cleaning & Aftercare:

Warning: Do not use abrasives, scourers bleach or any type of chemical cleaning solution when cleaning the towel shelf. It is recommended to use warm soapy water and a clean damp cloth.

Before you begin:

1. Check the chosen wall space for any pipes/cables prior to drilling
2. Unpack the product then read these instructions before proceeding. Inspect the product for damage. If any damage is found, contact our Customer Relations team.
3. Make sure that all components are present prior to installation.

Installation:

Step 1:

- Place the towel shelf at the desired height, then make a mark across the top of the shelf to the wall.
- At the back of the towel shelf, measure the distance between the two fixing points. Apply the measurements to the wall below the original marking. Ensure all the markings are level using a spirit level.

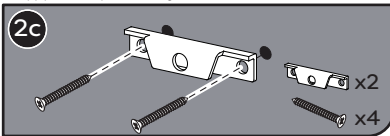
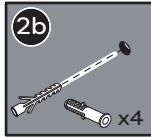
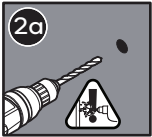
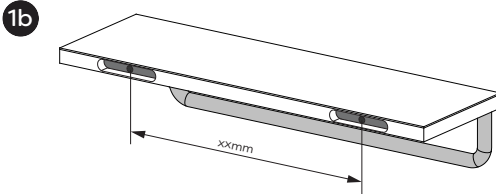
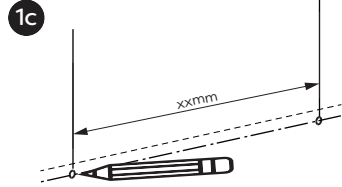
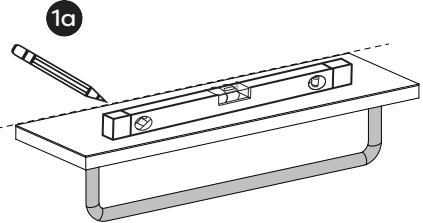

Step 2:

- Using an appropriate sized drill bit, carefully drill the holes in the wall then insert the 'Rawl Plugs'.
- Place the fixing brackets over the drilled holes then using the 'Screws' provided, secure the unit to the wall by screwing into the 'Rawl Plugs'.

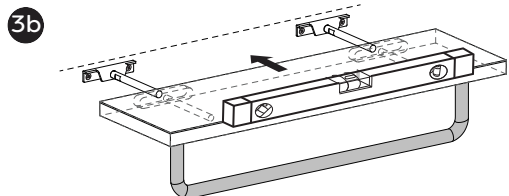
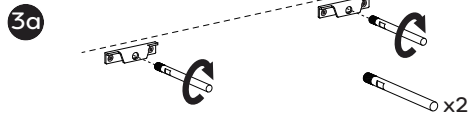

Step 3:

- Screw the fixing rods into the centre holes on the fixing brackets. Ensure the rods are fully secured into the brackets.
- Carefully insert the towel shelf onto the fixing rods. Ensure that the towel shelf is fully inserted into place.
- Ensure the hanger bracket is level using a spirit level.

Diagrams are for illustration purposes only. Your towel stacker may superficially differ from this drawing however the installation guide steps still apply.