

Osaka Wall Hook Hanger Bracket

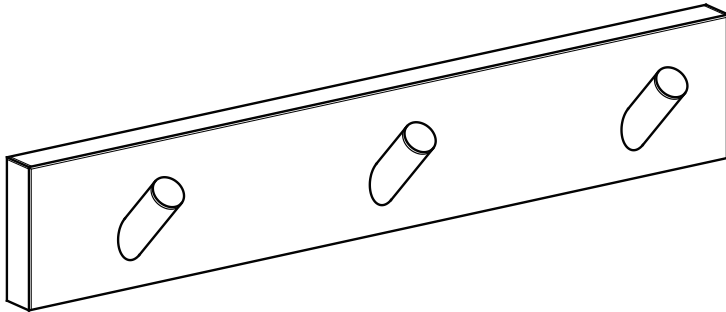

Fitting Instructions

Please follow them carefully and leave this manual with end user

Items Included:

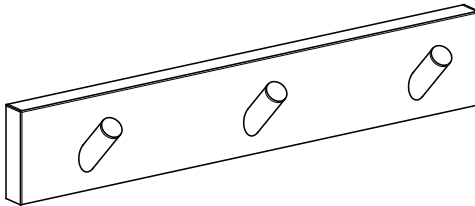

Hook Hanger bracket (x1)

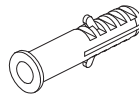

Rawl plugs
(x2)



Wall screws
(x2)

Tools Required (Not Included):

Ensure the appropriate PPE is used during installation



Screw
driver



Drill

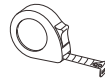

Tape
Measure



Spirit Level

Recycling and Disposal:

Please recycle the packaging in accordance with your local government regulations on waste handling and follow the same advice at the end of the products life.

Cleaning & Aftercare:

Warning: Do not use abrasives, scourers bleach or any type of chemical cleaning solution when cleaning the hook hanger. It is recommended to use warm soapy water and a clean damp cloth.

Before you begin:

1. Check the chosen wall space for any pipes/cables prior to drilling
2. Unpack the product then read these instructions before proceeding. Inspect the product for damage. If any damage is found, contact our Customer Relations team.
3. Make sure that all components are present prior to installation.

Installation:

Step 1:

- Place the hanger bracket at the desired height, then make a mark across the top the bracket to the wall.
- At the back of the hanger bracket, measure the distance between the two fixing points. Apply the measurements to the wall below the original marking. Ensure all the markings are level using a spirit level.

1b

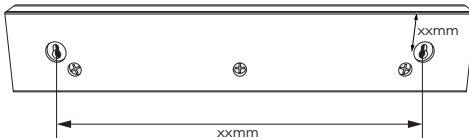

1a

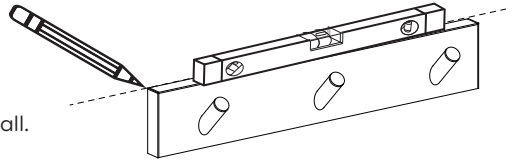

1c

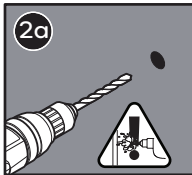
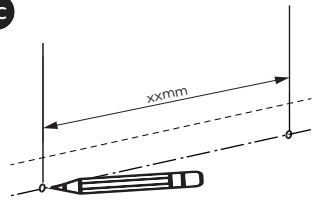

Warning:
Check the chosen wall space for
any pipes/cables prior to drilling!

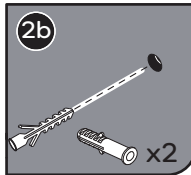

Step 2:

- Using an appropriate sized drill bit, carefully drill the holes in the wall then insert the rawl plugs.

Step 3:

- Using the screws provided, screw into the rawl plugs leaving at least a 5mm protrusion of the screw head.
- Carefully insert the hanger bracket onto the screw heads. Ensure that the bracket is fully slotted into place.
- Ensure the hanger bracket is level using a spirit level.

3a

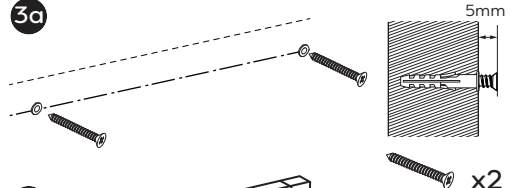

3b

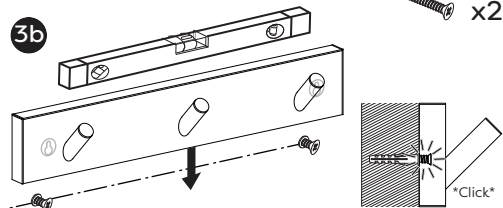

Diagrams are for illustration purposes only. Your towel stacker may superficially differ from this drawing however the installation guide steps still apply.