

TMV Douche Kit

Kit Includes:

In-line Thermostatic Mixing Valve, Wall Bracket With Built In Angle Valve, 1.25m Double Interlock Hose, Spray head



Installation Instructions:

The Thermostatic mixing valve can be positioned discreetly for easy access. Once the temperature has been set then it is rarely necessary for any further adjustment. The factory set temperature is 38°C.

The mixed outlet pipe from the Thermostatic mixing valve to the angle valve should be firmly fixed for rigidity when in use. Wall bracket with built in angle valve can be mounted on a panel and secured with a back-nut or fitting depending on panel depth. It is recommended that the panel is not relied upon for rigidity.

Guarantee & Aftercare:

During installation extra care must be taken to avoid damaging the fittings. We provide a 3 year guarantee against faulty materials (excluding serviceable parts), providing they have been installed, cared for and used in accordance with our instructions. Clean with soft damp cloth and non corrosive detergent only.

Note: Ensure Angle valve is turned to off position after use.

Part List and Installation

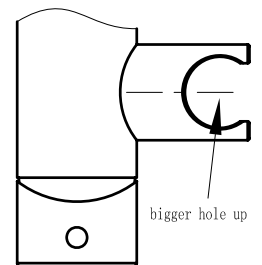
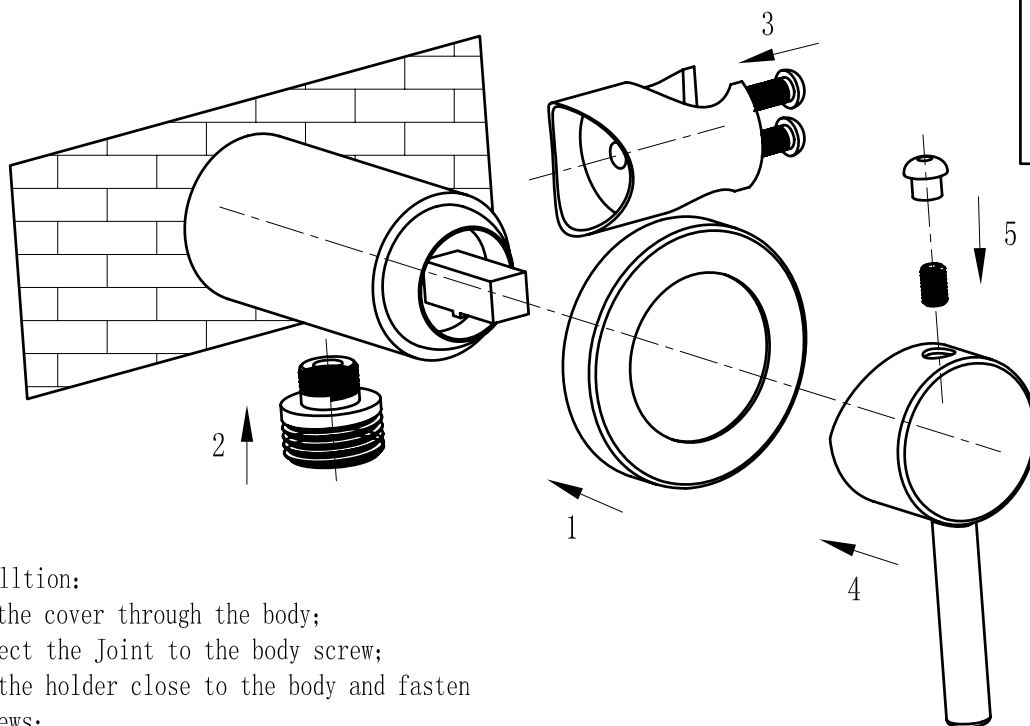

Installation:

- 1、Put the cover through the body;
- 2、Connect the Joint to the body screw;
- 3、Put the holder close to the body and fasten two screws;
- 4、Put the handle on the cartridge;
- 5、Fix the hexagon screw with socket wrench then put the blue and red plug in.

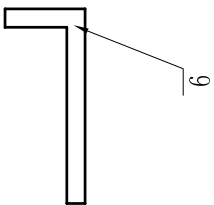
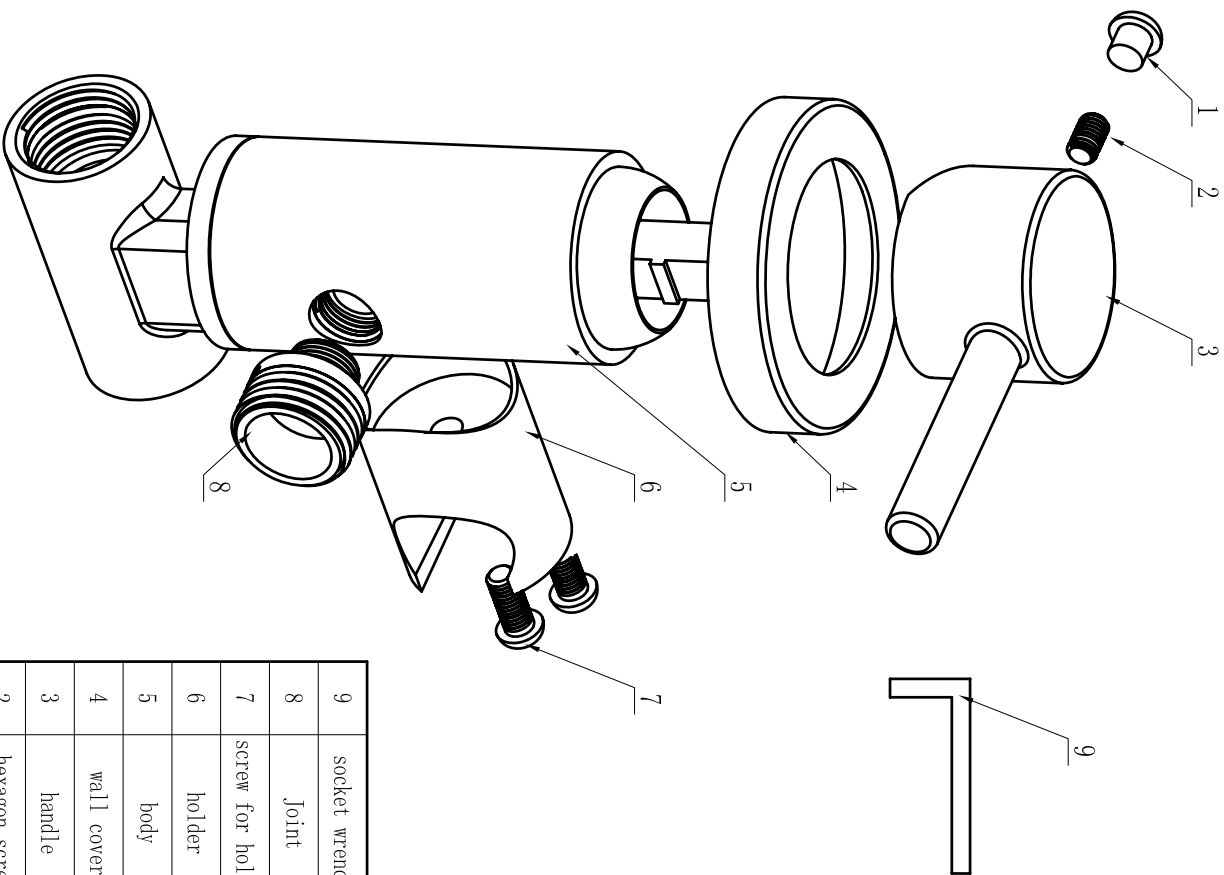

9	socket wrench	1
8	Joint	1
7	screw for holder	2
6	holder	1
5	body	1
4	wall cover	1
3	handle	1
2	hexagon screw	1
1	Blue and red plug	1
Item No	Name	QTY

standard Part List

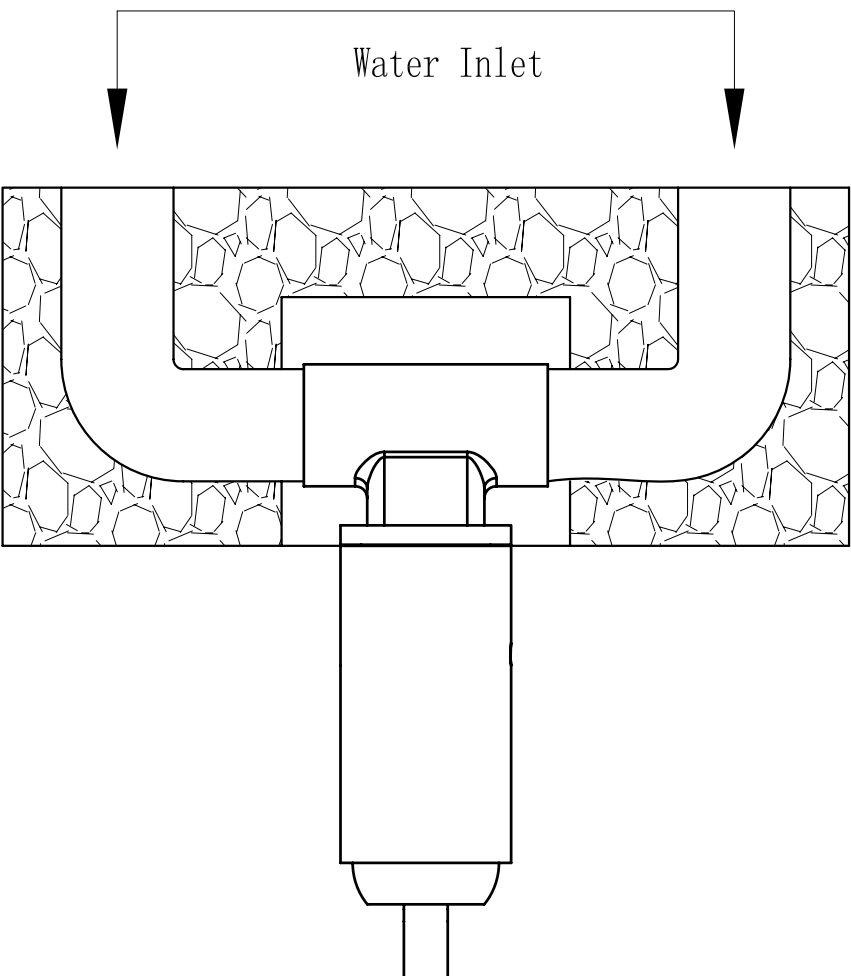

Installation 1