

REEF

1000mm pvc waterproof panelling

installation instructions
please read this leaflet thoroughly before installation

a. square edge fixing recommended for shower panels

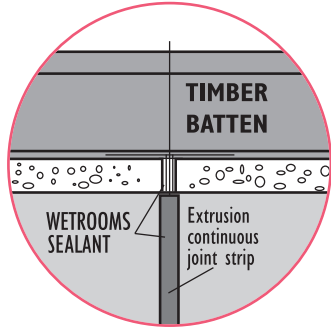

First trim off the tongues on the sides of each panel. Panels are easily cut on-site. The edges being covered by Reef panel extrusions. This will facilitate for faster installation. Panels can be joined together in continuous runs with decorative H joint extrusions.

Panel size:
width 1000mm tongue & groove height 2440mm. depth 10.5mm

b. tongue & grooved recommended for continuous panel runs

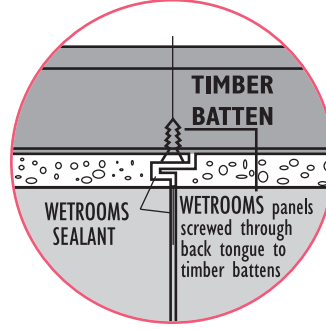

Vertical edges tongued and grooved giving finished panelling a smooth, easily maintained surface. Each panel has a symmetrical tongued and grooved vertical edges to give 5mm of joint overlap. When sealed with Reef sealant a waterproof joint is assured.

Panel size:
width 1000mm tongue and groove height 2400mm x depth 10.5mm

aluminium & pvc profiles

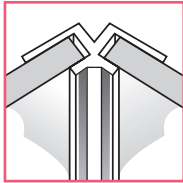

Internal corner
2400mm
Used on all internal 90° corners sealing with Reef sealant.



External corner
2400
Used on external 90° corners sealing with Reef sealant.

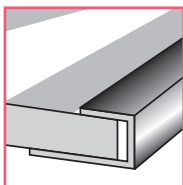

U trim
2400mm
Finishing touches end cap for square cut edge panel, sealing with Reef sealant.

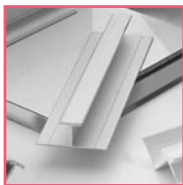

Joining and stacking profile
2400mm
Used to mount panels side by side, or above each other, sealing with Reef sealant.

extrusions:
the sides of the panels should be trimmed to form a tight fit

aluminium profiles

Bright Silver
Satin Silver
Gloss White
Antique Gold
Anthracite

p.v.c profiles

White
Bright Silver

adhesives sealants and cleaners

Benefits of using Reef sealant

Reef Sealant is of the highest quality silicone. It is a fast curing, low modulus, neutral, fungicidal silicone sealant, developed for use with Reef waterproof panelling, and for general sanitary use.



- Reef Sealant forms a strong secure bond even between two non-porous surfaces.
- Reef Sealant has a high degree of elasticity, which ensures that the bond remains firm during the natural expansion and contraction of the panelling.
- Reef Sealant is designed for high pressure and pumped shower systems.

It is recommended that Reef own brand of adhesive sealant and cleaner are used. For a 1000mm wide panel, approximately 1 cartridge of Reef adhesive and 1 cartridge of Reef sealant is required. The hardwearing surface of the panelling can be hygienically cleaned with Reef Spray Cleaner which is a mild non-abrasive cleaner with an anti-bacterial agent. Abrasive cleaners and bleaches must NOT be used on Reef panelling.

fixing wetrooms panelling in wet areas

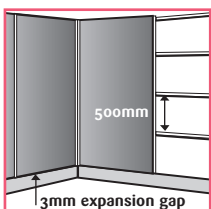

Timber battens:
(45mm x 21mm)
Battens are recommended to be fitted at a maximum distance of 500mm apart.

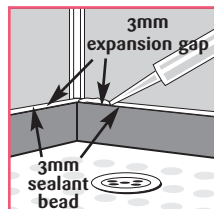

Panel fitting:
Fit panels 3mm above bath, shower tray or floor. Seal expansion gap with Reef sealant.

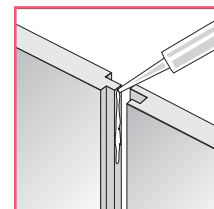

Panel and decor strip sealing:
Seal all square edge tongue and groove joints with Reef sealant. Always seal inside each profile prior to inserting panel.

fixing of panels to battens

The panels should be fixed direct to battens using Reef adhesive. It is recommended that the panels be fixed to battens to provide an air space behind the panels. Treated timber battens approximately 45mm x 21mm should be fixed horizontally with one at the head and base of the panels with additional horizontal battens at a recommended distance of 500mm apart. They should be plumb and parallel to each other to give a solid ground for fixing the panels with Reef adhesive. Wash hand basins, towel rails and other heavy items should have additional battens behind them to give a secure fixing.

panel preparation

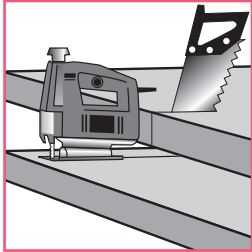

Cutting panels: Using a handsaw cut panel with pattern face upwards. When using an electric saw cut panel with decorative face downwards.

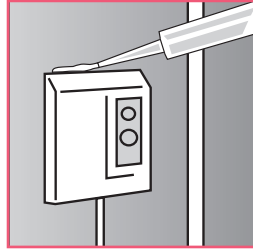

Pipes and accessories: Leave a 3-4mm clearance around all pipes and accessories and seal with a bead of Reef sealant. If a collar is to be fitted first seal with Reef sealant.

To check - before and during installation for visible defects. As is general practice installed panels and extrusions are assumed to be accepted.

tongue and groove panel installation

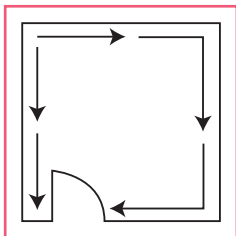

Where to start: Start at the corner furthest from the door, panel in both directions around the room. The last panel is fitted above the doorway, placed in position tongue first and swung into position. All panels must be correctly aligned and plumb, allowing for 3mm expansion gaps. Fix panels to battens using Reef panel adhesive. Seal all panel joints using Reef sealant.

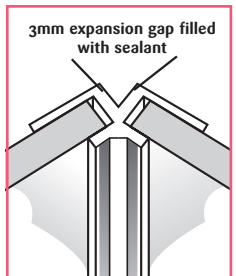

Begin panelling: First fix a Reef internal corner profile in position ensuring that it is plumb. Apply Reef sealant to the recess of the profile. Apply Reef adhesive to the battens. Insert the first panel after removing the smaller tongue, or cutting to size. Then continue to panel away from the corner in both directions, fixing panels to battens with Reef adhesive, and sealing joints with Reef sealant. Allow for 3-4mm expansion gaps, filled with Reef sealant.

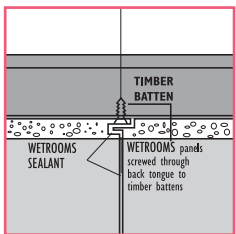

Continue panelling: Continue panelling around the room fixing each panel to the battens with Reef adhesive, and/or screws through the back lip of grooved edge. Seal tongue and groove joints using Reef sealant. Use internal and external corner profiles, sealing with Reef sealant, where appropriate.

square edge shower panel installation

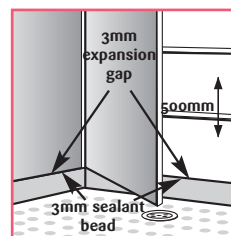

Two panel shower enclosure:

First cut off the tongue on each panel edge. The shower tray must be fitted hard against or cut into the wall. Cut the panels and profiles to size. First fix a Reef internal profile in position against the battens ensuring that it is plumb.

Apply a generous bead of Reef sealant into profile and insert panels. Fix panels

to battens using Reef panel adhesive. Allow for 3-4mm expansion gaps, filled with Reef sealant.

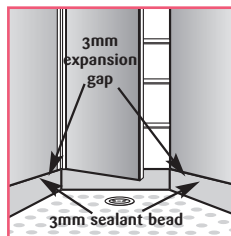

Three panel shower enclosure:

Two internal profiles are required. First panel is fitted as for the two panel shower enclosure. Put an internal corner profile onto the edge of second panel, and apply Reef adhesive to the battens. Insert other edge into profile already attached to the wall, and swing second panel into place forming back of enclosure. Fix profile to

wall, insert third panel and glue to wall. Ensure a generous bead of Reef sealant is applied into all the profiles. Allow for 3-4mm expansion gaps, filled with Reef sealant.

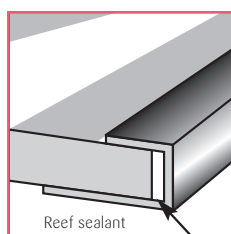

Finishing touches U-trim:

Finish outer panel edges with U-Trim, applying a generous bead of Reef sealant into the U-Trim. Seal all gaps around the tray with Reef sealant prior to installing the shower door or side panel.

Note: Do not fit and sit panels directly on top of bath or shower tray - allow 3-4mm expansion gaps.

square edge panelling for continuous wall installations

Install in a similar manner to tongue and groove panelling, using the "H" continuous run decorative "joining and stacking" profile to join panels, applying a generous bead of wetrooms sealant into the profile.

For further information please contact:

Mere Marketing, Lyncastle Road, Appleton Thorn, Warrington WA4 4SN Tel: 01925 214 200 Fax: 01925 214 204 Email: sales@merebathrooms.co.uk