

Installation and operation instruction



1. Before install our shower, please make sure that you have assembled cold and hot outlet in the wall, which is two female G1/2 connectors. (pay attention the center distance between two female G1/2 is 1500mm, such as Figure II) .
2. Decorate the wall tile surface.
3. Wrap the PTFE tape around the G1/2 connector(1), then screw on the female G1/2 in the wall. So is another connector. (pay attention the center distance and horizontal position) .
4. Set two Decorative cover(2) separately on male G3/4 connectors (1) .
5. Assemble Valve Body(5) on male G3/4(1), adjust direction and horizontal position, then screw with Hexnut(4). Before screw, make sure Rubber washer(3) inside Hexnut (4). There are hot and cold valve bodies, assemble as you want. Assemble another side as above.
6. First Hexnut (7), then plastic sleeve (6) pass through U pipe(8). Use tank to screw Hexnut (7), make sure U pipe(8) fix on Valve Body(5).
7. Shower pipe(9) pass through Ball bracket(14), then insert Hole b on U pipe(8). then put Flange(12) on the wall to mark fixing holes.
8. Remove Shower pipe(9), use Electric drill punch on mark hole, and put 2pcs Plastic expansion screw(10) in the two holes. Take Shower pipe(9) insert back Hole b, screw Self-tapping screw(11) in Plastic expansion screw(10). Before screw, adjust position. Fix shower pipe(9) by Screws(13). Last, use tank to screw tighten Hexnut (7), in order to fix Shower pipe(9) on U pipe(8).

Victorian Plumbing

Diamond House.41,Stephenson Way.Formby Business Park Formby.England.L37 8EG

Tel:0044 800 862 0878

Website:www.victorianplumbing.co.uk

Figure I

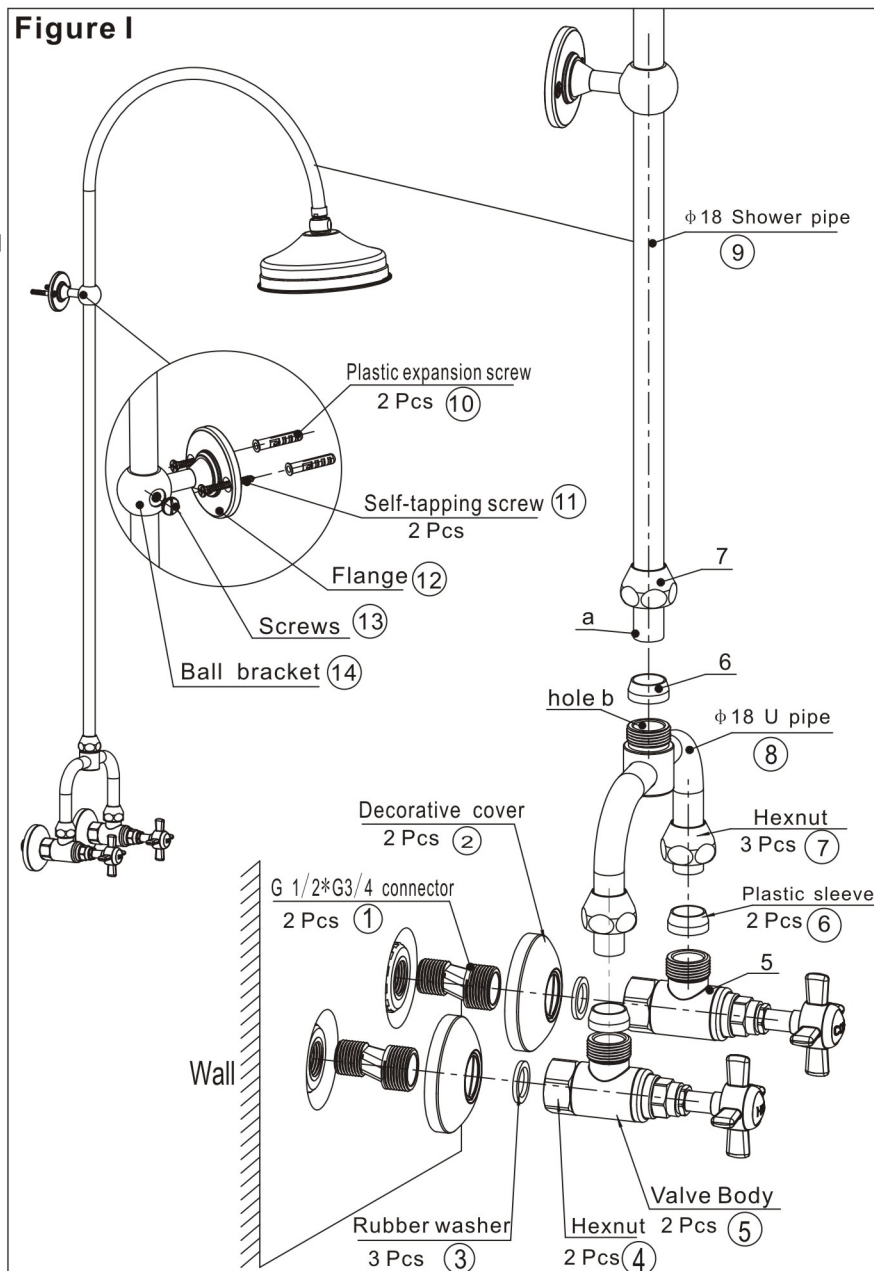

Figure II

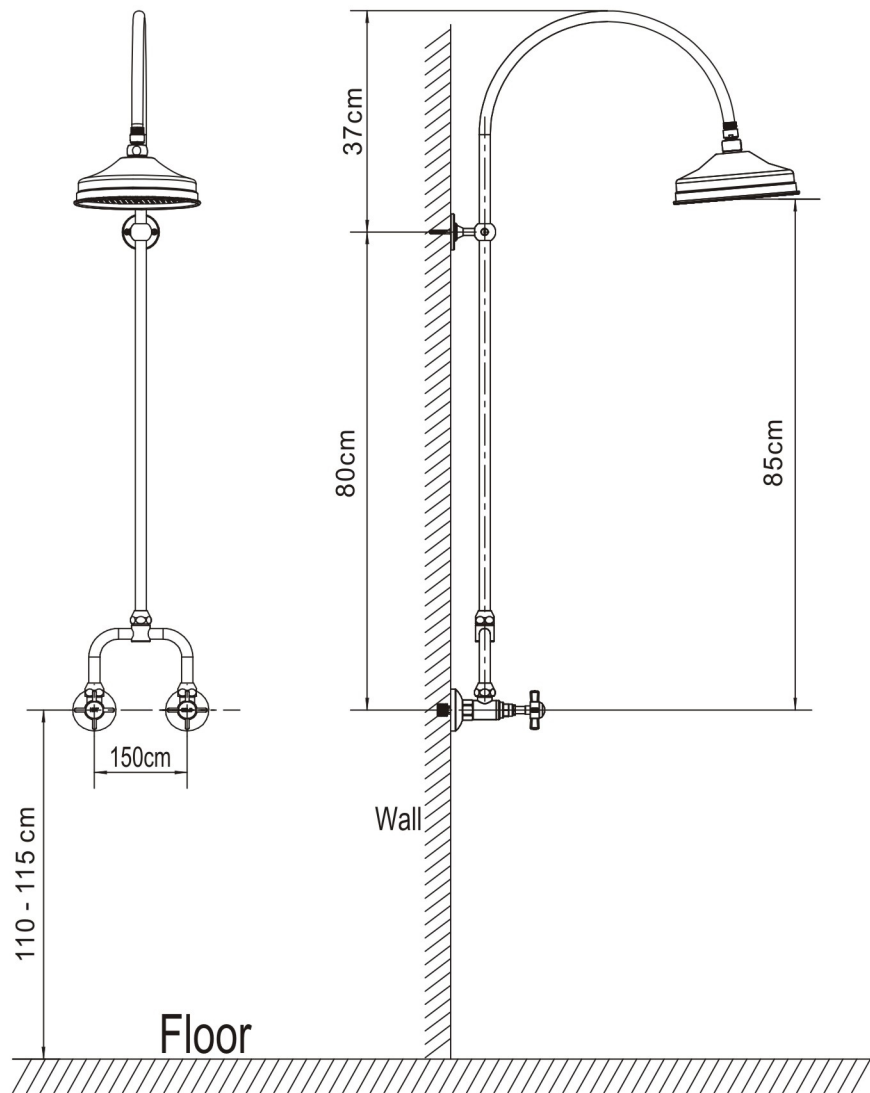

Figure III

9, Rubber washer (15), Hexnut (16), Connector (17), Plastic sleeve (18) were assembled in the factory, called part d. Silicone washer (19) and Top shower (20) also assembled in the factory, called e. Set part d on part e, then fix on part c male G1/2.

10, Connect the inlet and outlet 6. Check all joints & connections for leaks.

