

Installation Instructions

Engaging 3L TripleLock and Click4U using a soft-faced hammer

1

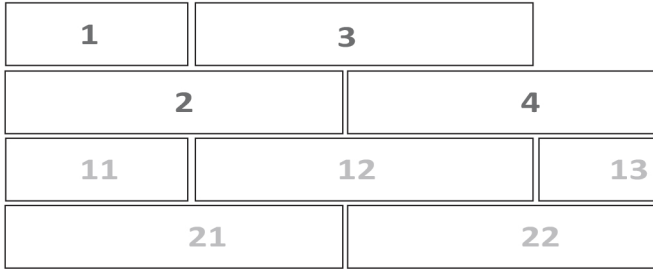

ESTABLISH STAGGER AND ALIGN TOOLS

Products should be staggered in bricklaid pattern, stagger equal to 1/2 of a plank. Tools needed: planks, underlayment, spacers, soft-faced hammer.

2



PREPARE FLOOR

In case of an uneven floor, place underlayment. Set spacers equaling the thickness for the required expansion gap at proper distances.

3



INSTALL 1ST PLANK

It is very important that the first row is installed straight. To realize this, installation alternates back and forth between rows one and two, for the first two rows only. Start with a small plank (1) and position this plank close to the wall.

4

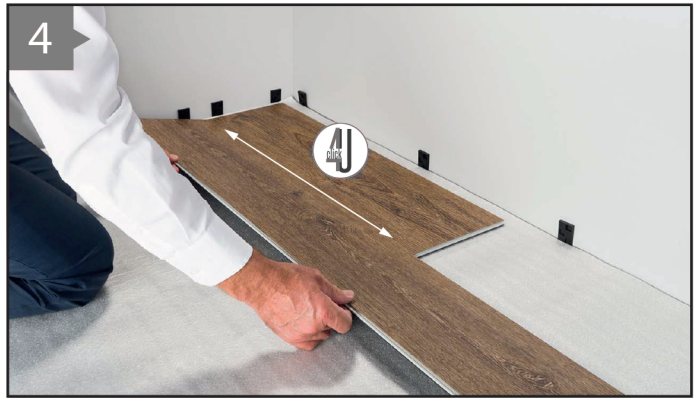

INSTALL 2ND PLANK

Now select a long plank (2). Using the **Click4U** angle system, angle the long side of plank 2 onto the long side of plank 1. Drop plank 2 to lock. Make sure there are no gaps.

5



ENGAGE 3RD PLANK ON LONG SIDE

Take another long plank (3). Repeating the previous step, insert the long side of plank 3 into the long side of plank 2. Then slide plank 3 to your left until the short side is in contact with the short side of plank 1.

6

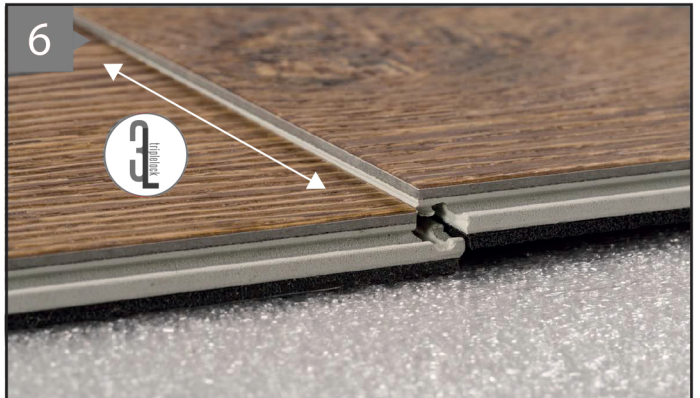

ENGAGE 3RD PLANK ON SHORT SIDE - 1

Using the **3L TripleLock** one piece drop-lock system, drop the short side of plank 3 onto the short side of plank 1.

Installation Instructions

Engaging 3L TripleLock and Click4U using a soft-faced hammer



ENGAGE 3RD PLANK ON SHORT SIDE - 2

Using a soft-faced hammer slightly tap the joints on the short side to secure. This ensures 3x locking.



INSTALLATION FROM 4TH PLANK ONWARDS

For the next rows, installation does not require alternating rows. Install one row after the other by starting with angling the long side, until the short sides are in contact.



SECURING PLANKS

As you go, don't forget to use a soft-faced hammer on the short sides to secure the locking.



FINALIZE FLOOR

Finished? Remove spacers and cover gaps with a trim.



DISASSEMBLING LONG SIDE

Wish to disassemble? Lift up the entire row, in the same angle as you did during installation, then slide apart the rows.

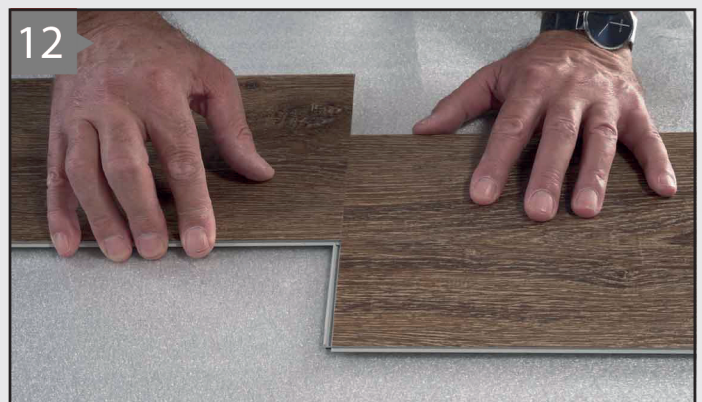

DISASSEMBLING SHORT SIDE

Disassemble the row by sliding apart the planks on the short side.