

# Installation Guide

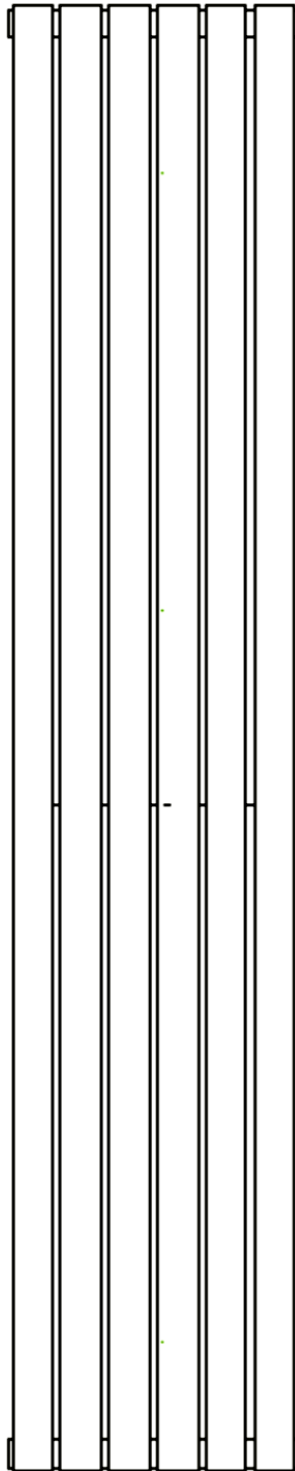

## Pre-Filled Glycol Radiator

# Important information

Before installation, please read this guide carefully.

- A fully qualified and competent person should install this product.
  - Observe all local plumbing and building codes.
  - Shut off the main water supply.
  - Operating temperature maximum 100°C. Please install a warning sign near the product to avoid burning and scalding accidents.
  - Select the desired location for the radiator ensuring the chosen wall is both strong enough and suitable to carry the weight of the radiator when full of water.
  - The provided fixings are for masonry walls only, if installing on any other surface please check that it will safely support the product and purchase suitable fixings
  - When cleaning, never use abrasive cleaners on this product as they will damage the surface. Wipe the surface clean with a soft, damp cloth.
  - Manufactured to BS EN 442-1 Radiators and convectors.
  - The pipework must be flushed out to remove any debris which can affect the function of this product.
  - We update our product information and instructions regularly: for the latest product information and instructions please look up your product by using search bar on the website [www.victorianplumbing.co.uk](http://www.victorianplumbing.co.uk)
  - **The heating element must be installed in the inlet marked bottom.**
- 

## Child Safety Notices

Please note that you are 100% legally responsible for your own child's safety at home. Once installed, the radiator can become a hazard for children as this radiator is not designed to support unreasonable extra weight, such as that of a child and the radiator becomes hot during use. We must stress that you should not allow children to climb/grab/play with the radiator or rails, as this can cause accident or injury for the child from heat, falling, or the radiator being pulled off the wall.

---

## Check & Inspect

Here at Victorian Plumbing, we pride ourselves on selecting products from reputable manufacturers who manufacture to our exacting standards and quality control measures. All our products are well packaged and should reach you in pristine condition. Please check this product carefully prior to install as we must be notified of any shortages or damage within 30 days of delivery. For further information please see terms and conditions.

## Tools required for installation (not supplied)

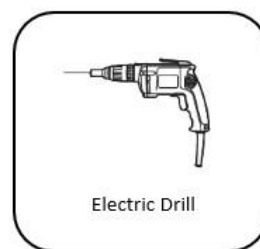
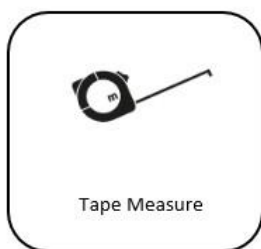
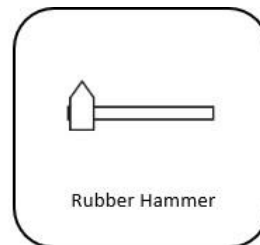
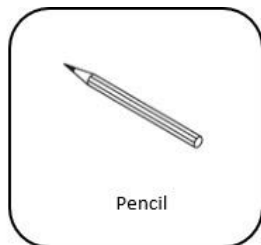

---

## Please check you have all the items below:

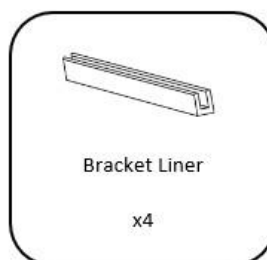
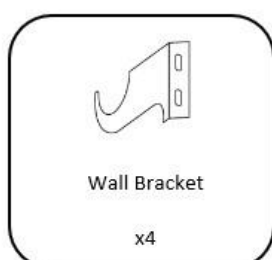
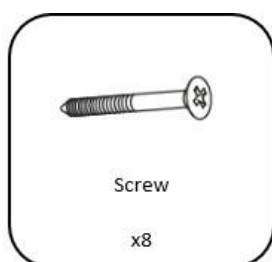
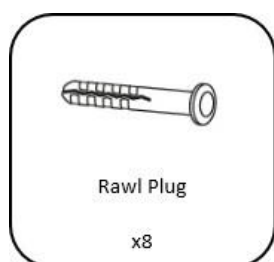

## Step 1

Carefully measure and mark out the correct location where the top and bottom brackets are to be positioned, checking for level.

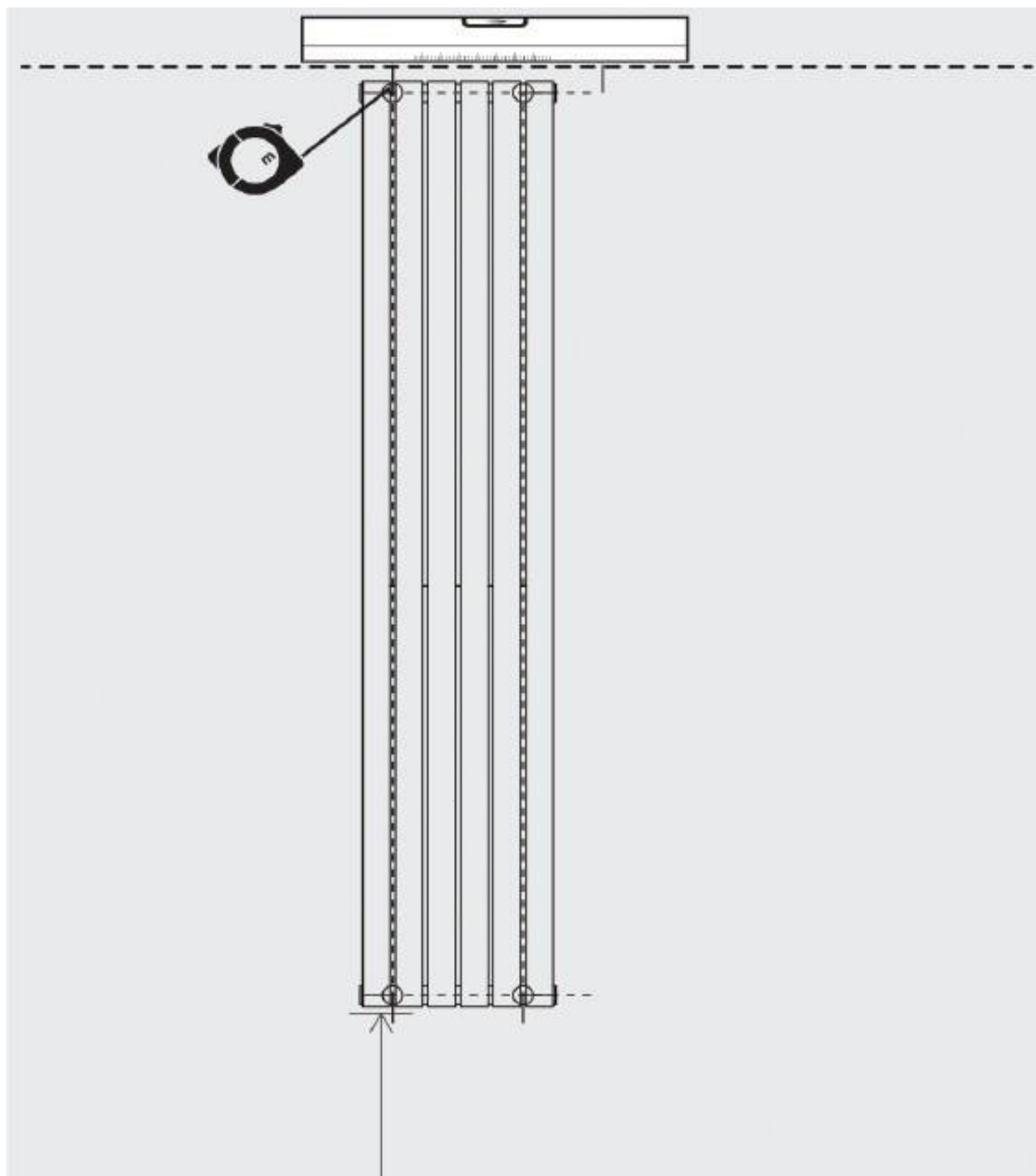

Before installation place a dust sheet on the floor to prevent losing any small parts.

## Step 2

Carefully drill the holes for the rawl plugs ensuring the correct sized masonry bit is used and insert the rawl plugs. For false or studed walls different fixings can be purchased from your local DIY store. Ensure the fixings you choose are suitable for the type of wall structure to which you are hanging the radiator, also allowing for the weight of the radiator when filled.

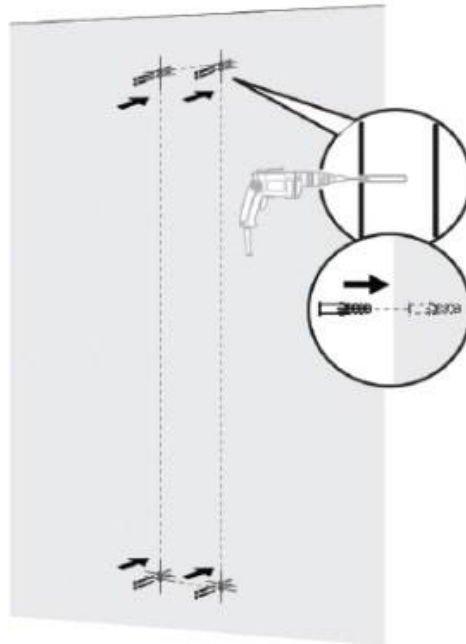

---

## Step 3

Insert the fixing screw through the holes in the bracket and secure the bracket to the wall by screwing into the rawl plug, repeat this task for all brackets. Using a spirit level re-check to ensure brackets are level.

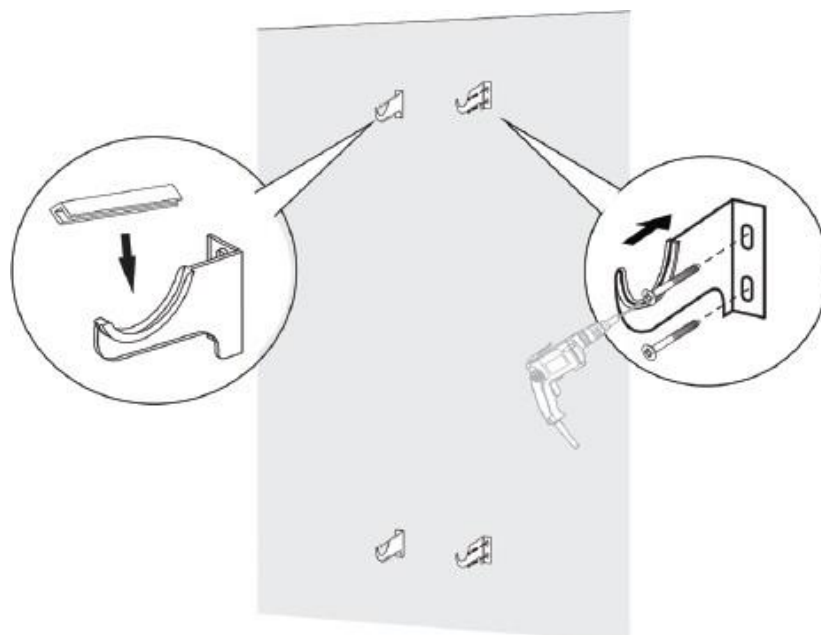

## Step 4

Hang the radiator on the brackets, always checking that the radiator sits fully on to the bracket.

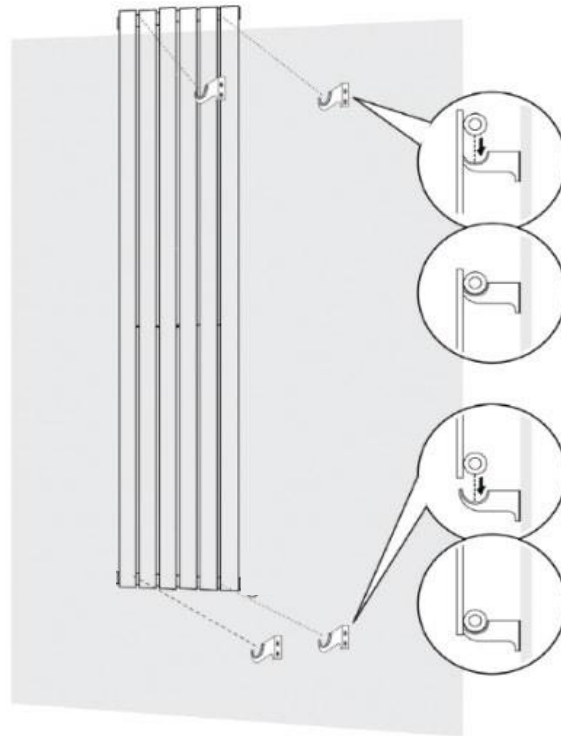

---

## Recycling and disposal

- Please recycle the packaging in accordance with your local government regulations on waste handling, and follow the same advice at the end of the products life.

Product - Steel

Packaging - Cardboard, plastic, steel