

Assembly Instructions

Instructions for installing the bath and the panel

List of elements:

- 1. Bath - 1 item
- 2. Frame rails - 2 items
- 3. Wood screws - 12 items
- 4. Bath legs - 4 pieces
- 5. Leg nuts - 12 items

- 6. Foot with thread - 4 items
- 7. Foot stabilization stand - 4 items
- 8. Wall plugs - 4 items
- 9. Wall brackets - 4 items

For mounting the casing:

- 10. Panel - 1 item
- 11. Mounting clips - 8 items
- 12. Wall plugs - 4 items
- 13. Wood screws - 12 items
- 14. Floor screws - 4 items

Bath installation on the base:

- 1) Base
- 2) Stand

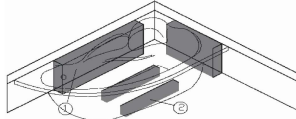

Before You Start.

- Read these instructions carefully.
- Check the pack & make sure you have all parts listed. If not, contact your supplier who will be able to help you.
- When ready to start, ensure that you have all the right tools to hand, plenty of space & a clean dry area for assembly.
- Remove packing & protective film & inspect product prior to the commencement of assembly. Any damages found must be reported to the product supplier immediately.
- Remove & discard any transportation screws as they are not required for installation.

It is recommended that when the bath needs turning 2 people should carry out his operation.

Fitting Instructions:

- Turn the bath over so it is sitting on the top face. Ensure that the top face is protected so it cannot be scratched or damaged.

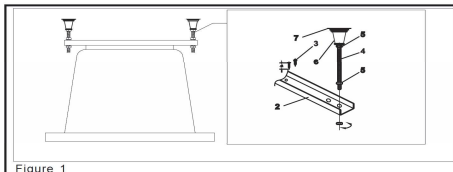

Figure 1

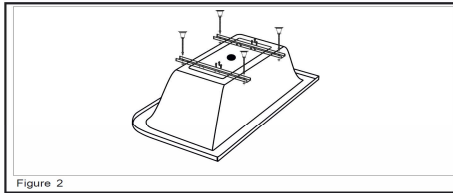

Figure 2

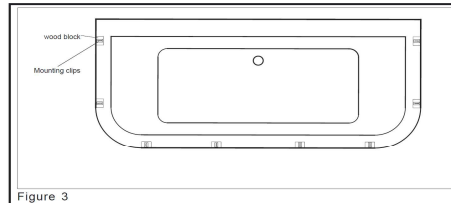

Figure 3

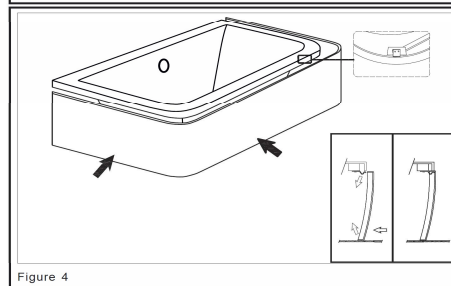
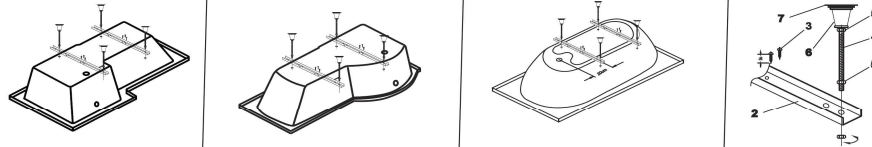

Figure 4

1. Place the bath as in Figure 2. Mount rails (2) to the bath bottom using wood screws (3) Then screw down legs (4). The rails spacing should ensure stability of the installed bath.

Figure 1



2. Put the bath in the selected place in the bathroom. Then level the bath legs (4). Mark the outline on both walls. Mark the places for brackets (9) (see Figure 3).

Figure 2

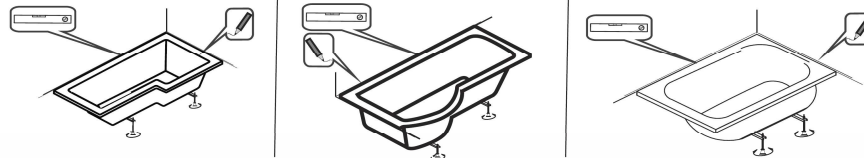

3. Mount the brackets (9) to the walls and slot the bath onto the brackets.

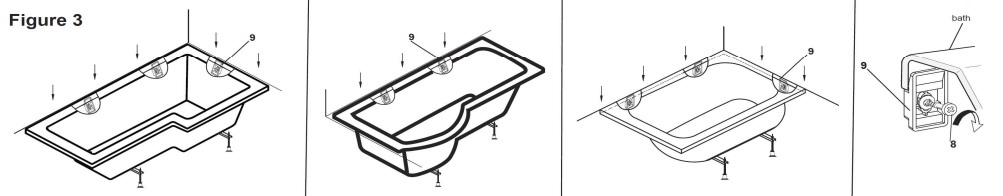

rew.1.1/12/08/15

4.

A. Tighten the clips (11) to the wooden block under the bath rim

B. Tighten the clips (11) to the floor using screw provided (14)

C. Install the panel as shown in Figure 4. If necessary the panel can be trimmed to the required dimensions.
The panel is a separate product.

Figure 4

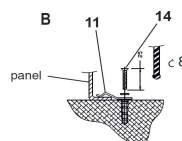
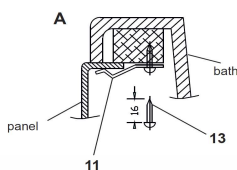
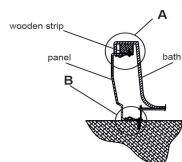
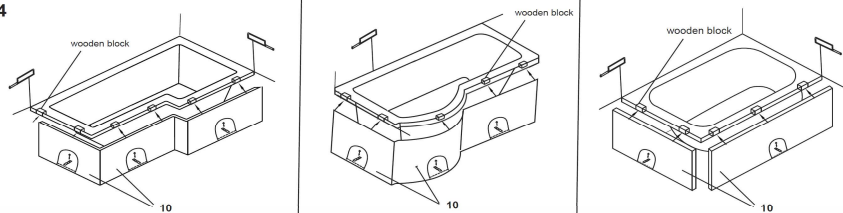

PANEL FIXING INSTRUCTIONS

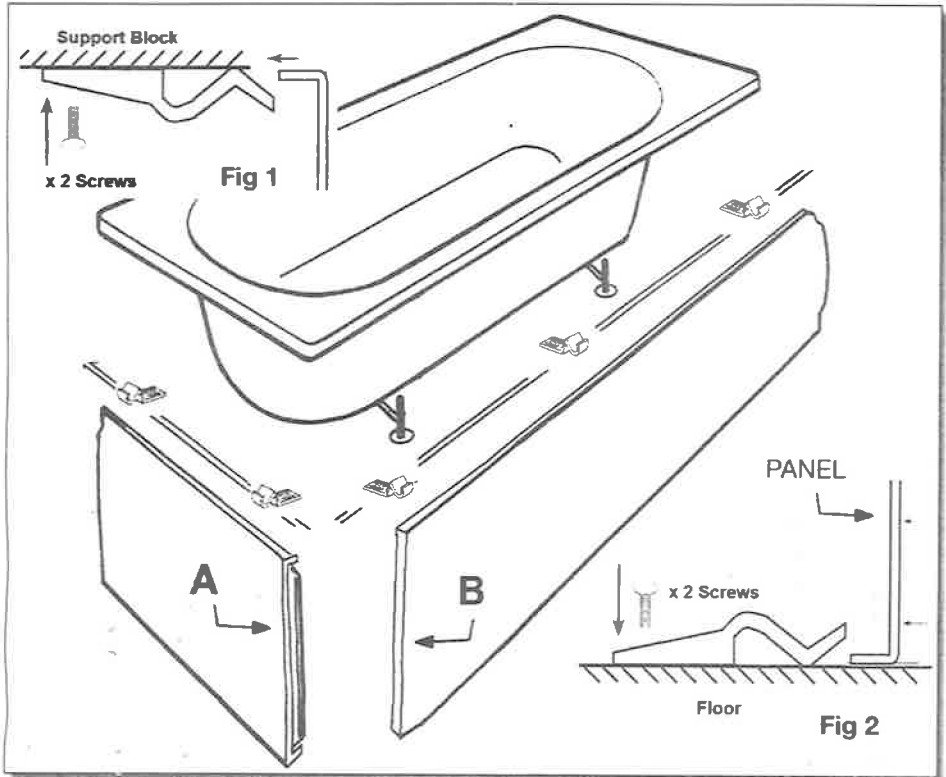

Should the cutting of panels be necessary (due to water pipes or skirting boards) a small fine toothed saw or sharp knife is recommended. Please use appropriate care and safety equipment.

1. Fit both panels in position, locate top flanges of the panels between the support block and panel clip (Fig 1)
2. Ensure that both panels are set vertical and that the end panel (A) is located behind front panel (B) at corner joint
3. To secure the panel to the wall use a piece of timber secured to the wall vertically. For the floor - Secure x3 panel clips for the front panel to the floor directly in line with the clips fitted to the bath. (x2 panel clips for the end panel) (Fig 2)
4. Small mirror screws can be used to secure the panel against the timber. Alternatively Velcro or Magnetic strips will secure in a neat fashion.

Illustrations & specifications are for guidance only and may be different depending on individual installation requirements.