



This product is IP44 rated and suitable for installation in zones: **2 & Outside Zone**

All installations must comply with guidelines which are based on a zonal concept. The diagram above illustrates this concept and must be followed to ensure the safe installation of electrical appliances in the bathroom. These regulations apply to domestic installations only. Installations must be made in accordance with the current IEE wiring regulations and relevant building regulations. **HiB recommends that all electrical bathroom products should only be fitted by a suitably qualified, Part P registered electrician.**

Thank you for purchasing this HiB product.

Please read through these instructions carefully and refer back to them during installation to ensure that your product is fitted safely and that it retains its high quality finish.

Please retain this leaflet for future reference.

Before installation, ensure the domestic electrical mains supply to which the mirror is to be connected is turned off. Before drilling, ensure that there are no hidden cables or pipes in the wall.

Illuminated Mirrors

Solas 50-C Art No. 79510500 / Solas 60-C Art No. 79510600
Solas 50-B Art No. 79520500 / Solas 60-B Art No. 79520600

Installation

NB. SOLAS mirrors must be installed with a minimum distance of 150mm between the infra-red sensor switch and any adjacent wall or object to ensure correct operation of the sensor.

1. Position the mirror in a suitable location (according to the zonal diagram - Fig. 1), ensuring that the domestic electrical mains supply is within reach of the electrical entry point of the product.
2. Carefully mark the position of the mirror using a soft pencil ensuring it is level. Remove the mirror and mark the mounting points. **Please ensure that all marked mounting points accurately match up with the fixing points on the mirror.**
3. Using a suitable drill bit, drill holes in the marked positions to a suitable depth. If drilling through tile, use a ceramic drill bit.
4. Insert wall plugs level with the surface of the wall. If fitting to a tiled surface, wall plugs should be inserted below the tile surface to avoid cracking. *NB. For plasterboard walls, specialist fixings should be purchased, available from any DIY or hardware store.*
5. Screw supplied fixings into wall plugs.
6. **Ensure the domestic electrical mains supply to which the mirror is being connected is turned off.** Connect the domestic mains supply to the terminal box according to the wiring diagram (Fig. B) overleaf.
7. Hang the mirror in position.
8. Switch the domestic electrical mains supply for the mirror back on.

CAUTION

We recommend that you place this mirror on a soft flat surface to ensure no breakages. We also recommend that you leave corner protectors on until final fitting.

Do not lift this product via the illuminated frame

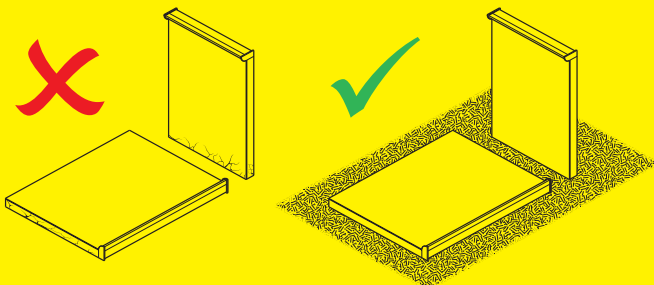

Mounting Points Diagram (Fig. A)

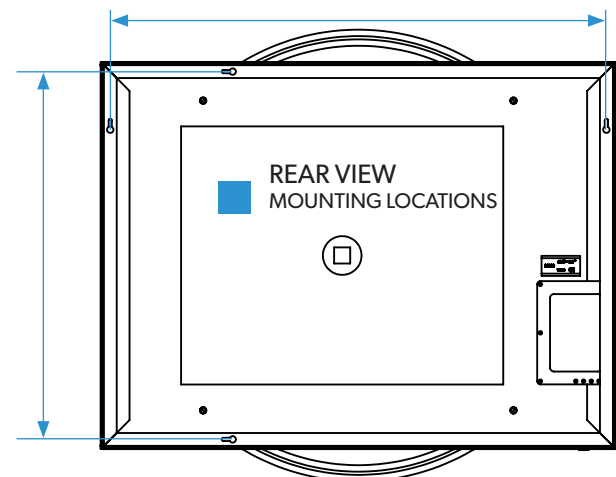

Note: Solas is dual orientation.

Operation Instructions

This mirror is fitted with colour temperature changing technology and heated de-mister pad

To switch on/off

1. Slowly move your hand past the sensor to turn the mirror on
2. Slowly move your hand past the sensor again to turn the mirror off

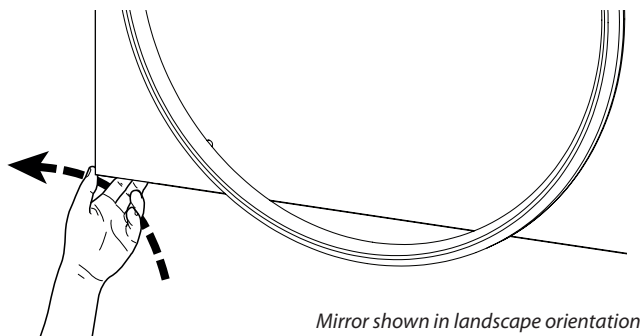

3. Heated de-mister pad is on when the mirror is on

To change the colour temperature

1. To alter the colour temperature of the mirror, **hold** your hand underneath the sensor and the colour temperature will start to change.
2. Simply move your hand away from the sensor when the desired colour temperature has been reached and continue to operate the mirror as normal.
3. The chosen colour temperature will remain set even after power is switched off and on again.

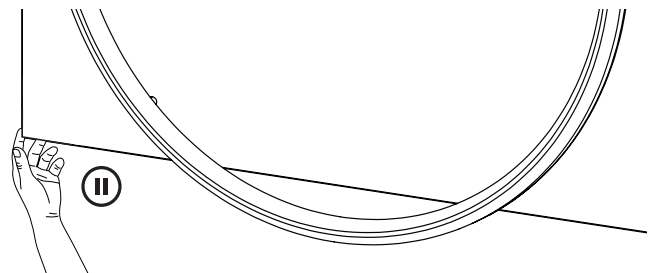

Wiring Diagram (Fig. B)

Wiring Diagram

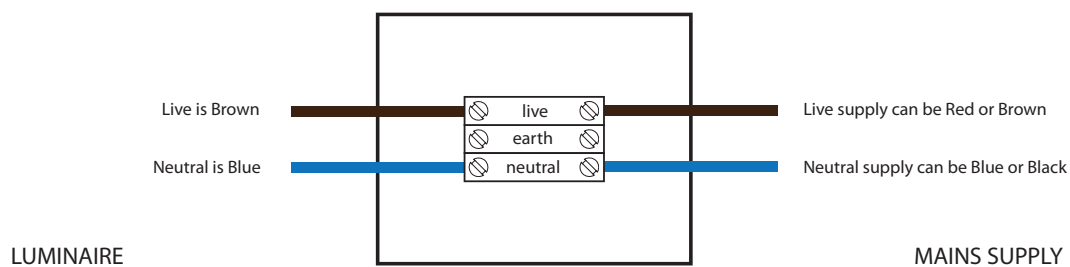

Care Instruction

Do not use abrasives or solvents when cleaning this product. Wipe off all water spillages as soon as possible using a soft, damp cloth.

Aftercare Service

In the unlikely event that this product should fail please contact HiB customer services, details shown below. Wipe off all water spillages as soon as possible using a soft, damp cloth.



WEEE compliance
Must not be mixed with general household waste