



Thank you for purchasing this HiB product.

Please read through these instructions carefully and refer back to them during installation to ensure that your product is fitted safely and that it retains its high quality finish.

Please retain this leaflet for future reference.

### 2 & Outside Zone

All installations must comply with guidelines which are based on a zonal concept. The diagram above illustrates this concept and must be followed to ensure the safe installation of electrical appliances in the bathroom. These regulations apply to domestic installations only.

Ensure product is installed in accordance with all relevant building and wiring regulations. If in doubt consult an electrician.

### This product is suitable for installation in zones:

#### Installation

Before installation, ensure the domestic electrical mains supply to which the cabinet is to be connected is turned off. Before drilling, ensure that there are no hidden cables or pipes in the wall. **NB. Groove Cabinets must be installed with a minimum distance of 150mm (Reflective surfaces may increase requirement) between the infra-red sensor switch and any adjacent wall or object to ensure correct operation of the sensor.**

**It is strongly recommended that the fitting of this product is conducted by two people and that the doors on this cabinet are not removed for installation**

1. Position the cabinet in a suitable location (according to the zonal diagram (Fig. 1) above) ensuring that the mains supply cable is within reach of the cable connection point of the cabinet. Carefully mark the desired position of the cabinet using a soft pencil, ensuring it is level.
2. Remove the cabinet from the wall and using a spirit level, mark a horizontal line below the pencil mark, taking into account the location of the mounting points (Fig. A). Place brackets on the line paying attention to the distance between the hangers on the cabinet. Carefully mark the position of the holes using a soft pencil. (Fig. B)
3. Before drilling, ensure there are no hidden cables or pipes behind the mounting point. Using a suitable drill bit, drill holes in the marked positions to a suitable depth.
4. Insert wall plugs level with the surface of the wall. If fitting to a tiled surface, wall plugs should be inserted below the tile surface to avoid cracking. **NB. For plasterboard walls, specialist fixings should be purchased from any DIY or hardware store**
5. Fix the brackets to the wall using the screws provided.
6. Carefully remove the small screws along the top front edge of the cabinet to gain access to the internal panel(s) (Fig. C) Keep screws in a safe place.
7. Temporarily hang the cabinet ensuring the claws on the hangers are securely located on the wall brackets. Using a spirit level adjust the cabinet via the screws on the hangers (Fig. C).
8. Mark the position of the internal fixing hole and remove the cabinet. Using a suitable drill bit, drill a hole and insert a wall plug as per stage 3.
9. Connect the cable at the rear of the cabinet to the mains supply cable using a suitable terminal block (not supplied) according to the wiring diagram (Fig. 2) on the back page.
10. Rehang the cabinet in position, tighten the screws on the hangers (Fig. C) and secure the base of the cabinet with the supplied screw(s) and screw cap(s).
11. Insert the shelf supports provided into the appropriate holes on the inside of the cabinet, depending on what height each shelf is required. Clip the shelf into the side of the carcass where the hinges are located first (Fig D). Gently push the shelf down onto opposite shelf supports ensuring all 4 points are secured.
12. Switch the mains supply back on.

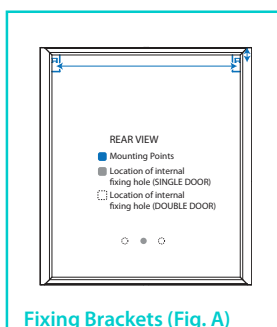

Fixing Brackets (Fig. A)

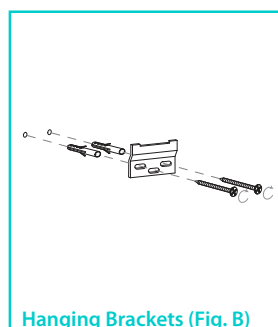

Hanging Brackets (Fig. B)

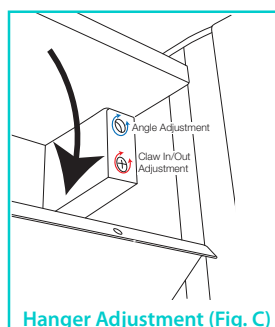

Hanger Adjustment (Fig. C)

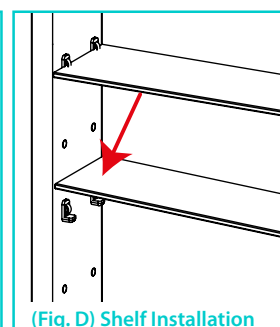

(Fig. D) Shelf Installation

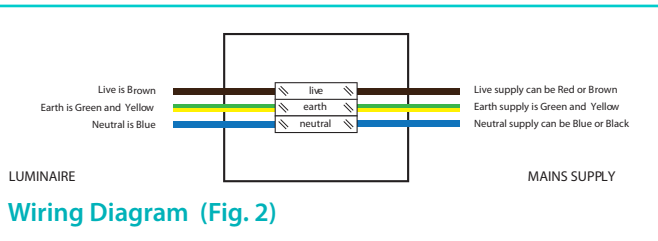

Wiring Diagram (Fig. 2)

### Care Instructions

To preserve the high quality finish of your HiB product, please ensure you regard the following care and cleaning recommendations:

Do not use abrasives or solvents when cleaning this product.

Wipe off all water spillages as soon as possible using a soft cloth.

In the unlikely event that this product should fail please contact the retailer from which the item was purchased.

After installation, it may be necessary to alter the alignment of the doors. The small screws on each hinge must be turned, which will move the door position.

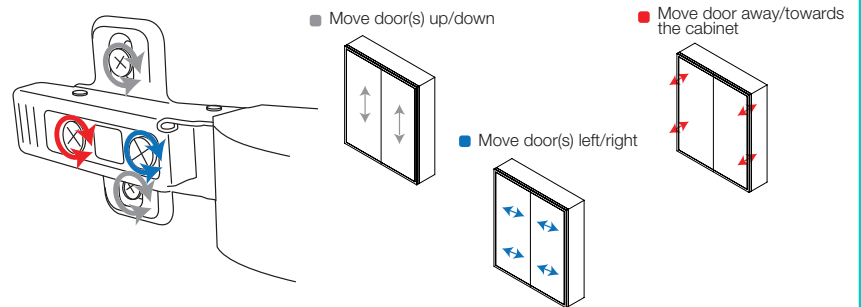

### Operating Instructions

To turn illumination on or off, wave hand past the sensor on the bottom of the cabinet. (Fig F.)

To alter the colour temperature, hold your hand under the sensor, remove hand when the desired colour temperature has been reached.

The heated Pad is only on when the cabinet is illuminated. **NB. Groove Cabinets must be installed with a minimum distance of 150mm (Reflective surfaces may increase requirement) between the infra-red sensor switch and any adjacent wall or object to ensure correct operation of the sensor.**

### Charging Socket(s)

Charger socket(s) are suitable for charging and powering electric razors, trimmers and toothbrushes. Some cabinets may contain multiple charging sockets. **NB. On first use of the charger socket, inserting the plug may prove to be stiff. Reasonable force may be required to fully insert the plug. After a few uses, stiffness will ease and the socket will function as normal.**

### Pairing Device To the Cabinet

- To activate the Bluetooth, turn on cabinet by the sensor located on the underneath the cabinet (see figure F). The cabinet will give out a tone to confirm it is ready for pairing.
- Activate the Bluetooth on your device\* (see figure G). Refer to the device's instructions for details.
- Search for "HiB001". If prompted for a connection code, use "0000". The cabinet will give out a tone to confirm successful connection.
- You can now play music or other media through the Bluetooth cabinet (see fig. H).
- When the cabinet is turned off the connection to the Bluetooth will be lost. When the cabinet is turned on again it will automatically reconnect to the last connected device if it is still within range.
- Refer to your device manual for operating controls.
- Music will stop playing when a phone call comes into the Bluetooth device, and will automatically reconnect when finished.

\*Only compatible Smart Phones & Bluetooth Devices.

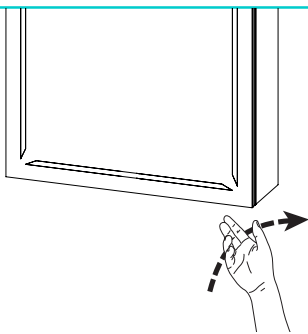

Turn Cabinet On (Fig. F)

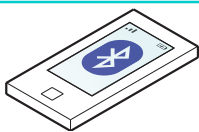

Activate Bluetooth (Fig. G)

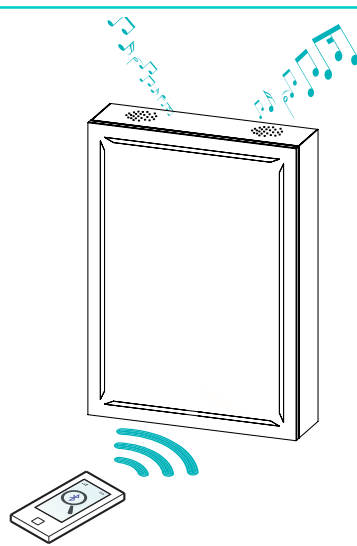

Play Content from device (Fig. H)

### Trouble Shooting Guide

Symptoms	Possible Problem	Solution
Device not paired	Bluetooth not activated	Check Bluetooth is activated on compatible device & cabinets turned on
Device not connecting	Only one device can be connected to the cabinet at any one time	Disconnect all devices and reconnect only one device
No volume	Volume is controlled from device	Increase volume on device
No connection	Out of range	Range is within 8 metres, move device closer to cabinet



WEEE compliance

Must not be mixed with general household waste

T: +44 (0)20 8441 0352 F: +44 (0)20 8441 0219 E: sales@hib.co.uk [hib.co.uk](http://hib.co.uk)

Building 3, North London Business Park, Oakleigh Road South, New Southgate, London. N11 1GN

©HiB Copyright: No part of this document may be reprinted or duplicated without HiB consent. All sizes and measurements are approximate, but we do try and make sure they are as accurate as possible. In the interest of continuous product development, HiB reserves the right to alter specifications as necessary. E & OE.