

# CATALOGUE

---

Function and feature-----	1
Specification and Model-----	2
Unit name-----	3
Installation warning-----	6
Installation approach-----	7
Use introduction-----	9
Protection and maintain-----	10
Warning proceeds-----	11
Problem elimination-----	12

## » FUNCTION & FEATURE

### WATER-SAVING

Water flows out when your hands approach it and it will stop at once when hands draw back, saving water dramatically

### SANITATION

Self-open and close to free hand from any touching, which efficiently avoids bacteria mutual infections

### INTELLIGENCE

With its micro-computer controlling its action and against light and ultraviolet radiation, the faucet can self-adjust its best detection zone, it can avoid error work. Besides it can avoid water waste with the function water self-stopped over a minutes' continuous detection.

### LOW POWER CONSUMPTION

For DC Products, 4AA alkaline batteries can be used for 2 years at 300 cycles a day (note: battery must be produced by brand manufacturer, and should not be stocked over half year from its production date).

### MICRO-COMPUTER CONTROLLING

The control unit is super-minisized design with integrate circuit in detection part, which can be against moisture and humidity,

### COMFORT

It will feel comfortable and wonderful when you wash hand.

### SELF-CLOSE FOR ABNORMAL POWER

When power supply (AC mode Faucet) is cut off suddenly or battery (DC mode faucet) is power out, it will self-close.

## » SPECIFICATION & MODEL

Specification		Remark
Power Voltage	AC220V(50/60Hz) DC6V(4AA alkaline batteries)	Choose DC6V or AC220V as per different demand
Power consumption in static	≤0.5mw	When use 4AA alkaline batteries it can be used about 2 years as per worked 300 cycles one day
Detection zone	12-18cm	With 30cmx30cm standard white sheet, it can adjust detection zone automatically according to different environment
Water pressure	0.1~0.6MPa	
Ambient temperature	0.1~45 °C	
Water temperature	0~80 °C	
Diameter of inlet /outlet pipe	G1/2" (DN15)	

## » UNIT NAME

### Mixing Valve

PARTS NAME

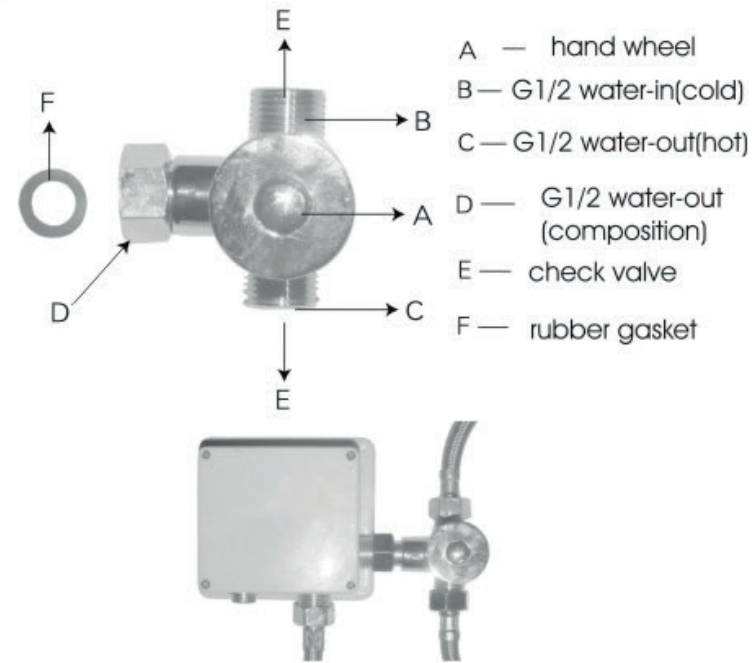

### ILLUSTRATION INSTALLATION

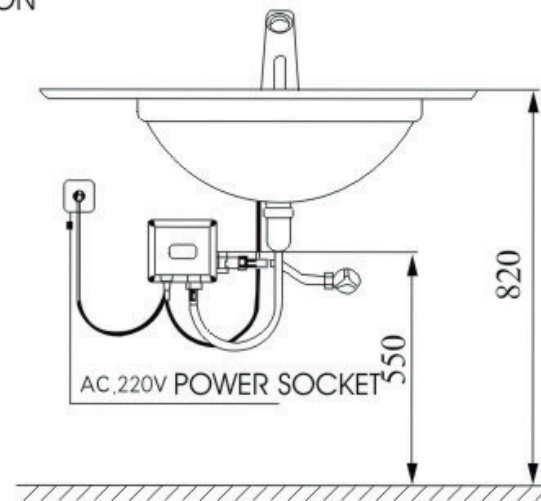

## » UNIT NAME

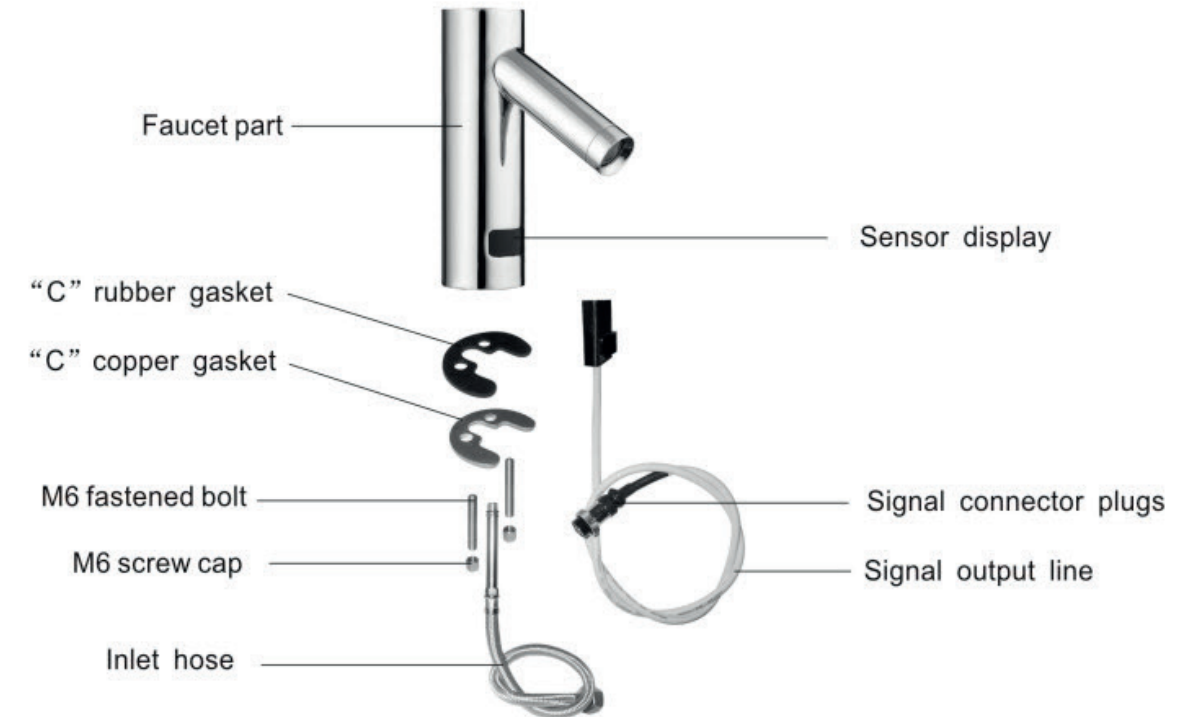



## » UNIT NAME

### DC MODE

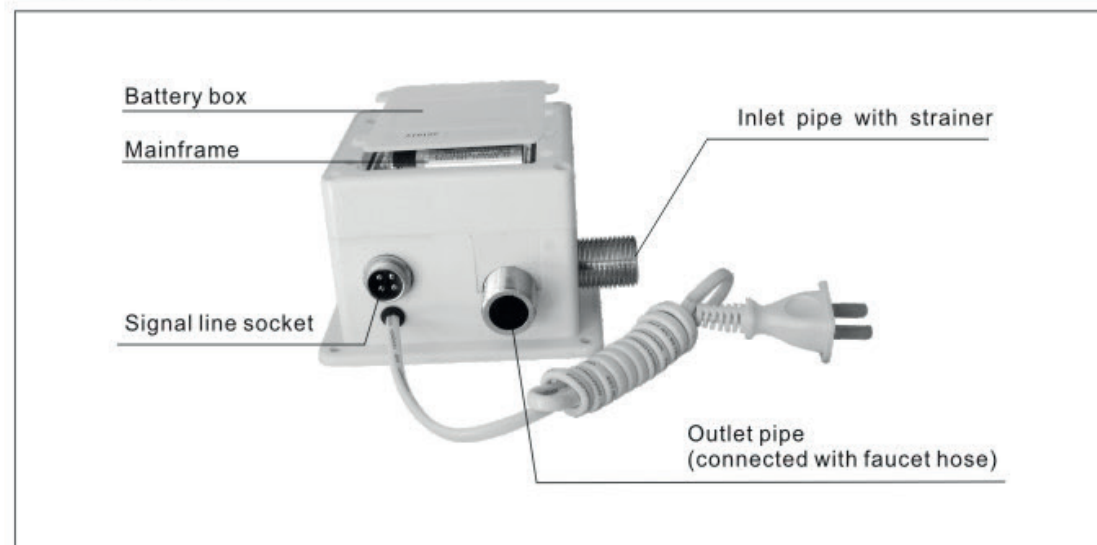

### AC MODE

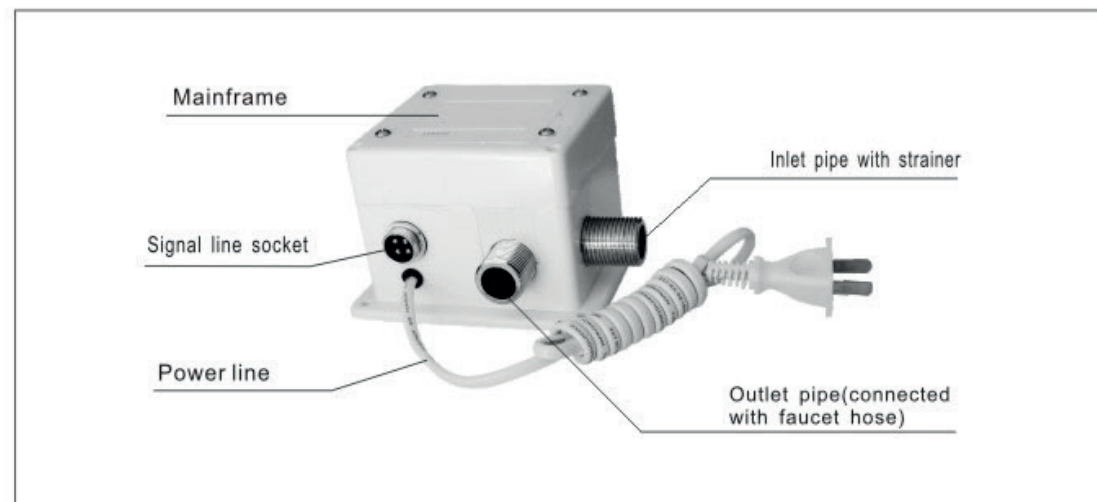

## » INSTALLATION WARNING

### LOCATION DESIGN

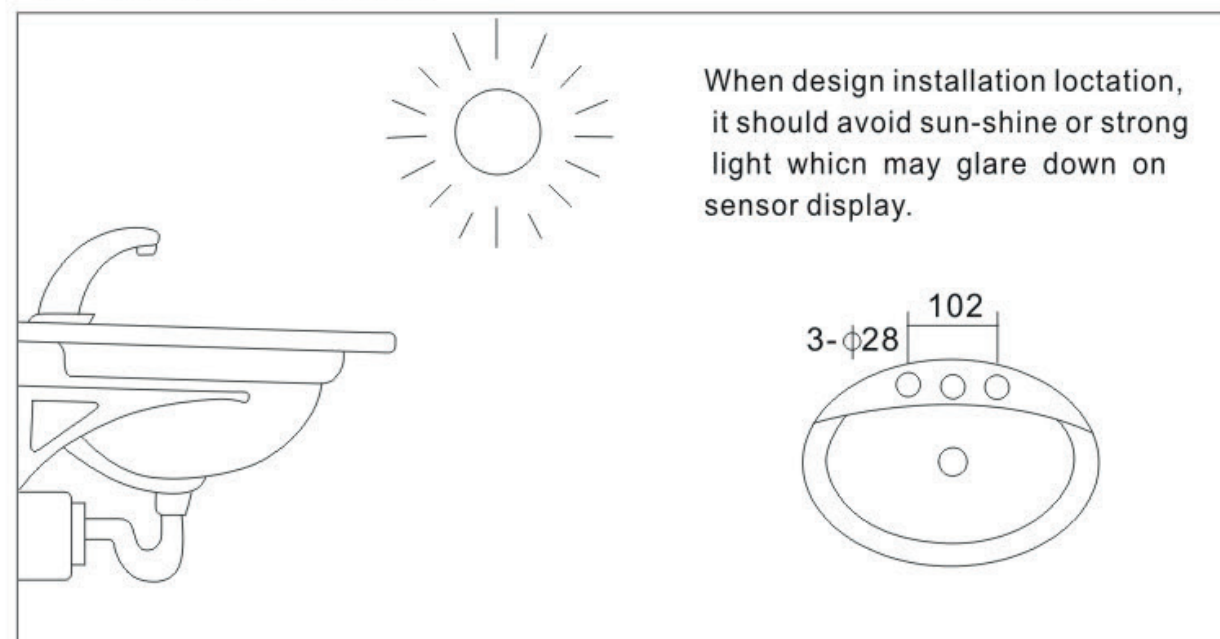

### BASIN DESIGN

It should choose standard 3 holes basin or single basin and the hole diameter should be larger than 28mm or it will break signal line when faucet moves.

### PIPE CLEANING

Before installation, please flush the pipe circuit firstly, or it will block electromagnetic valve, which will result for abnormal work.

## » INSTALLATION APPROACH

### INSTALLATION SHOW

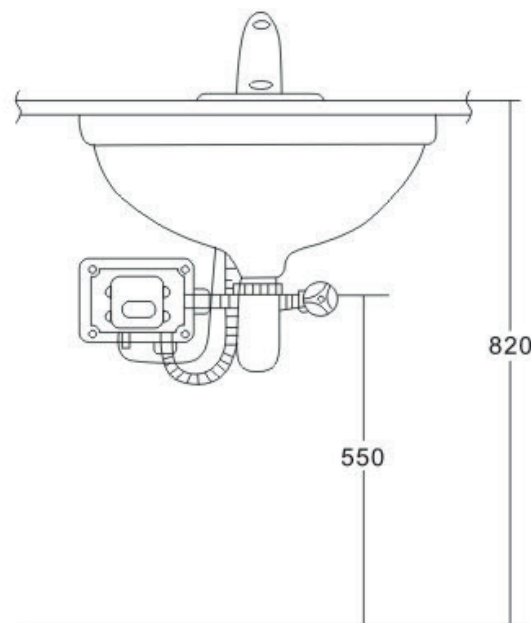

Note: please close water switch before installation



Insert signal connector plugs into mainframe's socket, and fasten screw.

Note: when insert signal line, please do keep signal connector plugs clean and dry, which can avoid abnormal work

## » INSTALLATION APPROACH

### BATTERY INSTALLATION



Note: please don't use batteries together which are different brands, models and power states.

(DC MODE)

1. Dismantle four bolts, put into 4AA alkaline batteries correctly, put back the cover and fasten bolts.
2. When change batteries, new batteries should be put into after 5 minutes from taking out old ones, which can make the original datas in machine clean completely. or it will work abnormally.

### SENSOR DISPLAY CLEANING



After installing. Please clean sensor display with soft and dry towel.

Note: it will influence detection distance whether the sensor display is clean.



## >> USE INTRODUCTION

### CLOSE & OPEN

1. When hands touch detection zone, it will work automatically after 0.5S, once hands draw back, it will be closed in 0.5S.
2. When wash hands over 1 minutes or continuous detection by error object, machine will be closed automatically. When hands or error object leaves about 10S it will be detective again.

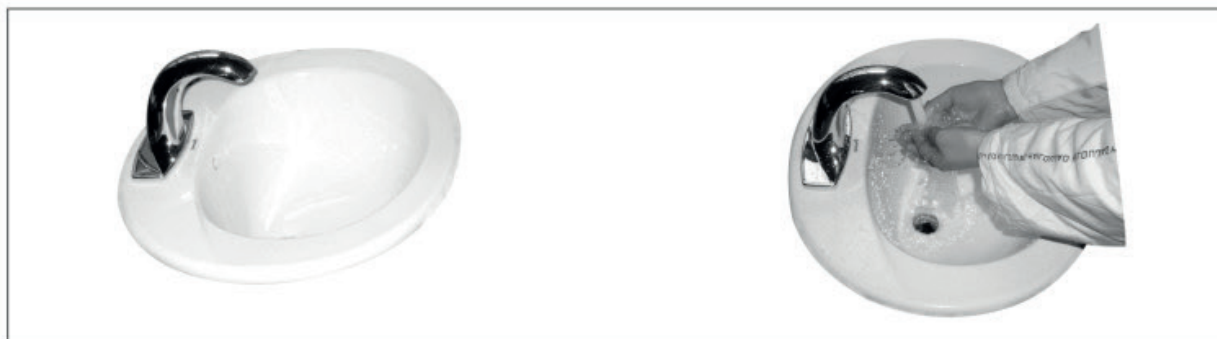

### DETECTION DISTANCE ADJUSTMENT

If detection distance is too long or too short, please adjust it as following:

1. Close water switch firstly and dismantle faucet from basin.
2. Pull out sponge as above picture with needle clip.
3. Put down detection part, tear tap and adjust potential metre carefully with screwdriver. Turning it in sequence, the detection distance is longer. On the contrary, it will become shorter.

Note:

this product can be self-adjusted, and have a strict inspection before prior sale. If no special need, please don't adjust distance by yourself.

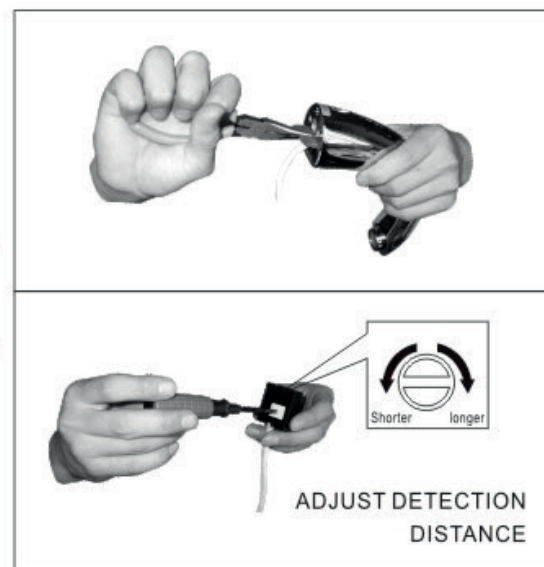

## >> PROTECTION & MAINTAIN

### BATTERY INSPECTION

When light blink one time every 4S, it shows battery is power out and we should change new battery.

Note: it can't work when battery is power out.



### STRAINER AND MOUTH-FILTER CLEANING

Clean strainer and mouth-filter every six to twelve months or when water flux is fewer.

Note: shut inlet pipe switch firstly, turn out inlet pipe mouth and clean strainer. Then connect inlet pipe and open inlet pipe switch.



Note: shut inlet pipe switch firstly, turn out faucet nozzle, put down and clean mouth-filter. Then connect faucet nozzle and open the Switch.



## » WARNING PROCEEDS

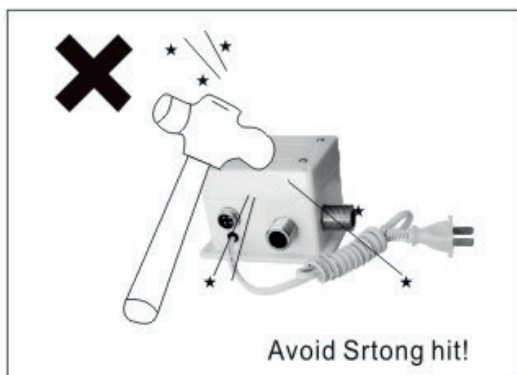

There are electronic components and some plastic elements in machine. So it should avoid strong hit.

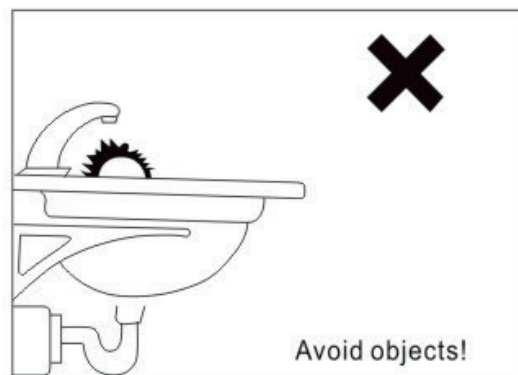

It will influence correct detection if there are some other objects on sensor display. We must clean them



When clean the mainframe in everyday maintain, we can't clean it with erosion cleanser or water directly. We should plur advanced wax around it and then clean it with tidy sponge.

