

## WH-8801 User manual



# Contents

Important safety warning

Product specifications

Preparation before first use

Other functional description

Overall sketch

Operation

Cleaning

Warm air drying

Key Flush

Lamp control

Water temperature adjustment

Drying temperature adjustment

Seat temperature adjustment

Night light

Remote button function

Remote control operation protection

Maintenance and cleaning

Troubleshooting

Dimensions

## Important safety warning

### Save these instructions.

Warning: Risk of electric shock, fire, or injury to life. This product must be grounded safely. Connect to a dedicated 220-230V AC.50Hz.10A. In a circuit with a ground fault circuit breaker or an earth leakage protector.

Warning: Risk of electric shock or product damage. Do not spray water directly onto the product.

### A fully qualified and competent person should install this product.

Note! The risk of product damage. Do not install it in a place where water may splash.

Note! The risk of product damage. Do not install the product in an excessively humid place where moisture may condense on the surface of the product. Please maintain adequate ventilation in the environment to prevent damage to electronic components.

Note! Risk of product damage or property loss. Hard push and hard water pipe joints may cause water to leak.

Note! Risk of product damage. Do not apply excessive force to the nozzle or the product may be damaged.

Note! Risk of product damage. Water may freeze in a water pipe, make arrangements for water pipe insulation. Any water left in the product may freeze during winter storage. Please ensure that the product is at room temperature before reinstalling or using it.

Note! Risk of product damage. Do not turn on the power until the installation is complete, otherwise the product may malfunction.

Note: In warm climates, thermal protectors may fail during storage or transportation, causing the product to not work. Please ensure that the product is at room temperature before reinstalling or using it.

When using electrical products, especially when there are children, basic safety protection should be observed included the following:

**Danger - Reduce the risk of electric shock:**

- Do not touch the toilet that has been sprayed with water.

**Warning - Reduce the risk of low burns, electric shock, fire or personal injury:**

- Monitoring is required when children, the elderly, and disabled people use or are close to the device. Children should not be allowed to use this product. Do not allow children to stay alone in a room with this product installed.
- For children and the elderly who cannot perform their own temperature adjustment operations, it is necessary to help adjust the temperature, flushing temperature and air temperature of the toilet seat cover to the appropriate grade position.
- Use this product only in the manner described in the manual, and do not use accessories that are not recommended.
- Do not lean against the seat cover when using it to avoid damage to the product.
- Do not use this product if: Power cord and product are damaged; The product is not working properly; The product is drenched with water.
- Install the product correctly according to the installation instructions.
- This appliance is designed for fixed connection to the power supply. Connecting this appliance to the power supply must be performed by a qualified and authorised electrician.
- Keep the power cord away from the heated surface.
- Do not drop or insert any items into the pipes and openings.
- Do not use this product outdoors or where the particle spray equipment is being used. Also do not use this product in places where oxygen is supplied.
- This is a Class 1 electrical appliance and must be correctly earthed. Make sure the earth cable is connected first during the electrical connection.
- Prevent water from dripping onto the power cord.
- Incorrect repairs are dangerous. Trained and qualified engineers must only conduct repairs. Do not attempt to repair this product yourself, otherwise the warranty will be void.

## Product specifications

|  |                                       |  |   |  |
|--|---------------------------------------|--|---|--|
| Water supply pressure (dynamic pressure) |                                       | 0.7kgf/cm <sup>2</sup> ~ 7. Skgf/cm <sup>2</sup> (0.07Mpa. ~ 0.74Mpa.) |   |  |
| Specification                            |                                       | 220~230V      50Hz<br>1600W (cold water temperature < 8 ° C)           |   |  |
| Power cord length                        |                                       | About 1m   |   |  |
| Use environment                          |                                       | 0~40°C   |   |  |
| Cleaning                                 | Water output                          | Hip rinse/ female rinse  | 0.42~1.2L/min (three grades adjustable))                                |  |
|  |                                       | Laxative flushing  | 0.42~1.2L/min (three grades adjustable))                                |  |
|  | Maximum instantaneous heating power   |  | When the water temperature is <8 °C, the maximum power is 1600W.        |  |
|  | Cleaning water temperature adjustment |  | Off, low, medium, and high four (room temperature ~ 40 ° C)             |  |
|  | Number of nozzles                     |  | 1   |  |
|  | Nozzle position adjustment            |  | 5 Grade place   |  |
|  | Pulse massage                         |  | Open/Close  |  |
|  | Mobile flush                          |  | Open/Close  |  |
|  | Safety equipment                      | Water shortage protection  | Water flow detection sensor   |  |
|  |                                       | Water temperature overheat protection                                  | Temperature fuse, overheat circuit breaker, water temperature sensor    |  |
| Comfortable                              | Seat insulation                       | Maximum heating power  | 30W   |  |
|  |                                       | Temperature adjustment   | Off, low, medium, and high four Grade place (Room temperature ~ 39 ° C) |  |
|  |                                       | Safety equipment   | Thermal fuse, thermal circuit breaker                                   |  |
|  | Warm air                              | Mobile drying  | Open/Close  |  |
|  |                                       | Maximum air volume of the fan  | 0.22m <sup>3</sup> /min   |  |
|  |                                       | Maximum heating power  | 300W  |  |
|  |                                       | Temperature adjustment   | Off, low, medium, and high  |  |
|  |                                       | Safety equipment   | Thermal fuse, thermal circuit breaker                                   |  |
|  | Deodorization function                | Intelligent deodorization  | Activated carbon deodorization  |  |

Note: The product styles in this manual are subject to the actual product!

## Product Specifications (continued)

|                 |                        |                         |
|-----------------|------------------------|-------------------------|
| Health          | Remote control         | Set various functions   |
|                 | Nozzle self-cleaning   | Have.                   |
|                 | Antibacterial material | Seat, nozzle            |
| Other Functions | Auxiliary Button nob   | On the side of the body |
|                 | Sitting sensor.        | Located inside the seat |
|                 | Night light            | One blue LED light      |

## Preparation before first use

- Connect the water inlet hose, open the water stop valve, and plug in the power supply.
- Confirm that the battery is correctly inserted in the "remote control".
- Confirm that there are no obstacles in front of the product.
- Waiting for the host to complete the self-test. It is normal to hear the motor and the sound of running water during this period.
- The self-test process takes about 30 seconds.

## Other functional description

1. Smart toilet flushing method.
  - If it is a wall mounted smart toilet, you can press the water tank flush button on the wall to flush.
2. Intelligent toilet self-cleaning function
  - Press the laxative button, the nozzle will self-clean for three seconds, then extend to start the cleaning function.
  - After cleaning, the nozzle will self-cleaning for three seconds.
3. Intelligent toilet automatic deodorization function
  - After use, the toilet will automatically deodorize for 30 seconds, or it can be turned off with the remote control.
4. Button function
  - The user is seated and presses the button without performing the cleaning and drying functions; toilet bowl for drying; If the toilet is performing the cleaning or drying function, pressing it will stop the current function.
  - Rotate the button continuously ten times backwards to turn off the button indicator and then turn it back ten times to re-open the button indicator. The button has other functions. Refer to the button function section of this manual.

## Overall sketch

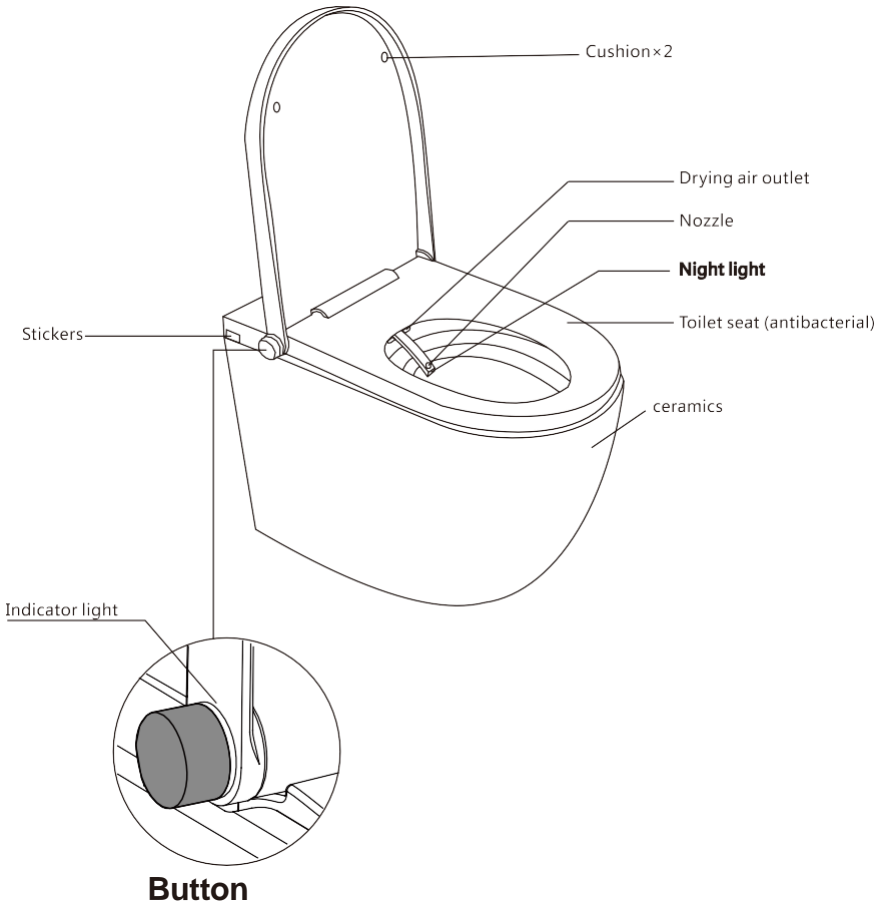

Button control: The front spine is cleaned, the female is cleaned after the rotation, and the cleaning is stopped by pressing.

(Note: The above smart toilet is one of the toilet models, which is subject to the actual product. )

## Female cleaning

Operational function of the toilet.

-start up

After the spin button, you hear a "beep" and start the female cleaning.

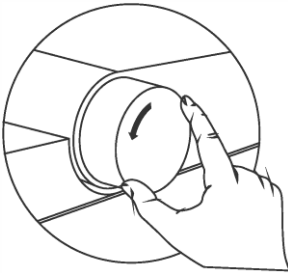

-stop

Press the button and hear a "beep" to stop the female cleaning.

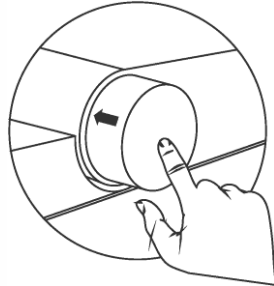

The cleaning will automatically stop after approximately three minutes of continuous cleaning.

## Cleaning

Operational function of the toilet.

-start up

Turn the button forward and hear a "beep" sound to start the hip cleaning.

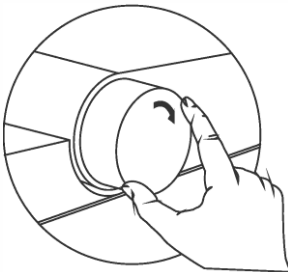

-stop

Press the button and hear a "beep" and stop the hip cleaning.

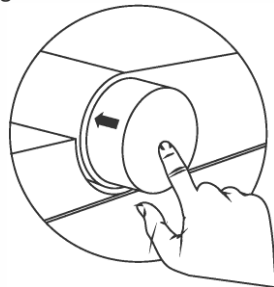

The cleaning will automatically stop after approximately three minutes of continuous cleaning.



## Warm air-drying

Operation function operation of the toilet.

-start up

Press the button and hear a "beep"  
to start the warm air arch.

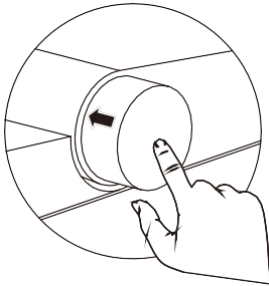

-stop

Press the button again and hear a "beep."  
After 6-7s, stop the warm air drying.

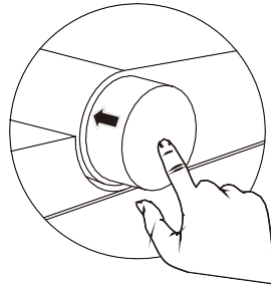

Drying will automatically stop after approximately three minutes of continuous drying.

## Lamp control

- close, open

Rotate the button ten times in the back and  
forth, and hear the "drip" sound, the button  
indicator lights off. The operation button  
indicator lights up again.

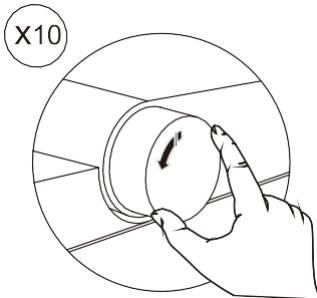

## Water temperature adjustment

When cleaning:

-Warming

The button is continuously rotated forward 2 times, and when the "beep" is heard, the water temperature rises by one step.

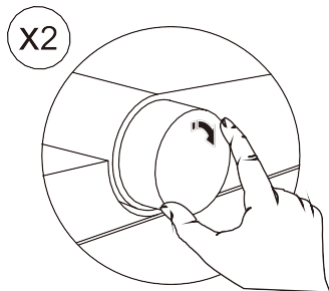

-Desuperheat

The button is continuously rotated backwards two times, and when the sound is heard, the water temperature is lowered by one step.

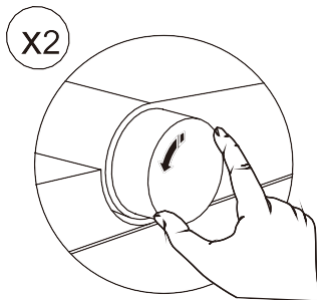

## Wind temperature adjustment

When the warm air is dry:

-Warming

The button is rotated forward two times in a row, two and when the sound is heard, the wind temperature rises by one step

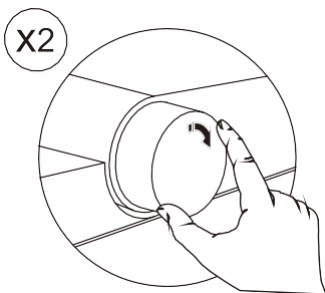

-Desuperheat

The button is continuously rotated backwards two times, and when the "beep" is heard, the wind temperature is lowered by one step.

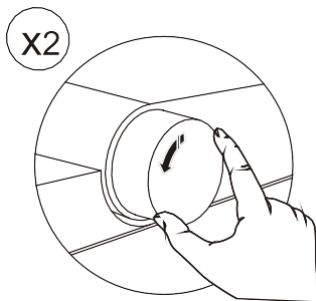

## Seat temperature adjustment

Operational function of the toilet:

-Warming

The button rotates forward two times in a row, two and when the "beep" is heard, the seat temperature rises by one step'

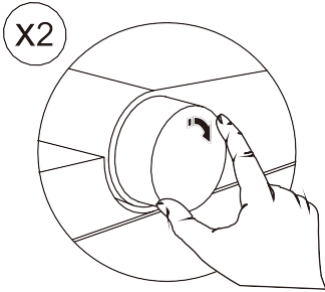

-Desuperheat

The button is continuously rotated backwards times, and when the "beep" is heard, the seat temperature is lowered by one step.

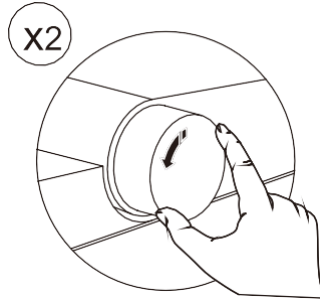

Summer seat is not heated:

The seat temperature setting has four speeds, off-low-medium-high, and the maximum temperature is reduced three times, and the seat will stop heating.

## Night light

Operational function of the toilet:

-Turn on

Quickly click the button three times (within one second) and hear a "beep" to turn on light.

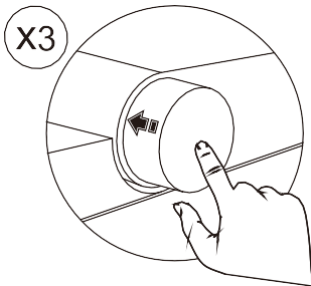

-Shutdown

Quickly click the button three times (within one second) and hear a "beep" and turn night light off.

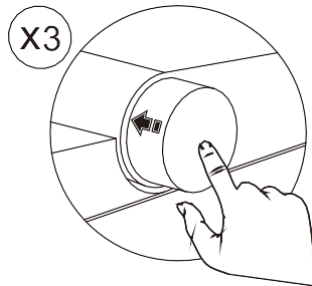

## Remote button function

**Note: For the first time, if the remote control does not respond to use, you need to re code. (Refer to the coding method on the following page)**

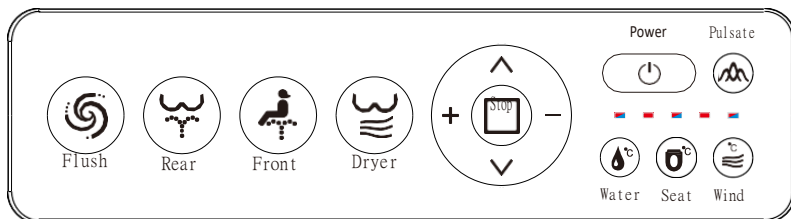

Press this button to perform the flush function. The Toilet pan with automatic flushing function can be flushed by pressing this button.  
\* This toilet has no function.

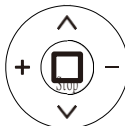

Press this button to perform laxative flushing, press the selection button to adjust the water temperature, flush the hydraulic power, and rinse the position. Press again to perform a mobile rinse.



In the laxative modes, press these two keys to adjust the sprinkler position. There are five position gears, and there are indicators.  
to indicate the current gear position.



Press this button to perform laxative flushing, press the selection button to adjust the water temperature, wash the hydraulic power, and rinse the position. Press again to perform a mobile rinse.



In the laxative modes, press these two keys to adjust the flushing hydraulics. There is an indicator light indicating the current.



Press this button to perform the drying function, press the selection button to adjust the water temperature.  
The drying temperature is four steps:  
1. Does not light for normal temperature,  
2. Blue is low, 3. Pink is mid-range,  
4. Red is high grade.



Press to stop all functions that are in use. It can stop the buttocks, female, laxative and dry functions.



When the massage button is turned on, the female flushing, and the laxative flushing function are turned on, press this button to perform the rubbing, and then press to stop the rubbing.



None The water temperature gear is divided into four gears:  
1. Not lit to normal temperature,  
2. Blue is low,  
3. Pink is mid-range,  
4. Red is high grade.



This button is the seat temperature adjustment button, and the seat temperature is four:  
1. Does not light for normal temperature,  
2. Blue is low,  
3. Pink is mid-range,  
4. Red is high grade.



\* This toilet has no function.  
This button is the wind temperature adjustment button, and the seat temperature is four:  
1. Does not light for normal temperature,  
2. Blue is low,  
3. Pink is mid-range,  
4. Red is high grade.



There are four modes of indicator display:

1. Running LED mode Press any key, If it is not in any other mode, it will display the effect of running lights, and the five indicators will light up once respectively.
2. Temperature regulation mode Press the water temperature key, the seat temperature key, and the air temperature key, and their gear positions will be displayed. There are colors to indicate the temperature gear positions.
3. Nozzle length adjustment mode Press the arrow key, the length of the nozzle will be displayed with five indicators.
4. Water pressure regulation mode Press the plus and minus keys to display the water pressure intensity, with three indicators.



This button is the key for automatic deodorization. Press the automatic deodorization on, the indicator light is on, press again, the indicator light is off. When the indicator is on, the Toilet pan automatically performs a 30-second deodorization function when the user is away from the seat.  
\* This toilet has no function.

\* This toilet has no function.

This key is a function key, different toilets have different functions.  
\* This toilet has no function.



Press this button to light the Toilet pan night light, then press this button to turn off the night light. Press and hold this button to enter the power save mode, and automatically resume after 8 hours, or press this button again to turn off the power save function.



This key is the nozzle cleaning key, press once to clean the nozzle Washing function. Automatic stop after 1 minute End. You can also press the Stop button to stop.  
\* This toilet has no function.

\* This toilet has no function.



Long press User 1 to allow automatic flip; Press and hold User 2 to disable automatic flip.

**Special attention: for the water tank or sensing panel without automatic flushing function, pressing the flush key will not execute the flushing function.**

## Remote control operation protection

A The remote control communicates with the body.

The remote control controls the body by sending wireless signal. The closer signal is, the stronger the signal is.  
Please choose the installation location.

B Remote control signal pair code

If the remote control is lost or damaged, you need to pair the signal with the appliance with a new remote control.  
Otherwise, the remote control cannot be used.

The pairing method is as follows:

1. Press and hold the remote control stop button. Press and hold the Toilet button again:

2. After hearing the long sound of "beep" Release the button and stop button.

3. Press the remote control stop button again. A "beep" will indicate that pairing was successful. If there is no sound, Please replace the remote-control battery and try again.

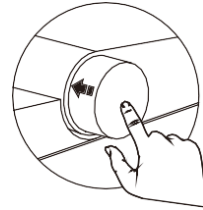

C The use and replacement of the remote-control battery

The remote control uses two **7-cell alkaline batteries (not supplied)**.

D. **Other**

- Do not place the remote control where the liquid may be sprayed directly, or by immersing it in a liquid.
- Do not place it around small appliances such as hand dryers and hair dryers, so as not to interfere with the normal use of the remote control.
- Do not apply external force to the button area of the remote-control frequently or violently.
- After using the remote control, put it back on the remote-control bracket on the wall.

### Note:

1. The positive and negative poles of the battery must match the markings on the remote control.
2. Old and new batteries cannot be mixed.
3. Please use alkaline batteries.
4. Please remove the battery when not in use for a long time.

## Maintenance and cleaning

### Routine cleaning

For the best results, keep the following in mind when maintaining your product: Note! Do not flush the toilet cover directly with water (included the remote control)

- Apply a small amount of cleaning solution to test the cleaning solution will not damage the surface of the Toilet, once confirmed the cleaning solution can be applied to the entire surface.
- Do not let the detergent soak: Do not let the detergent soak the product.

## Maintenance and cleaning

Avoid rough surface materials: use soft, wet sponges or cotton cloth, do not use rough surface materials to clean the surface, such as brushes, scour pads, etc.

- \* Scrub: Immediately after adding the cleaner, wipe the surface with a damp cloth and wipe off the detergent and dirt sprayed onto the surface.
- \* Neutral cleaning liquid and detergent should be used.
- \* Cleaning seat
- \* Avoid abrasive cleaners and disinfectants in aerosol cans.

### Maintenance tips

Clean the seat with a mixture of detergent and water. using a soft, moist sponge or cloth. Dry with a soft towel and let the seat dry naturally.

Note: The success of the cleaning process depends on factors such as the hardness and temperature of the water, the exact amount of ingredients used, the change in cleaning rules, and the state of the product being cleaned. Because these factors will change, the company cannot guarantee the validity of the mentioned rules.

- Clean the lid and seat smart seat to clean Smart toilet cleaning:
- Isolate the power and close the water stop valve
- Wring with a soft cloth dampened with water
- Dry with a dry soft cloth

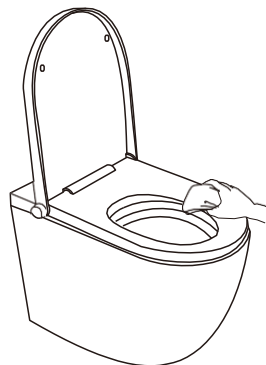
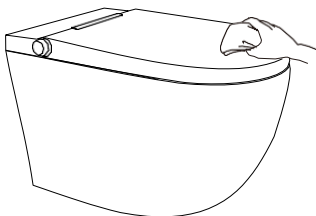

## Maintenance and cleaning

### Seat cover and seat cleaning:

It is not recommended that the user disassemble the seat cover and the seat to clean the dirt in the corners, so as not to damage the internal connecting wires and electrical components. Please contact a qualified electrician to disassemble and replace the cover and seat.

#### □ Nozzle cleaning

How to clean the nozzle with a soft brush:

- When not seated, the front or rear button, the nozzle will stick out, but will not spray water.
- Users can clean the nozzle with a soft brush and water.
- Press the button to retract the nozzle.
- After cleaning, wipe the water on the product with a dry soft cloth.

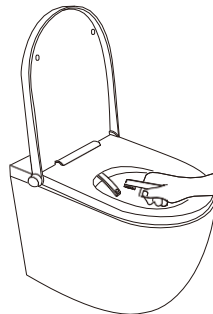
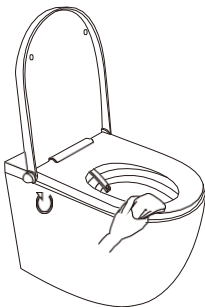

#### □ Filter cleaning or replacement

The user finds that the amount of flushing water is small or there is no water. Please clean or replace the filter in time. If it is a wall mounted toilet (because the filter is installed in the water tank), please refer to the tank cleaning instructions.

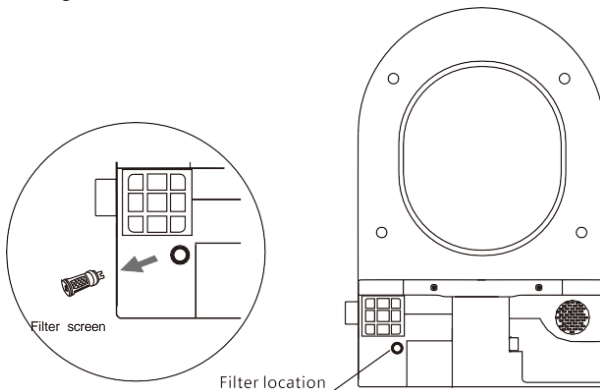

Bottom of seat

## Maintenance and cleaning

- Maintenance when not in use for extended periods of time  
If you are not going to use the smart toilet cover for a long time, be sure to close the water stop valve.
- Turn off the power.
- Close the water valve.

### Note:

1. If the product is not used for a long time without draining the water, the residual water is easy to freeze in winter and deteriorates in summer.
2. In the winter, the water supply pipeline in the home has been frozen. Do not use the smart toilet immediately. You can raise the temperature in the room and wait for it to naturally thaw before use.
3. When using it again after long-term use, be sure to rinse it several times to ensure that the internal piping is clean.
4. Take out the battery of the remote control.

## Troubleshooting

### General function

| Symptoms                   | Possible reason  | Recommended measures   |
|----------------------------|--|--|
| The machine is not working | A. Power outage<br>B. No power cord or socket is connected.<br>C. The power line leakage protection switch is not reset.<br>D. The human body does not touch the seat, sensing area. | A. Wait until the power is restored.<br>B. Check the power cord or check the power outlet.<br>C. Press the reset button on the plug.<br>D. Contact the seat sensing area.                                  |
| No nozzle can effluent     | A. The seat failed to sense the user.<br>B. The water supply valve is closed, or the inlet pipe is bent.<br>C. The filter is blocked.  | A. Adjust the sitting position, there can be no object isolation between the skin and the seat, such as pants.<br>B. Turn off the power, remove the water supply, and re-energize.<br>C. Clean the filter. |



## Troubleshooting (continued)

### Cleaning function

| Symptoms   | Possible reason  | Recommended measures  |
|--|--|---|
| No water flow  | <p>A. The water supply valve has been closed.</p> <p>B. The drop sensor does not detect the user.</p>  | <p>A. Open the water supply value.</p> <p>B. Check the active seat information in the "Usage Method" section.</p>   |
| Low flushing water pressure  | <p>A. The filter is blocked.</p> <p>B. The water supply pressure is insufficient.</p> <p>C. The plastic seat cover is not connected to the ceramic base.</p> | <p>A. View the "cleaning filter" section of the hidden water tank.</p> <p>B. Increase the water pressure to the water pressure range required by the product.</p> <p>C. Reinstall the plastic seat cover so that there is no large gap between the plastic seat cover and the ceramic base.</p> |
| The water is blocked in the nozzle before the cleaning is completed. | <p>A. The sitting sensor does not detect the user.</p>   | <p>A. View in the "User Manual"</p>   |
| Water flows out of the hole beside the Nozzle when flushing          | <p>Protection against excessive water pressure inside the product.</p>   | <p>No</p>   |

### Sitting sensor

| Symptoms  | Possible reason  | Recommended measures   |
|---|--|--|
| Press the wash button when not in use, the cleaning function is enabled | <p>The sitting sensor is covered by an object or the <b>seat is wet</b></p>                                    | <p>Wipe water or foreign objects that fall into the <b>sensor area</b></p> |
| Even if you sit, the cleaning function does not work.                   | <p>In the current sitting position, the sitting sensor cannot monitor the user, or the pad is on the seat.</p> | <p>Change sitting posture</p>  |

## Troubleshooting (continued)

### Remote control

| Symptoms                     | Possible reason  | Recommended measures  |
|------------------------------|--|---|
| Remote control does not work | <ul style="list-style-type: none"><li>A. The battery is exhausted, or the battery polarity is reversed.</li><li>B. The remote control is in the water.</li><li>C. The remote control is broken.</li><li>D. The distance is too far.</li><li>E. Changed the new remote control does not match the toilet.</li></ul> | <ul style="list-style-type: none"><li>A. Please replace the battery, please insert the battery correctly.</li><li>B. Take out the battery in time and then dry it.</li><li>C. Contact the dealer for replacement.</li><li>D. Close to the Toilet, try again.</li><li>E. Reference remote control operation protection page 11</li></ul> |

### Warm air function

| Symptoms                            | Possible reason  | Recommended measures   |
|-------------------------------------|--|--|
| The heater stops working during use | In the current seat position, the sitting sensor cannot detect the user. | To change the sitting position, press the stop button first, then press the drying button. |

### Seat heating

| Symptoms            | Possible reason   | Recommended measures  |
|---------------------|---|---|
| The seat is not hot | <ul style="list-style-type: none"><li>A. The heated seat has not been opened.</li><li>B. The heating has started, because the power is small, and the heating time is longer.</li><li>C. The heated seat is broken.</li></ul> | <ul style="list-style-type: none"><li>A. Refer to the seat heating function on the button or refer to the seat heating function of the remote control.</li><li>B. Wait for a while, then test.</li><li>C. Contact dealer for replacement or repair.</li></ul> |

### Night light

| Symptoms                     | Possible reason  | Recommended measures   |
|------------------------------|--|--|
| Night light not lighting up. | <ul style="list-style-type: none"><li>A. Night light function is not turned on.</li><li>B. Night light is broken</li></ul> | <ul style="list-style-type: none"><li>A. Please refer to the night light function on the button or the night light function of the reference remote control.</li><li>B. Contact the dealer for replacement or repair</li></ul> |

### Water temperature

| Symptoms                     | Possible reason   | Recommended measures  |
|------------------------------|---|---|
| The nozzle sprays cold water | <ul style="list-style-type: none"><li>A. Flush water temperature grade is not adjusted.</li><li>B. Heater is broken</li></ul> | <ul style="list-style-type: none"><li>A. Please refer to the water temperature adjustment of the remote control</li><li>B. Contact supplier for replacement or repair</li></ul> |

## Size

Dimension drawing of floor mounted toilet installation

