

Please follow these fixing and care instructions to ensure that your product is fitted safely and that it retains its high quality finish. Please retain this leaflet for future reference.

This instruction leaflet applies to the following products:

AD115144 Fineline Rod System

## 4 way system

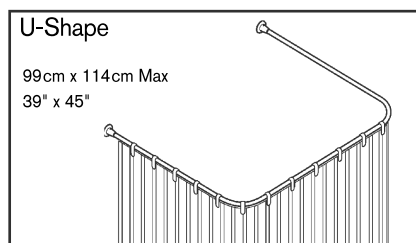

3 rods  
2 90° bends  
4 straight joints  
2 wall brackets  
2 ceiling support brackets  
2 ceiling support rods  
2 ceiling support rod inserts

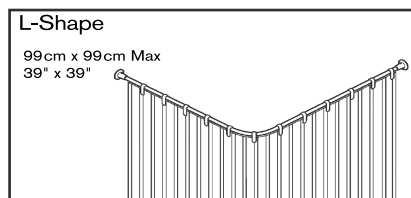

2 rods  
1 90° bend  
2 straight joints  
2 wall brackets  
1 ceiling support bracket  
1 ceiling support rod  
1 ceiling support rod insert

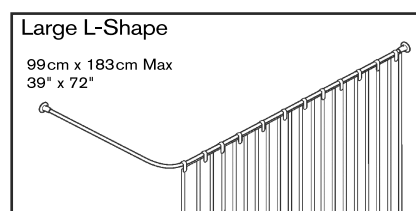

3 rods  
1 90° bend  
3 straight joints  
2 wall brackets  
2 ceiling support brackets  
2 ceiling support rods  
2 ceiling support rod inserts

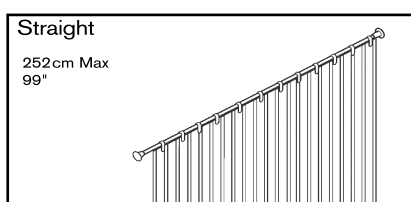

3 rods  
2 straight joints  
2 wall brackets  
2 ceiling support brackets  
2 ceiling support rods  
2 ceiling support rod inserts

## Fixing Pack Contents

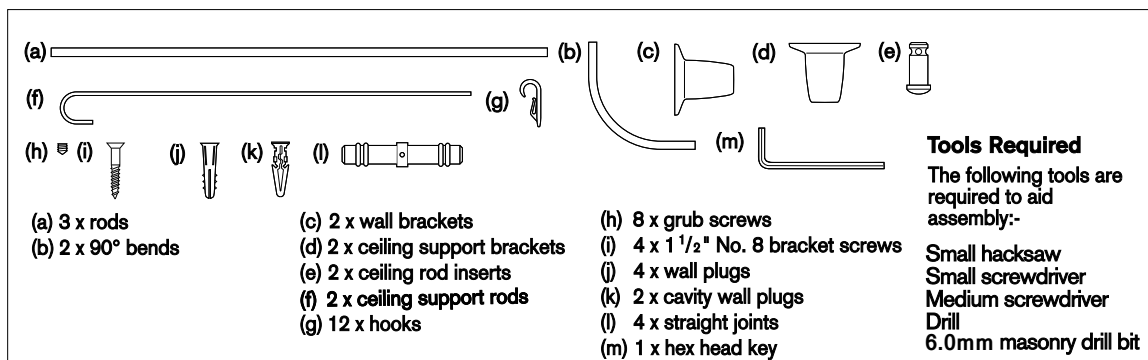

## KEEP DIY TOOLS OUT OF THE REACH OF CHILDREN

### Home Safety Advice

- It is recommended that two people fit the rod to ensure that it is fitted safely.
- Always take care when using an electric drill, particularly in the bathroom. Always check for hidden cables and pipework before drilling and take extreme care if there is any water in the working area.
- It is advisable to use a residual current circuit breaker (RCCB).
- Always wear suitable eye protection when drilling.
- If the product is to be fitted on a ceramic tiled wall, a ceramic drill bit should be used. Always ensure that the drill hole passes through the central tiled area rather than through the grouted area. To prevent surface damage to the tile, mask the area around the hole with tape before drilling.
- Do not strike the product with hard or sharp objects.
- Do not use this product as a grab rail.
- Do not overload the product.

**Note:** The wall plugs supplied are for use on solid walls only. For cavity walls or plasterboard use specialist fixings that are available from all good DIY stores.

## Assembly Instructions

The pack contents will assemble to make the four shapes illustrated and can be cut to size as required using a small hacksaw. Care should be taken to ensure that all rod ends are cut square and that rough edges are removed. You will need two people to mount this product.

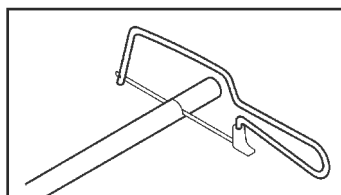

For straight version:  
Measure the distance between facing walls and cut assembled rods to length less 33mm. Slide one rod end into wall bracket, align opposite end and slide part way into facing bracket. Secure with grub screws.

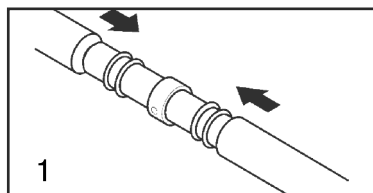

Start by laying out the components in desired configuration. Measure around bath or shower tray to determine exact dimensions and shape. Join rods together using straight joints tapping gently into place if required. When assembled cut to length. Rods can be cut to length before assembly but where possible cut wall bracket ends – not jointing ends.

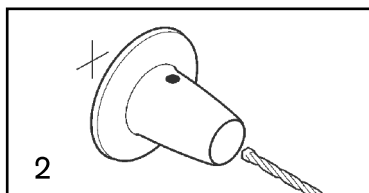

Measure drop of shower curtain to determine position of wall brackets (remember to allow for curtain hooks and enough overlap for bath or tray). Place the first wall bracket in position and use as a template to mark screw hole. Drill hole using a 6.0mm drill and insert wall plug. Fix wall bracket with screw provided. NB If product is to be fitted on a ceramic tiled wall, a ceramic drill bit should be used. \*

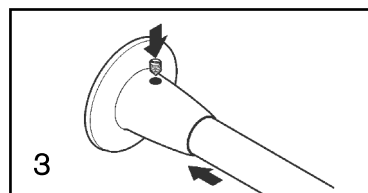

Using this wall bracket, insert the rod assembly and use it as a guide to check that the second wall bracket is positioned correctly - ensuring that the rail assembly is horizontal. Repeat the steps in paragraph two to attach the second bracket to the wall. Locate rod assembly in wall brackets and secure with grub screws – ensuring that the rod is supported by the second person.

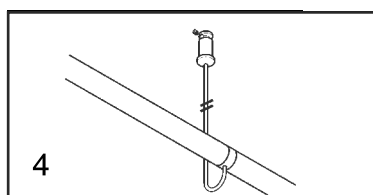

Position ceiling support rod U bends into appropriate straight joints, measure and cut to length. Push ceiling support rod into ceiling rod insert and secure by tightening the grub screw on the ceiling rod insert.

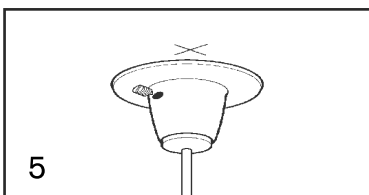

Ensure ceiling support rod is in vertical position and mark ceiling support bracket hole centre. Drill and screw bracket to ceiling either into ceiling joist or use cavity wall plug supplied. Locate the ceiling rod insert into the support bracket and secure by tightening the grub screw in the support bracket ensuring that the grub screw engages the recess on the ceiling rod insert.

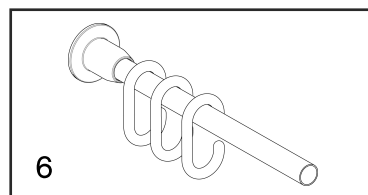

Fix hooks to curtain and clip them onto the assembled rod. Your finished rod system is now ready for use.

\* If fitting to a tiled surface, the wall plugs should be inserted below the surface of the tile.

This pack contains sufficient hooks to fit one standard shower curtain.

For details of the other items in the Croydex range please visit our website: [www.croydex.com](http://www.croydex.com)

Croydex, Central Way, Andover, Hampshire,  
SP10 5AW, UK

Tel: +44 (0) 1264 365881 Fax: +44 (0) 1264 356437  
E-mail: [info@croydex.co.uk](mailto:info@croydex.co.uk)