

Toilet Seat with Chrome Plated Metal Hinges

Please follow the fixing and care instructions to ensure your toilet seat is fitted safely and retains its high quality finish. Please retain this leaflet for future reference.

This installation guide applies to products fitted with chrome plated metal hinges.

499269	GLITTER BLACK RESIN TOILET SEAT
454127	GLITTER WHITE RESIN TOILET SEAT
454129	GLITTER BLUE RESIN TOILET SEAT
690830	GLITTER SILVER RESIN TOILET SEAT
232020	SHELLS RESIN TOILET SEAT
284143	SANDSTONE MOULDED WOOD TOILET SEAT
454132	GRANITE MOULDED WOOD TOILET SEAT
284146	NAUTICAL MOULDED WOOD TOILET SEAT

Tools Required - Not Supplied

Hacksaw (Optional)

KEEP DIY TOOLS OUT OF THE REACH OF CHILDREN

Home Safety Advice

- Do not strike the product with hard or sharp objects.
- Do not stand on the lid or the seat.
- Avoid slamming the lid or the seat.

Product Care

- To retain the best quality finish, clean product with a soft cloth and a mild soap solution.
- Do not use abrasive or chemical cleaners as they may damage the surface of the toilet seat or hinges.
- Take care when cleaning the toilet pan with chemical cleaners. Avoid contact of the chemical cleaners with the toilet seat or hinges. Immediately rinse off any splashes to avoid damage or discolouration to the surface of the toilet seat and hinge parts.

Fixing Pack Contents (Not to scale)

A - Main Seat Washer x 2

B - Metal Washer x 2

C - Tapered Plastic Washer x 2

D - Fixing Nut x 2

E - Spanner x 1

F - Hex Key x 1

G - Fixing Bolt x 2

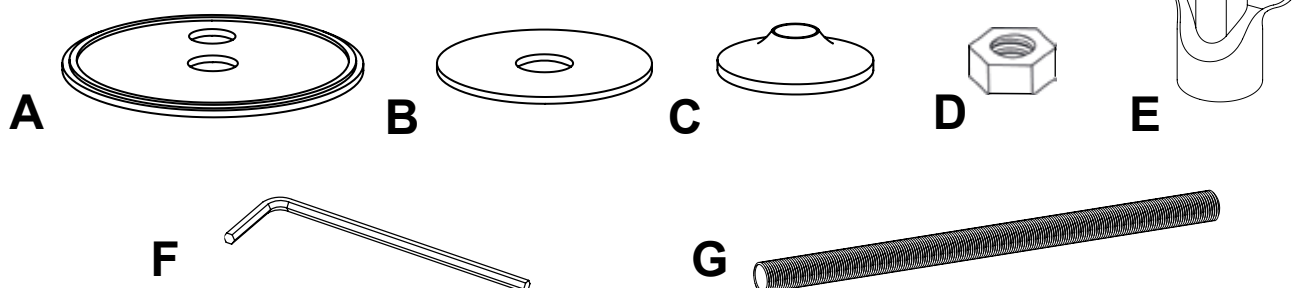

Toilet seat fitting guide

1. Position the toilet seat on the toilet bowl to check the fit.
2. Before fitting the seat to the pan it is essential that the hinges are adjusted correctly and the locking screws are firmly tightened. Failure to tighten these screws will result in the hinges working loose over a period of time.
3. The seat can be adjusted in 3 ways to fit the pan: (See Fig.1)
 - By loosening the locking screw using the Hex Key (G), the hinge plate can be rotated to adjust the distance between the fixing bolts.
 - By locating the fixing bolt into one of the 2 threaded holes in the hinge plate, it is possible to adjust the forward/backward position of the seat.
 - It is possible to get larger adjustment of the forward/ backward position by rotating the hinge plates through 180°.
4. Having adjusted the hinge make sure the locking screws are tight using the Hex Key (G).
5. Place the main seat washers on to the hinge plates, and feed the fixing bolts through the holes in the toilet pan.
6. Fit the tapered plastic washer, metal washer and fixing nut as shown in Fig 2.
7. Secure the fixing nuts very firmly using the spanner supplied. Care must be taken not to over tighten the nuts as this could result in damage to the toilet pan.
8. After a few days use, check the nuts are still tight. This is necessary as the main seat washers will compress during the first few days.

FIG 1

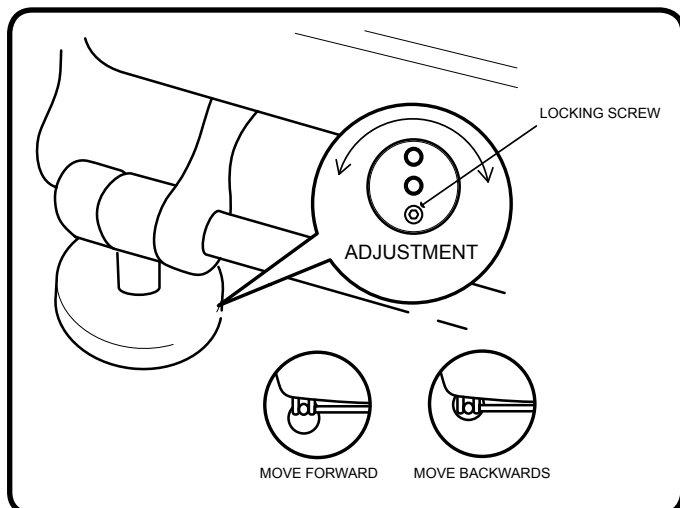
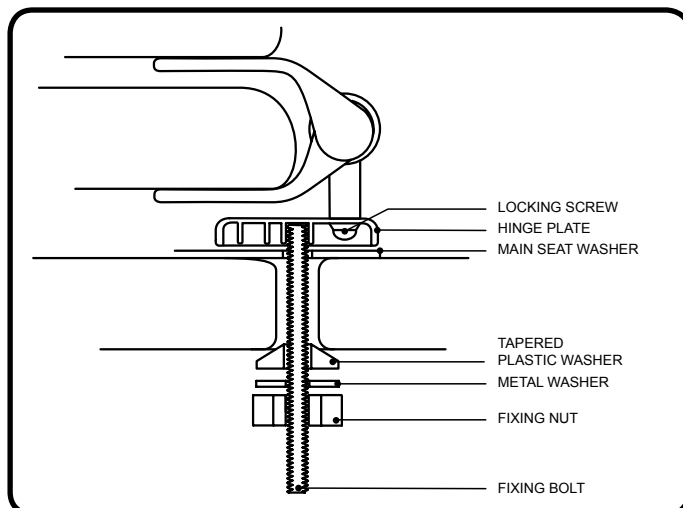

FIG 2



Homebase Ltd
 489-499 Avebury Boulevard
 Milton Keynes
 MK9 2NW