

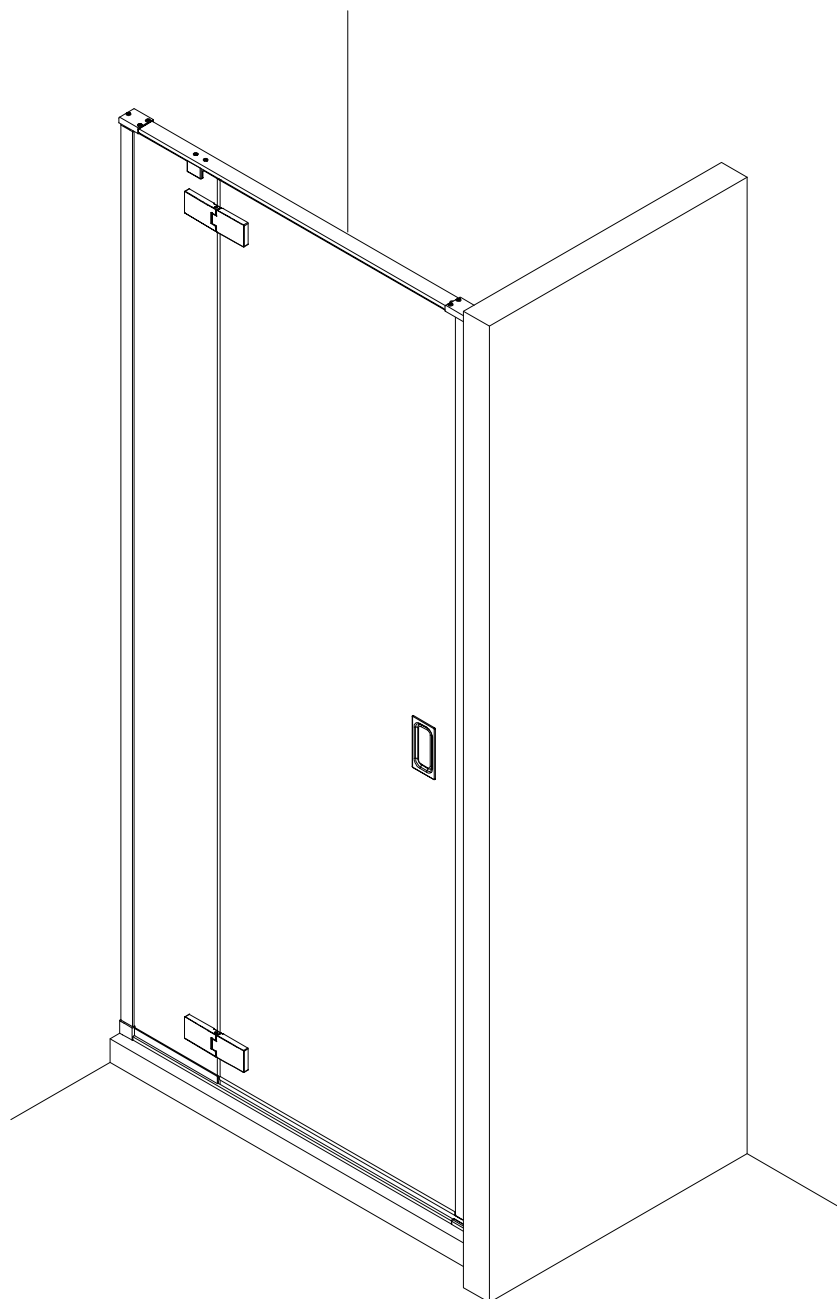

SVELTE HINGED DOOR

SHDSC0800
SHDSC0900
SHDSC1000
SHDSC1200



INSTALLATION INSTRUCTIONS

crosswater [®]
SHOWERING

IMPORTANT - Please read before installation

Please read these instructions carefully before starting installation and keep in a safe place for future reference.

Check the contents of the pack carefully before installation. Simpsons will not be held responsible for any de-fit / re-fit costs where faulty product has been fitted.

If any fault is found with materials or workmanship, it must be reported immediately to the manufacturer. Remedial action will be taken, based on information received, on condition that:

1. Full details are supplied to the manufacturer;
2. The enclosure has not been modified or tampered with;
3. The manufacturer is informed of any damage/shortages prior to installation.

We do not accept responsibility for any problems that may occur through incorrect installation.

The success of the installation and operation of any shower enclosure is, of course, dependant on the squareness, alignment and construction of the walls to which fixing is to be carried out.

VERY IMPORTANT

You must complete all tiling and grouting, and the shower tray **MUST** be level and fully sealed to the tiles before installation. If you do not fit the enclosure onto a tiled surface, or seal the tiles to the tray before installation, water may soak into the wall behind the wall profiles.

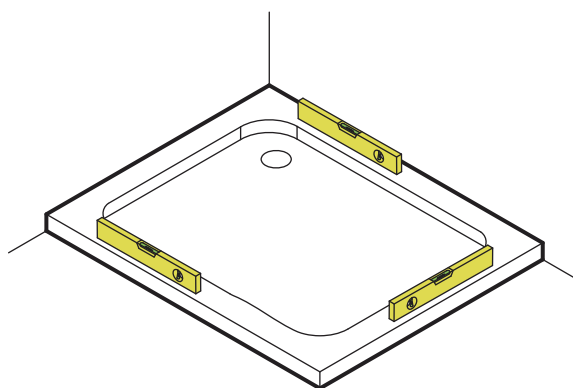

INSTALLATION - Advice and safety

The installation instructions are based on typical use and conditions.

These products come with the two wall channels pushed onto each side of the glass panel frame.

These hints have been prepared for your guidance, you must exercise due care at all times.

For Health and Safety 2 people must carry out the installation of this enclosure.

Handle glass with care. Although the glass supplied is toughened safety glass (EN12150), impacts can damage both the glass and the frame.

Warning!

Please check for any hidden pipes or cables before drilling holes in the wall.

To stop the drill bit slipping, masking tape can be applied to the tiles when preparing the holes.

When using power tools always follow the manufacturers user instructions.

Do not sit the enclosure on a bed of silicone, as this will also stop any water from draining back into the tray.

If the enclosure is sealed to the tray on the inside, any water that may get into the framework will not be able to drain back into the tray, this may cause the enclosure to leak.

Leave the silicone sealant to dry for 24 hours before using the enclosure.

CARE AND CLEANING

Do not use solvents or abrasive material or chemicals to clean the enclosure.

Only clean using soapy water and a soft cloth, rinse thoroughly afterwards.

INSTALLATION

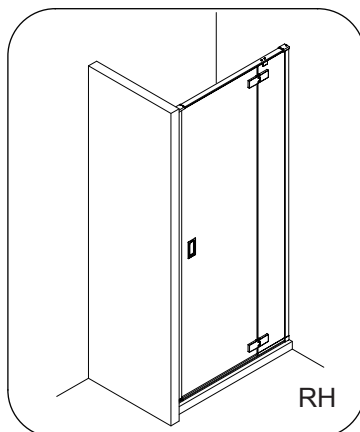
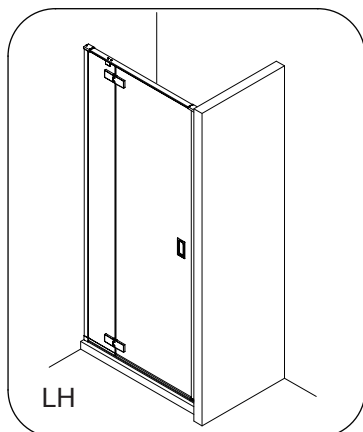

CONTENTS

SVELTE HINGED DOOR

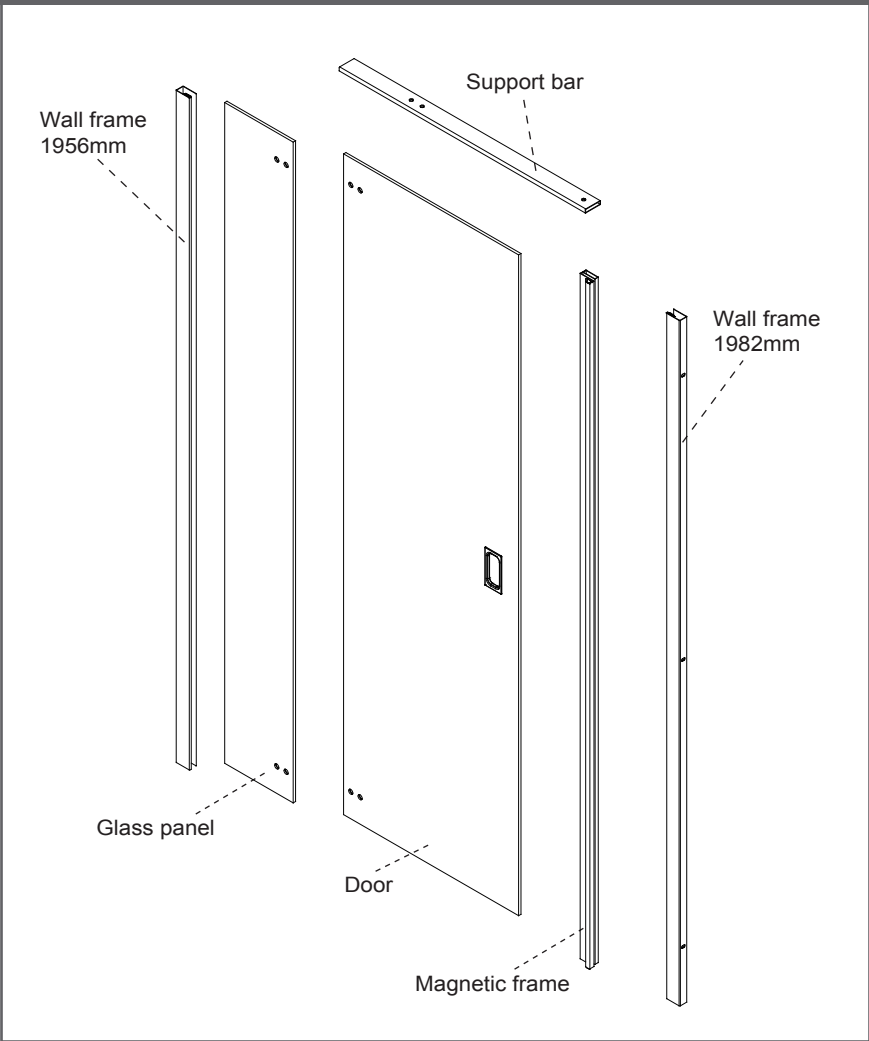

A  ST4X40mm Screw x 3

G  M4X12mm Screw x 2

B  Wall Plug x 10

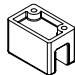
H  Glass clamp assembly x 1

C  1954mm Wall frame sealing strip x 1

I  Cover x 2

D  Top Cap x 2

J  Cover for taper sleeve x 8

E  ST4X40mm Screw x 7

K  Hinge x 2

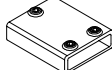
F  Cap x 2

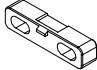
L  Bracket x 2

M  Magnetic strip x 1

N  1982mm Wall frame sealing strip x 1

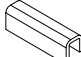
O  Bottom seat x 1

P  Waterproof barrier bar x 1

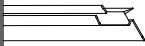
Q  Bottom waterproof strip x 1

R  Side waterproof strip x 1

S  Bottom profile x 1

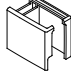
T  Bottom seat(LH) x1

U  Handle x 1

V  Alcohol Prep Pad x 1

W  Bottom seat(RH) x1

X  Positioning template x 1

Y  4mm Allen key x 1

Z  2.5mm Allen key x 1

Tools and equipment needed

Drill, 6mm Masonry drill bit, Cross Philips screwdriver, Slotted Philips screwdriver, Spirit level, Pencil, Tape measure, Knife, Silicone sealant, Wood,Rubber Mallet.

Step 1

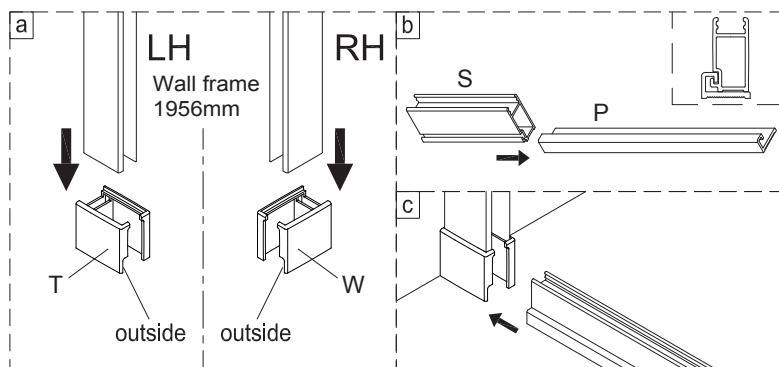

Model	A(mm)
SHDSC0800	770~795
SHDSC0900	870~895
SHDSC1000	970~995
SHDSC1200	1170~1195

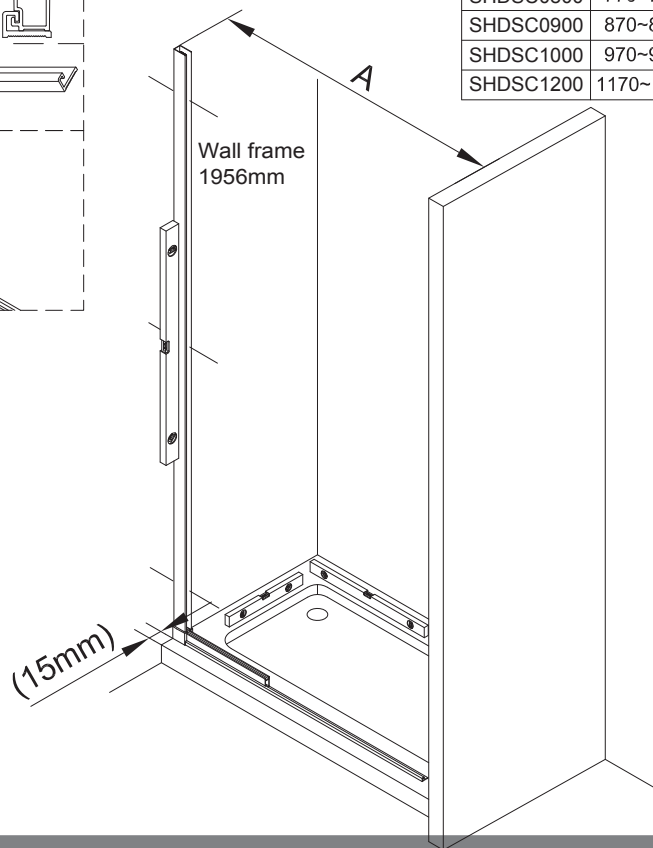
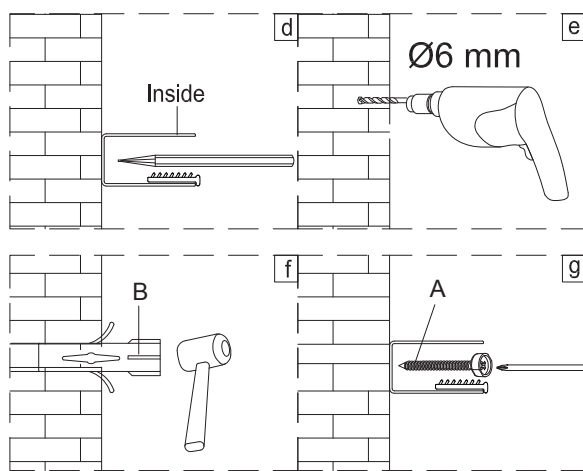

Step 2

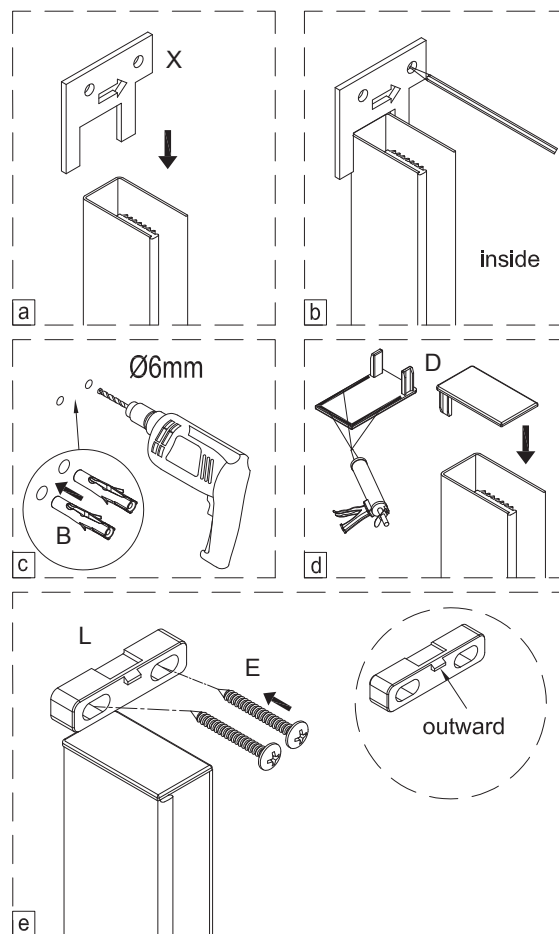
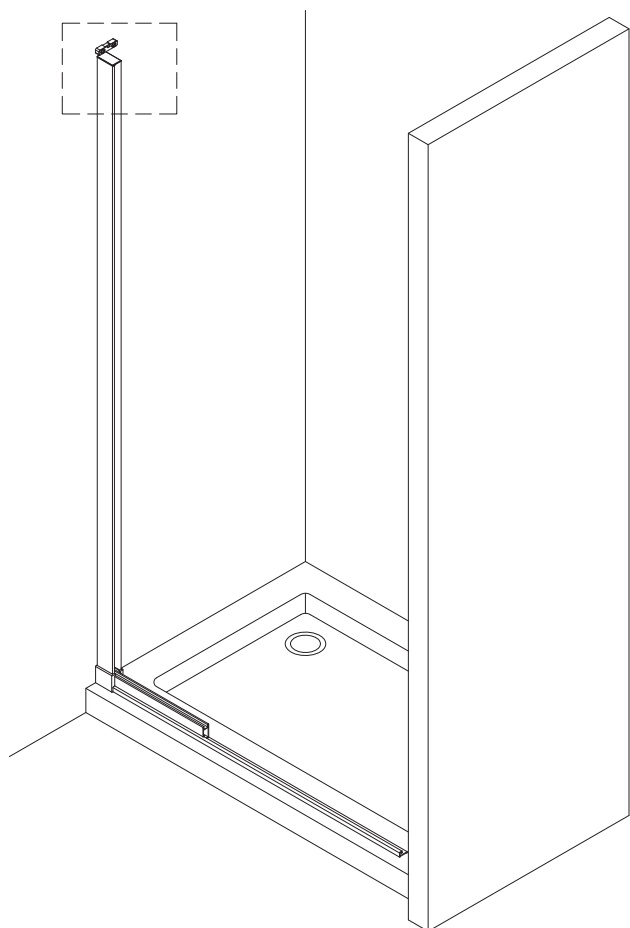

Step 3

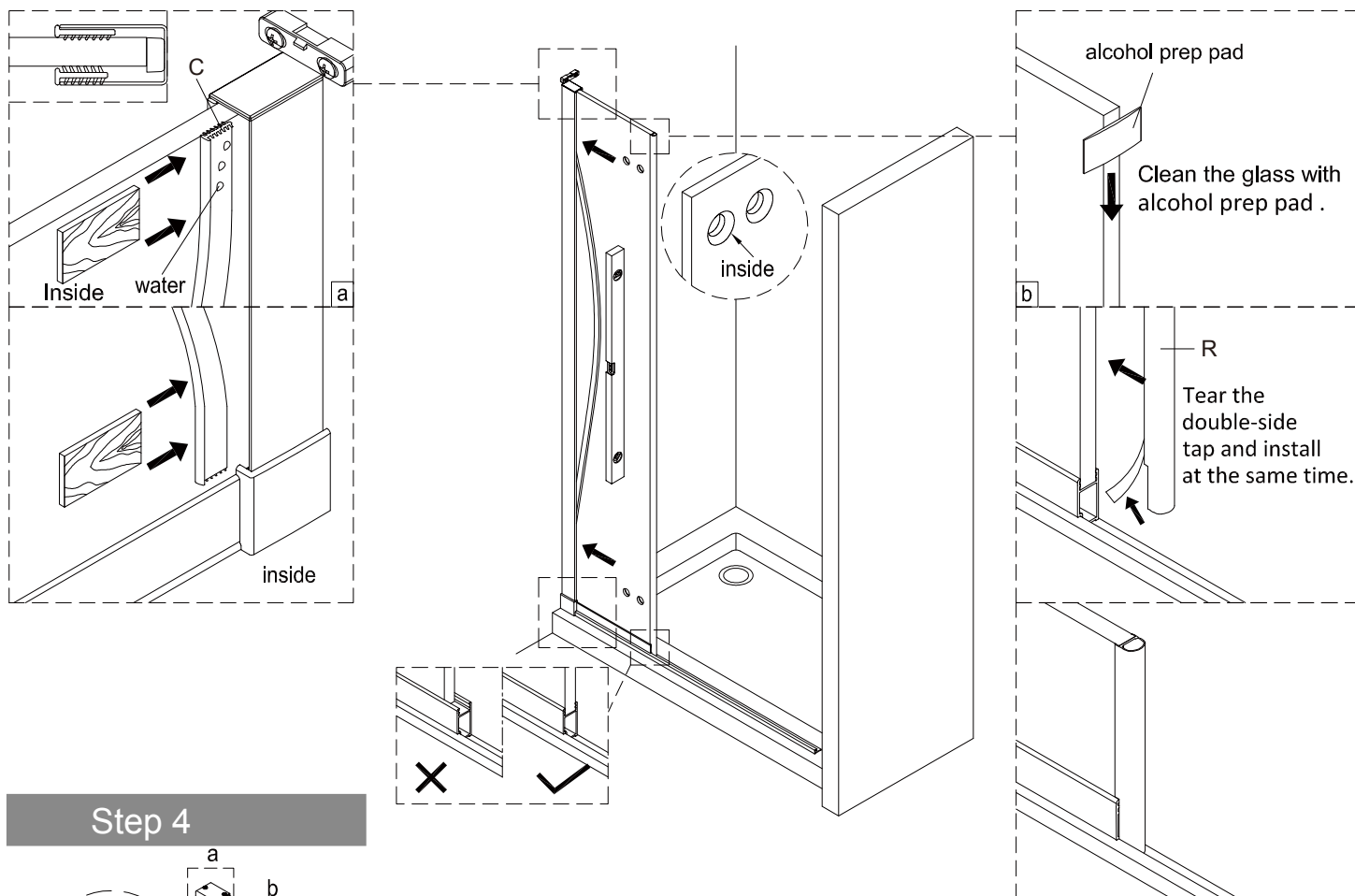

Step 4

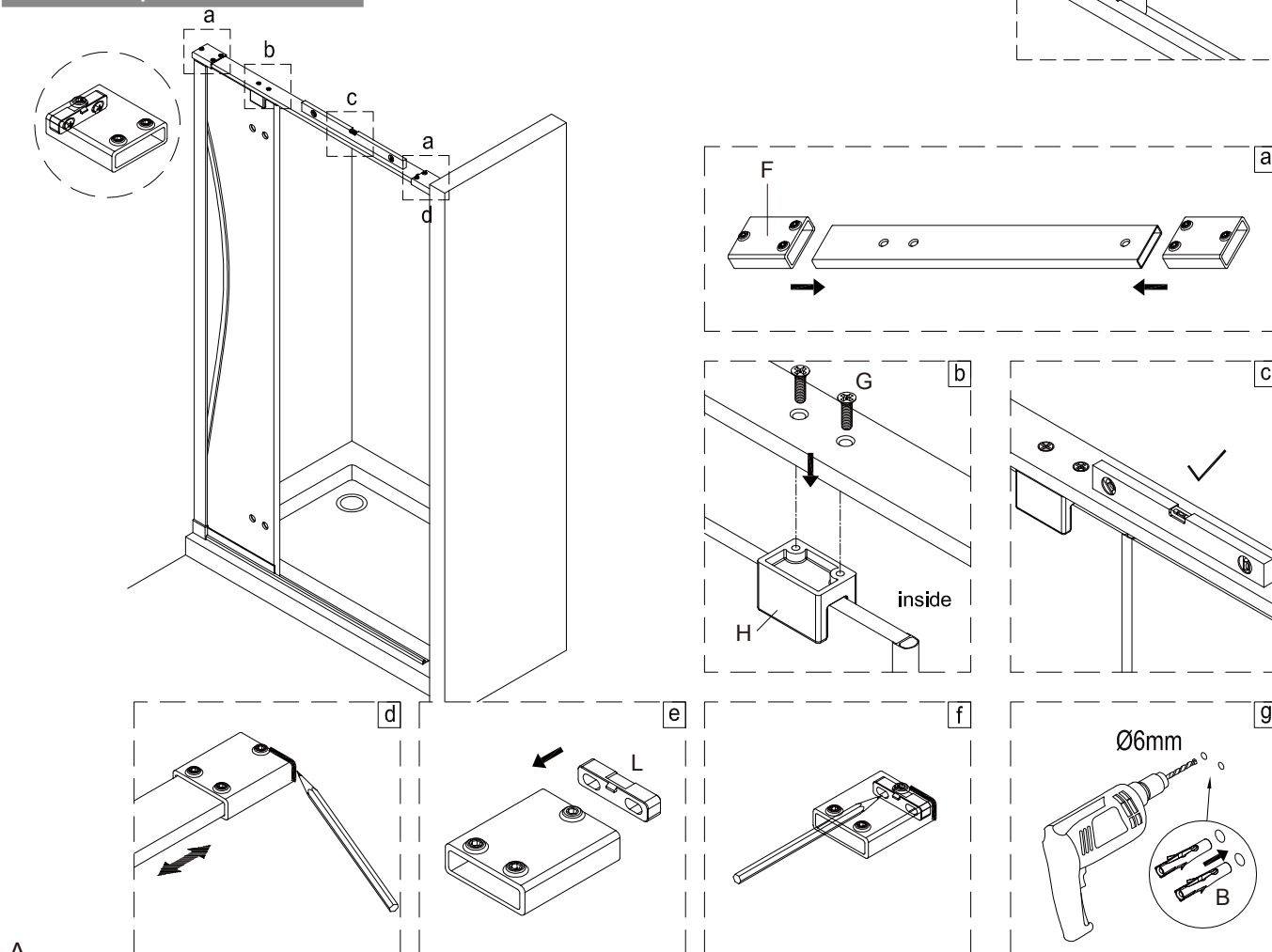

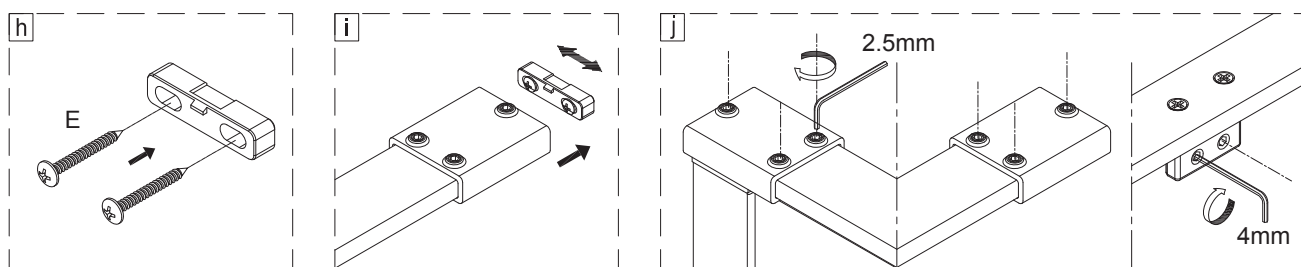

Step 5

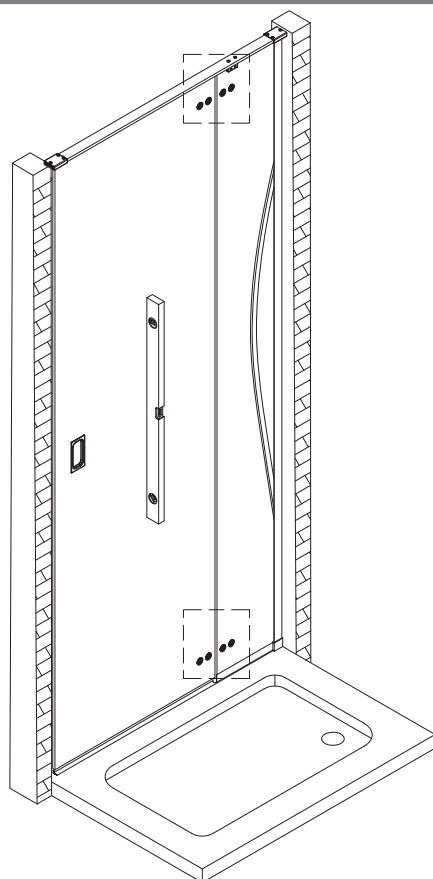

Tighten the screws .

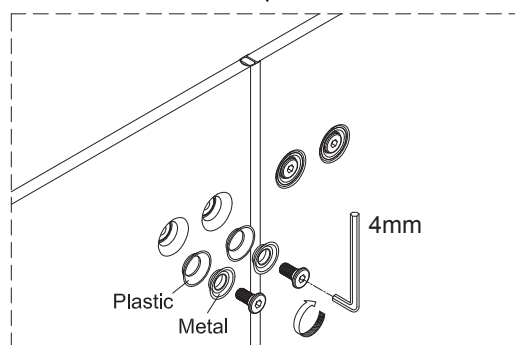
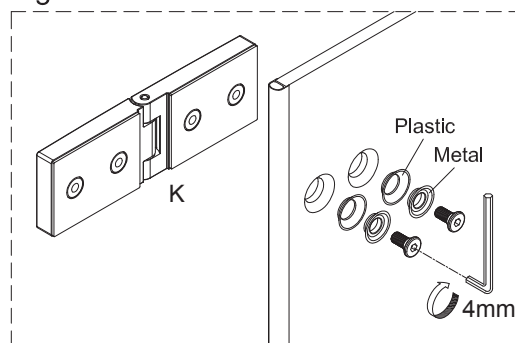

Step 6

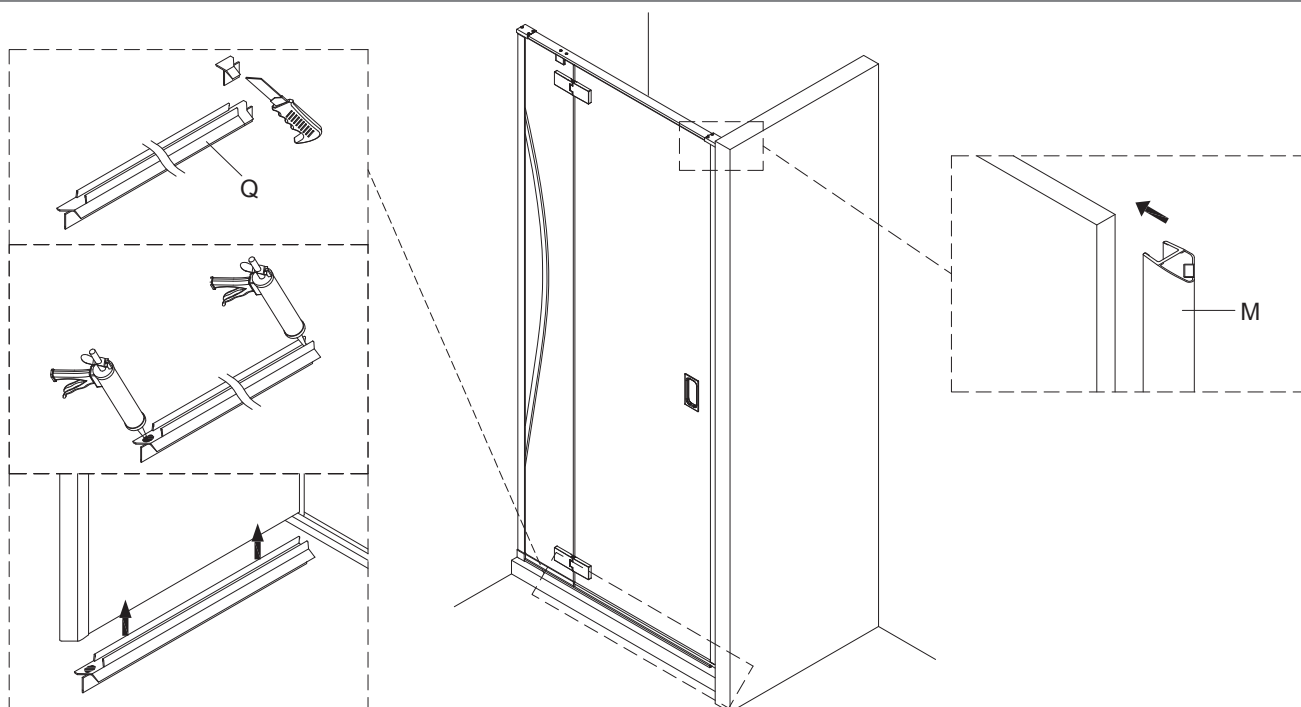

Step 7

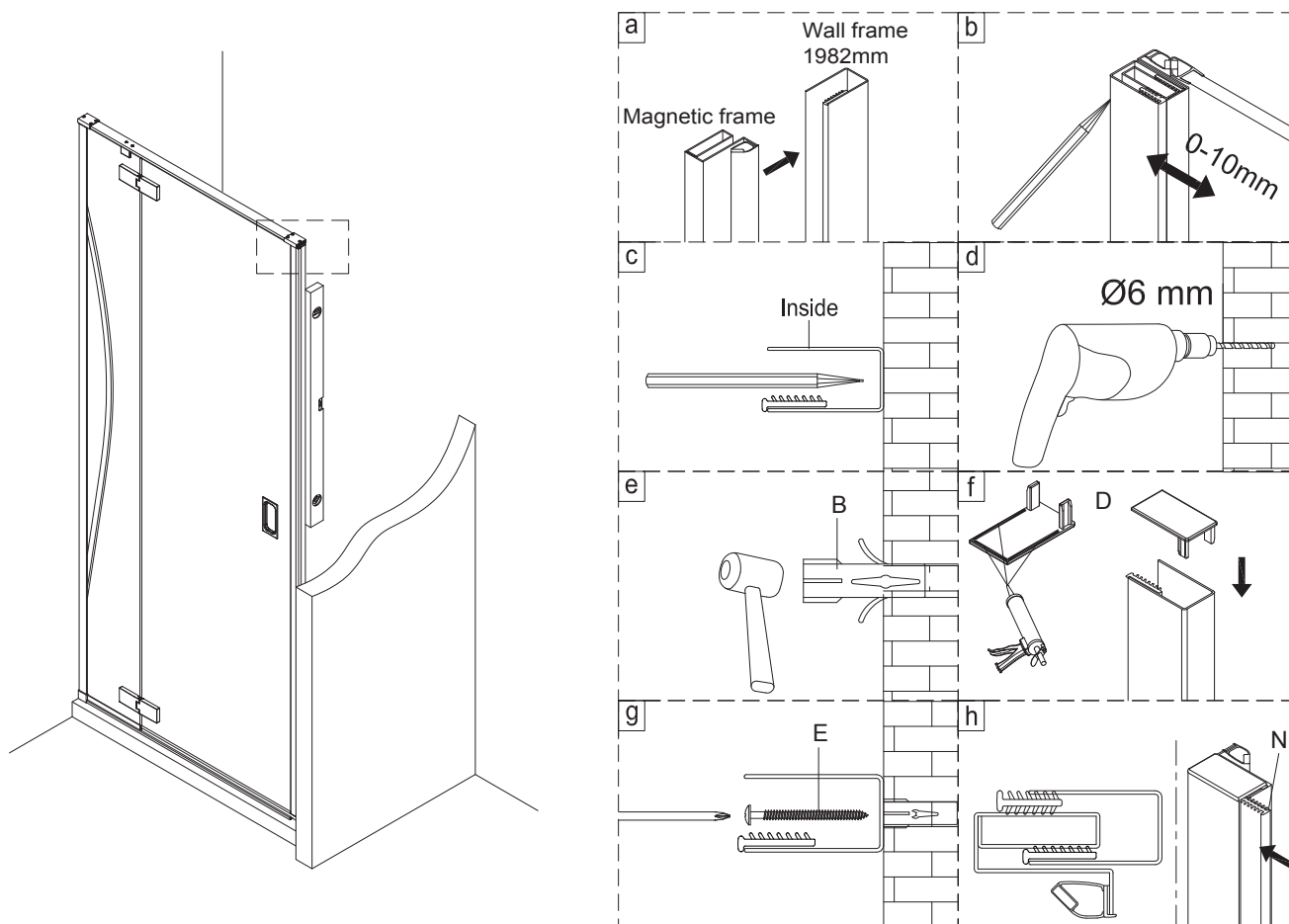

Step 8

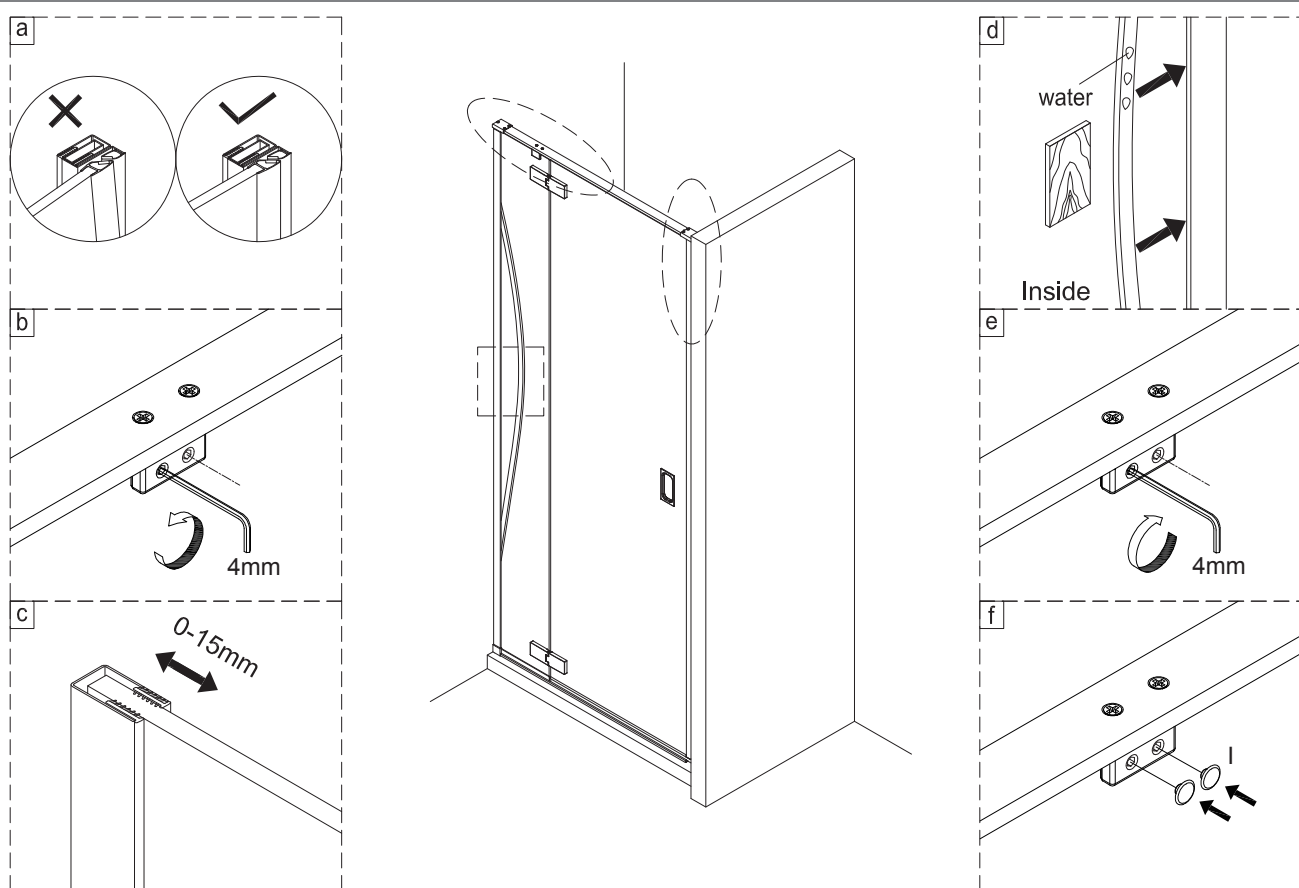

Step 9

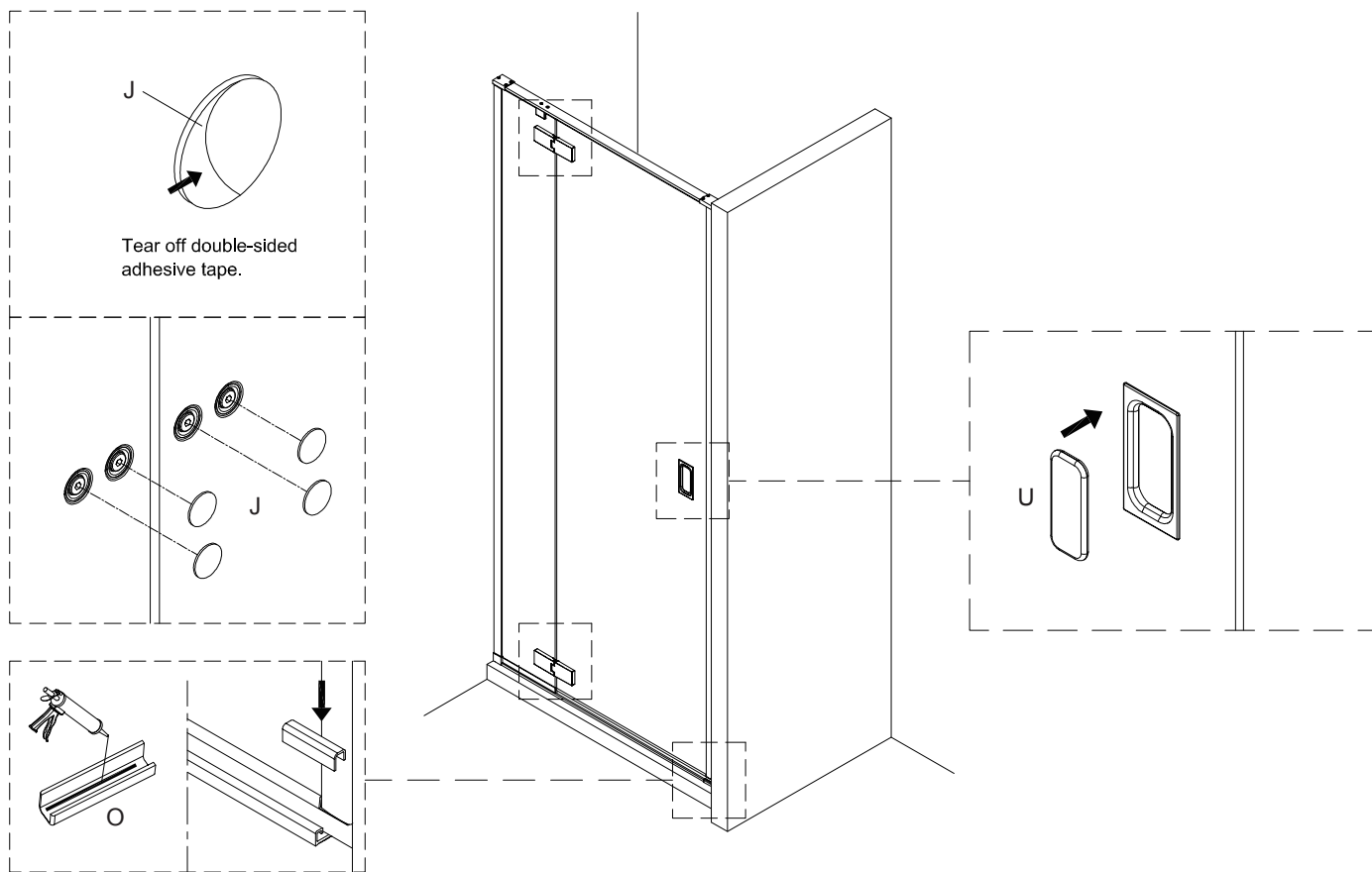

Step 10

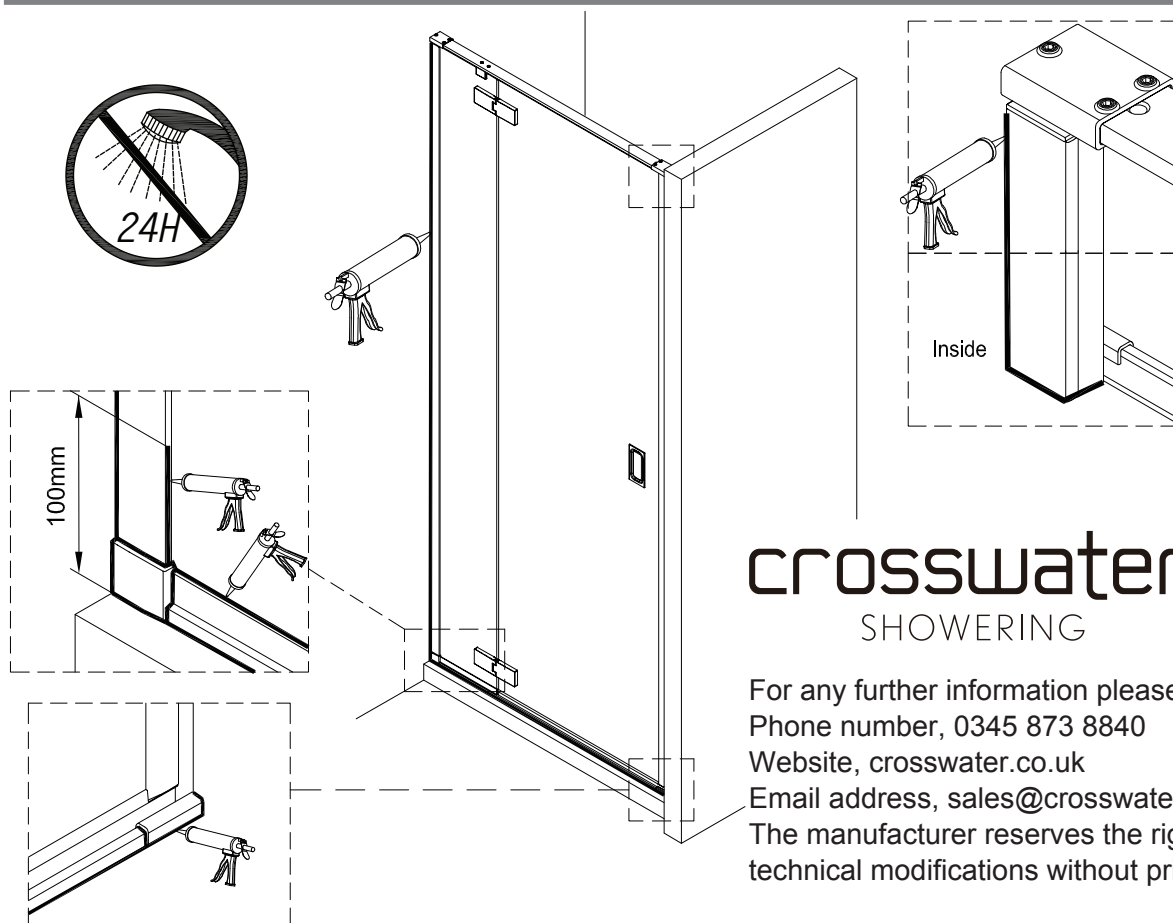

crosswater[®]
SHOWERING

For any further information please contact Crosswater
Phone number, 0345 873 8840
Website, crosswater.co.uk
Email address, sales@crosswater.co.uk
The manufacturer reserves the right to make technical modifications without prior notice.

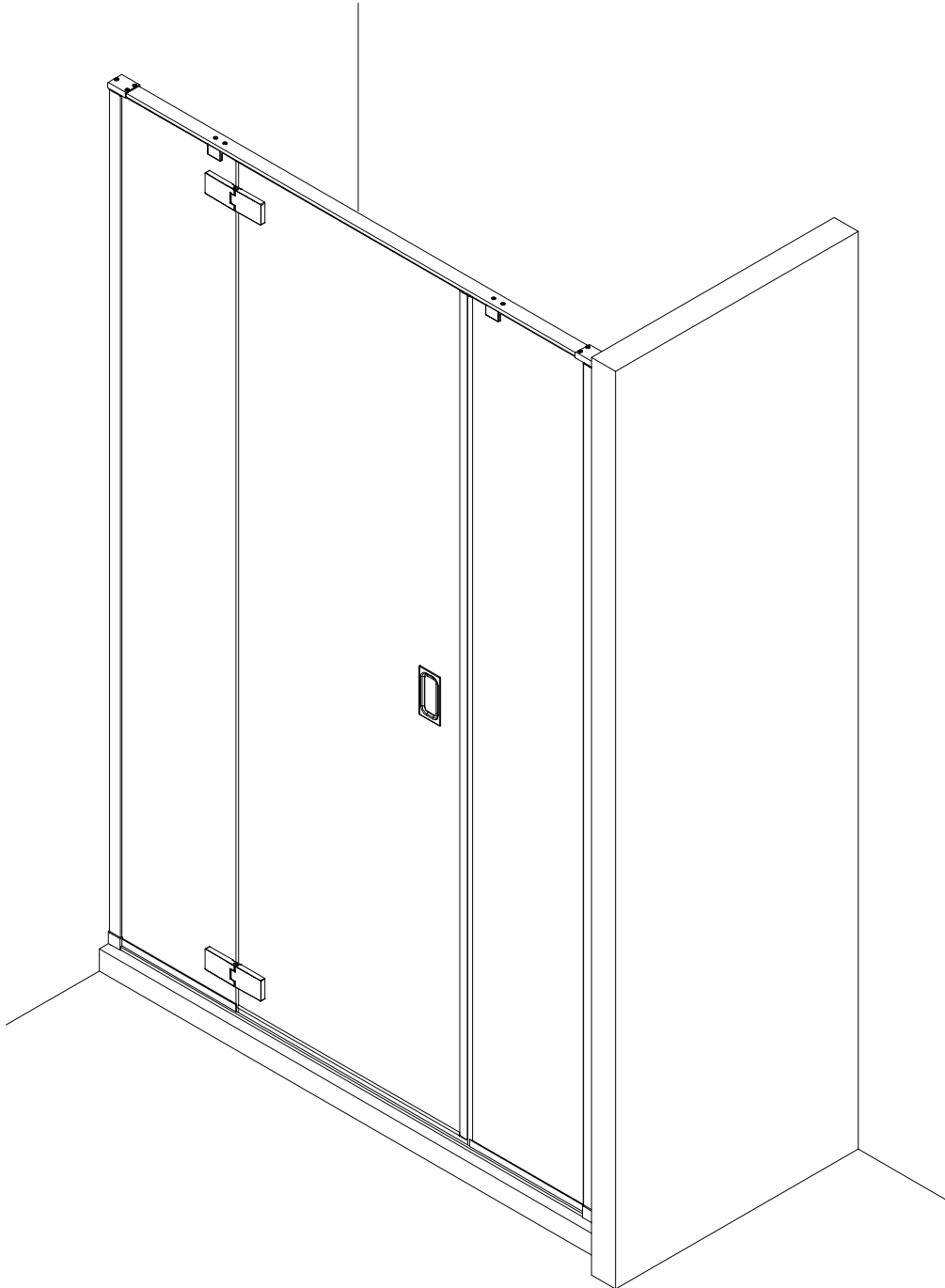

INSTALLATION INSTRUCTIONS

crosswater  [®]
SHOWERING

IMPORTANT - Please read before installation

Please read these instructions carefully before starting installation and keep in a safe place for future reference.

Check the contents of the pack carefully before installation. Simpsons will not be held responsible for any de-fit / re-fit costs where faulty product has been fitted.

If any fault is found with materials or workmanship, it must be reported immediately to the manufacturer. Remedial action will be taken, based on information received, on condition that:

1. Full details are supplied to the manufacturer;
2. The enclosure has not been modified or tampered with;
3. The manufacturer is informed of any damage/shortages prior to installation.

We do not accept responsibility for any problems that may occur through incorrect installation.

The success of the installation and operation of any shower enclosure is, of course, dependant on the squareness, alignment and construction of the walls to which fixing is to be carried out.

VERY IMPORTANT

You must complete all tiling and grouting, and the shower tray **MUST** be level and fully sealed to the tiles before installation. If you do not fit the enclosure onto a tiled surface, or seal the tiles to the tray before installation, water may soak into the wall behind the wall profiles.

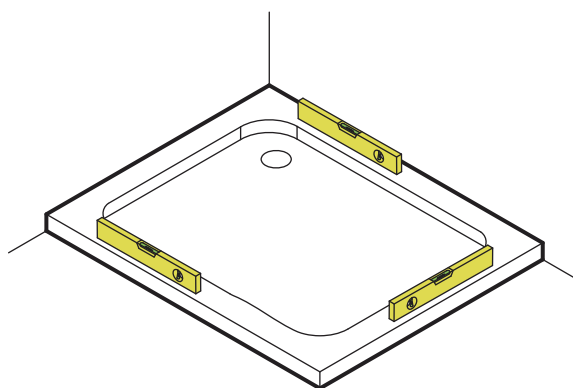

INSTALLATION - Advice and safety

The installation instructions are based on typical use and conditions.

These products come with the two wall channels pushed onto each side of the glass panel frame.

These hints have been prepared for your guidance, you must exercise due care at all times.

For Health and Safety 2 people must carry out the installation of this enclosure.

Handle glass with care. Although the glass supplied is toughened safety glass (EN12150), impacts can damage both the glass and the frame.

Warning!

Please check for any hidden pipes or cables before drilling holes in the wall.

To stop the drill bit slipping, masking tape can be applied to the tiles when preparing the holes.

When using power tools always follow the manufacturers user instructions.

Do not sit the enclosure on a bed of silicone, as this will also stop any water from draining back into the tray.

If the enclosure is sealed to the tray on the inside, any water that may get into the framework will not be able to drain back into the tray, this may cause the enclosure to leak.

Leave the silicone sealant to dry for 24 hours before using the enclosure.

CARE AND CLEANING

Do not use solvents or abrasive material or chemicals to clean the enclosure.

Only clean using soapy water and a soft cloth, rinse thoroughly afterwards.

INSTALLATION

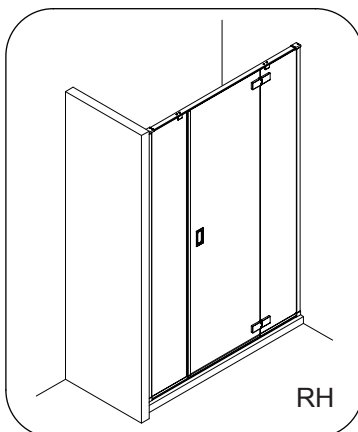
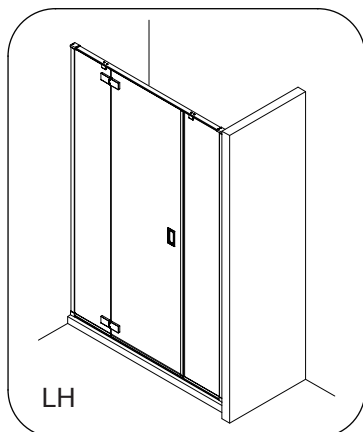

CONTENTS

SVELTE HINGED DOOR RECESS ONLY

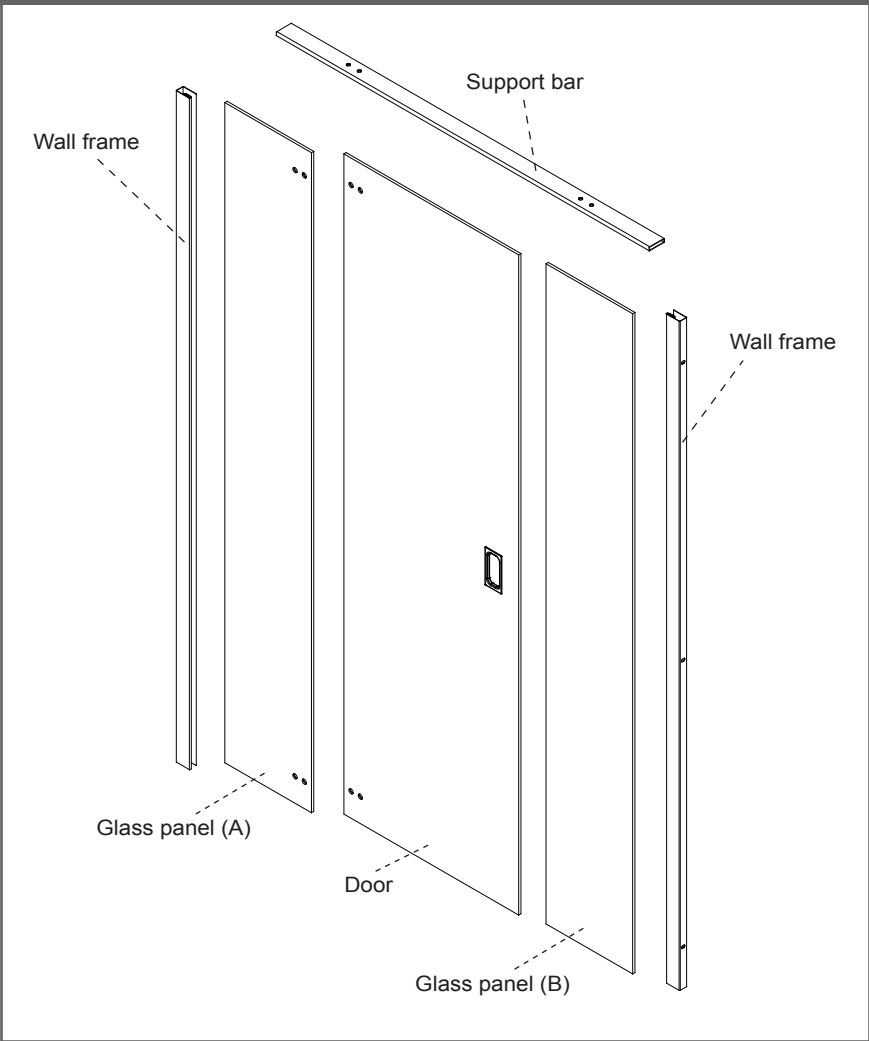

A



ST4X40mm Screw x 6

G



M4X12mm Screw x 4

B



Wall Plug x 10

H



Glass clamp assembly x 2

C



Wall frame sealing strip x 2

I



Cover x 4

D

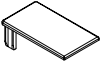

Top Cap x 2

J



Cover for taper sleeve x 8

E



ST4X40mm Screw x 4

K



Hinge x 2

F

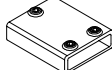

Cap x 2

L

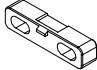

Bracket x 2

M



Magnetic strip x 1

N



Magnetic strip x 1

O



Bottom seat x 1

P



Bottom profile x 2

Q



Waterproof barrier bar x 1

R

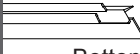

Bottom waterproof strip x 1

S



Side waterproof strip x 1

T

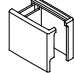

Bottom seat x 1

U



Handle x 1

V



Alcohol Prep Pad x 1

W



Positioning template x 1

X



4mm Allen key x 1

Y



2.5mm Allen key x 1

Tools and equipment needed

Drill, 6mm Masonry drill bit, Cross Philips screwdriver, Slotted Philips screwdriver, Spirit level, Pencil, Tape measure, Knife, Silicone sealant, Wood,Rubber Mallet.

Figure 1 illustrates the assembly sequence of the wall frame. (a) shows the initial assembly of the wall frame with components T and O. (b) shows the assembly of the wall frame with components P and Q. (c) shows the assembly of the wall frame with components P and Q.

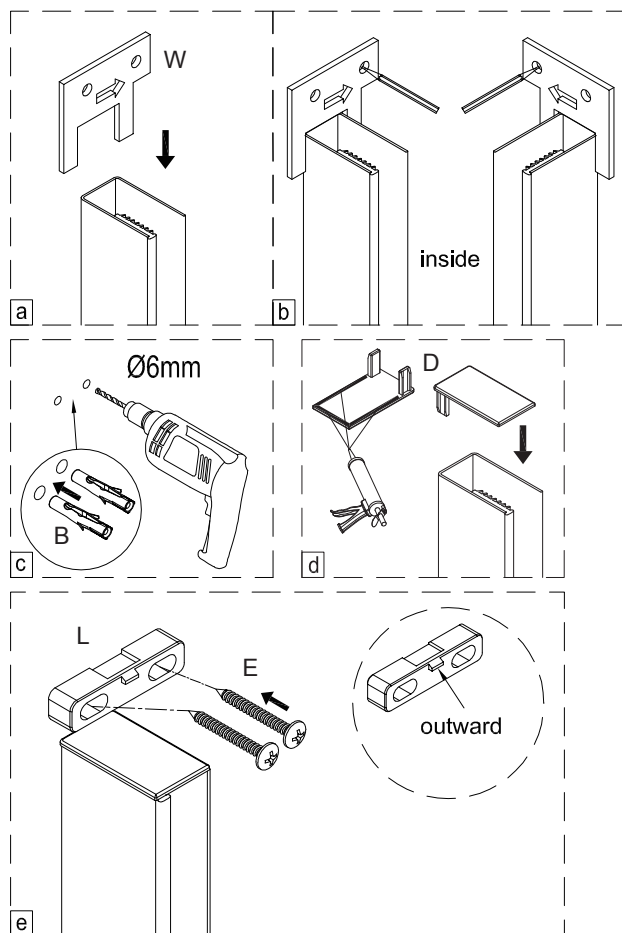
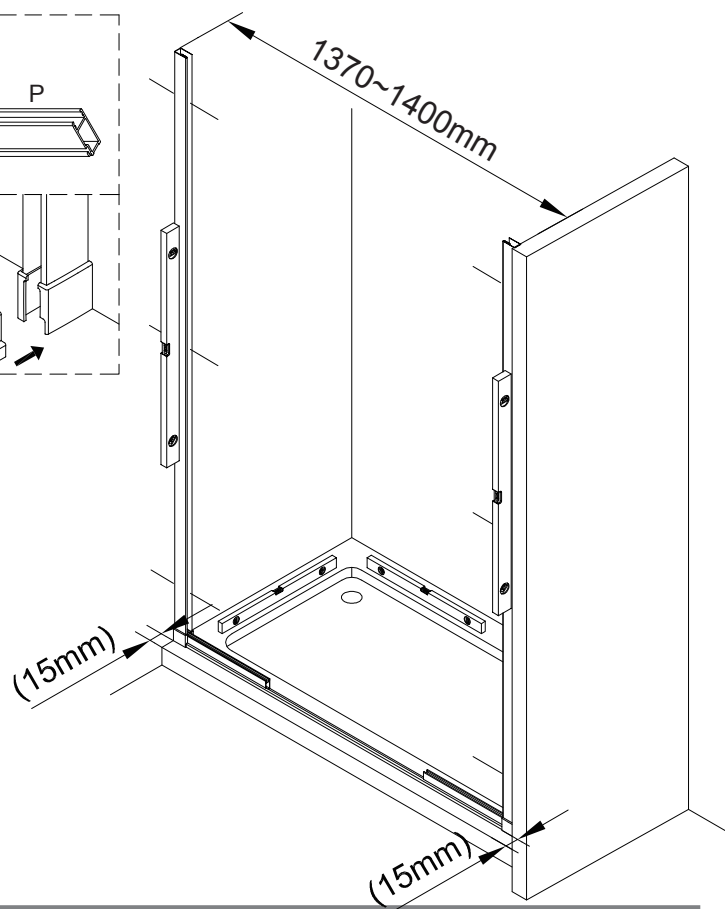
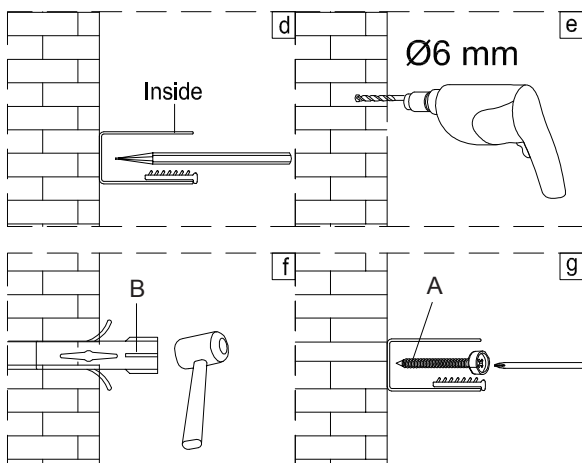

The diagram illustrates the correct and incorrect methods for installing a double-sided adhesive tape on a glass panel. It is divided into three main sections: (a), (b), and (c).

Section (a): Shows the correct method for applying the adhesive tape. The tape is applied to the inside of the glass panel. The label "Inside" is used to indicate the correct side. The label "water" is used to indicate the correct application of the adhesive. The label "C" is used to indicate the correct application of the adhesive.

Section (b): Shows the correct method for cleaning the glass. The label "alcohol prep pad" is used to indicate the correct cleaning method. The label "Clean the glass with alcohol prep pad ." is used to indicate the correct cleaning method.

Section (c): Shows the correct method for tearing the double-sided tape. The label "S" is used to indicate the correct tearing method. The label "Tear the double-side tap and install at the same time." is used to indicate the correct tearing method.

Section (d): Shows the correct method for installing the glass panel. The label "inside" is used to indicate the correct side. The label "X" is used to indicate the incorrect method. The label "✓" is used to indicate the correct method.

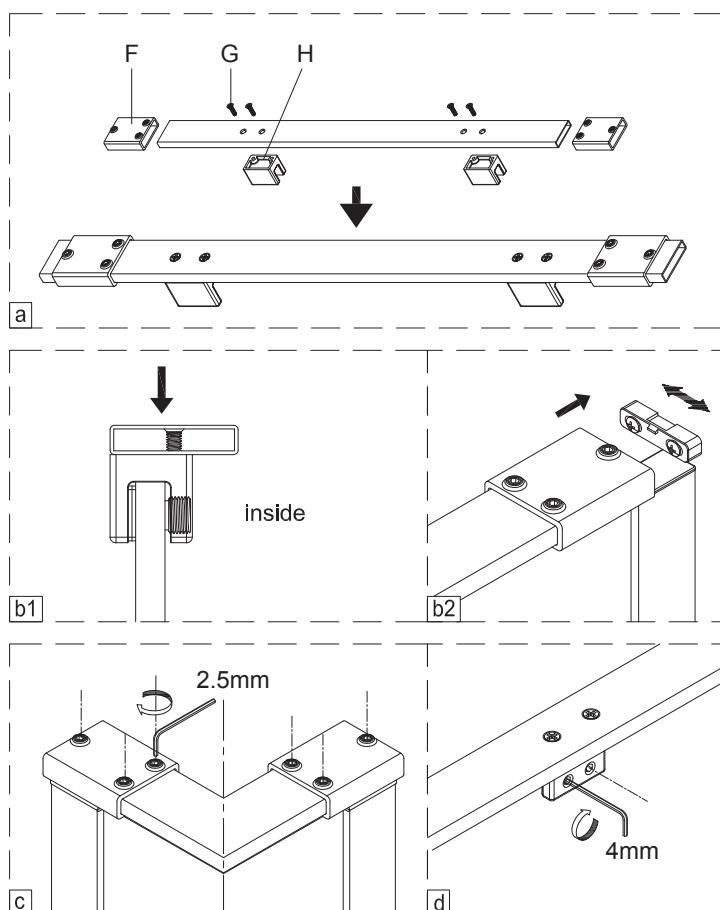

Step 5

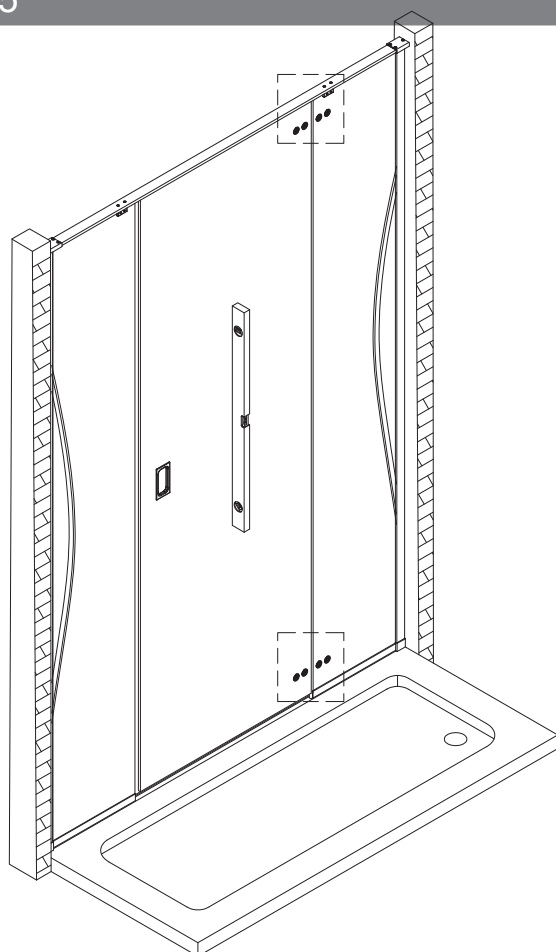

Tighten the screws .

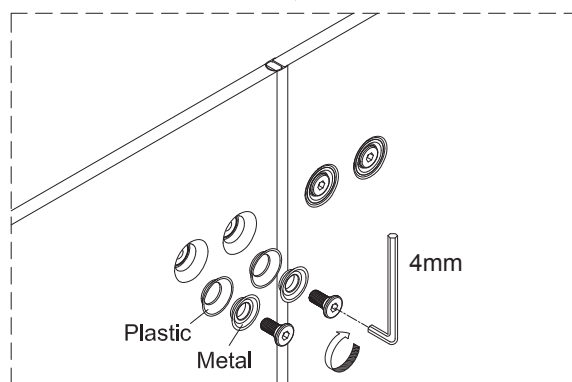
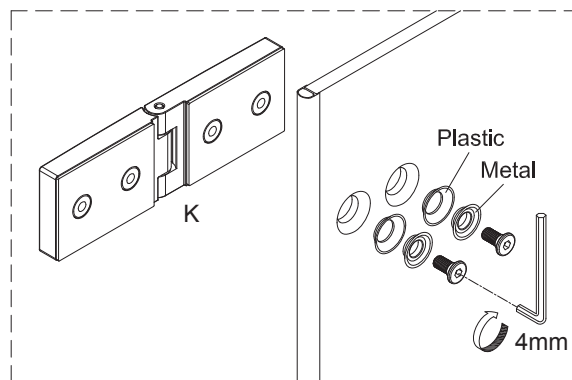

Step 6

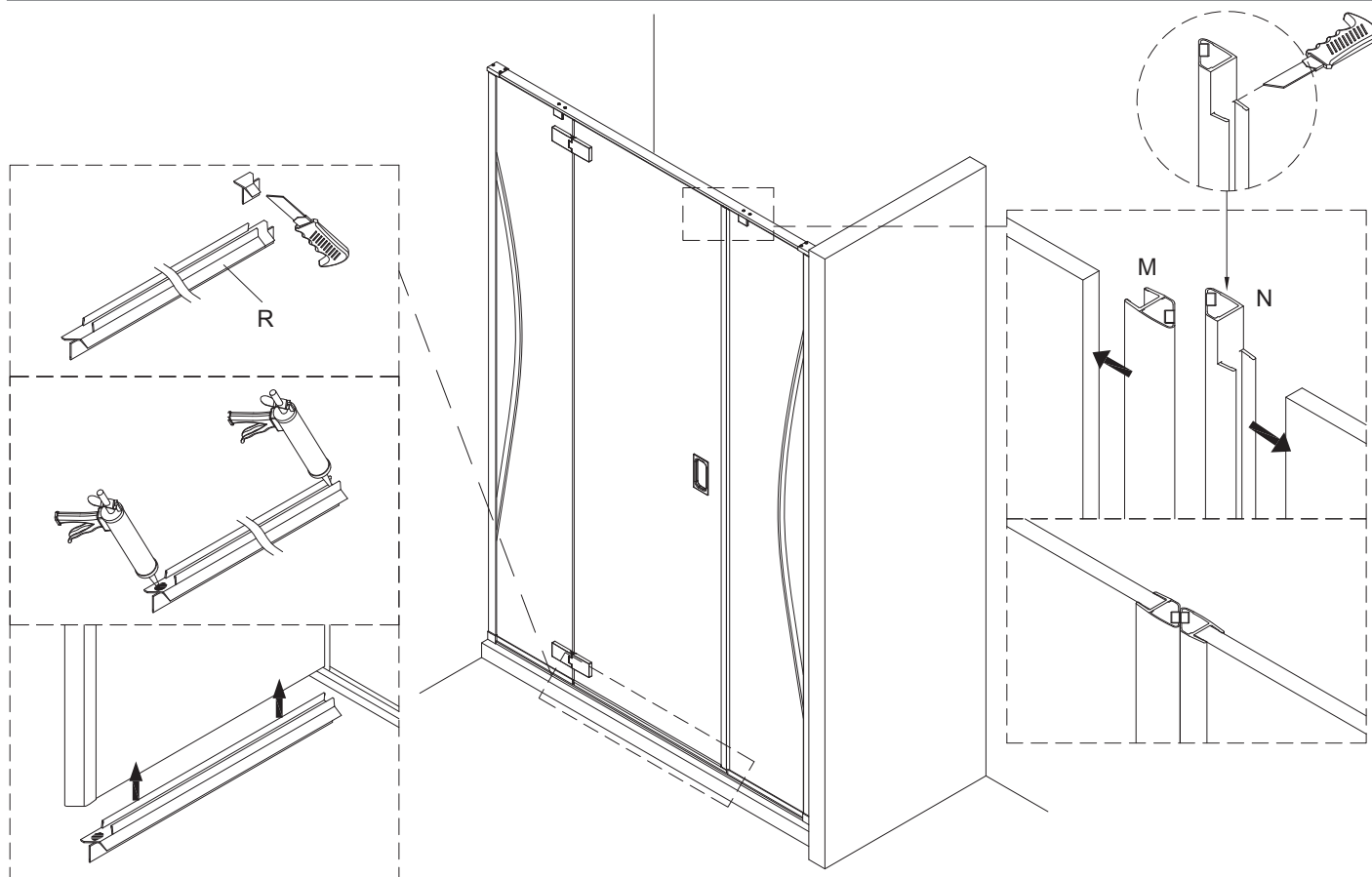

Step 7

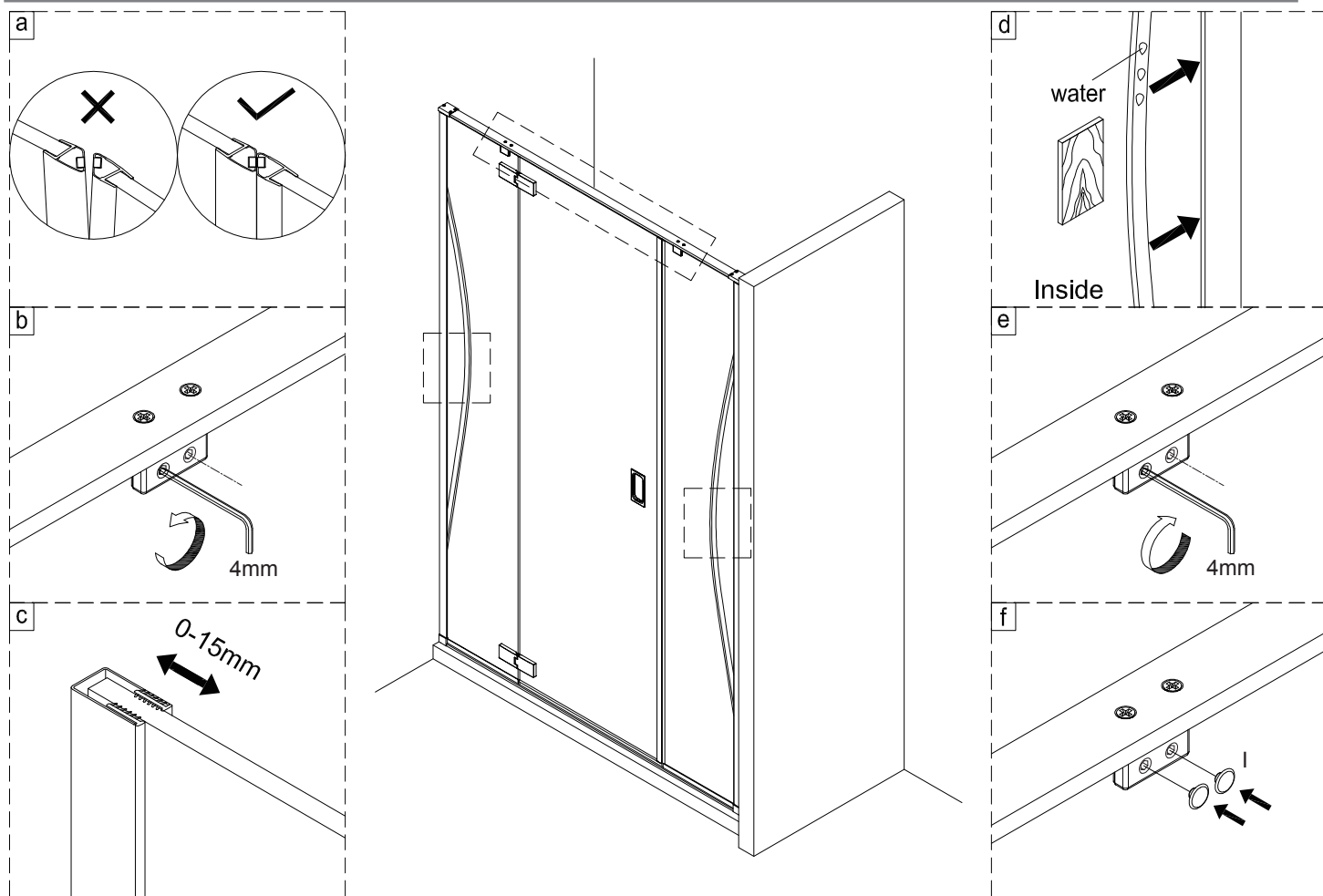

Step 8

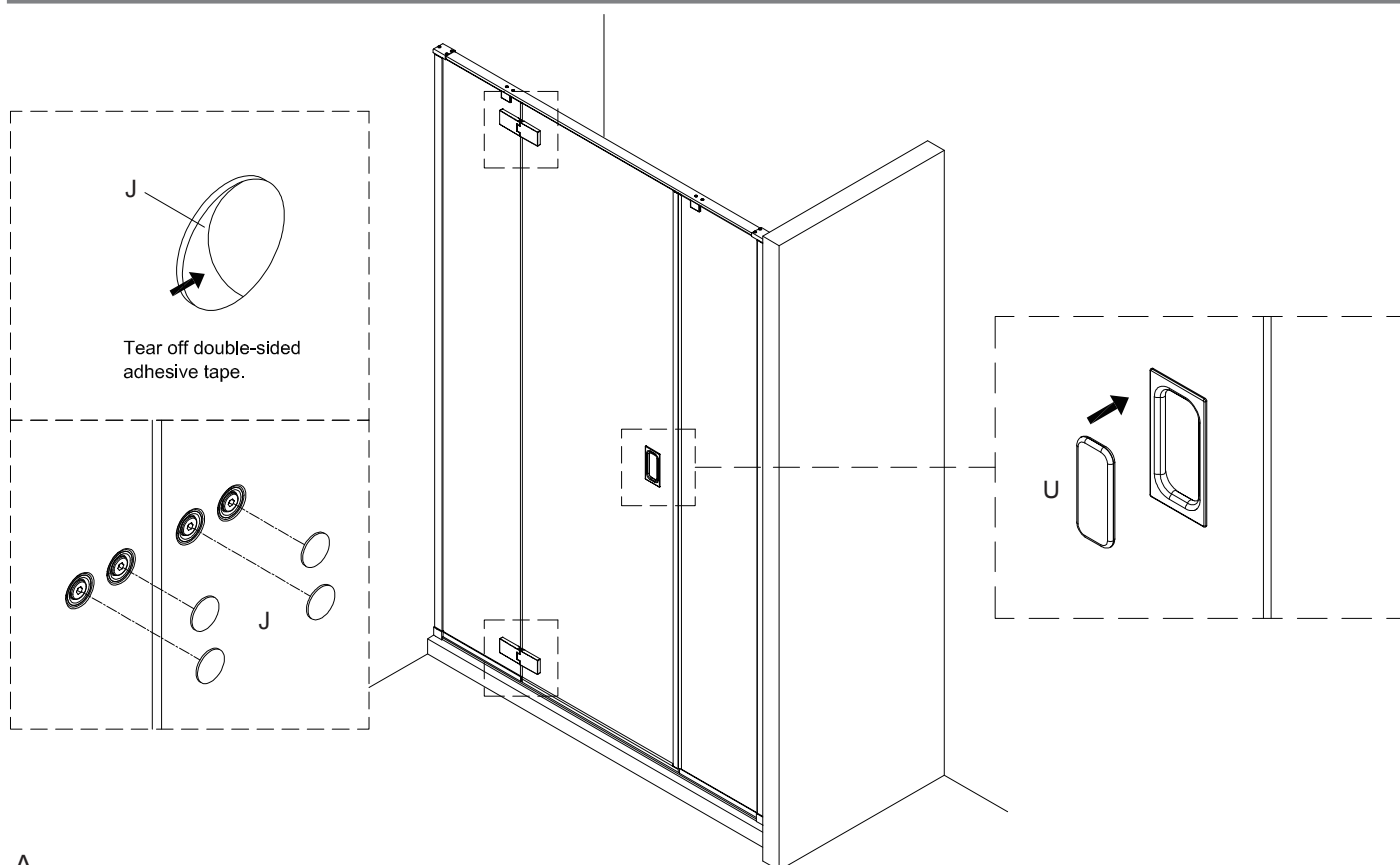

Step 9

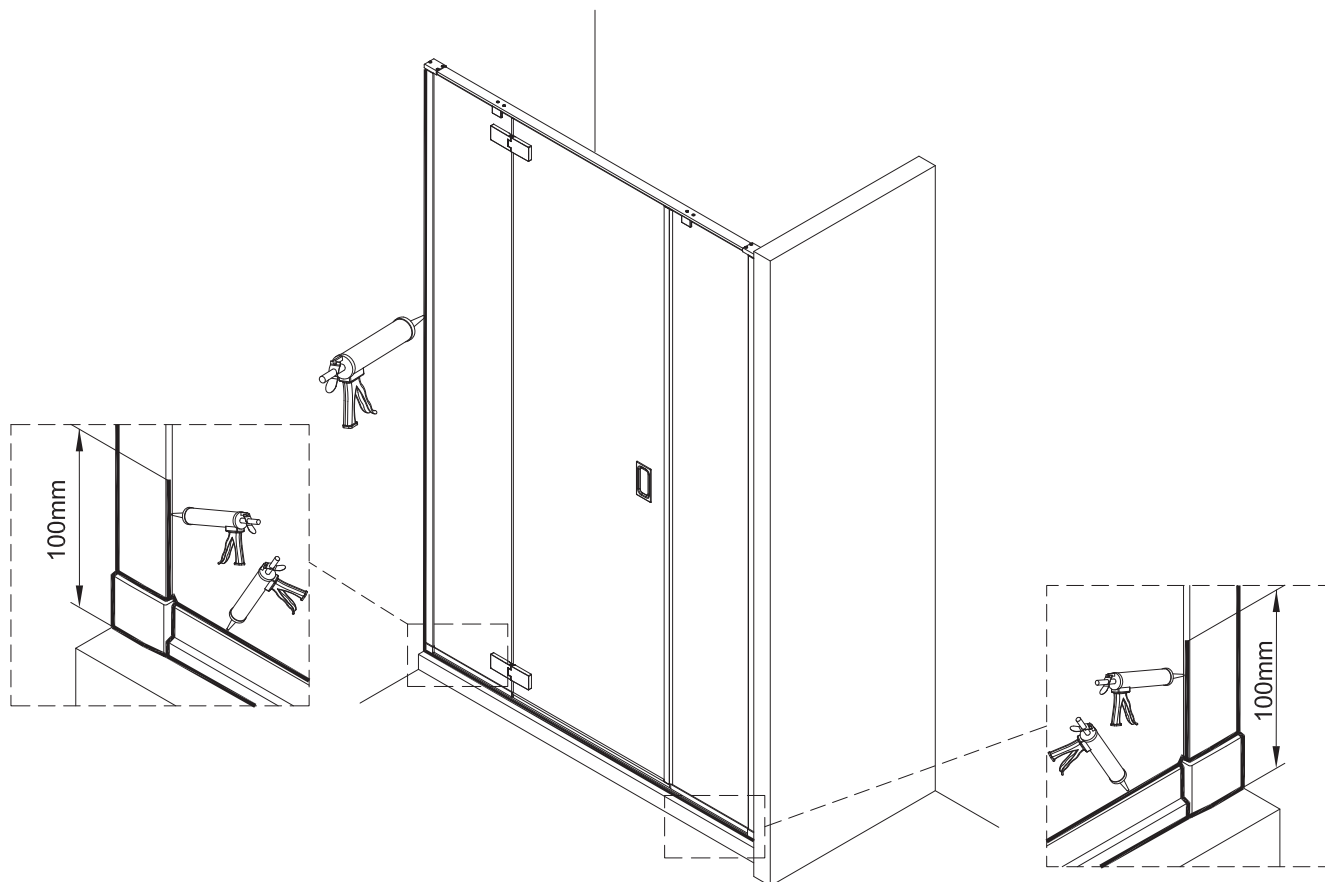

crosswater[®]
SHOWERING

For any further information please contact Crosswater
Phone number, 0345 873 8840

Website, crosswater.co.uk

Email address, sales@crosswater.co.uk

The manufacturer reserves the right to make technical
modifications without prior notice.