

Chrome Low Level Flush Pipe Pack

INSTALLATION INSTRUCTIONS

Please follow these care instructions to ensure your product retains it's high quality finish and please retain this leaflet for future reference.

1. Identify all components are present prior to installation
2. Check for any leakage on completion

WARNING!

We recommend that this product is installed by a qualified tradesperson and we accept no liability for products fitted incorrectly, and where the correct testing procedures have not been used, resulting in the escape of water.

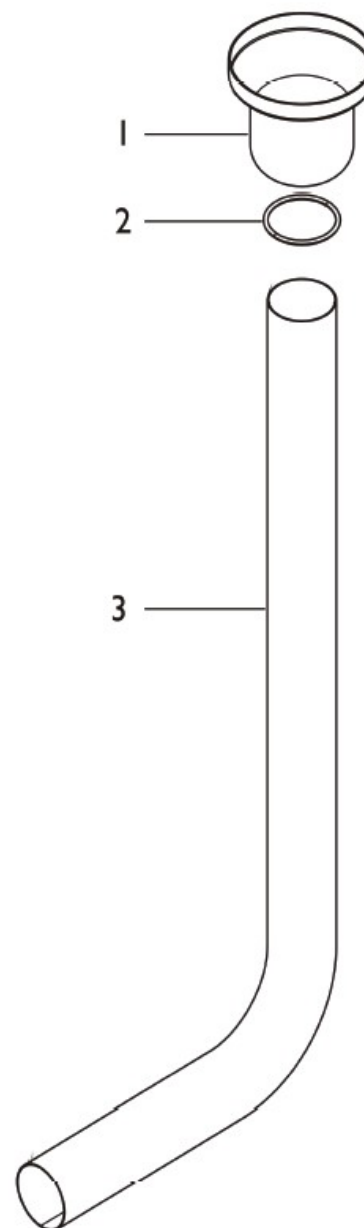

1. H/L Shroud x 1
2. "O"Ring x 1
3. Flush Pipe x 1

