

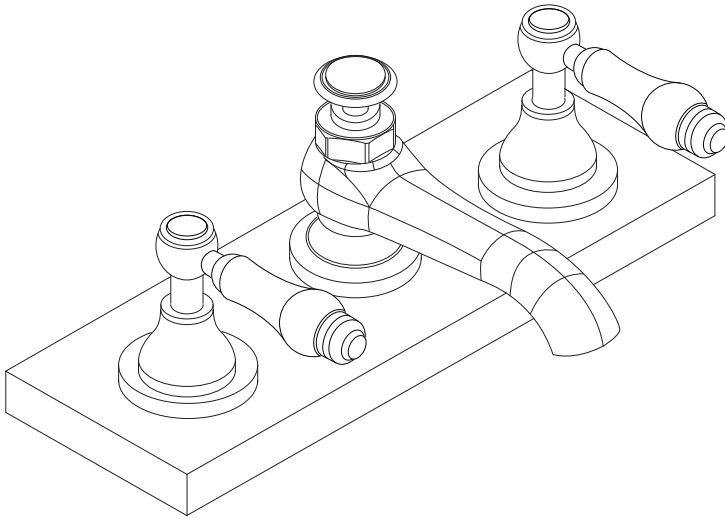

## **Traditional 3 Tap Hole Basin Mixer & Pop-Up Waste**



## **Fitting Instructions**

Please follow them carefully and  
leave this manual with end user

## Before you begin:

1. **We recommend that this product is installed by a qualified tradesperson.** Victorian Plumbing Ltd. accept no liability for products incorrectly installed, or where the correct testing procedures have not been adhered to, thus resulting in the escape of water and consequential damage.
2. Ensure the supply pipes have been thoroughly flushed to remove any debris.
3. Ensure the incoming mains water supply is switched off prior to commencing the installation.
4. Observe all local plumbing and building codes & regulations.
5. Unpack the product then read these instructions before proceeding. Inspect the product for damage. If any damage is found, contact our Customer Relations team.

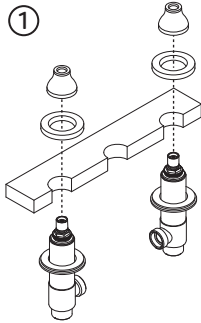

Insert the hot & cold 'Side Valves', 'O-rings' and 'Back Nuts' to the underside of the basin holes. Place the 'Cover Plates' and 'Handle Sleeves' over the 'Side Valves' at the top of the basin.

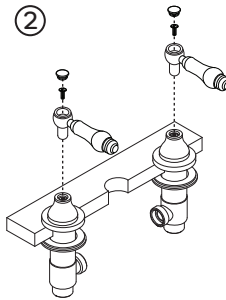

Place the 'Control Handles' over the hot & cold 'Side Valves'. Using the 'Set Screws' provided secure the handles to the valve by screwing into the hot & cold 'Side Valves'. Screw the 'Cover Caps' over the 'Handles'.

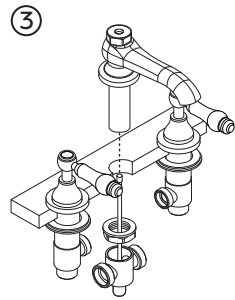

Feed the 'Mixer Tap' through the basin hole at the top. Secure the tap to the basin using the 'Rubber Seal' and 'Back-Nut' below the basin. Feed the 'Diverter' through the threaded tail of the 'Mixer Tap' and tighten.

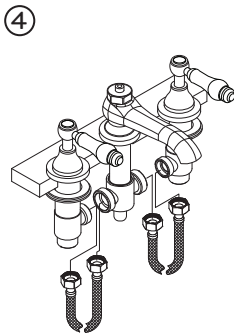

Flush the pipework then connect the 'Flexi-Pipes' to the 'Side Valves' and 'Diverter'.

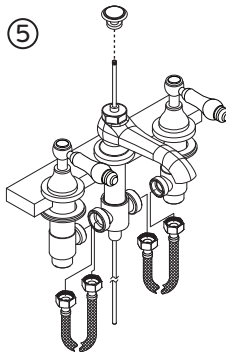

Feed the 'Vertical Control Rod' through the 'Diverter' and 'Mixer Tap' then screw the 'Pop-Up Handle' to the rod. Secure the 'Pop-Up Handle' to the 'Mixer Tap'.

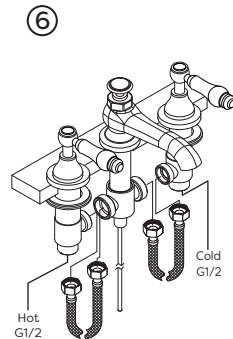

Connect the hot & cold water supply to the valves. Turn on the water supply and check all joints and connections for any leaks.

**Note:** Diagrams are for illustration purposes only. Your tap may superficially differ from this drawing however the installation guide steps still apply.

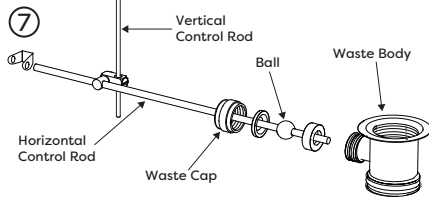

**Installation tip:**  
Pipe a fine bead of good quality silicone sealant around the top and bottom edge of the basin waste hole.

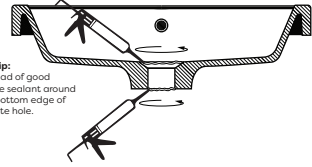

Place a 'Rubber Seal' over the threaded tail of the 'Plug Housing'. Proceed to feed the 'Plug Housing' through the basin waste hole.

Place the second 'Rubber Seal' and 'Waste Body' over the threaded tail of the 'Plug Housing'. Tighten to secure the waste into position. Wipe away any excess silicone with a damp cloth.

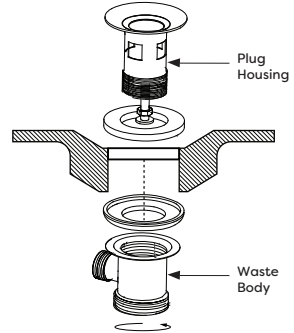

Unscrew the 'Waste Cap' off the 'Waste Body' then slide the cap onto the 'Horizontal Control Rod' (as shown in diagram above). Insert the 'Horizontal Control Rod' into the 'Waste Body', ensuring the 'Ball' is in-line with the 'Waste Body'. Connect the 'Horizontal Rod' to the 'Vertical Rod', then test the pop-up waste function.

## Flexible Connecting Pipes:

When installing the flexi-pipes to the household pipework. Special care must be taken to ensure they do not bend sharply causing a kink or twist. Failure to do so may result in poor performance and damage to the flexi-pipes.

### Example:

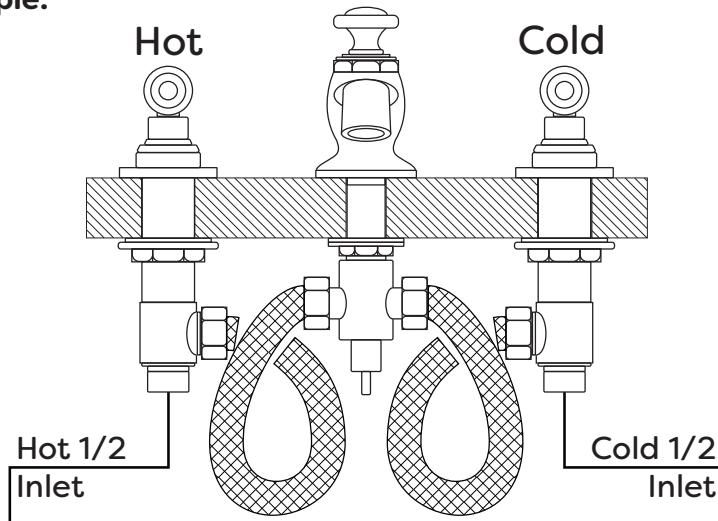

Once all pipes are securely connected; turn on the mains water supply, run the taps, and check all joints/connections for any leaks.

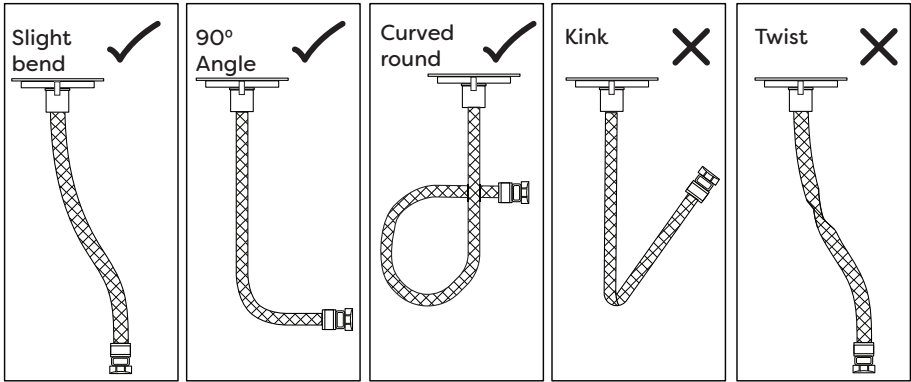

### Aftercare:

Always clean the surface of tap to keep it bright. **Attention:** please do not use inappropriate tools such as sharp brushes, rough sponges, scouring pads or corrosive detergent to clean the tap. Please clean the tap by wet cloth and soapy water. Then rinse the soap out with clean water and dry with a soft cotton cloth.

## Troubleshooting

FAULT	POSSIBLE CAUSE
Taps do not turn on	<ul style="list-style-type: none"> <li>• Closed isolation valve.</li> <li>• Mains water supply turned off.</li> </ul>
Water dripping from taps	<ul style="list-style-type: none"> <li>• This is normal for a short time after using the taps.</li> <li>• If water continues to drip, possible build up of limescale in the cartridge valve.</li> </ul>
Low or no flow rate	<ul style="list-style-type: none"> <li>• Partially closed isolation valve.</li> <li>• Instantaneous water heater cycles on and off as flow rate pressure is too low.</li> <li>• Head of water is below the minimum distance required.</li> <li>• Hot or cold water being drawn off elsewhere causing pressure changes or instantaneous boiler temperature changes.</li> <li>• Airlork or partial blockage in the supply pipework.</li> </ul>

### Recycling and Disposal:

Please recycle the packaging in accordance with your local government regulations on waste handling and follow the same advice at the end of the products life.

[www.victorianplumbing.co.uk](http://www.victorianplumbing.co.uk)