

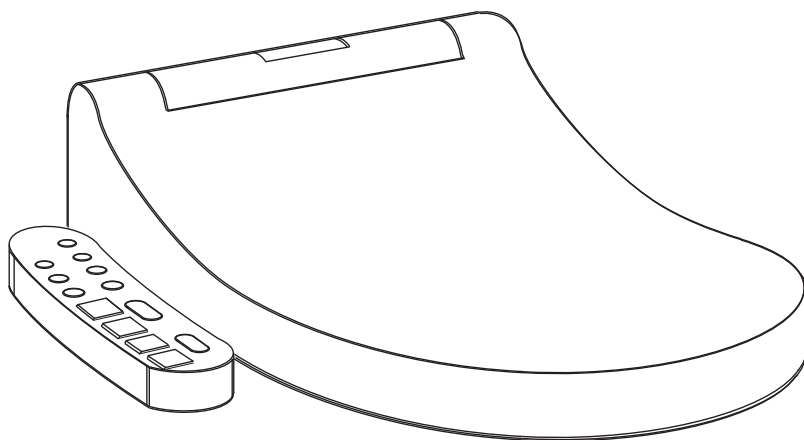

Smart Bidet Toilet Seat



Fitting Instructions

Please follow them carefully and
leave this manual with end user

Important Information

Before installation, please read this guide carefully.

1. **We recommend that this product is installed by a qualified tradesperson,** Victorian Plumbing Ltd. accept no liability for products incorrectly installed, or where the correct testing procedures have not been adhered to, thus resulting in the escape of water and consequential damage. Observe all local building codes & regulations.
2. **Ensure the incoming mains power supply is switched off prior to commencing the installation.**
3. **Ensure the mains water supply is turned off prior to commencing the installation.**
4. Unpack the product then read these instructions before proceeding. Inspect the product for damage. If any damage is found, contact our Customer Relations team.

! SAFETY INFORMATION !

Please read the “General Safety Information” and “Electrical Safety Information” before use. It is important that all the precautions here are followed.



GENERAL SAFETY INFORMATION



Please carefully follow the electrical safety information when installing/operating the product. Failure to adhere to the guidelines below may result in damage/water leakage to the product or injury.

1. Do not use sea water or any other kind of water except tap water.
2. It is not recommended to use this product during a thunder storm.
3. Do not place your finger or any object into the warm air outlet.
4. Avoid placing objects or clothing over the air outlet.
5. Improper use of the “seat temperature” may cause low temperature scalding. It is recommended to turn temperature setting to off during long periods of use.
6. Do not let children play with this product.
7. Avoid standing on the lid of the toilet seat, as this will put unnecessary stress on the bolts and hinges.
8. Do not use the toilet seat if there are any signs of damage.
9. Do not throw cigarettes or any other flaming material into the toilet.
10. There are strong magnets inside the toilet seat. Do not use the product if you have a pacemaker and/or other auxiliary medical equipment.
11. Do not crush or excessively bend the water inlet hose.
12. Take measures to ensure the piping is not subjected to temperatures below 0°C freezing.
13. If you are not using the toilet for a long period of time, turn off the angle valve and turn off the power.
14. If the pan outlet is blocked, turn off the power and clean the obstruction.



ELECTRICAL SAFETY INFORMATION



Please carefully follow the electrical safety information when installing/operating the product. Failure to adhere to the guidelines below may result in a fire, short circuit, electrical shock, injury or water leakage.

1. Do not use a smart toilet seat that shows any signs of wire damage.
2. **This installation should only be installed by a qualified tradesperson** in accordance with the applicable regulations regarding safety and all other regulations.
3. All installations to which the device is connected should comply with regulations applicable in the country of installation and use.
4. Always connect the smart seat via a 240V fused spur switch.
5. Use a high sensibility and fast respond leakage switch (rated induced currents below 15mA) or insulating transformer (1.5kVA~3kVA) to protect the outer loop.
6. Extensions leads or electric plug adapters should not be used to supply power to the smart seat.
7. **Before installing or removing the toilet seat**, make sure it is fully isolated from the mains power supply.
8. Do not open the device. Any interference with the internal components will invalidate the warranty.
9. Regularly check the toilet for any damage to ensure it is safe to use.
10. Do not pour water or detergent on top of the toilet seat and electrical outlet.
11. Do not install the smart seat in a car, caravan, motor home, ship or any other moving vehicle .
12. Disconnect the smart toilet seat from the power supply if you suspect a fault, this includes the following:
 - Water leakage from the pipe or inside of the product.
 - A crack or damage on the product.
 - Unusual sound or smell.
 - Smoke.
 - Unusual heating
 - Blockage.
13. Do not connect the water inlet soft pipe to the electrical wire and outlet.
14. Do not strike, yank, twist, excessively bend, pinch, bind, damage or alter the electrical cords.
15. Do not use a loose or faulty electrical outlet.
16. Use the electrical outlet and wire appliance in a specified area. (See electrical zones)
17. Confirm that the electrical outlet is connected to the ground.
18. Ensure the bathroom is well ventilated.
19. When carrying out any maintenance (except nozzle cleaning maintenance) ensure the power is off.

Recycling and Disposal:

Please recycle the packaging in accordance with your local government regulations on waste handling and follow the same advice at the end of the products life.

Diagram:

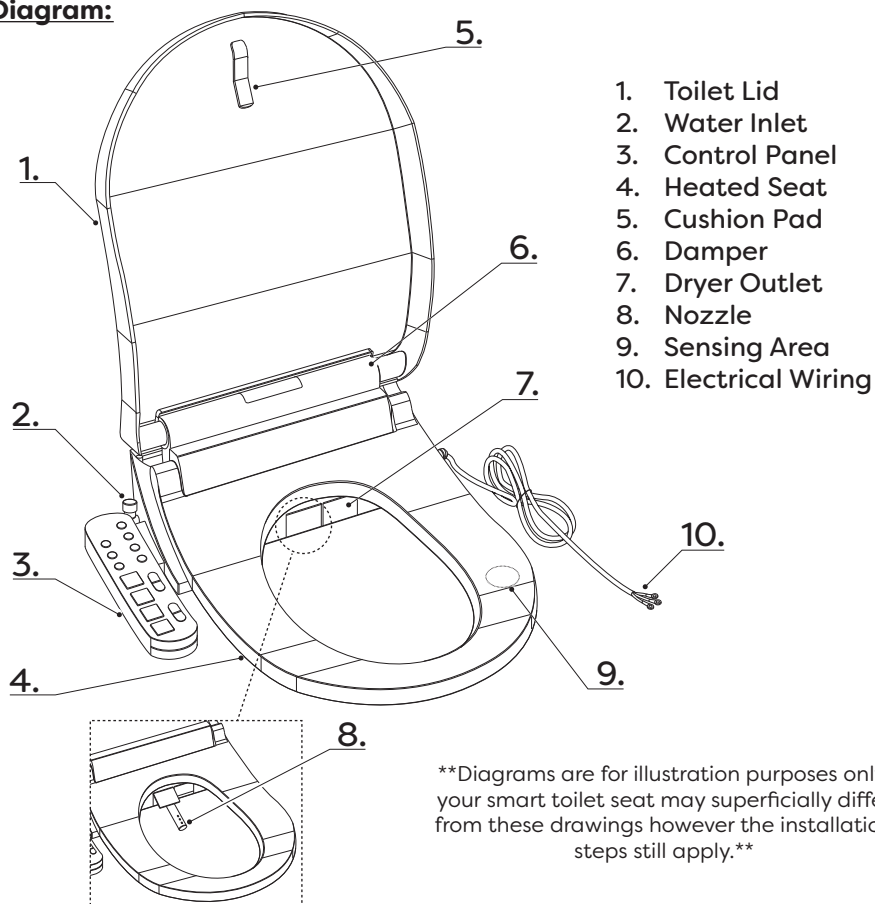

Fitting List:

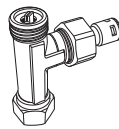
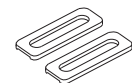
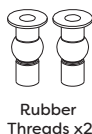
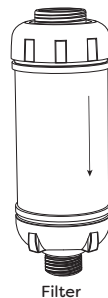
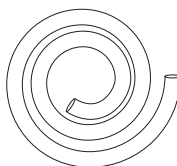
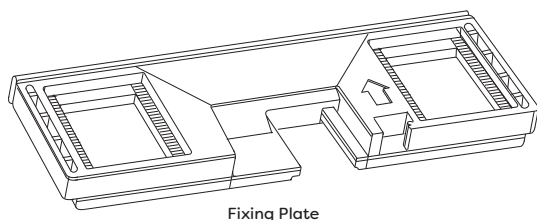

Tool required for installation (Not Included):

Ensure the appropriate PPE is used during installation

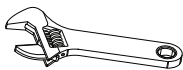

Adjustable Wrench



Screwdriver



Power Drill

Function introductions:

Function	Introduction
Rear Wash	Provides rear cleaning
Rear Oscillating Wash	Moves the nozzle back and fourth for rear cleansing
Front Wash	Provides cleansing with front cleansing nozzle with a gentle spray
Front Oscillating Wash	Moves the nozzle back and fourth with a gentle spray
Child Wash	Special warm water cleansing for children
One Solution	Auto clean, flush and dry
Strong Wash	Large amount of water to clean the buttocks to promote laxative
Lady Care	Special cleaning of female's physiological period
Nozzle Position Adjustment	Adjusts the nozzle to a suitable washing position
Temperature Adjustment	Set the temperature of the seat and water
Water Pressure Adjustment	Change the cleaning water pressure
Seat Sensor	Functions activated by sitting on the seat
Drying	Dries the user after cleansing
Changing Drying Intensity	Control the temperature of warm air from the dryer
Nozzle Self Clean	Provides nozzle self-cleansing before washing
Deodorizer	Removing odours
Power Saving Mode	Saves electricity
Night Light	Preparations for insufficient light
Soft Close	Damper in the seat and cover, to make it close softly
Power Switch	Turn the power on and off
UV Sterilization	Automatically activates after the user has left the seat.

Installation:

Step 1:

- (If applicable: remove the existing toilet seat from the pan.) Apply a small amount of lubricant to the rubber threads, then insert the two rubber threads to the mounting holes in the toilet bowl.
- Place the fixing plate over the mounting holes, the plate should be positioned up against the front of the cistern. Insert the two metal washers within the grooves of the fixing plate then using the bolts provided, secure the fixing plate to the rubber threads.

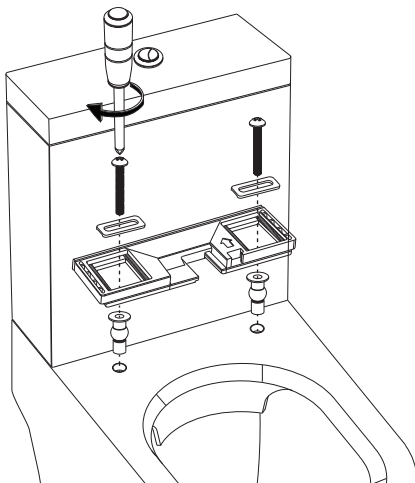

Step 2:

- Once the fixing plate is fixed into position; mount the toilet seat into the fixing plate (an audible click can be heard when fully slotted into place). Ensure that both the seat/lid will stay in the upright position when installed and will fit the pan (adjust the position of the fixing plate if necessary).

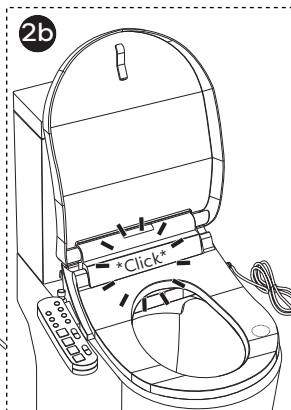
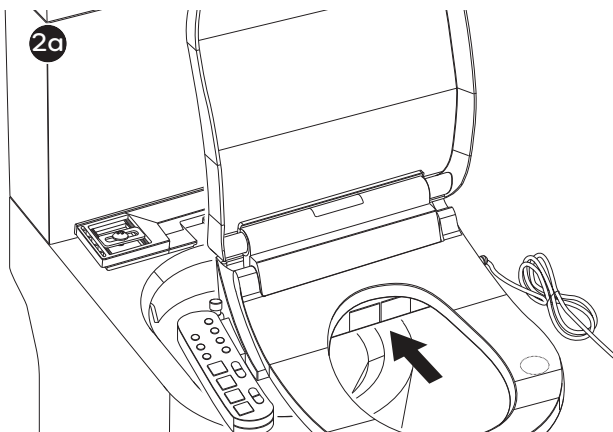

Step 3:

- Ensure the isolation valve for the water supply is in the off position and that the pan the pan is drained of water. Unscrew the inlet pipe from the isolation valve, then connect the T-Valve to the isolation valve and inlet pipe. Tighten all the connections with a wrench.

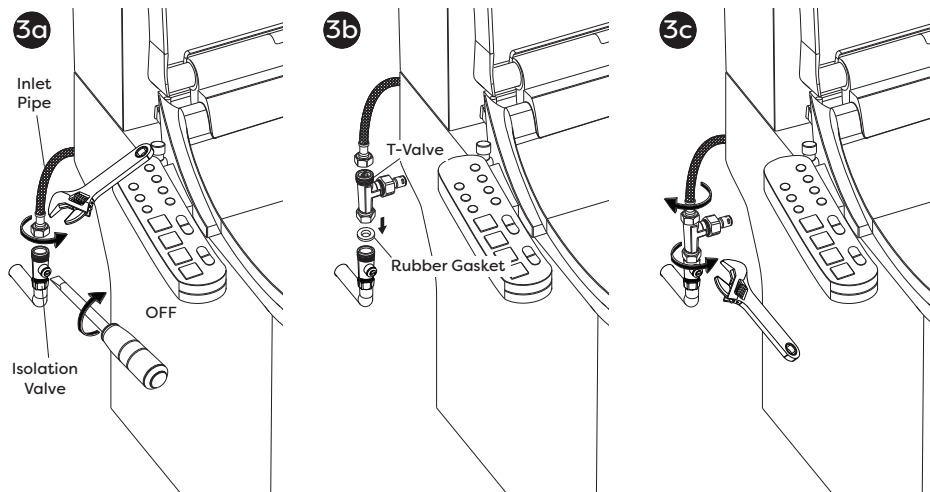

Step 4:

- Unscrew the plastic connecting to the T-Valve connector, Screw the filter to the T-Valve connector (ensure that the arrow direction on the filter is pointing away from the T-Valve), then connect the PE inlet pipe to the plastic nut and toilet seat (as shown in the diagram below).

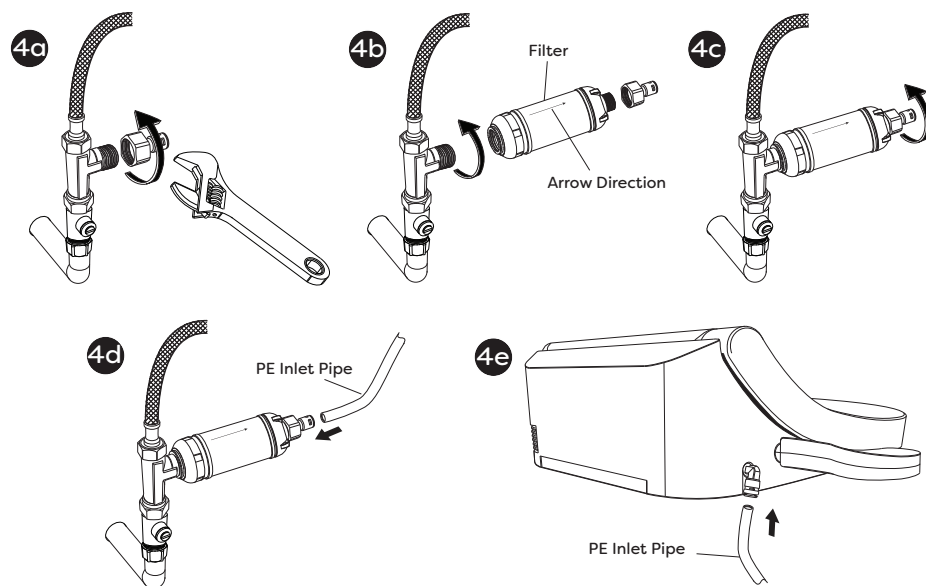

Step 5:

- Prepare the wall ready for the electrical connection by carefully drilling a hole in the wall using an appropriate sized drill bit, then feed the power cable through the hole to the fused spur switch.

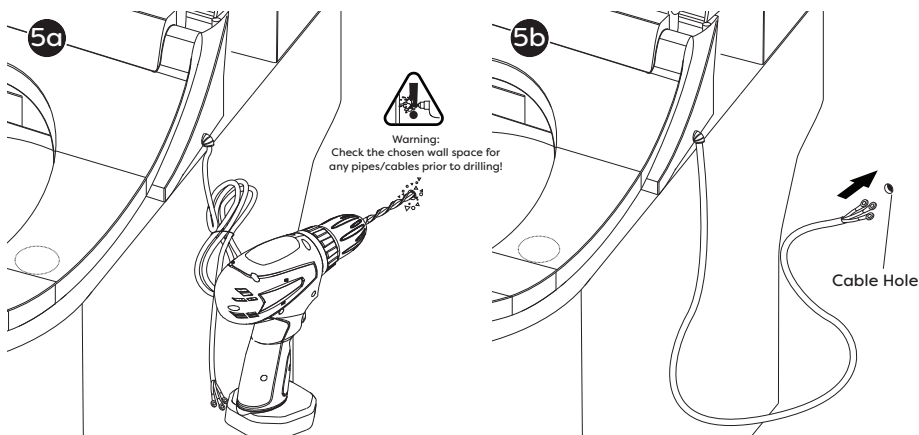

Electrical Connection:

WARNING: Before you begin, ensure the mains power supply is switched off prior to connection!

Connect the smart seat cable and mains supply to a fused spur switch according to the wiring diagram. Ensure that there are no exposed wires upon completed installation.

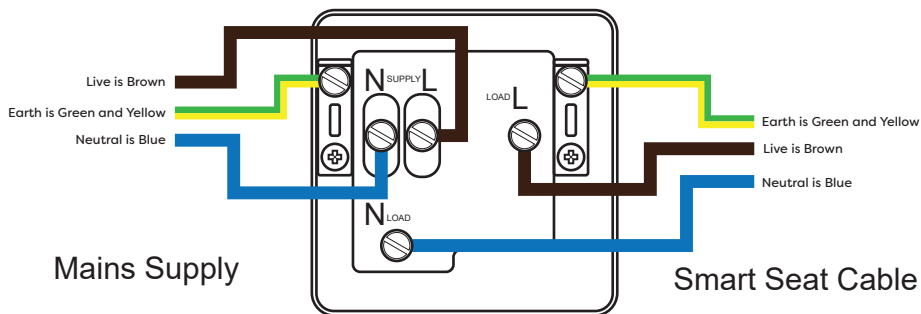

Diagrams are for illustration purposes only. Your switch may superficially differ from this drawing. Refer to the instructions of your chosen switch for guidance if needed.

Preparation:

Turn on the water supply, fill flush the toilet and check all joints/connections for any leaks.

Turn on the power supply, ensure the fused spur switch is on and press the power button on the control panel.

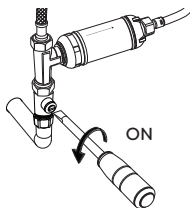

Operation:

Sitting on the seat:

- The sensor on the seat responds to the pressure as you sit down. This is indicated by the 'Clean' indicator lighting up.
- If the automatic deodorization function is on, the deodorization will start to work.

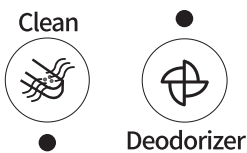

Wash and Pressure Functions:

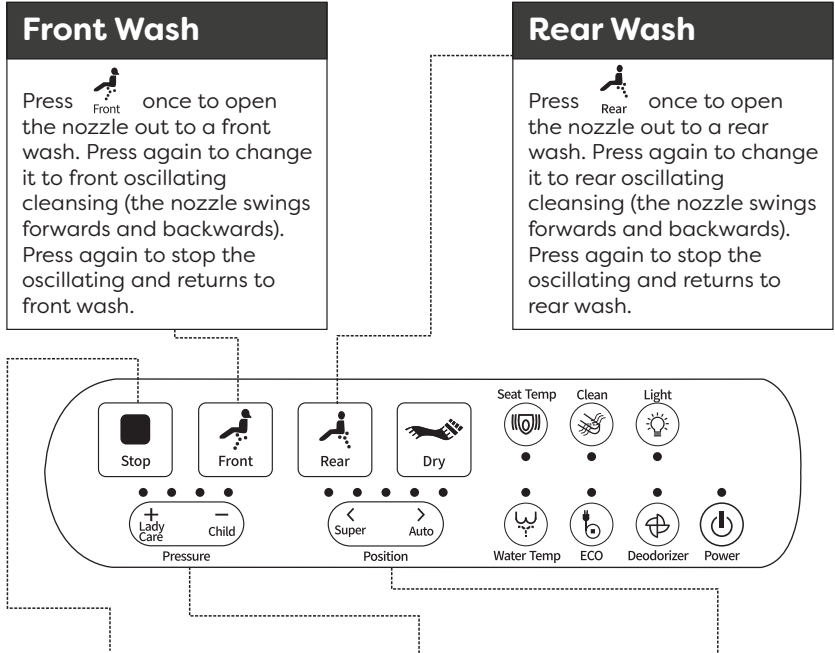

Front Wash

Press  once to open the nozzle out to a front wash. Press again to change it to front oscillating cleansing (the nozzle swings forwards and backwards). Press again to stop the oscillating and returns to front wash.

Rear Wash

Press  once to open the nozzle out to a rear wash. Press again to change it to rear oscillating cleansing (the nozzle swings forwards and backwards). Press again to stop the oscillating and returns to rear wash.

Stop

Press to stop the current cleaning operation.

Note: front and rear washing will stop automatically after 2 minutes

Water Pressure Adjustment

Adjusts the pressure of the water indicated by the 4 lights.

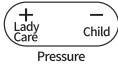

Indicator display → ● ● ● ●

Nozzle Position Adjustment

Adjusts the position of the nozzle indicated by the 5 lights.

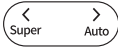

Indicator display → ● ● ● ● ●

Note: Under oscillating, the nozzle position adjustment is unavailable

Nozzle Cleaning:

- Press  to enter nozzle cleaning mode, the nozzle will come out and automatically start to wash, afterwards you can manually clean the nozzle if necessary. Press the stop button to end the cleaning mode and the nozzle will retract.
- Note: the nozzle will automatically clean the peripheral part before front and rear wash.

Drying Functions

Stop

Press to stop air drying.

Note: Dryer will stop automatically after 4 minutes.

Dryer

Press this button to start warm air drying

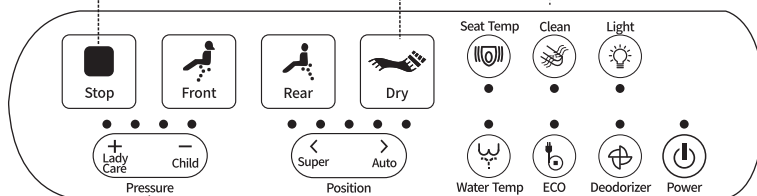

Warm Air Temp Adjustment

Adjusts the pressure of the warm air indicated by the 4 lights.



Indicator display → ● ● ● ●

Water Temp

Adjust the temperature of the water indicated by the colours above the symbol.

- First press (Blue): Corresponds to 33 °C
- Second press (Green): Corresponds to 36 °C
- Third Press (Red): Corresponds to 39 °C
- Fourth press (No Light): Normal room temperature (does not heat)

Each time you press this button, the water temperature switches to the next level.



Automatic Cleaning Operations:

Lady Care

Press this button to enter 'Lady Care' mode. The nozzle extends out and water temp is set to red (39°C), water pressure is set to level 2 and nozzle position is set as default.

Water pressure/temp is non-adjustable while in this mode, nozzle position is adjustable.

Automatic process lasts for 2 minutes. Press  to end the process immediately .

Strong Wash

Press this button to enter 'Powerful Washing' mode. The nozzle extends out and water pressure is set to level 5.

Automatic process lasts for 2 minutes. Press  to end the process immediately .

Reminder

While in 'Auto' mode the front wash, rear wash, flush, etc. will not function.

'Lady Care', 'Child Wash', 'Strong Wash' and 'One Solution' can only be enabled in 'Auto' mode.

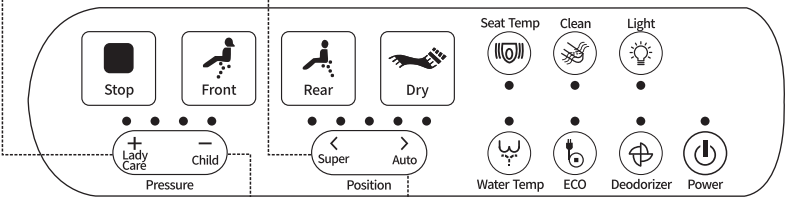

Child Wash

Press this button to enter 'Child Wash' mode. The nozzle extends out and water temp is set to green (36°C), water pressure is set to level 1 and nozzle position is set to front wash level 5.

Water pressure/temp and nozzle position is non-adjustable while in this mode.

Automatic process lasts for 30 seconds. Press  to end the process immediately .

One Solution

Press this button to start in 'Auto' mode. The order is rear wash (40 seconds), oscillate wash (20 seconds), warm air dryer (2 minutes) then ends.

Press  to end the process immediately.

Deodorizer

Press this button to start deodorizing, the indicator on the control panel lights up. Press again to stop.

Indicator →  Deodorizer

Reminder

During drying, the deodorizing function is temporarily stopped, it will automatically start again after the drying is completed.

When a person leaves the seat, the deodorizing function will continue to work automatically after 1 1/2 minutes.

Extra Features:

Night Light

Press this button to turn on the indicator lights and night lights. Press this button again to turn off the lights.



Power

Press this button to enter standby mode (all the lights are off). Press again to turn on the toilet seat (Power light is on).

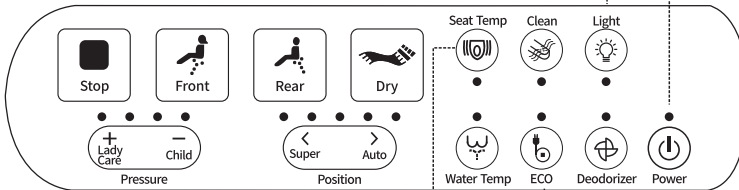
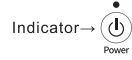

Seat Temperature

Adjust the temperature of the seat indicated by the colours above the symbol.

- First press (Blue): Corresponds to 33 °C
- Second press (Green): Corresponds to 36 °C
- Third Press (Red): Corresponds to 39 °C
- Fourth press (No Light): Normal room temperature (does not heat)

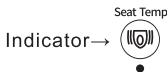

Each time you press this button, the seat temperature switches to the next level.

Attention: To prevent the low temp burn, the seat automatically reduces the seat temp below 35°C after sitting on the seat for 10 minutes.

Power Save

Press this button, the indicator blinks on the control panel (entering standby mode). After leaving the seat for 1 ½ minutes the seat enters power saving mode. While in this mode, the seat temp is kept at 25°C and the settings before power saving are automatically restored the next time.

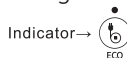

Buzzer:

Buzz once	Sitting on the seat; all functions are available.
Buzz twice	Standing up from the seat; parts of the functions are available.
Buzz three times or more	Fault on the toilet seat.

UV Sterilization:

Once you leave the toilet seat for 15 seconds, the UV sterilization function will automatically turn on and sterilizes the nozzle for 3 minutes. Every 4 hours, it will start again.

Note: this function may differ due to different model configurations. The low-light will flash for 3 seconds when the UV sterilization starts. During the operation do not look directly into the light as this may cause permanent damage to the eyes.

Trouble Shooting:

PROBLEM	REASON	ACTION
No power	The fused spur switch is turned off	Ensure the fused spur switch is on
	The electrical outlet is not connected to the power supply	Check if the electrical outlet is connected to the power supply.
No water comes out while cleaning	Water Bar Pressure too low.	Ensure the water pressure is within operating range (see product specification)
	Isolation valve closed or partially opened.	Open the isolation valve fully
	Water inlet filter blocked.	Remove and clean the filter, then re-fit (see 'Cleaning the Valve Filter')
Cleansing water not warm enough	Temperature setting is incorrect	Readjust
Seat temperature not warm enough	Seat temperature setting is incorrect or in power saving mode	Readjust
Toilet seat is loose	Fixed bolts are loose	Tighten the bolts
No response when pressing button	Fault	Reboot or contact supplier

Cleaning & Maintenance:

Toilet Seat Cleaning:

Before you begin ensure the power is turned off at the switch.

To maintain the surface finish of your product, wipe the toilet seat regularly using a clean damp cloth, a mild detergent mixture can be used. Do not use abrasive cleaning agents or materials which can strip and scratch the surface.

Nozzle cleaning & maintenance:

Press the  button, the nozzle will come out and begin auto washing, afterwards you can use a brush to clean the nozzle if needed.

Attention: Do not use a steel brush to clean the nozzle.

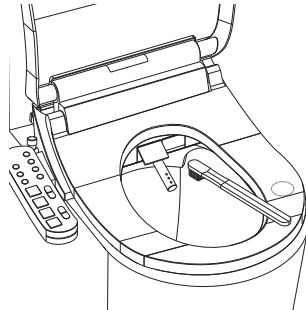

Toilet Seat Release:

To remove the toilet seat from the pan. Press the release button (located below the power cable) while carefully pulling back the toilet seat.

Note: Turn off the isolation valve and detach the PE inlet pipe from the seat prior to removal.

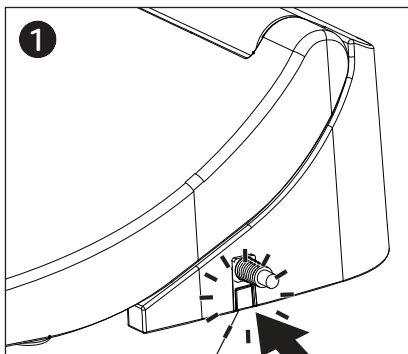

Release Button

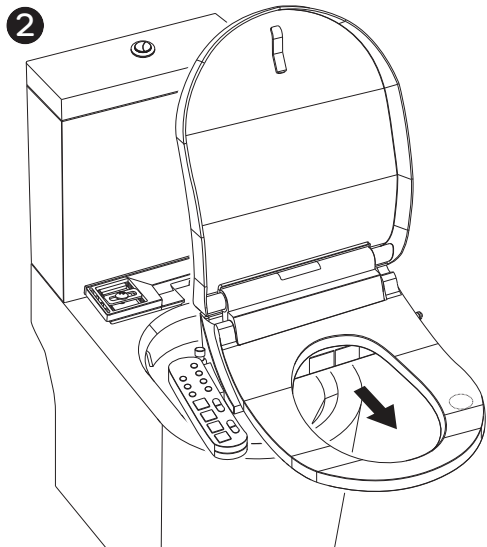

Cleaning the Valve Filter:

- Turn off the isolation valve and ensure the cistern and pan is drained of water, then remove the T-Valve from the inlet pipe and filter. Carefully remove the two valve filters from the T-Valve (as shown in the diagram below). Wash away any debris and carefully clean the filters using a soft bristle brush. Re-fit the valve then turn on the isolation valve (check all joints and connections for any leaks).
- **Note:** Do not use any cleaning agents, use water only. Do not use excessive force to clean the filter as this may damage the filter, affecting normal use.

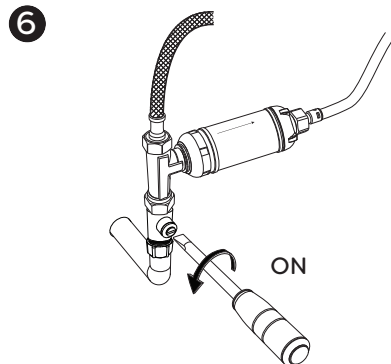
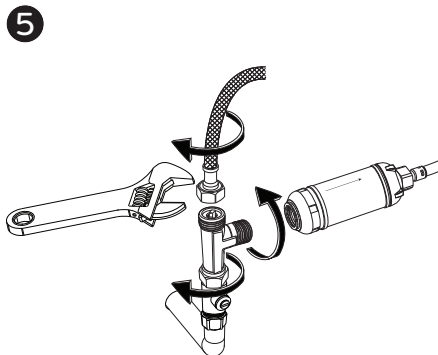
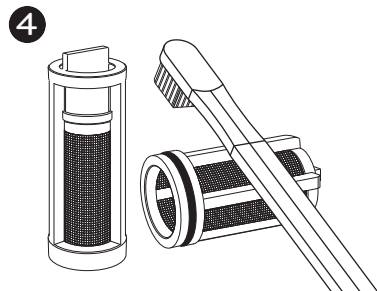
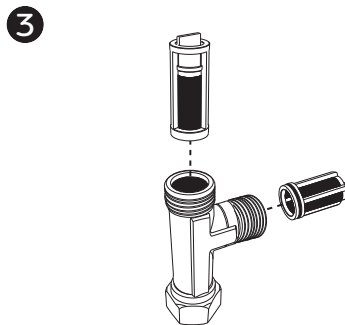
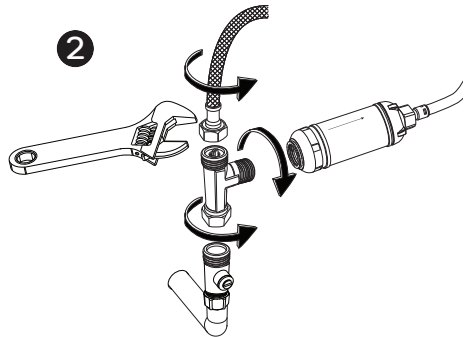
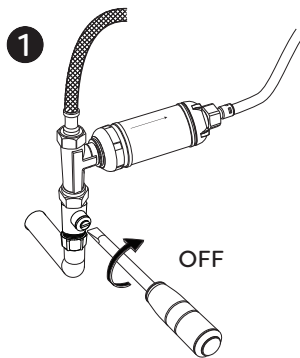

Product Specification:

Ambient temp range		4°C-40°C		
Inlet water temp range		4°C-40°C		
Rated voltage		220V~50Hz	120V~60Hz	(Inlet water temp: 15°C±0.5°C)
Rated power		1200W	1200W	
Water pressure range		0.06MPa - 0.75MPa		
Water pressure adjustment		Adjustable in 4 indicator settings		
Cleansing device	Water temp adjustment	Adjustable in 4 indicator settings: Room temp, 33°C, 36°C, 39°C		
	Safety device	Temp sensor control system, dry burning-resistant protection device, over temp protection system, water and electricity isolation system		
	Rear wash	0.4-0.6 L/min (water pressure≥0.15MP.a)		
	Front wash	0.4-0.65 L/min (water pressure≥0.15MP.a)		
	Strong wash	0.45 L/min (water pressure≥0.15MP.a)		
Seat heating device	Seat temp control	Adjustable in 4 indicator settings: Room temp, 33°C, 36°C, 39°C		
	Seat protective system	Temperature sensing control system/fuse		
Warm air dryer	Warm air temperature	4 adjustable settings: 35°C, 42°C, 48°C, 54°C (The wind temp is greatly affected by the environment, and the values are for reference only.)		
	Safety device	Temperature reset switch/fuse		
Deodorizer		Catalyst deodorant box		

www.victorianplumbing.co.uk