

AREZZO

Electric Towel And Robe Hanging Bar

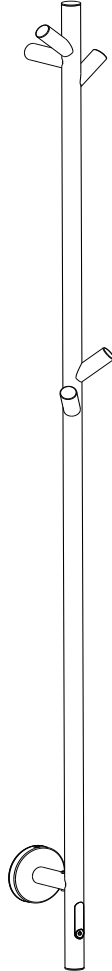

Fitting Instructions

Please follow them carefully and
leave this manual with end user

Important Information

Before installation, please read this guide carefully.

1. **We recommend that this product is installed by a qualified tradesperson.** Victorian Plumbing Ltd. accept no liability for products incorrectly installed or any damage to the floor, walls, plumbing, heating element, towel heater, or personal injury during installation.
2. **Check the chosen wall space for any pipes/cables prior to drilling**
3. Observe all local building codes & regulations.
4. **Ensure the incoming mains power supply is switched off prior to commencing the installation.**
5. Unpack the product then read these instructions before proceeding. Inspect the product for damage. If any damage is found, contact our Customer Relations team.

! IMPORTANT SAFETY INFORMATION !

1. Never use an towel heater that shows any signs of damage.
2. Always connect the towel heater via a 240V fused spur switch.
3. **Children under the age of 3** should not be allowed within close proximity of the device without the supervision of an adult.
4. Be aware, all metal surfaces are hot when the towel heater is switched on.
5. **This installation should only be installed by a qualified tradesperson** in accordance with the applicable regulations regarding safety and all other regulations.
6. All installations to which the device is connected should comply with regulations applicable in the country of installation and use.
7. Extensions leads or electric plug adapters should not be used to supply power to the towel heater.
8. **Do not pour water into the towel heater.**
9. The device is intended for home use only.
10. **Before installing or removing the towel heater,** make sure it is fully isolated from the mains power supply.
11. Do not open the device. Any interference with the internal components will invalidate the warranty.
12. Regularly check the device for any damage to ensure it is safe to use.
13. The towel heater must be electrically isolated from the mains power supply during any maintenance.

Tools required for installation (not supplied):

***Ensure the appropriate PPE is used
during installation***



Electrical
Tape



Drill



Spirit level



Screwdriver



Pencil

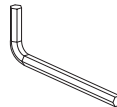

Alan Key

Technical Information:

Electric Supply	230V
Heating Output Available	20W
Device Protection Class	Class I
Certification	These products are in compliance with 2014/30/EU Electromagnetic Compatibility and 2014/35/EU Low Voltage Directive These products carry CE mark accordingly.

Fitting List:

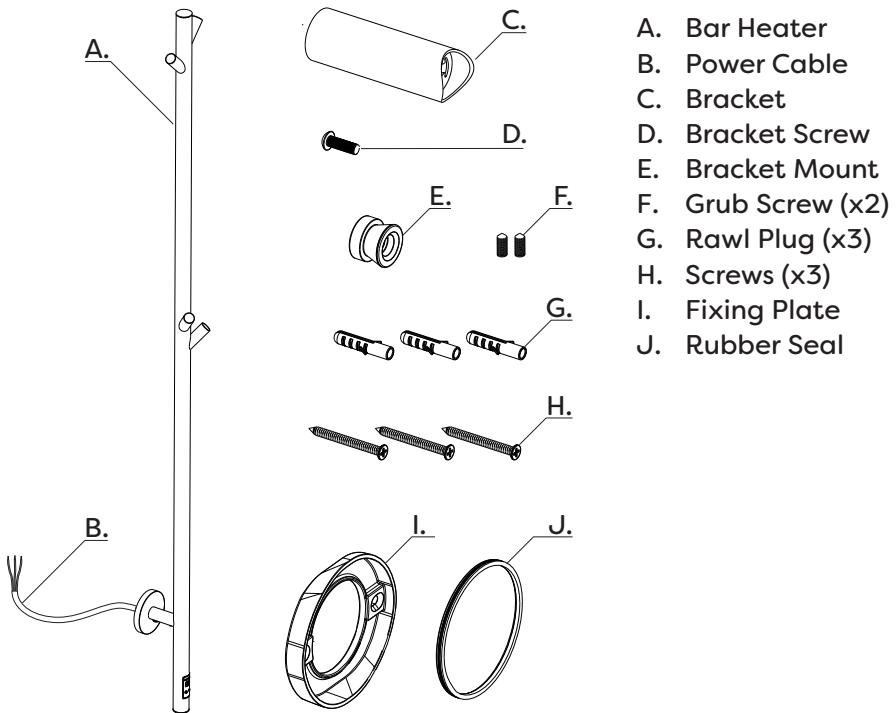

Diagrams are for illustration purposes only. Your towel heater may superficially differ from this drawing however the installation guide steps still apply.

Installation:

Diagrams are for illustration purposes only. Your towel heater may superficially differ from this drawing however the installation guide steps still apply.

Step 1:

- Screw the 'Bracket' (C) to the 'Bar Heater' (A) using the 'Bracket Screw' (D) provided.
- Set the 'Bar Heater' (A) at the desired height, then make a mark across the top and bottom of the 'Bar Heater' to the wall.
- Ensure the centre markings between the brackets are 1260mm apart from each other.

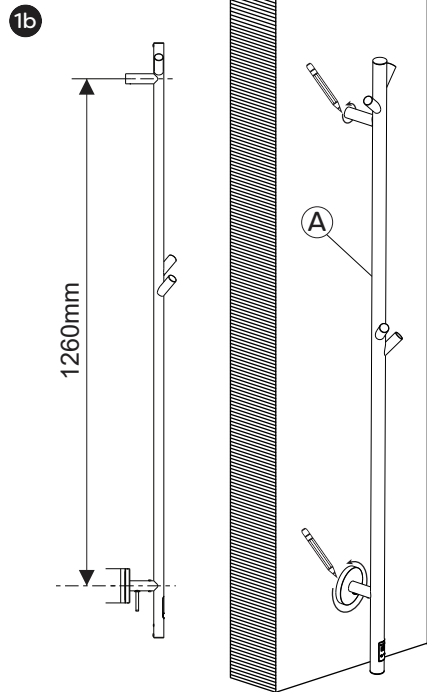
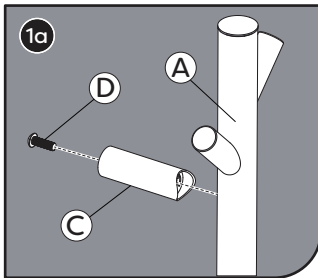

Step 2:

- Place the 'Fixing Plate' (I) over the centre marking and mark the holes in the wall ready for drilling. Using an appropriate sized drill bit, carefully drill the holes in the wall then insert the 'Rawl Plugs' (G). Using an appropriate sized drill bit, carefully drill a cable sized hole in centre to feed the 'Power Cable' (B) through.
- Place the 'Fixing Plate' over the drilled holes then using the 'Screws' (H) provided, secure the unit to the wall by screwing into the 'Rawl Plugs'.

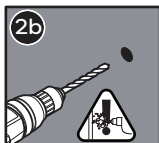
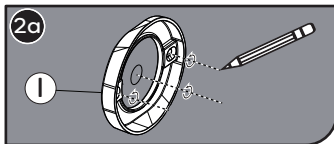

Warning:
Check the chosen wall space for any pipes/cables prior to drilling!

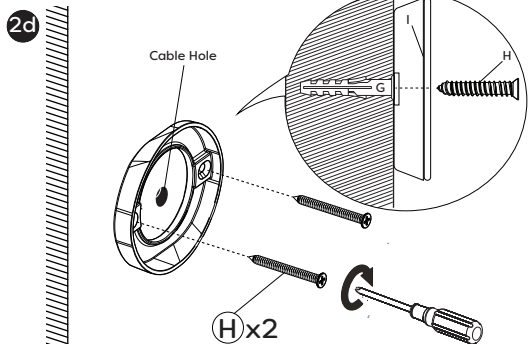
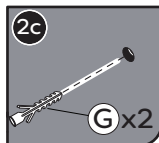

Step 3:

- Place the 'Bracket Mount' (E) over the centre marking and mark a hole in the wall ready for drilling. Using an appropriate sized drill bit, carefully drill the hole in the wall then insert the 'Rawl Plug' (G).
- Place the 'Bracket Mount' over the drilled hole then using the 'Screw' (H) provided, secure the unit to the wall by screwing into the 'Rawl Plug'.

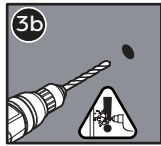
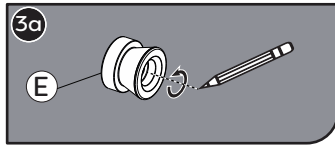

Warning:
Check the chosen wall space for
any pipes/cables prior to drilling!

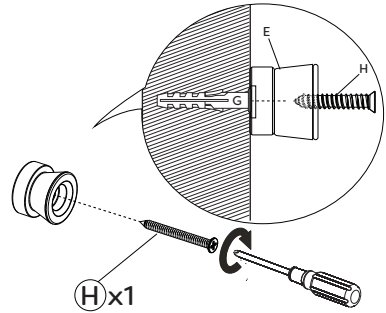
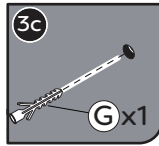

Step 4:

- Mount the 'Bar Heater' (A) onto the 'Bracket' (E) and 'Fixing Plate' (I) and feed the 'Power Cable' (B) through the pre-drilled cable hole in the wall. Secure the 'Bar Heater' into place by using the 'Grub Screws' (F) provided and tighten with an 'Alan Key'. Ensure the 'Bar Heater' is level using a spirit level.
- Proceed to connecting the cable to your chosen 'Fused Spur Switch'. (See Electrical connection)

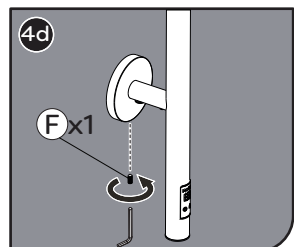
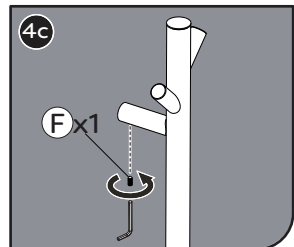
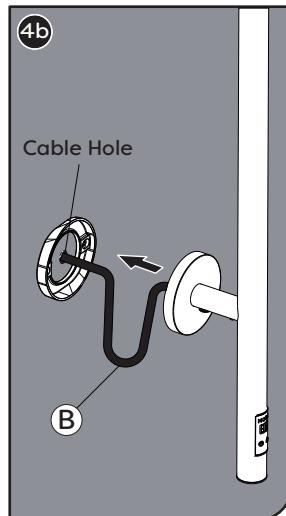
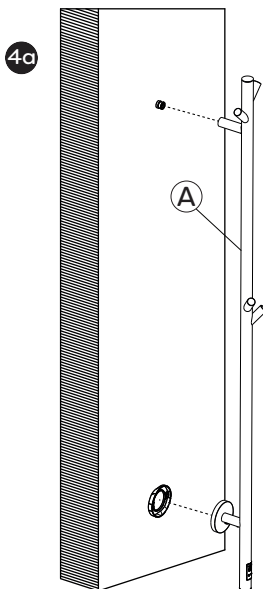

Electrical Connection:

WARNING: Before you begin, ensure the mains power supply is switched off prior to connection!

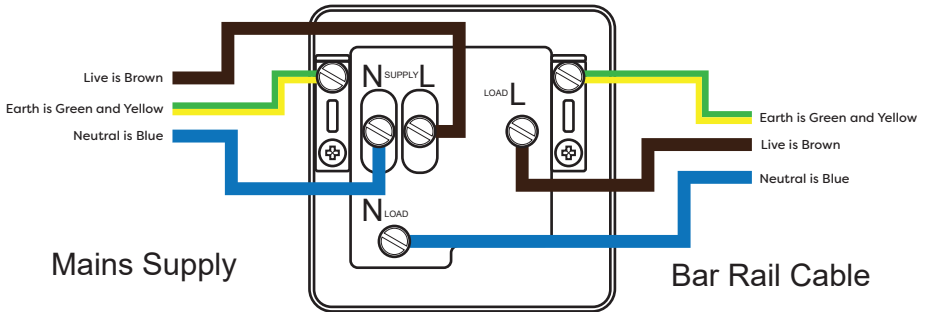

Connect the bar rail cable and mains supply to a fused spur switch according to the wiring diagram. Ensure that there are no exposed wires upon completed installation.





Diagrams are for illustration purposes only. Your switch may superficially differ from this drawing. Refer to the instructions of your chosen switch for guidance is needed

Timer Settings

1. Continuous Operation



- Press/Hold the  button for 3 seconds to switch on the dryer, the dryer will start to warm up (all lights on).
- Press/Hold the  button again to switch off the dryer, the dryer will stop heating.

2. Time Booster

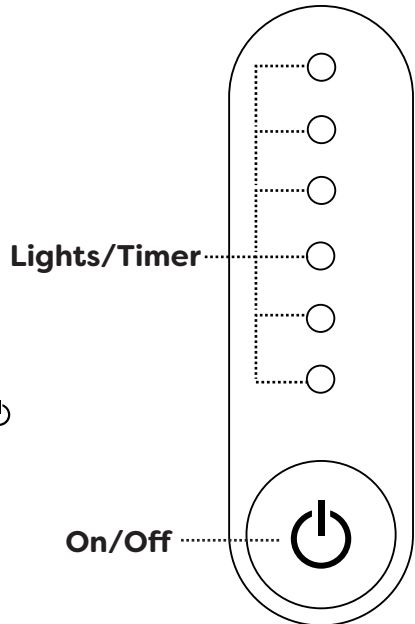

- Pressing the  button once will activate the timer function.
- One light stands for 2 hours. Pressing the  button again turns on more lights and sets the different working times. After 3 seconds, the light will flash twice and starts heating. The lights will countdown and turn off automatically.
- Pressing the  button at any time will turn off the Towel Dryer.

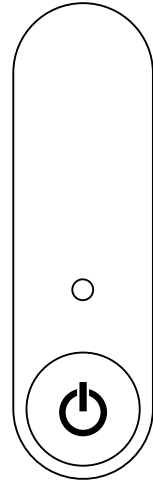

3. Timer for 24-Hours

- Pressing the  button once will activate the timer function.
- Pressing the  button to choose the time you want, hold the  button for 3 seconds, the indicator light will flash twice.
- The towel heater starts heating for the set time and counts down the time.
- The towel dryer will automatically switch off after the timer counts down goes to zero and goes into sleep mode.
- The indicator light will flash intermittently to indicate the towel dryer is in sleep mode. The towel dryer will automatically switch on at the same time when you initially activated the timer. (E.g.: If the timer was set at 7am for 2 hours, the towel dryer will automatically turn on each day at 7am for 2 hours, then turn off.)



The timer can be stopped at any time by pressing the  button at any time. The dryer will the automatically switch to sleep mode. Pressing the  button once more, will cancel the 24hr timer and towel dryer is turned off completely.

Trouble Shooting:

PROBLEM	ACTION
No response to pressing the switch button	Ensure the power supply is switched on. Check that the wires are fully connected to the switch.

Product Disposal:

This product should not be disposed as general waste, but should be brought to the appropriate collection point for recycling of electric and electronic devices.

Information on the appropriate point for used devices can be provided by your local authority, product distributor or from where the product was purchased.

Aftercare:

Always clean the surface of towel heater to keep it bright. **Attention:** please do not use inappropriate tools such as sharp brushes, rough sponges, scouring pads or corrosive detergent to clean the towel heater. Please clean the towel heater by wet cloth and soapy water after each time of usage. Then rinse the soap out with clean water and dry with a soft cotton cloth.

www.victorianplumbing.co.uk