

Flush Plate for Concealed Cisterns

Before you Begin:

- This instruction shows how to fit the flush plate. Ensure the part is the correct size and fit in conjunction with your chosen compatible concealed cistern.
- Unpack the product then read these instructions before proceeding. Inspect the product for damage. If any damage is found, contact our Customer Relations team.

Item included:

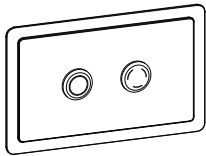

Flush Plate

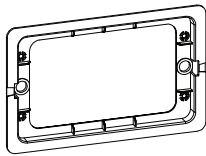

Fixing Plate



Bolts (x2)

Note: Diagrams are for illustration purposes only. Your Flush Plate may superficially differ from this drawing however the installation guide steps still apply.

1

Connect the 'Fixing Plate' to the plastic frame. Ensure the plate is fully clipped into place.

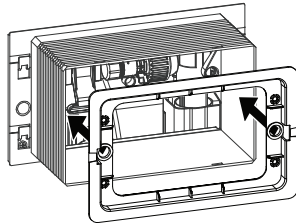

2

Secure the 'Fixing Plate' into place using the 'Bolts' provided.

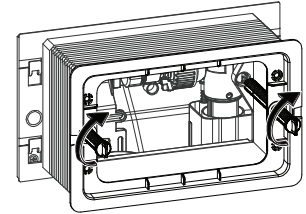

3

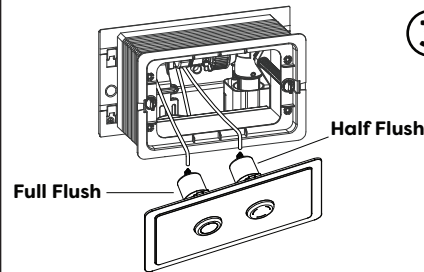

Connect the vacuum pipes from the flush valve, to the appropriate fixings on the rear side of the 'Flush Plate'.

Note: Ensure the pipes are aligned to the correct flush button.

4

Align the 'Flush Plate' with the plate frame. Once aligned, press inwards until the 'Flush Plate' is fully inserted into place.

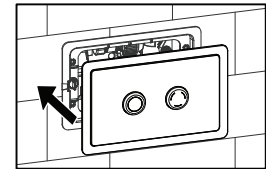

Note: To disassemble; insert a flat-head screwdriver into the side of the 'Flush Plate' and carefully pull it outwards.

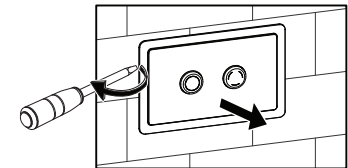

Recycling and Disposal:

- Please recycle the packaging in accordance with your local government regulations on waste handling and follow the same advice at the end of the products life.

Cleaning and Aftercare:

- Warning:** Do not use abrasives, scourers, bleach or any type of chemical cleaning solution when cleaning the overflow cover. It is recommended to use warm soapy water and a clean damp cloth.