

Beautifully Traditional

ARCADE™

TECHNICAL DETAILS

For full technical details on all our products,
please visit our website www.arcadebathrooms.com

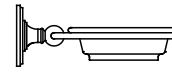

Arcade wall mounted
china soap dish - nickel

ARCA1 NKL

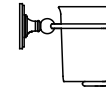

Arcade wall mounted
china mug & holder
- nickel

ARCA2 NKL



Arcade wall mounted
towel ring - nickel

ARCA3 NKL

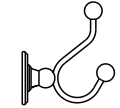

Arcade wall mounted
double robe hook - nickel

ARCA4 NKL

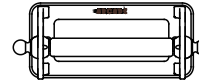

Arcade wall mounted
paper roll holder with
ceramic bar - nickel

ARCA5 NKL

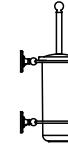

Arcade wall mounted
brush & china holder
- nickel

ARCA8 NKL



Arcade wall mounted
robe hook - nickel

ARCA14 NKL

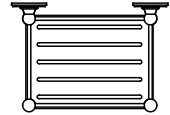

Arcade wall mounted
sponge basket - nickel

ARCA15 NKL

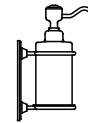

Arcade wall mounted
single soap dispenser
ceramic - nickel

ARCA19 NKL

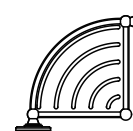

Arcade wall mounted
corner basket 62mm
deep (215mm by 215mm)
- nickel

ARCA22 NKL



Arcade wall mounted
wire basket 62mm deep
(155mm by 330mm)
- nickel

ARCA23 NKL

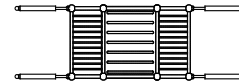

Arcade bath mounted
extendable bath rack
- nickel

ARCA27 NKL

INSTALLATION INSTRUCTIONS

FUTURE CARE

Please read these instructions carefully and keep in a safe place for future reference.
The product is 100% brass nickel plated with polished stainless steel screws.
The product should only be cleaned with soapy water, and dried with a soft towel.





MAINTENANCE

Please do not use any detergent containing hydrochloric acid or caustic chemicals.
Avoid scratching the surface with hard objects, and do not use a coarse cloth to wipe.
The product should be installed by a professional, following the recommended installation instructions.

INSTALLATION INSTRUCTIONS

Please follow the diagrams to install the accessories onto the wall.

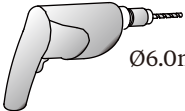
Tools required:

	
 Ø6.0mm	

①

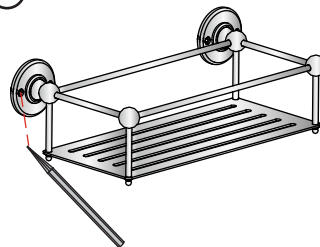

Determine the final installation position, mark the fixing hole positions in pencil.

②

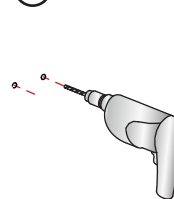

Using a 6mm drill bit, drill holes in the marked positions.

③



Insert the rawl plugs into the drilled holes.

④

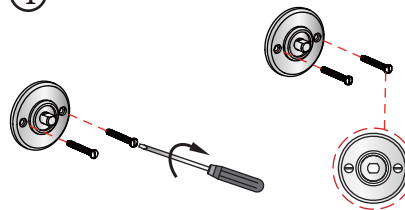

Screw in the stainless steel screws to secure the base to the wall.
Please ensure that the screw heads are horizontally level.

⑤

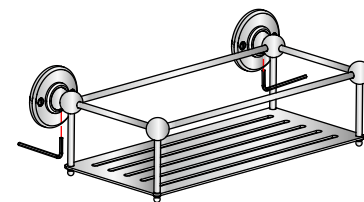

Insert the basket body into the base.
Fix it with the allen key supplied.