

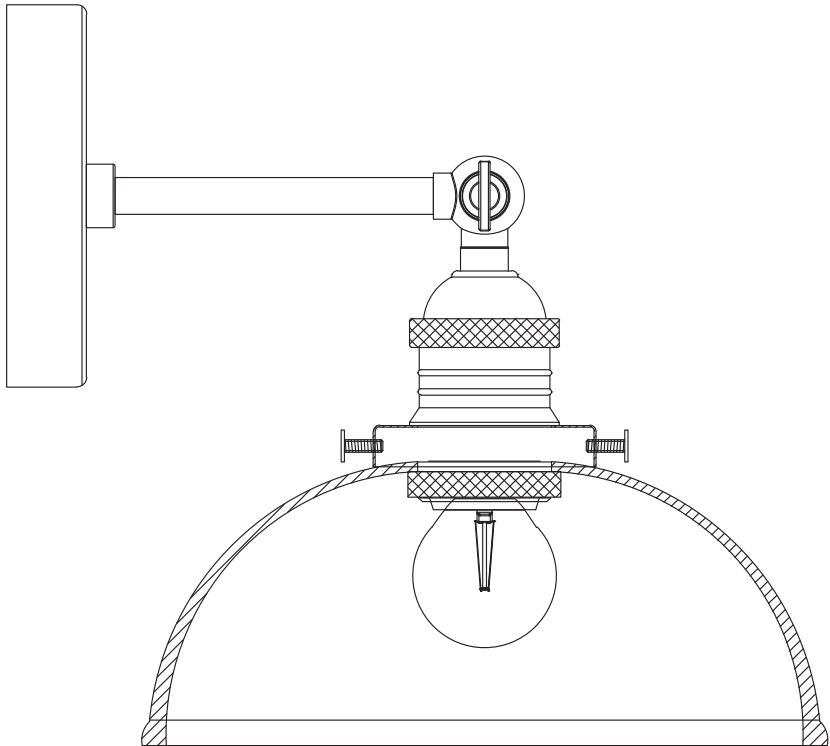

Alchemy Wall Light



Fitting Instructions

Please follow them carefully and
leave this manual with end user

Important Information

Before installation, please read this guide carefully.

1. **We recommend that this product is installed by a qualified tradesperson.** Victorian Plumbing Ltd. accept no liability for products incorrectly installed or any damage to the floor, walls, lighting or personal injury during installation.
2. Observe all local building codes & regulations.
3. **Ensure the incoming mains power supply is switched off prior to commencing the installation.**
4. Unpack the product then read these instructions before proceeding. Inspect the product for damage. If any damage is found, contact our Customer Relations team.

Installation:

1. Position the wall light in a suitable location (according to the zonal diagram) ensuring that the domestic electrical mains supply is within reach of the electrical entry point of the product.
2. Carefully mark the position of the wall light mounting points using a soft pencil. Ensure that all marked mounting points accurately match up with the fixing points on the wall light.
3. Before drilling, ensure there are no hidden cables or pipes behind the mounting points. Using a suitable drill bit, carefully drill holes in the marked positions to a suitable depth.
4. Insert the rawl plugs level with the surface of the wall. For plasterboard walls, specialist fixings should be purchased.
5. Line up product with the marked fixing points, feed mains supply through the lights base and screw into place.
6. Connect the domestic mains supply to the terminal block according to the wiring diagram.
7. Switch the domestic electrical mains supply back on.

Electrical Connection:

WARNING: Before you begin, ensure the mains power supply is switched off prior to connection!

Connect the light cable and mains supply to the terminal block according to the wiring diagram. Ensure that there are no exposed wires upon completed installation.

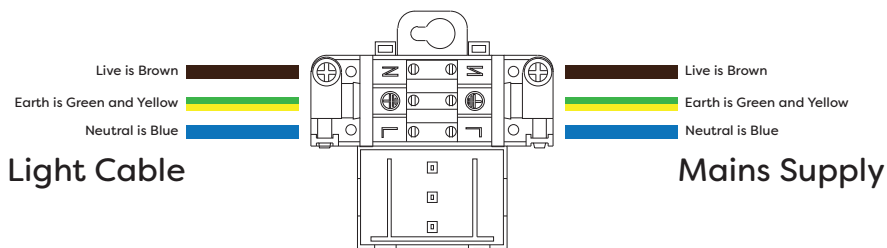
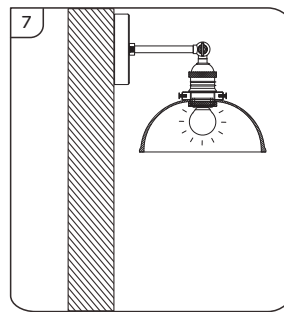
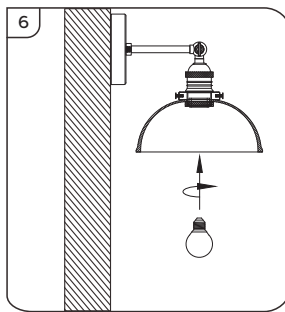
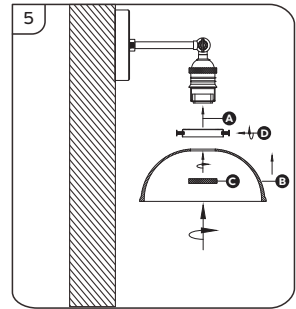
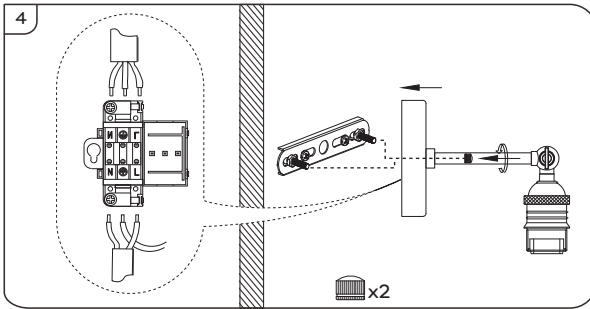
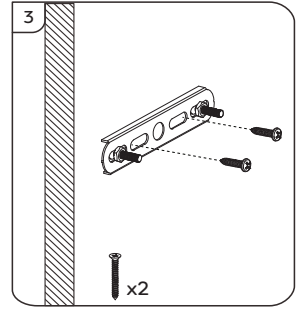
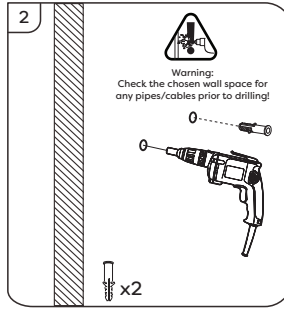
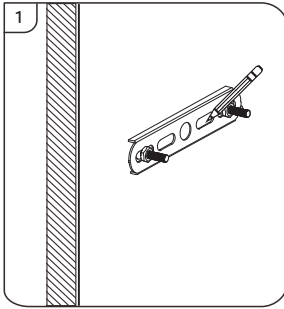

Diagram:



Diagrams are for illustration purposes only. Your wall light may superficially differ from this drawing however the installation guide steps still apply.

Maintenance & Cleaning

- **Caution** - Always disconnect the power supply when servicing or cleaning.
- Use a clean dry soft cloth.
- Do not use abrasive cloths or polishes as this may cause damage to the product.

Safety Information

- We always recommend installation by a qualified electrician.
- This product is produced in conformity with all relevant safety regulations.
- To reduce the risk of fire, electrical shock, or personal injury, always turn off and unplug lamp and allow it to cool prior to replacing light bulb.
- Ensure the power is switched off from the mains before cleaning or carrying out maintenance.
- Do not attach your new light fixture wiring to any existing wiring that shows signs of wear and tear,
- When changing the bulb ensure that the power supply has been disconnected and the bulb has cooled down before replacing.

Zonal Diagram:

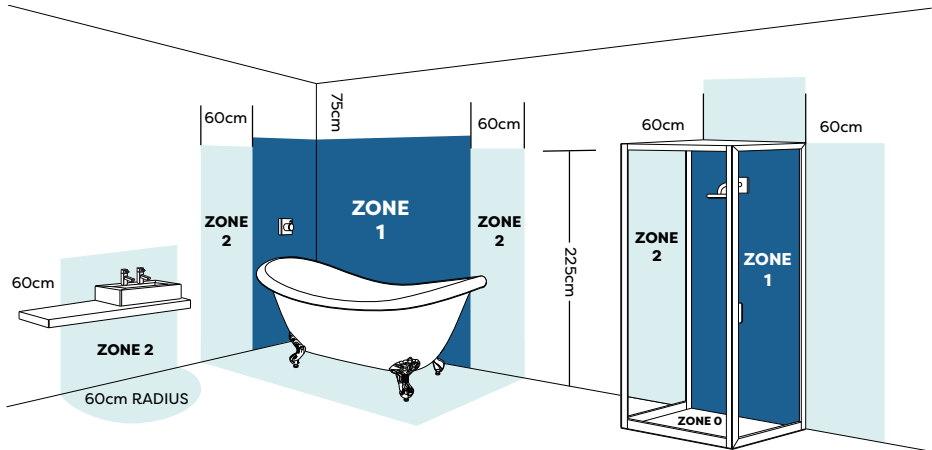

Recycling and Disposal:

Please recycle the packaging in accordance with your local government regulations on waste handling and follow the same advice at the end of the products life.