

AFTERCARE INSTRUCTIONS

Your fitting has a high quality finish and should be treated with care to preserve the visible surfaces.

All surface finishes will wear if not cleaned correctly, the only safe way to clean your mixer is to wipe with a soft damp cloth. Stains can be removed using washing up liquid. All bath cleaning powders and liquids will damage the surface of your fitting, even the non-scratch cleaners. **NOTE: Never use abrasive detergents or disinfectants or those containing alcohol, hydrochloric acid or phosphoric acid.**

GUARANTEE

All products are manufactured to the highest standards and a 5 year guarantee covers any defect in manufacture.

NOTE: The 5-year guarantee on the cartridge is invalidated if damaged by any waterborne debris.

All products must have access for servicing or replacement during the life of the product.

In the interests of continuous product development we reserve the right to alter specification as necessary

PRODUCT CODE:

PRODUCT IDENTIFICATION CODE LASER ETCHED ON PRODUCT

Installer please fill in code here _____.(Where applicable)

TELEPHONE HELPLINE! +44 (0)844 701 6273

Bristan Group Limited
Birch Coppice Business Park
Dordon
Tamworth
Staffordshire
B78 1SG
UK
A Masco Company
Website: www.bristan.com
Telephone: +44 (0) 844 701 6274
Facsimile: +44 (0) 844 701 6275
Email: enquire@bristan.com

BRISTAN

Luxury Bottle Trap

Fitting Instructions & Contents List

Please keep these instructions for future reference and request of replacement part

INSTALLATION

N.B. Before installation, please write the name and product code of your fitting in the space provided overleaf. This will ensure a speedier service if you should need to phone the helpline.

1. Identify all components and check for completeness, particularly before commencing installation.
2. Fit the rubber washer (6) to the trap (7) and assemble with body (5).
3. Fit one locking ring (3) over horizontal tube (9) and assemble with body (5) using tapered rubber washer (8) as a seal.
4. Push plastic trap tube (4) fully into body (5).
5. Fit two locking rings (3) onto vertical tube (2), push tube inside plastic trap tube, adjust to required length and secure with lower locking ring.
6. Place shroud (10) over horizontal tube (9) and connect to waste pipes (1 1/4" BSP - not supplied).
7. Using rubber washer (1) as a seal, connect vertical tube (2) to basin waste (not supplied) using the upper locking ring (3) from point 5.
8. Check all joints and connections for leaks.
9. See back page for aftercare instructions.

INSTALLATION DIAGRAM

CONTENTS

1. Rubber Washer	(x1)
2. Vertical Tube	(x1)
3. Locking Ring	(x3)
4. Plastic Trap Tube	(x1)
5. Trap Body	(x1)
6. Rubber Washer	(x1)
7. Trap	(x1)
8. Tapered Rubber Washer	(x1)
9. Horizontal Tube	(x1)
10. Shroud	(x1)

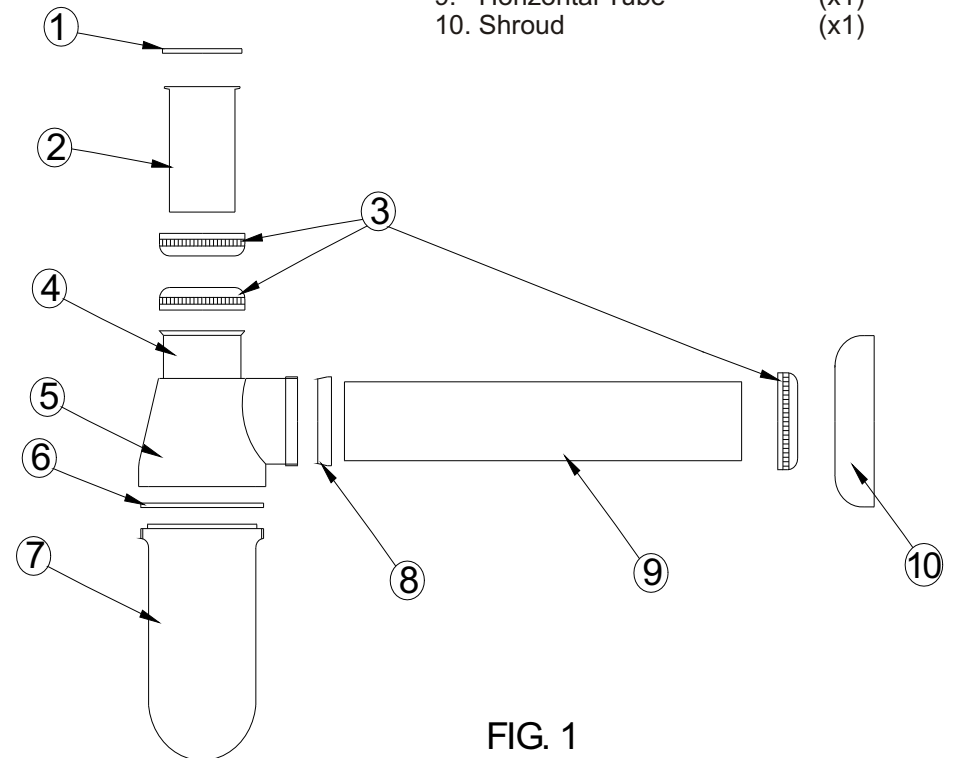

PLEASE NOTE:

In the unlikely event you find a part missing, please contact our Customer Service helpline on **0844 701 6273** for immediate dispatch of part