

Installation and operation instruction

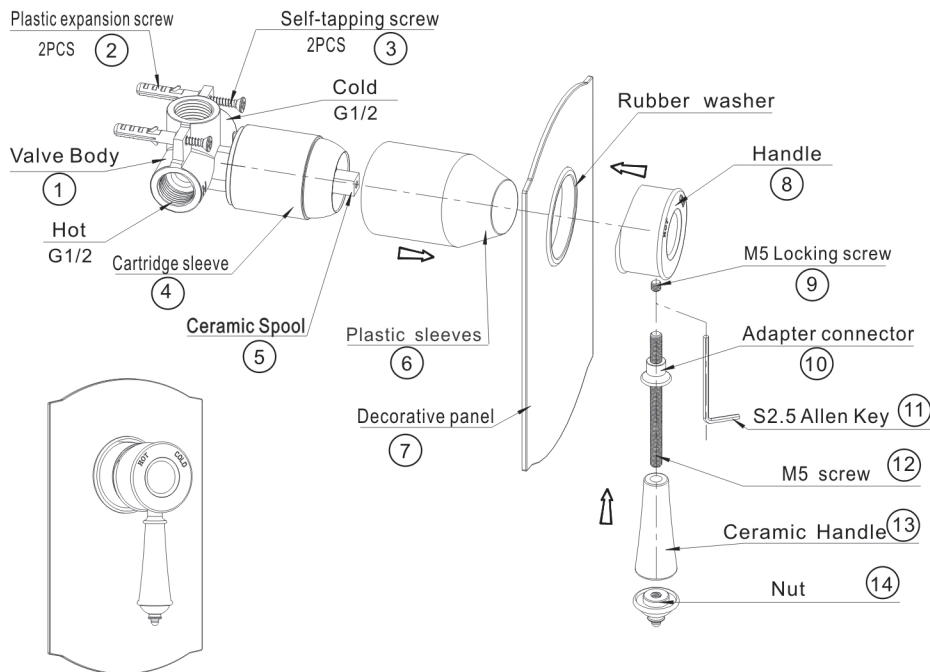

1. Place two plastic expansion screws (2) on the wall, and then use two SS304 self-tapping screws (3) to fix the valve body (1) on the wall (pay attention to the position and levelness between the valve body, floor and wall).
2. Connect the cold/hot water inlet pipe to the two G1/2 inlet holes of the valve body (1).
The outlet connector connect to shower pipe.
3. Decorate the wall tile surface.
4. Pull out Plastic sleeves (6), then covered Cartridge sleeve (4) by Decorative panel (7).
5. Removed 14, 13, 12, 10 one by one from Handle (8).
6. Handle (8) covered on Ceramic Spool (5), then use S2.5 Allen Key (11) to lock M5 Locking screw (9).
7. Wring M5 screw (12) into Handle (8), then assemble Adapter connector (10) and Ceramic Handle (13), then fix Ceramic Handle (13) use Nut (14).
8. check all joints and connections for leaks.



Victorian Plumbing

Diamond House.41, Stephenson Way. Formby Business Park Formby. England. L37 8EG

Tel: 0044 800 862 0878

Website: www.victorianplumbing.co.uk