

SILVERDALE  
GREAT BRITAIN

Low Level W.C

INSTALLATION INSTRUCTIONS

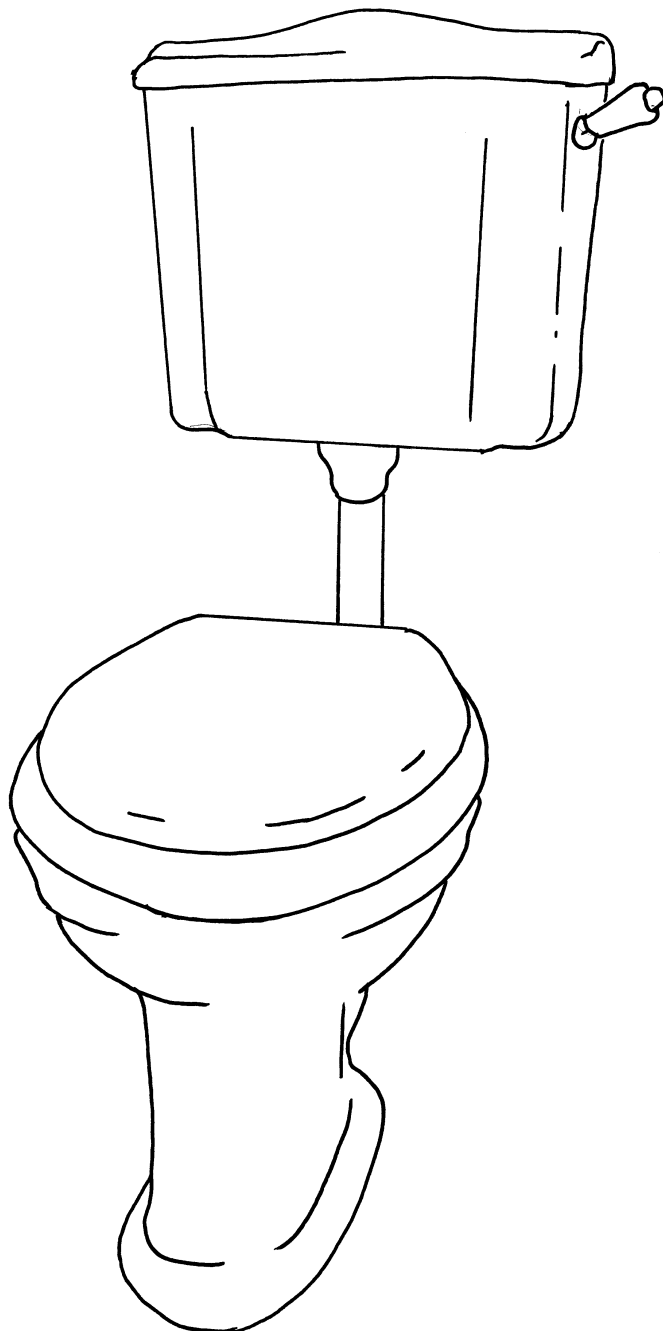

# Installation Instructions

## GENERAL INFORMATION:

### ON RECEIPT OR YOUR W.C SUITE:

Please inspect all ceramic items for transit damage prior to installation. Do not attempt to install damaged items, contact your supplier.

### PRIOR TO INSTALLATION:

We recommend that your W.C suite be connected to a mains water supply. If the cistern fill rate proves to be unsatisfactory, we advise that the restrictor be removed from the inlet valve assembly as illustrated in the care and maintenance section. Please ensure that you have the correct type of soil pipe connector for your installation and that your top flush valve kit is complete.

### WARRANTIES:

Cistern internals – 5 years from purchase date (excludes rubber seals)

Ceramic items – lifetime

### IMPORTANT:

PLEASE LEAVE THIS INSTRUCTION MANUAL WITH THE END USER ONCE THE PRODUCT HAS BEEN INSTALLED.

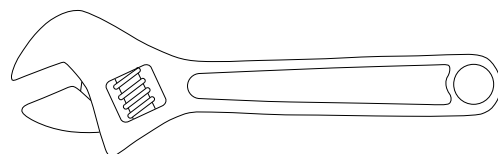
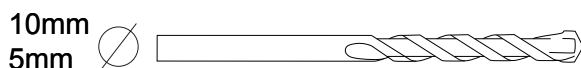
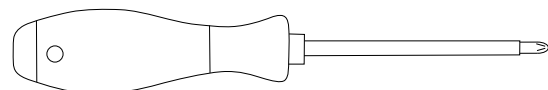
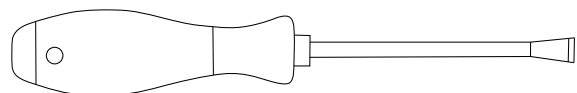
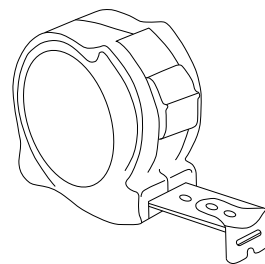
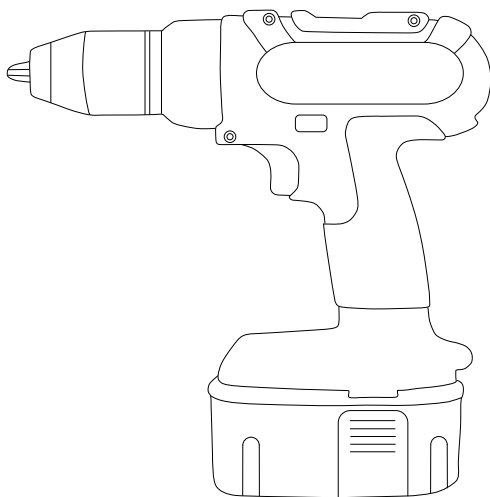

Tools required.

# Installation Instructions

Identify the lever that your cistern requires and assemble as per instructions

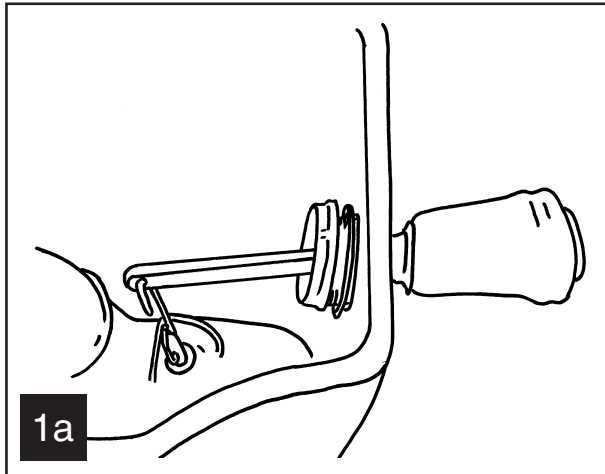

Side Lever  
Pass the lever through the hole in the cistern  
Slide the siphon link through the hole in the lever  
Tighten the nut to secure ensuring parallel

1b

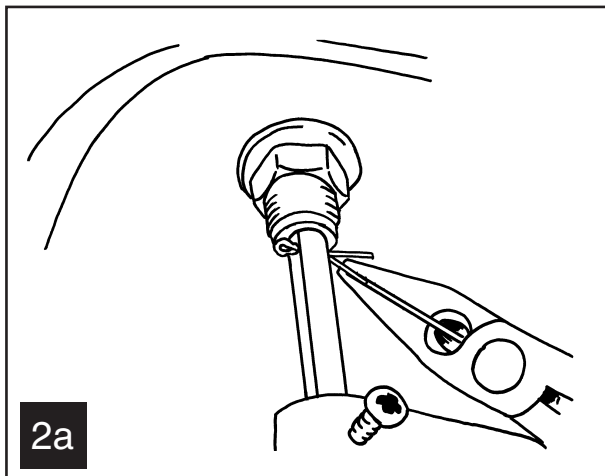

Remove the split pin and washer from the assembly using pliers

2b

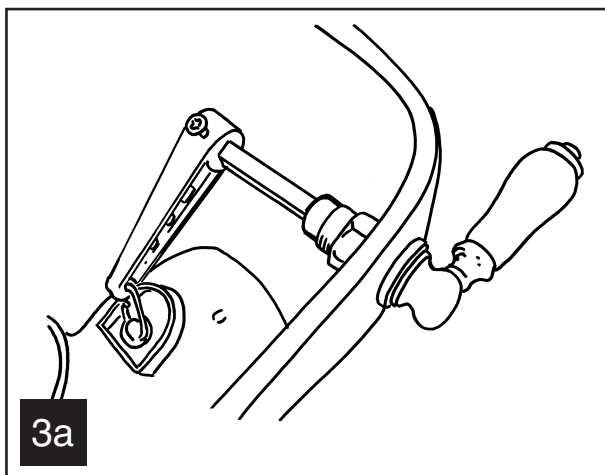

Slide lever through the lever hole in the cistern and tighten the bush on the inside of the fitting.  
Place the siphon link through the lift arm and slide the lift arm onto the shaft of the lever.  
Replace the split pin and washer

3b

# Installation Instructions

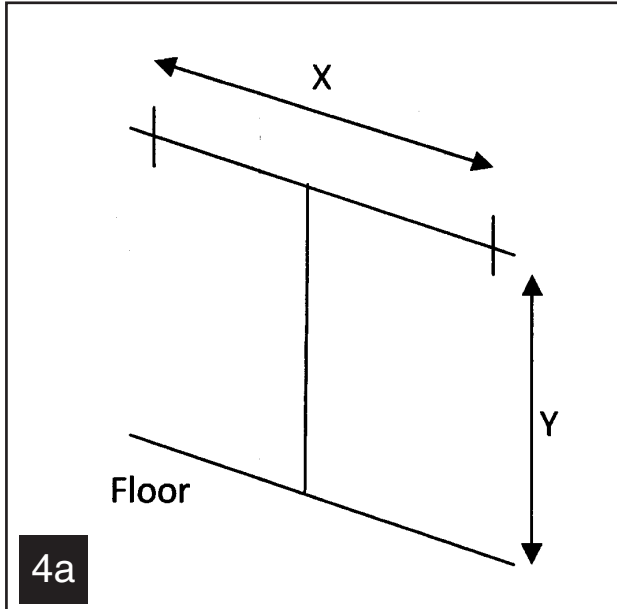

Place the WC into desired position. Measure the appropriate height on the wall and scribe a parallel line appropriate for your cistern as the table below.

	X	Y
Belgravia	327	940
Balasani	327	940
Victorian	327	940
Nouveau	400	895

Due to production tolerances check the distance between centers is correct to your cistern.

If a different height is required adjust as necessary then cut the Pipe to suit remembering that the top of the pipe should only locate into the tail of the syphon 50mm.

**4b**

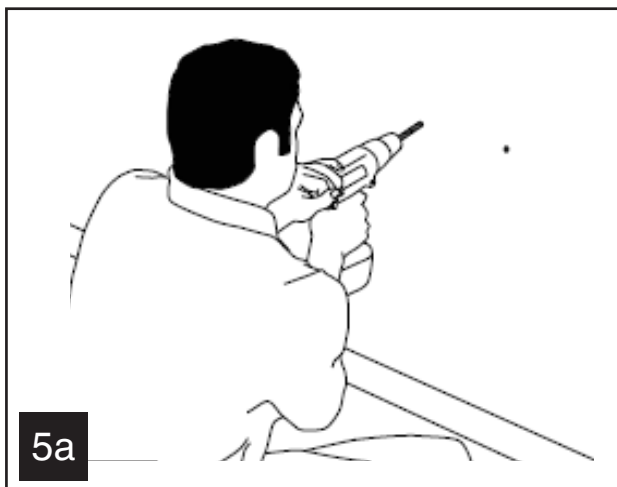

Drill the holes 5mm dia and place wall plugs in the holes. Hang the cistern onto the wall.

**5b**

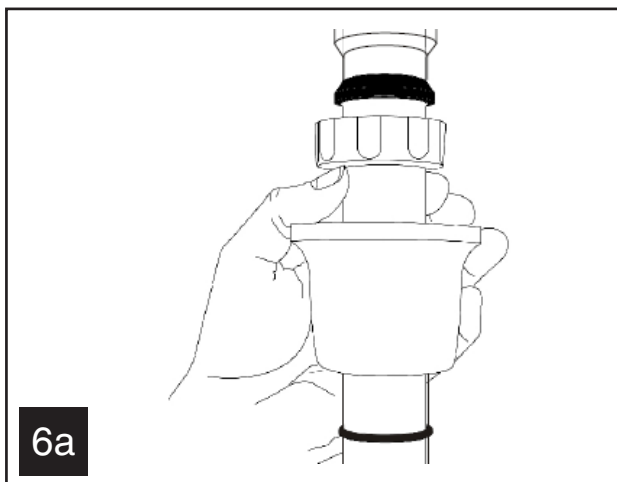

Assemble the upper part of the pipe into the cistern and secure the backnut and seal into the siphon tail.

**6b**

# Installation Instructions

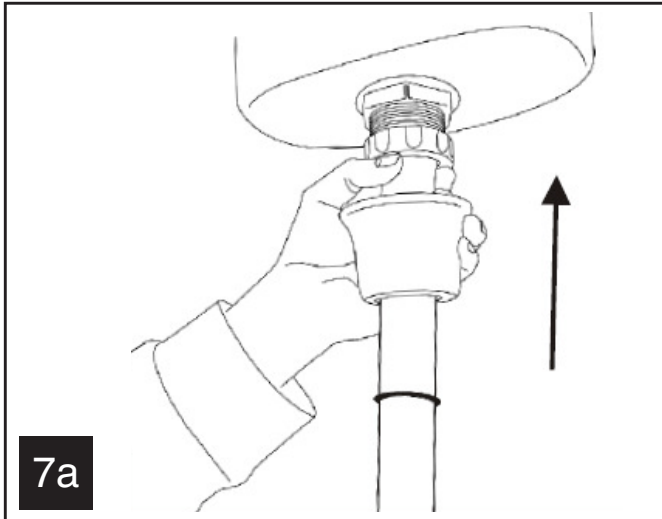

Push the embellisher and oring up to cover the assembly

7b

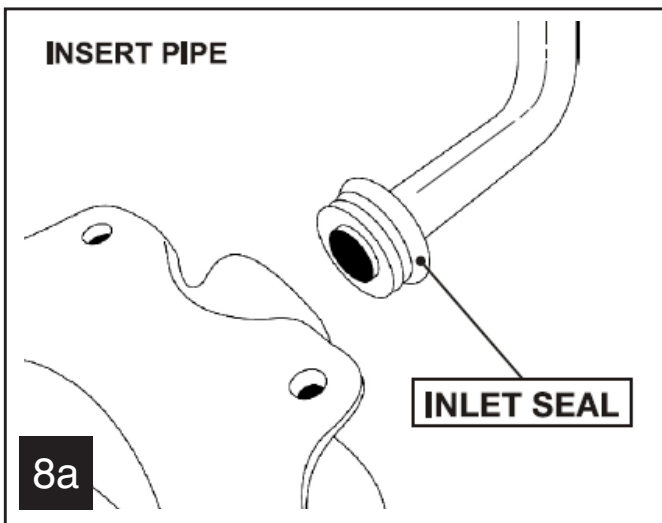

Place inlet seal onto the base of the low level pipe.  
Place the pipe into the back of the pan  
Make the appropriate plumbing connections to waste outlet and cistern supply.

8b

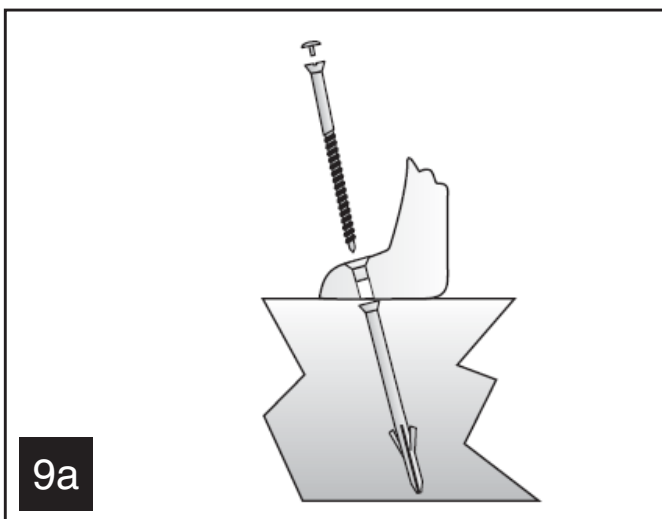

Place the pan into position and mark the hole positions, remove the pan  
Drill and plug the holes with a 7mm drill.  
Replace the pan and assemble as shown.

9b

# Installation Instructions

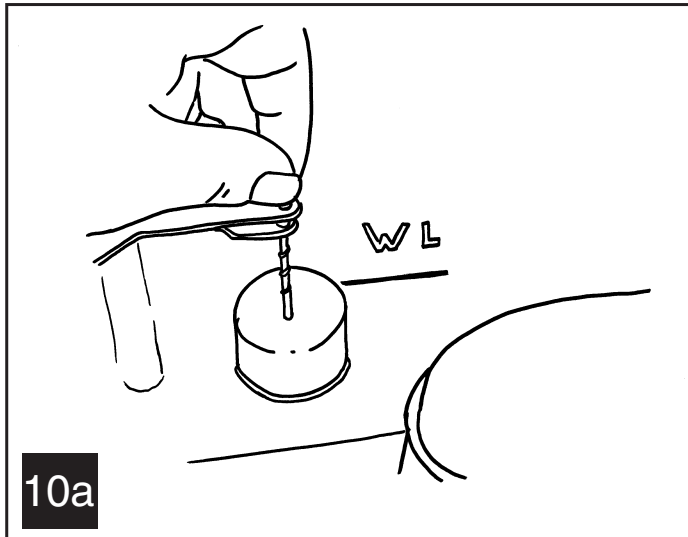

Adjust the float to set the waterline. Flush the WC once, check for leaks and ensure water line is correct.

10b



Silverdale Bathrooms

UK Manufacturers of Luxury Ceramic Brands

Silverdale Road Newcastle under Lyme Staffordshire ST5 6EL

Tel: 01782 717175

Facsimile: 01782 717166

Email: [sales@silverdalebathrooms.co.uk](mailto:sales@silverdalebathrooms.co.uk)

WEB: [www.silverdalebathrooms.co.uk](http://www.silverdalebathrooms.co.uk)