

## COVER WC FLOOR - WALL TRAP

- I A PARETE:** Predisporre la parete con i fori di carico e scarico dell'acqua alle altezze indicate dallo schema sottostante. Installare il W.C. e fissarlo alla parete utilizzando i fissaggi in dotazione.
- GB TO THE WALL:** Prepare the wall by making holes for the filling and draining of the water at the height shown in the picture below. Place the W.C. bowl in position and anchor it to the wall with the fixings provided.
- E A PARED:** Predisponen la pared con los agujeros de carga y descarga del agua según las alturas que se indican en el esquema aquí abajo. Instalen el inodoro y fíjarlo a la pared utilizando los anclajes proveídos
- F A PAROI:** Prédisposer le mur avec les trous de charge et décharge de l'eau aux hauteurs indiquées dans le schéma ci - dessous. Installer le cuvette et fixer - le au mur en utilisant les fixations fournis.

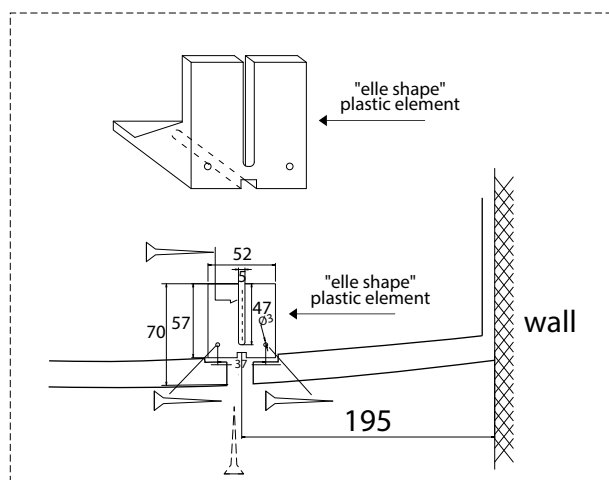

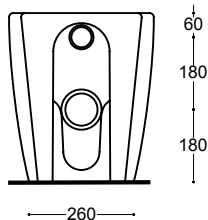
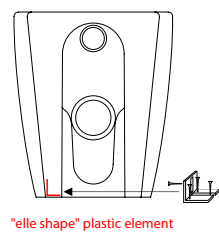
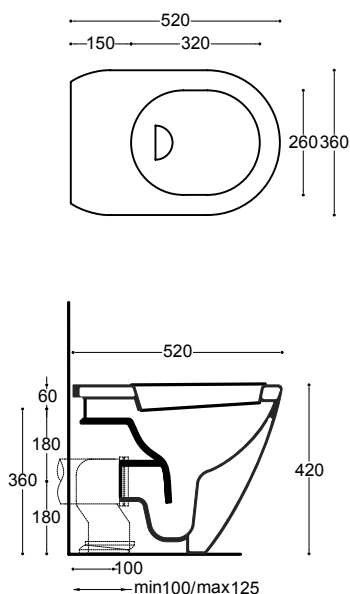
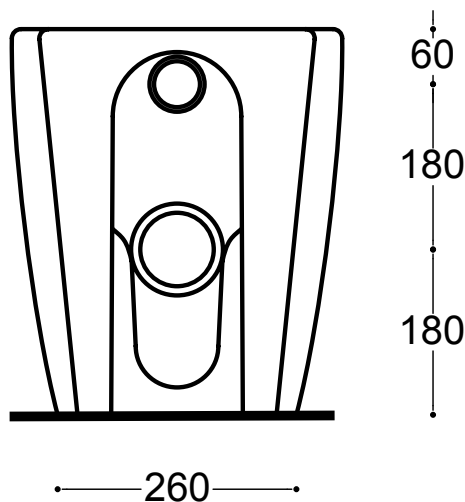
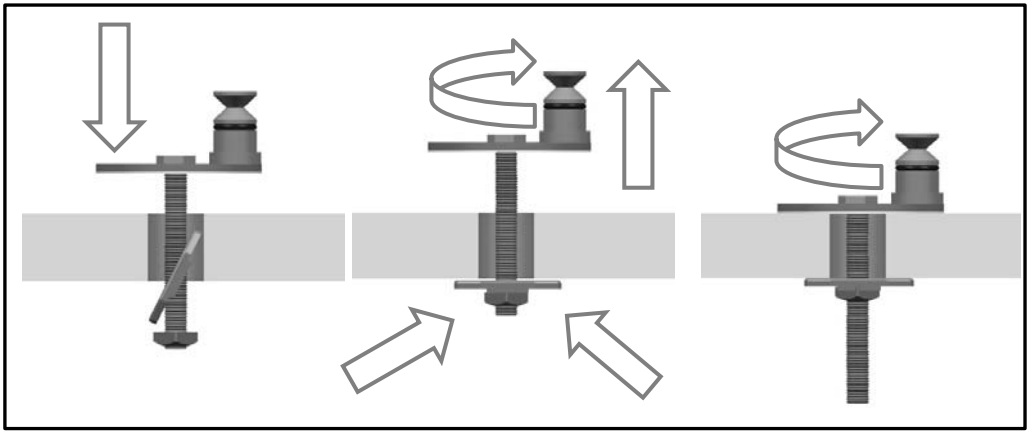

BLACK

WHITE

