

AFTERCARE INSTRUCTIONS

Your fitting has a high quality finish and should be treated with care to preserve the visible surfaces.

All surface finishes will wear if not cleaned correctly, the only safe way to clean your mixer is to wipe with a soft damp cloth. Stains can be removed using washing up liquid. All bath cleaning powders and liquids will damage the surface of your fitting, even the non-scratch cleaners. **NOTE: Never use abrasive detergents or disinfectants or those containing alcohol, hydrochloric acid or phosphoric acid.**

Bristan recommend E-Cloth for cleaning all of our bathroom & kitchen products. Using just water, E-cloth gives a smear free, deep clean by breaking up and holding dirt, which normal cloths leave behind. Order through your Bristan stockist. (ORDER CODE: ECLOTH)



GUARANTEE

All products are manufactured to the highest standards and a 5 year guarantee covers any defect in manufacture.

NOTE: The 5-year guarantee on the cartridge is invalidated if damaged by any waterborne debris.

All products must have access for servicing or replacement during the life of the product.

In the interests of continuous product development we reserve the right to alter specification as necessary

PRODUCT CODE:

PRODUCT IDENTIFICATION CODE LASER ETCHED ON PRODUCT
Installer please fill in code here _____.(Where applicable)

TELEPHONE HELPLINE! +44 (0)844 701 6273

Bristan Group Limited
Birch Coppice Business Park
Dordon
Tamworth
Staffordshire
B78 1SG
UK
A Masco Company
Website: www.bristan.com
Telephone: +44 (0) 844 701 6274
Facsimile: +44 (0) 844 701 6275
Email: enquire@bristan.com

BRISTAN

Prism Diverter Valve

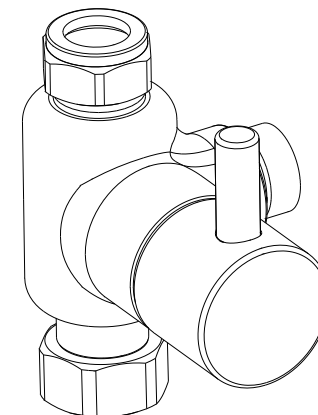

Fitting Instructions & Contents List

Please keep these instructions for future reference and request of replacement part

INSTALLATION

The diverter is designed to be fitted onto the G1/2" male outlet of an exposed shower valve to feed water to a rigid riser or handset and hose.

1. Identify all components, study diagram and check for completeness, particularly before arranging installation.
2. Install the shower valve (not supplied) as directed using the fitting instructions Supplied with that product.
3. Connect diverter (1) to shower valve via nut (2) using washer (3).
4. The vertical tube from the rigid (not supplied) will connect to the diverter via the compression nut (4) and olive (5) or G1/2" female nut with a flat washer or seal. (depending on the rigid riser's specification).
5. Finish fitting rigid riser as per the fitting instructions supplied with flat product.
6. Attach hose to diverter using small rubber washer and handset (not supplied).
7. Turn on shower and operate diverter in both positions using the diverter lever (a) To switch between the rigid riser and the handset. Check all joints and Connections for leaks.

MAINTENANCE

If either fitting begins to drip during operation:

1. Ensure shower control is in the 'off' position.
2. Unscrew lever (a) loosen grub screw (b), diverter head (c) and unscrew valve.
3. Carefully clean seating, rubber washer.
4. Replace valve and handle then test shower.
5. Contact our helpline if problem persists.

CONTENTS

- | | |
|--------------------|------|
| 1. Diverter | (x1) |
| 2. Connecting Nut | (x1) |
| 3. Washer | (x1) |
| 4. Compression Nut | (x1) |
| 5. Olive | (x1) |

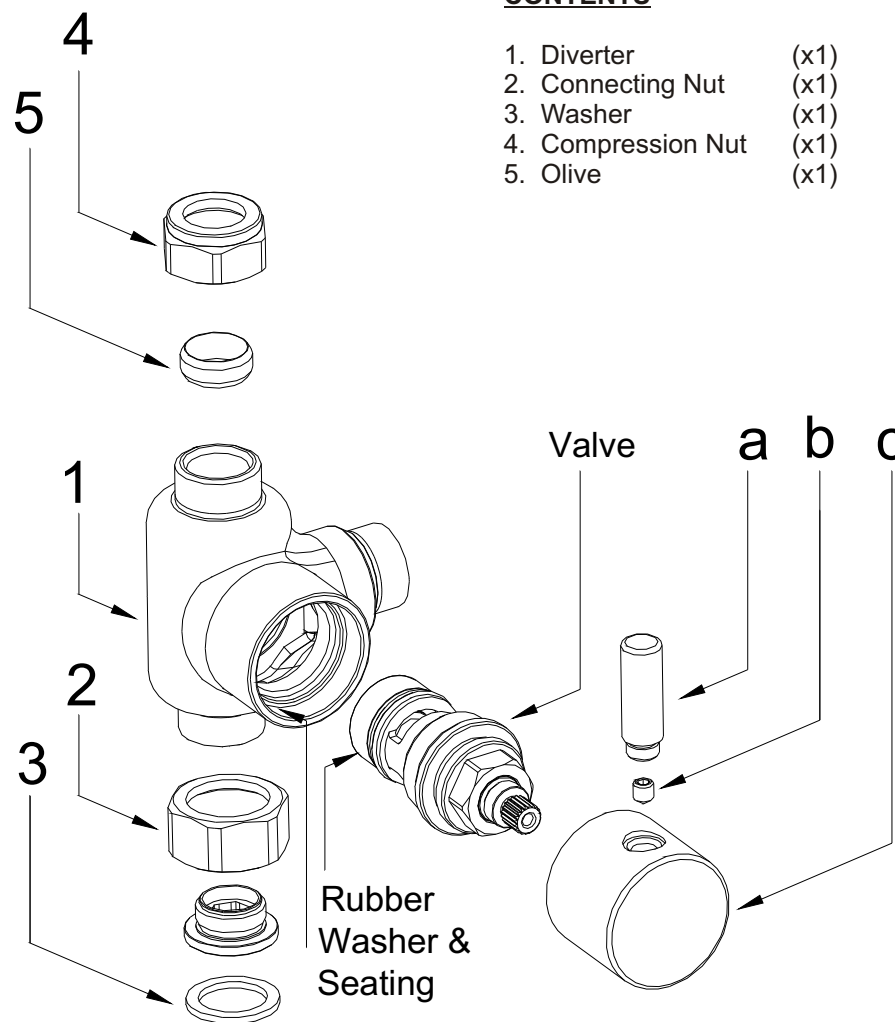

PLEASE NOTE:

In the unlikely event you find a part missing, please contact our Customer Service helpline on **0844 701 6273** for immediate dispatch of part