



## Wall Hung WC

## Fitting Instructions



Before starting any installation project please consider the following:  
Prior to drilling into walls, check there are no hidden electrical wires or cables or water supply pipes with the aid of an electrical detector.  
If you use power tools do not forget:

- Wear eye protection
- Unplug equipment after use
- This is a heavy product & will require a two man lift



Please keep these instructions for future reference and request of replacement parts



## 1. INSTALL THE TANK

- Turn the water supply off before installing the new toilet.
- Install the concealed tank system in wall before decorating the wall.
- Install the tank system per tank's installation instructions.

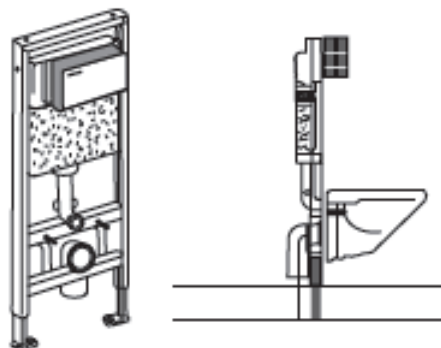

## 2. SET THE SPACING OF THE BOWL

After you install the tank, be careful to set the spacing of the bowl on wall according to the dimensions as shown.

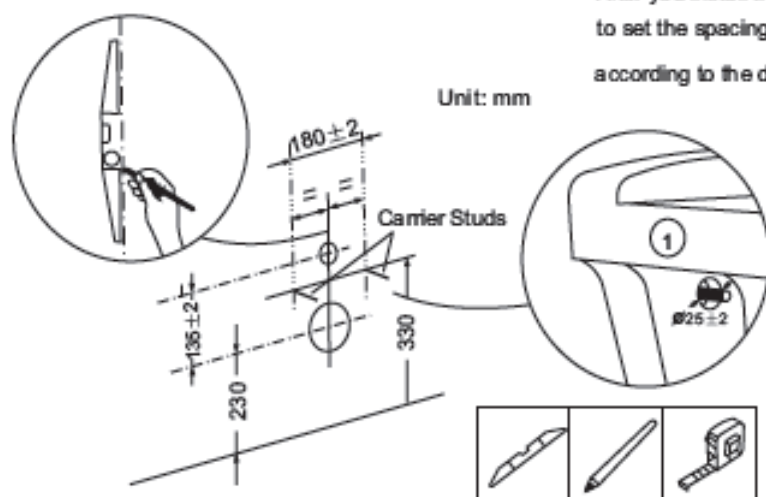

## 3. ATTACH CONNECTION PIPE

- Attach pipe with gasket to the inlet to link to the concealed tank.
- Attach pipe with gasket to the outlet.  
\*Apply gasket for sealing the bowl to wall.
- You may apply some lubricant to help connect smoothly.

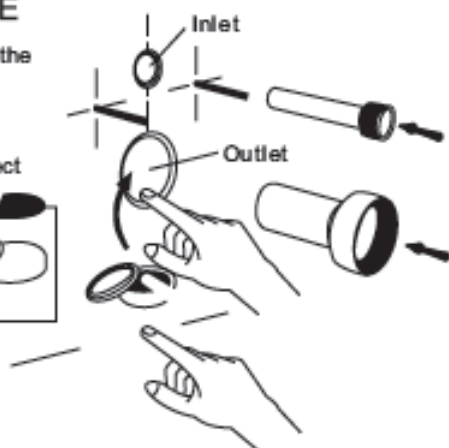
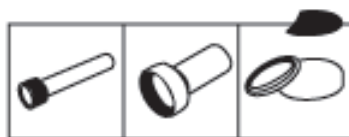

## 4. INSTALL THE NEW BOWL

a) Apply a little silicone sealant along the edge, to fill the gap between bowl and wall. See Fig. 5a.

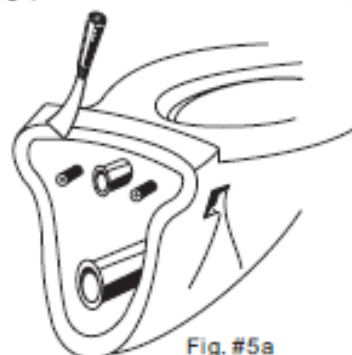

Fig. #5a

b) Place the new bowl on the wall through the carrier. Wrench the nut to tighten and make them attached securely. See Fig. 5b.

- Torque for tightening nuts is recommended to be within the range from 8 Nm to 12 Nm.

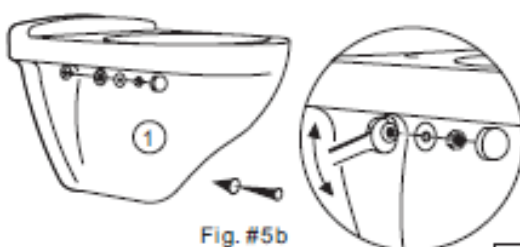

Fig. #5b



c) Adjust to horizontal and finish tightening. See Fig. 5c.

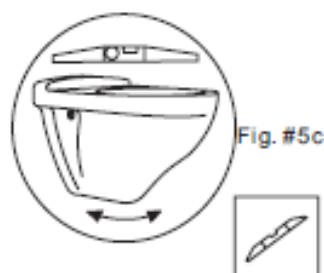

Fig. #5c



d) Apply sealant to make sure the bowl's edge seals to the wall. See Fig. 5d.



Fig. #5d

## Care and Maintenance

Once installed, flush the toilet 2 or 3 times to ensure it is functioning correctly and check all supply and waste connections for leaks.

If the toilet fails to remove solids please check the following:

1. You are pressing the correct button
2. The valve has been set correctly
3. There is no obstruction in the W.C outlet or in the connecting soil pipe.

Clean the exterior of your W.C suite with hot soapy water and a cloth.

*Do not use harsh abrasives particularly on areas displaying the HERITAGE logo.*

### **Aftercare Instructions.**

Your fitting has a high quality finish and should be treated with care to preserve the visible surfaces.

All surface finishes will wear if not cleaned correctly, the only safe way to clean your product, is to wipe with a soft damp cloth. Stains can be removed using washing up liquid. All bath cleaning powders and liquids can damage the surface of your fitting even the non-scratch cleaners.

### **Guarantee.**

All products are manufactured to the highest standards and a 25-year guarantee covers any defect in manufacture.

### **Contact Details.**

**If you require further assistance please contact Heritage Sales and Technical Enquiries:**

**Sales :** 0844 701 8501

**Technical:** 0844 701 8503

**Email:** [Technical@heritagebathrooms.com](mailto:Technical@heritagebathrooms.com)

**Website:** [www.heritagebathrooms.com](http://www.heritagebathrooms.com)

**Heritage Bathrooms  
Unit 6 Albert Road  
St Philips Central  
Bristol  
BS2 0XJ**

