

Installation instructions



Thank you for purchasing this Victorian Plumbing product. Please follow these care instructions to ensure your product retains its high quality finish - **and retain this leaflet for future reference.**

1. Identify all components are present prior to installation
2. Put the Connecting pipe (2) into flange and screw the nut tightly (as show on figure 1)
3. Make the Connecting pipe (2) transferred into the thread of the shower curtain rail(1) (as show on figure 2)
4. Put the shower curtain rail(1) at a predetermined position and make a mark at the position of the screw hole (as show on figure 3)
5. Drill a hole straight into the wall and insert rawl plugs
6. Install the shower curtain rail and ensure screws are firmly fitted

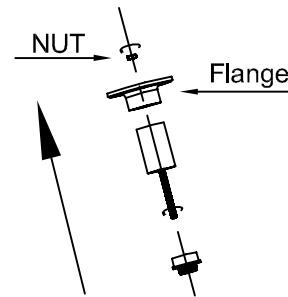

Figure 1

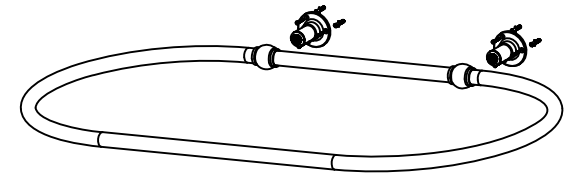
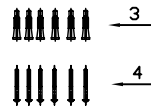
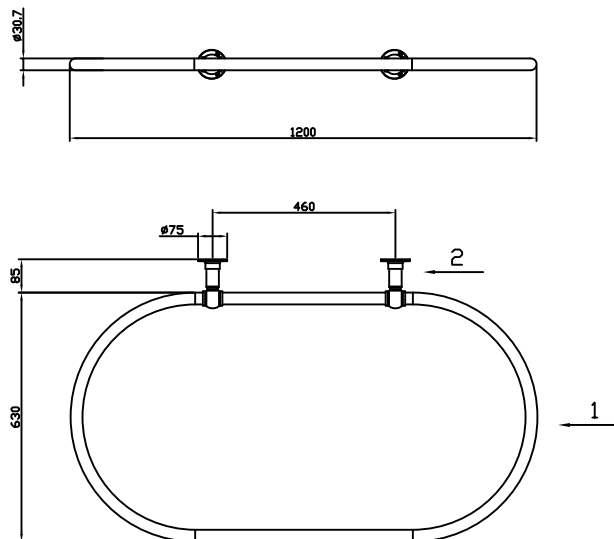

Figure 2



1. Shower curtain rail x 1
2. Connecting pipe x 2
3. Rawl plug x 6
4. Screw x 6

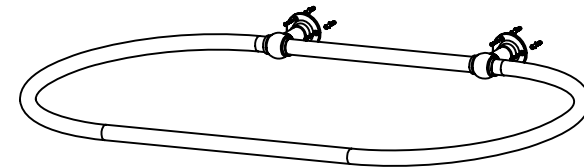

Figure 3

Please Note: Never drill into a wall without checking first for hidden pipes and cables

Victorian Plumbing

Diamond House. 41, Stephenson Way. Formby Business Park Formby. England. L37 8EG

Tel: 0044 800 862 0878

Website: www.victorianplumbing.co.uk