



# skylo dual flush height adjustable syphon



## WARNING

We shall not be responsible or liable for any failure of, or damage to, this plumbing product caused by the use of chlorine/bleach cleaners or related products added to the tank water. Use of such products will void the warranty and may result in product failure, possibly causing property damage. Do not over tighten plastic nuts and always turn off water supply when installing/removing toilet cistern parts.

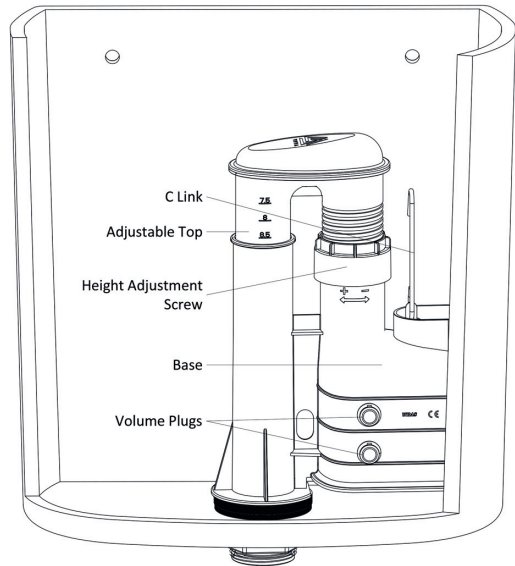

**Please note: Save this instruction sheet for future reference**  
**IMPORTANT: DO NOT use plumber's putty to seal this fitting**

**For more information please contact:**

**VIVA Sanitary**

Units 1-2 Capitol Trading Park, Kirkby Bank Road  
Knowsley Industrial Estate, Liverpool, L33 7SY

**Tel:** 0151 546 0531 **Fax:** 0151 549 4187

**E-mail:** sales@vivasanitary.co.uk

## INSTALLATION INSTRUCTIONS

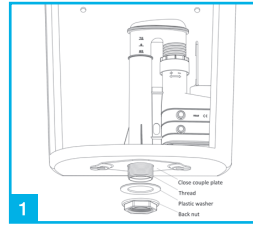

Insert the flush valve into the water tank. Slide close couple plate over syphon thread and tighten to the tank using the washer and nut.

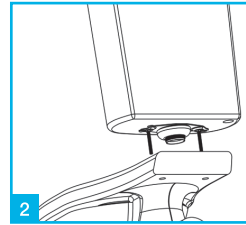

Fit doughnut washer and bolts and secure cistern to pan with wingnuts.

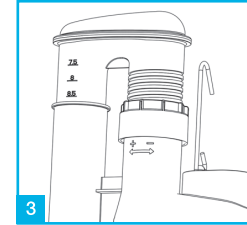

To adjust the height of flush valve twist the height adjustment screw and set to the desired height.

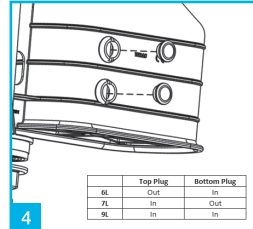

The flush volumes can be adjusted by removing the volume plugs. (Please refer to guide above)

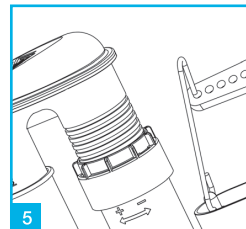

To operate flush valve connect the c link to the toilet handle lever arm.

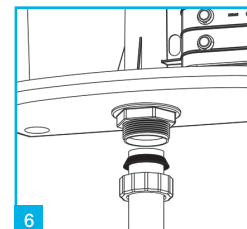

Low level installation does not require a close couple kit. Slide back nut and conical washer over the flush pipe and insert flushpipe into base of flush valve and secure with back nut.

## Dual flush operation

### Full Flush

*(Depress and release)*



### Half Flush

*(Depress and hold)*



Operating the dual flush function is really easy, when flushing your toilet depress and release for a full flush, depress and hold for a half flush. This will only flush half the water in your tank. Saving water and money.

## Internal Overflow

Water will internally overflow into the toilet pan when the water level reaches the spill over point.

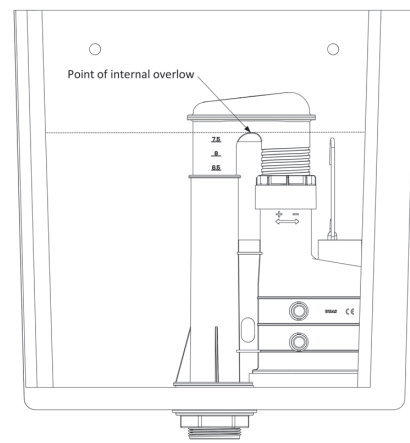

## TROUBLESHOOTING

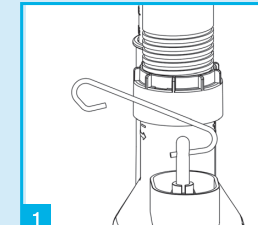

Remove c link by rotating until loose.

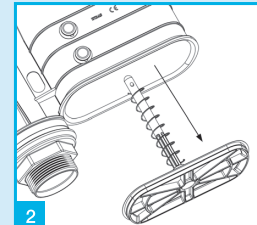

Slide stem through base to access the suction unit.

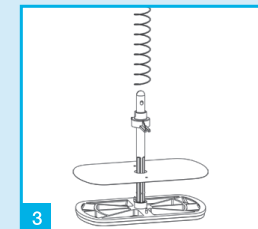

Remove spring and clip then replace the diaphragm washer.

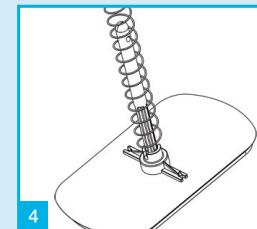

Once diaphragm washer has been replaced, secure clip and re-fit spring.

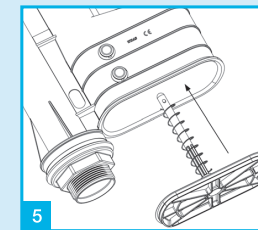

Slide suction unit back through the base.

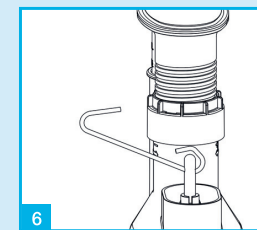

Re-connect c link to stem.

Installation videos and further information available now.

