



You're Guide to the Installation, Care and Maintenance of

3-Way Struana and 3-Way Ceto dispensers



Struana
Chrome Plate
4B8050



Ceto
Chrome Plate 4B8020
Brushed Nickel 4B8021

SYSTEM REQUIREMENTS:

The Francis Pegler/ BRITA Inline filter dispenser with BRITA P 1000 filter cartridge is designed to improve the taste and appearance of mains treated tap water for the preparation of hot and cold drinks and food.

The BRITA P 1000 water filter cartridge must only be connected to a potable cold water supply. Do not use a BRITA filter where water is microbiologically unsafe, or with waters of unknown quality without appropriate sterilisation.

WATER SOFTENERS. This product can be fitted alongside a water softener. Please refer to the additional installation instructions on page 10. Softened water should not be put through the BRITA filter cartridge.

The 3-Way Struana and 3-Way Ceto models have been designed to function under the following conditions.

- Ambient temperature operation 4°C - 40°C
- Storage/transport: -20 - 50°C
- Minimum supply pressure on cold side: 1.0 bar (cartridge optimum pressure 2bar)
- Maximum supply pressure on cold side: 6.0 bar
- Minimum supply pressure on hot side: 0.1 bar
- Maximum supply pressure on hot side: 6.0 bar
- Water temperature on cold side 4°C - 30°C
- In order to provide a consistent flow, supplies of hot and cold water to the sink mixer should be at equal (balanced pressure)
- To gain the best performance from the BRITA filter cartridge, please ensure that the cartridge is not exposed to temperatures below 4°C or in excess of 30°C

Water regulations requirements

It is important to ensure that the water supply to your 3-Way Struana or 3 way Ceto is connected in accordance with the water regulations (WRAS) requirements and good plumbing practice.

It is a water regulation requirement to fit double check valves on the inlets of your current kitchen taps, especially if the water is single flow and therefore mixes within the spout or body of the tap. The 3-Way Struana and the 3-Way Ceto are single flow dispensers and require non-return valves to be fitted in order to comply with these regulations.

For installation in-line with these regulations it is both BRITA and Pegler's recommendation and good plumbing practice that the supplies of hot and cold water to the sink mixer should be at equal (balanced) pressures in order to provide a consistent flow. Supplies should be from a common source, either mains or tank fed but if supplies are not equal pressures then non-return valves should be fitted (not supplied). To achieve this please order Pegler Prestex 802 check valve: order reference code 551001 (15mm).

It is both Pegler and BRITA's recommendation and good plumbing practice that a service valve should also be installed in both the inlet supply lines upstream of the product, for ease of any future maintenance.

To satisfy this requirement and that stated above we recommend you fit Pegler Prestex 8028 combined double check valve and service valve: order reference code 551020(15mm)

A design-tested non-return valve pursuant to DIN 3269-1/DIN 3269—2 DVGW and SVGW has been factory-fitted at the water inlet of the connecting fitting.

PRE-INSTALLATION CHECKS:

1. Ensure that there is sufficient space to install the product:
 - a) Above the sink – make certain that the positioning of the dispenser allows sufficient space for movement of tap handles and for the water to flow directly into the sink.
 - b) Below the sink - make certain that there is sufficient space for the cartridge to be securely mounted and enough space for the cartridge to be easily replaced for exchange. Note the cartridge can be positioned vertically with bracket or horizontally without bracket (e.g. placed on shelf). Cartridge dimensions (including filter head) are 27cm height x 12cm width x 13cm depth plus an allowance of 8cm vertically down for easy removal.
2. When installing the 3-Way Struana or 3-Way Ceto the hot inlet should be on the left hand side and the cold on the right hand side and the filter handle facing the front.

PARTS LIST & DIAGRAM OF WHOLE SYSTEM LINKED

Parts List		
	Description	Pegler Yorkshire Spares Code
A	Complete Dispenser Assembly	Not Available
B	Base Flange	854290
C	LED indicator Cable	854659
D	Inlet Hoses x 2	854291
E	Clamping Stud	854660
F	Clamping Plate	
G	Clamping Nut	
H	Check Valve Housing	854662
I	Battery	854286
J	Battery Tray	
K	PCB Unit	854661
L	Bracket	Call 0845 0770 035
M	Filter Head	Call 0845 0770 035
N	BRITA P 1000 water filter cartridge	Call 0845 0770 035
O	Filter Hose	854283
P	Separate Hose	854283

Please Note: Other spares are available. Please visit www.pegleryorkshire.co.uk for a more comprehensive spares breakdown

3. Remove the old kitchen tap by disconnecting any flexible hoses or copper tails from the domestic supply.
4. Once the old tap is removed clean around the sink tap hole ensuring it is free from dirt and debris.
5. Screw one of the flexible inlet hoses (part D) into the cold inlet in the body of the dispenser and tighten up ensuring 'O' ring seal is firmly in place to prevent any leaks.

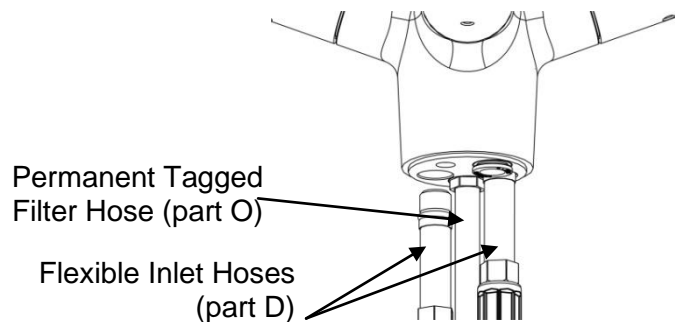

6. Locate separate black tube, (part P) Insert into push-fit connector. Push home until stop is achieved.

IMPORTANT NOTE: In the event of installing the incorrect hose into the push-fit connection – to remove press the black release collar around the push-fit and pull out hose.

7. Locate and screw in clamping stud (part E) until a stop is achieved.

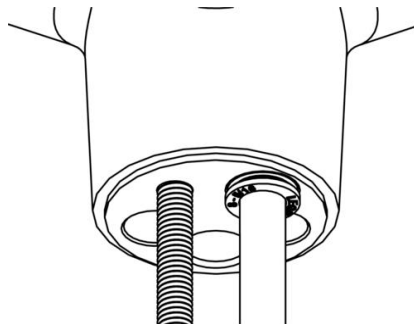

8. Insert Lifetime indicator cable (part C) into base flange (part B) ensuring the "O" ring is located around the indicator cable.
9. Ensure the rubber seal beneath base flange (part B) is in position and locate roughly over the hole in the sink or kitchen surface.
10. Feed Lifetime indicator cable (part C) through the hole and decide position of indicator light.

IMPORTANT NOTE: Deciding on the angle of the indicator light now will make installation easier later. Take care not to pull or damage the indicator light cable.

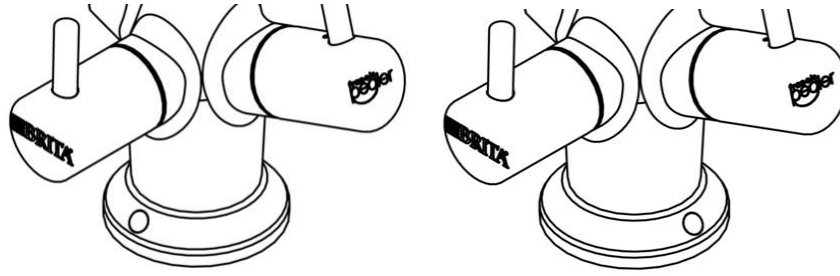

11. Pass flexible inlet hose (part D), plastic hoses (part P and O) and clamping stud (part E) through the base flange (part B) before locating the dispenser onto base flange in the desired position.

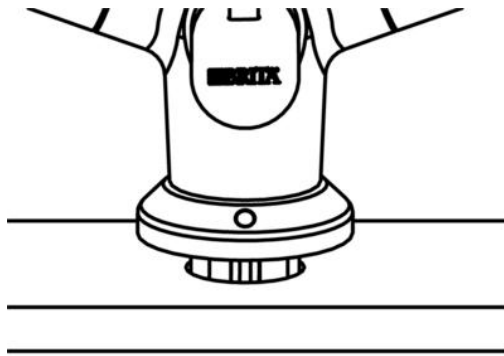

12. Check that the handle and spout movement is not obstructed.
13. Pass the second flexible hose (part D) up through the hole (in the sink or work surface) and screw into the dispenser. Tighten up; ensuring 'O' ring seal is firmly in place to prevent any leaks.
14. To fix the dispenser into place, firstly place "horse shoe shaped" clamping plate (part F) onto the threaded clamping stud (part E) ensuring larger diameter is facing upwards as shown. Secure by screwing tight the clamping nut (part G), taking care of the indicator light cable (part C) as this is now hanging down from the dispenser.

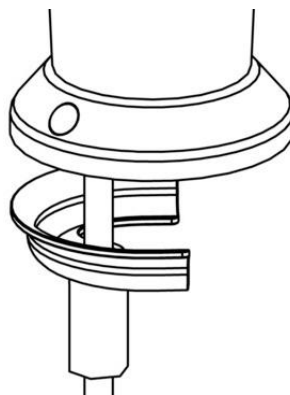

15. Once again re-check that handle and spout movement is not obstructed before tightening fully home.

16. The filter head (part M) and connections are pre-assembled and should not be dismantled by anyone other than a BRITA or Pegler approved installation engineer.
17. Fix the wall mounting bracket (part L) to the filter head (part M). Remove the red protective cap from the filter (part N) and insert it vertically into the filter head NOTE the filter can only be inserted into the filter head with the locking handles in the open position. Turn the locking handle to the closed position until it engages.

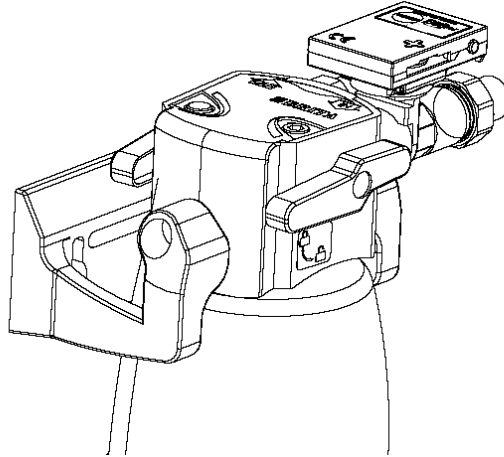

18. Position the cartridge in the chosen location and make sure you have sufficient space for cartridge removal then mark the position of the screw holes.
19. Remove the filter and filter head then screw the mounting bracket (part L) in place.

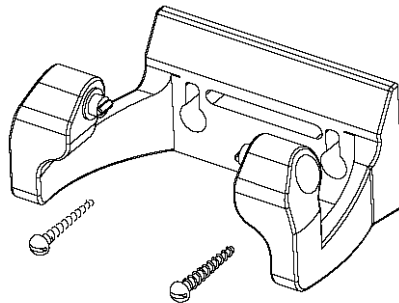

20. Re assemble the filter (part N) into the filter head (part M)
21. Take the hose (identified with tape) (part O) and push into the outlet end of the filter head (part M) until a stop is achieved. The remaining plastic hose (part P) should then be pushed into the brass check valve (part H) until stop is achieved.

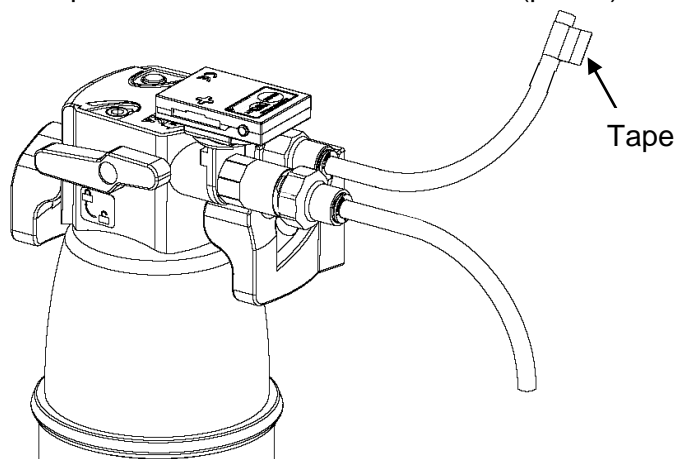

22. Once completed push the connecting plug on the end of the lifetime indicator cable (part C) into the socket on the side of the electronic box (part K). Remove the battery tray (part J) and insert the battery (supplied loose ref: CR2032) positive face up into the battery tray to ensure correct installation of the battery.

**Please note: Never insert battery tray without a battery fitted.
This can cause the battery tray to jam.**

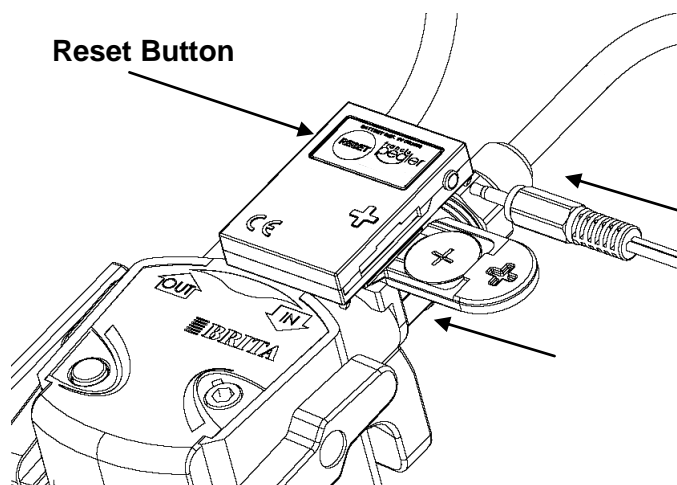

23. The filter head has been set at “++” to meet most UK water conditions. In some soft water areas, you may wish to adjust the filter head to your local settings. To do so, first carry out a carbonate test using the supplied strip.

To use the strip, run a glass of water from the tap and immerse the red response field of the probe into the water for 1 second.

After one minute, compare the colour of the response field with the table and read the appropriate setting from the table.

Depending upon the colour of the testing strip, we recommend setting your filter head as follows:

SETTING	+	++
Colour	Red, Orange, Yellow	Green, Dark Green
Capacity	1,000 L	500 L
Carbohydrate Hardness [°eH]	Up to 10.6	Above 10.6
Grains per Gallon CaCO ₃ [gpg CaCO ₃]	Op to 8.9	Above 8.9
Milligram per Litre CaCO ₃ [mg/L CaCO ₃]	Up to 151	Above 151

24. The filter head is set to “++” by default. To change the setting, use an Allen key (4mm). Turn in the direction of the arrow until the “+” appears in the window.

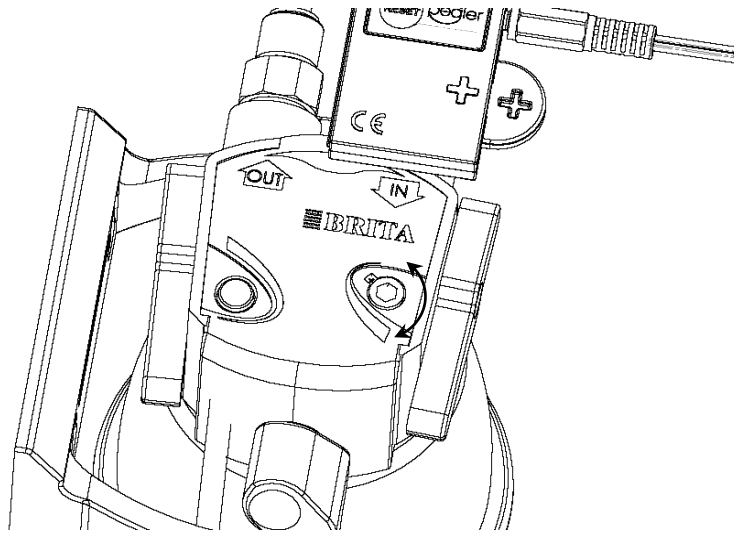

25. Connect flexible inlet hoses (part D) to supplies, using appropriate connectors or order Pegler Prestex 40 straight coupling: order reference code 709017 (15mm X 15mm)
26. Turn on water supply and check for leaks before the handles are turned on.
27. Next turn on the individual dispenser handles and check again for leaks.
28. Press the reset button on the PCB unit (Part K) and hold for 2 seconds, the LED will flash twice indicating the unit has been set to ++. If you require the + setting continue to hold the reset button for a further 4 seconds then the LED will flash at a faster rate, indicating the unit has been set to the + rating. If you make a mistake, press the reset button once to restart the setting procedure.
29. Before use of the filtered water run for one minute/approx 3 litres (or until water runs clear). This primes the new BRITA P 1000 cartridge ready for use for perfect BRITA filtered water at your fingertips.

FITTING A BRITA 3-WAY DISPENSER WITH A WATER SOFTENER:

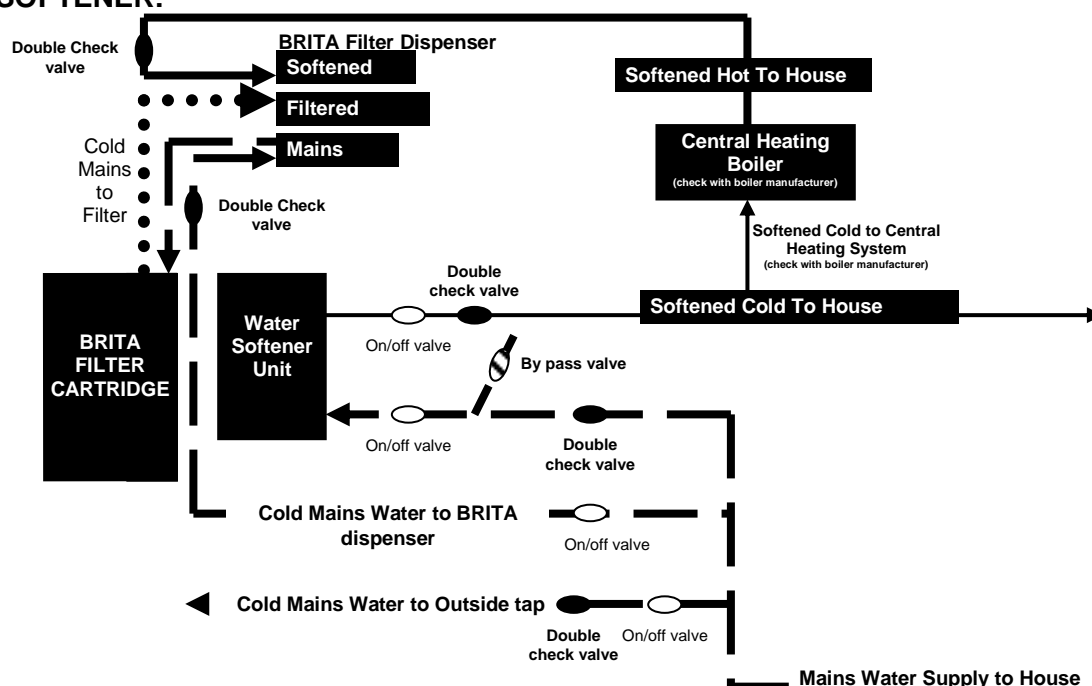

MAINTENANCE:

To maintain the surface finishes, simply wipe occasionally with a mild detergent on soft damp cloth, dry using soft cloth. Never use abrasive cleaners or chemical household cleaners, avoid contact with concentrated bleach. Pegler products are manufactured to the highest standards and should require little or no maintenance. In the unlikely event of any spare part requirements, please contact your nearest stockists or contact

Lifetime indicator:

The lifetime indicator only lights up when either the filter or the battery requires replacement indicated by the following:

Double red flash every 10 seconds = filter requires changing
Single amber flash every 10 minutes = battery requires replacing

It is recommended that the batteries should be changed every twelve months to reduce the risk of battery leakage.

When a new filter is fitted, following the procedure as detailed in point 28, this restarts the lifetime indicator and ensures you will be prompted to change again at the correct time.

Changing the battery will not affect the filter state counter.

Cartridge Exchange Instructions:

Always make sure that you have a BRITA P 1000 spare cartridge to hand. When buying new cartridges look for the BRITA P 1000 filter on the cartridge packaging.

The lifetime of the P 1000 filter cartridge is dependent on your individual volume usage and your water conditions. For optimum BRITA filtration performance, we recommend a minimum exchange of your cartridge every three months. Exchange will be prompted by your BRITA electronic cartridge exchange indicator.

1. When the cartridge exchange indicator double flashes red, the filter cartridge needs to be exchanged.

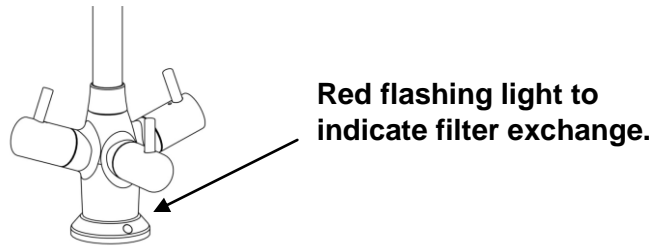

2. Remove exhausted cartridge by opening the locking handle, operate the flush valve and depressurise the system ensuring you have a container underneath the grey hose to catch the water. Remove the BRITA P 1000 filter cartridge from the filter head.

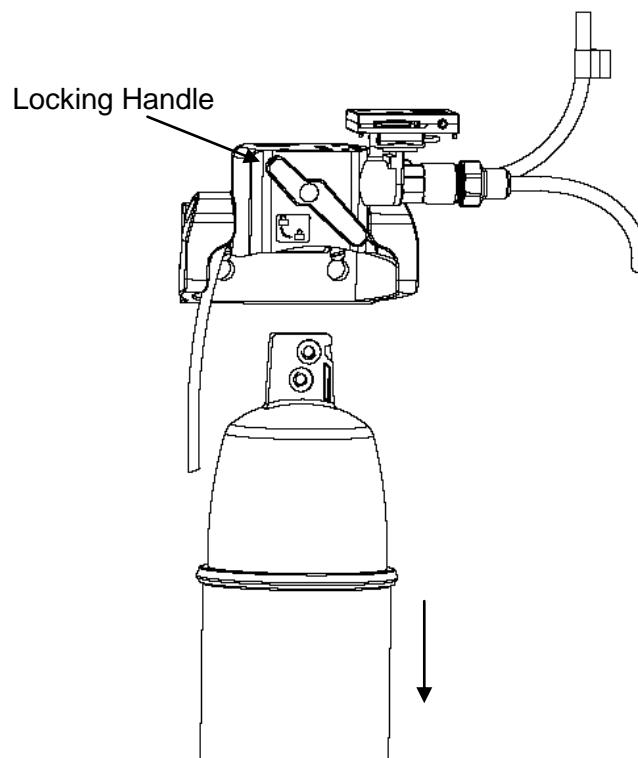

3. Remove all packaging and the red cap from the top of the new filter cartridge.
4. Insert new BRITA P 1000 water filter cartridge vertically into the filter head, the filter can only be inserted with the locking handle in the 'open' position.
5. Ensure the filter is positioned correctly.
6. Turn the locking handle until you feel it engage.
7. Restart the cartridge exchange indicator by pressing the "Reset" button located on the battery housing as described in point 28.

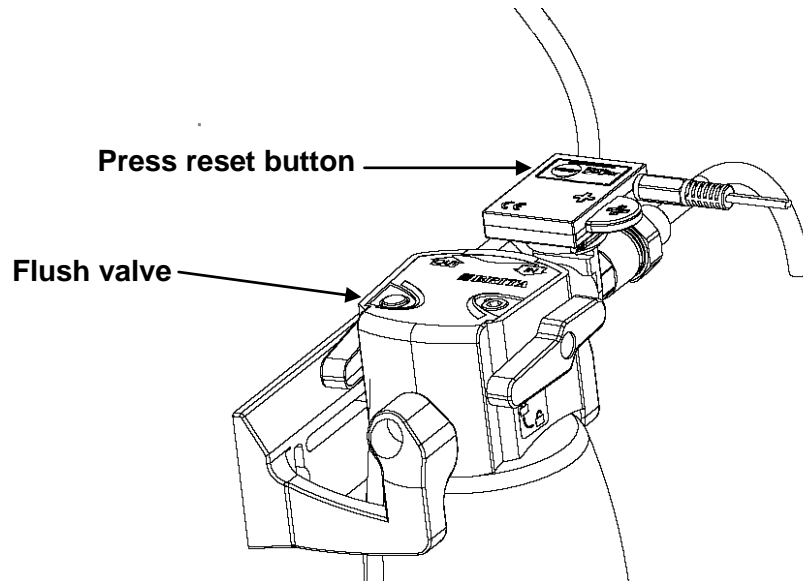

8. Turn the BRITA filter handle for one minute/approx 3 litres (or until water runs clear). This primes the new cartridge ready for use for cleaner BRITA filtered water at your fingertips.

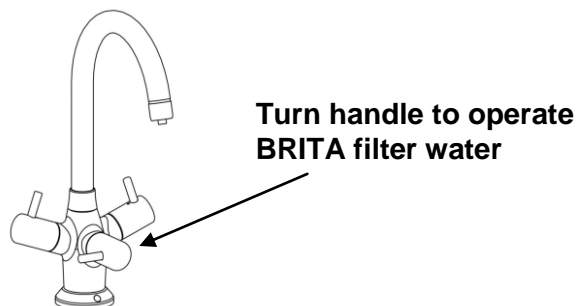

9. Check the dispenser to see that the cartridge exchange indicator has extinguished.

Note: To work together in taking responsibility for our environment, you can return your BRITA P 1000 cartridges to a number of BRITA dealers. To find your nearest recycling store visit www.brita.net/uk or call 0845 0770 035

More information on the use of BRITA P 1000 water filter cartridges can be found in the BRITA information guide.

CARE & USEAGE:

If an instruction is received from the authorities that mains water must be boiled, the BRITA filtered water must also be boiled. When the instruction to boil water is no longer in force, a new filter cartridge must be inserted and the connections must be cleaned.

For certain groups of people (e.g. those with impaired immunity and for babies), it is generally recommended that dispenser water should be boiled; this also applies to filtered water. Irrespective of the water used, you should use utensils with stainless steel, such as kettles and saucepans, to boil the water. In particular, people who are sensitive to nickel should use appliances made of stainless steel or kettles with concealed elements.

For reasons of hygiene, the filter is given a special treatment with silver. A small amount of silver, which poses no known threat to health, may be transferred to the water. This transference would be within the World Health Organisation (WHO) guidelines for drinking-water quality.

Protect the BRITA P 1000 water filter cartridge from direct sunlight and mechanical damage. Do not assemble near sources of heat or open flames. A stop valve must be installed before the filter system intake hose. If the water pressure is greater than 8.6 bar a pressure reducer must be installed in front of the filter system. The BRITA P 1000 is only suitable for domestic use.

IMPORTANT NOTE: For people with kidney disease or dialysis patients: During the filtering process, there may be a slight increase in potassium content. If you have kidney disease and/or have to live according to a potassium-regulated diet, we recommend that you discuss the use of the filter with your doctor.

If your BRITA Filter System is not in use for several days (2 - 3 days), we recommend that you flush the filter system with at least 2 litres. BRITA recommends that the filter system not be taken out of use for longer periods. After stagnation times of over 4 weeks the filter should be flushed with 20 litres or alternatively replaced. In this connection, please also remember the maximum useful life of the filter cartridge of 6 months.

The filter cartridge should be changed after 500 litres, but latest 6 months after commissioning, regardless of the level of exhaustion. To ensure optimum filter performance, the electronic exchange indicator integrated in your 3 way Struana and Ceto tells you when to change the cartridge.

The filter head of the filter system is designed for a service life of 5 years and bears a production date. Exchange must be carried out after 5 years by an expert.

Please store cartridge always in original sealed foil in a cool and dry place.

Although every effort is made to ensure good tasting, reliable odour free water, BRITA cannot offer guaranteed improvement on water quality if the intake of water is microbiologically unsafe or of unknown quality without adequate disinfection before entering the cartridge unit.

An independent institute has also certified the food grade quality of BRITA water filter products. A copy of this is available upon request.

The 3-Way Struana and 3-Way Ceto will for a short period after use drip, this is to allow water pressure within the spout to reduce to atmospheric conditions, and remove any pressure from the filter and filter head. It has been deemed that the amount of “dripping” after use is acceptable at the 2 bar optimum operating pressure. Installations made above this recommended operating pressure may incur dripping for longer periods of time.

The operation of the valves and the handles is such that they are precise and easy to operate. Total movement from fully on to fully off is only 90° or quarter of a turn. Excessive force once opened or closed may force the valve to malfunction.

Should excessive flow be experienced, then it may be necessary to install a Pressure reducing valve upstream from the product. Please order Pegler Prestex PRV-2: order reference code 5A2011 (15mm – which will reduce inlet pressure to 1.5bar minimum)

If you have a low pressure boiler, make sure you only connect the BRITA P 1000 to the cold water supply that feeds the filter dispenser with the angle valve and not the low pressure boiler.

As with every natural product, the BRITA P 1000 parts can be subject to natural fluctuations. This can lead to a slight abrasion of small carbon particles into your filtered water, noticeable as black bits. These particles have no negative health effects. If ingested, they will not harm the human body. In case you observe carbon particles, BRITA recommends flushing out the BRITA P 1000 filter cartridge until the black bits disappear.

The products have a 5 year guarantee against manufacturing defects and 1 year on mechanical parts. All the BRITA filter fittings are covered by a 2 year guarantee. A guarantee claim may be asserted only if all instructions in this handbook are followed and observed.

Pegler and BRITA shall not be held liable for any damage, including subsequent damage arising from the incorrect use of the product.

CONTACT DETAILS:

Pegler Yorkshire
St Catherine's Avenue,
Doncaster, South Yorkshire,
DN4 8DF
www.pegleryorkshire.co.uk

PeglerYorkshire Technical Helpline,
Telephone: 0800 1560 050
Fax: 0808 156 1012

BRITA Water Filter Systems Ltd
BRITA House,
9 Granville Way,
Bicester, OX26 4JT
www.BRITA.co.uk

BRITA Cartridge Helpline and installation:
Telephone: 0845 0770 035

Maximum drilled hole size Ø48
Optimum drilled hole size Ø44 (1.3/4" dia)
Minimum drilled hole size Ø33
All dimensions in mm

