

Traditional Shower Slide Rail Kit

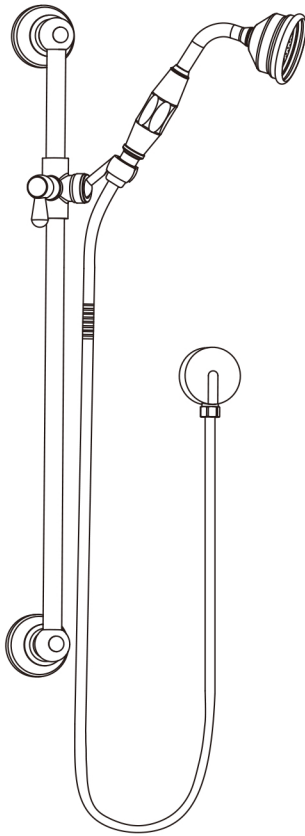

Fitting Instructions

Please follow them carefully and
leave this manual with end user

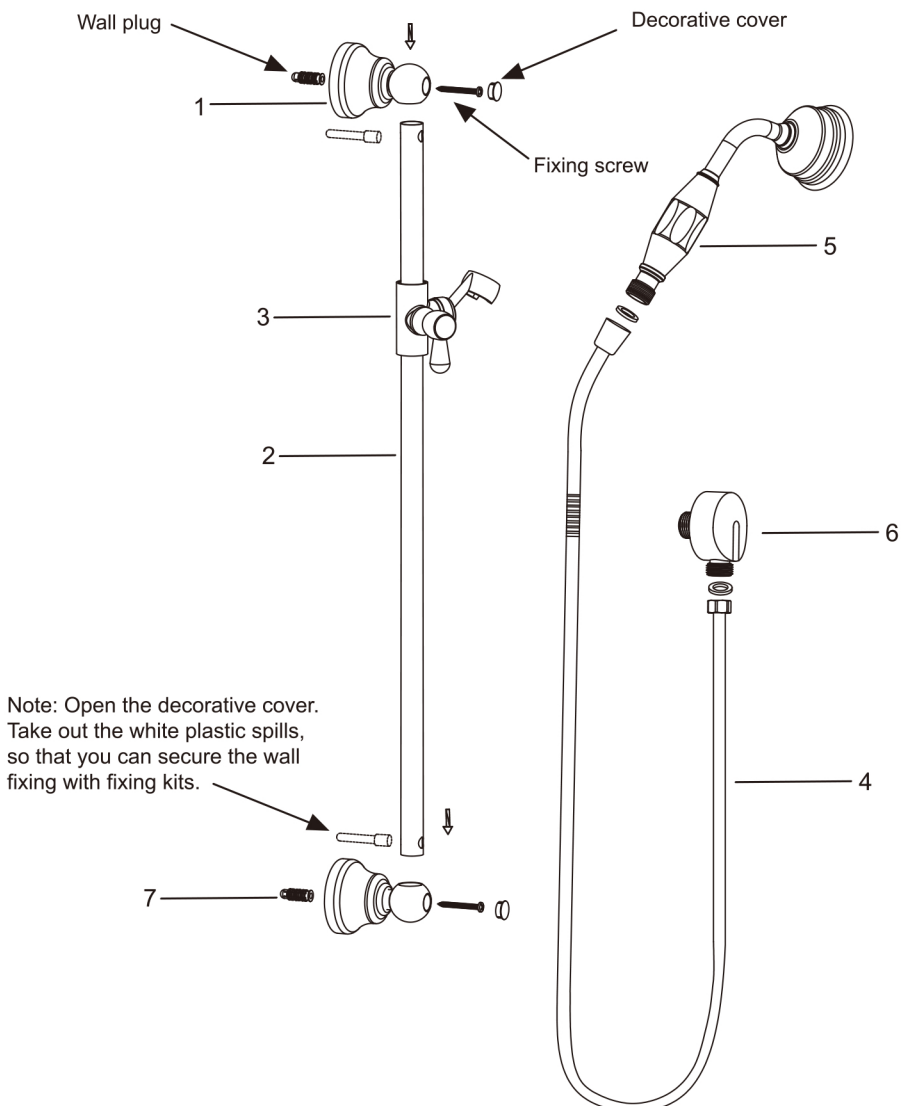

PACK CONTENTS

1 – Wall Fixing (Securing the slider rail kits on the wall), 2 – Slider rail (Add slider handset holder), 3 – Slider handset holder, 4 – 1.5m Shower hose, 5 – Handset, 6 – Outlet Elbow (Connect Flexible Hose), 7 – Fixing kits (Include 2 x wall plug and 2 x fixing screw)