

Installation Instructions

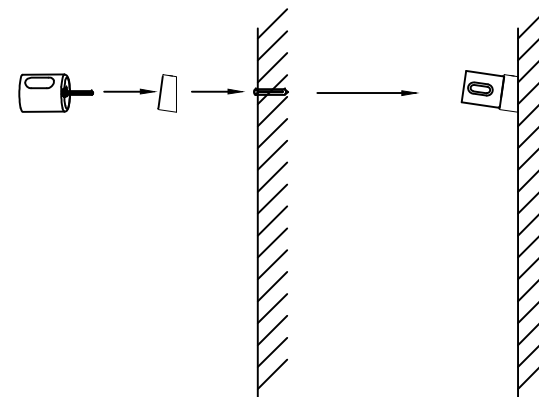
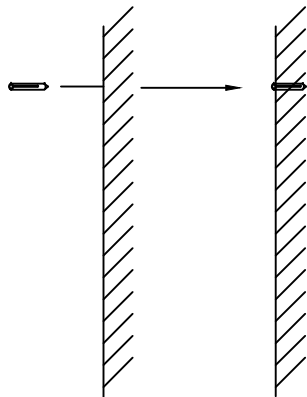
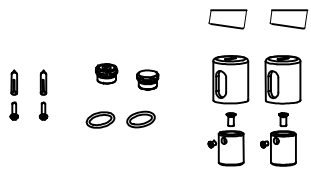

Step 1: Check the components to make sure all are included as above.

Step 2: Pinpoint the positions on the wall then drill four holes accordingly and fix the wallplugs into the wall.

Step 3: Connect the bracket socket to the wall with screws.

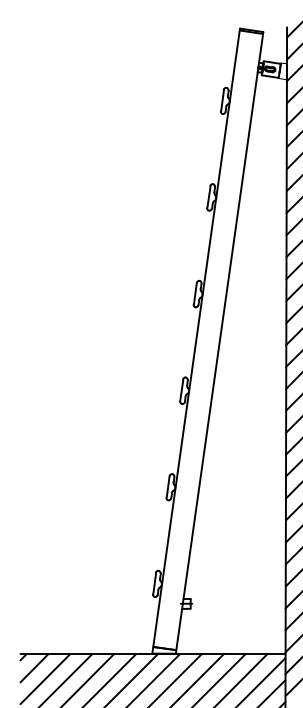
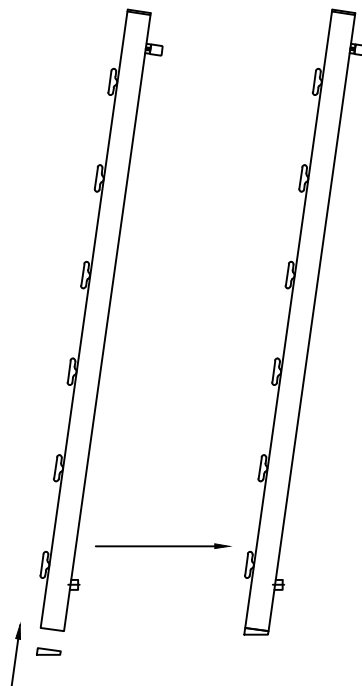
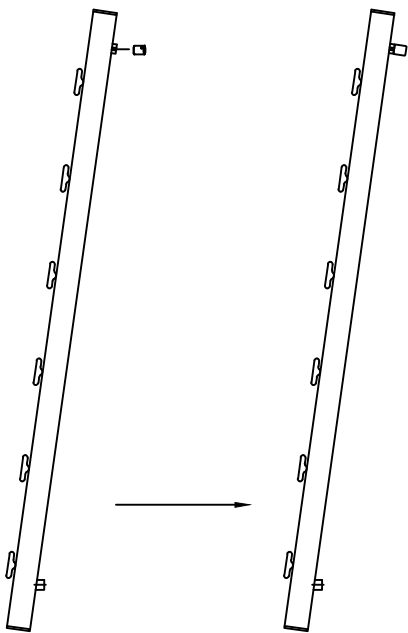

Step 4: Get the bracket fixed to the radiator.

Step 5: Get the adjustment base mounted on the floor, put the radiator on the adjustment base, and tighten the screws at the top.